

1	Safety Instructions.....	4	4.2	Sweep modes.....	17
1.1	Instructions for use.....	4	4.3	Select suction intensity (only in-app operation supported).....	18
1.2	Safety precautions.....	4	4.4	Use of mop module.....	18
1.3	About child safety.....	5	4.5	Map management.....	20
1.4	About the batteries.....	6	4.6	System reset.....	20
1.5	Scope of use of the product.....	6	5	Maintenance.....	21
1.6	Disclaimers.....	6	5.1	Clean dust box and water tank.....	21
1.7	FCC STATEMENT.....	6	5.2	Clean the main brush.....	22
2	Product overview.....	8	5.3	Clean its side brushes.....	22
2.1	Machine and its accessories.....	8	5.4	Clean caster.....	22
2.2	Machine and dust box.....	10	5.5	Clean sensors and charging electrodes.....	22
2.3	Machine and its sensors.....	11	5.6	Clean the mop module.....	23
2.4	Mop module.....	12	6	Common Faults.....	23
2.5	Dust collecting and charging dock.....	12	6.1	Voice prompts.....	23
3	Installation.....	14	6.2	Troubleshooting.....	25
3.1	Assemble the dust collecting and charging dock	14	6.3	Faults in Wi-Fi connection.....	26
3.2	Installation of Dust collecting and charging dock	15	7	Technical Parameters.....	27
4	Operating Instructions.....	16	8	IC warning.....	28
4.1	Use of the machine.....	16	9	Warranty Card.....	29

1 SAFETY INSTRUCTIONS

1.1 INSTRUCTIONS FOR USE

Please review the following basic safety precautions before using the product:

- Read the user manual carefully and follow the instructions in the user manual when using the product.
- Keep the user manual for future reference.
- If you need to transfer the product to a third party, include the user manual with the product.
- Any operation not in conformity to the instructions in the user manual may result in serious personal injury or damage to the product itself.
- This appliance is to only be used with the power supply provided.

1.2 SAFETY PRECAUTIONS



Warning

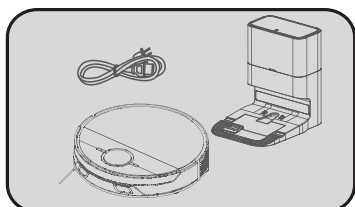

⚠ This product can only be used with the adapter, batteries and charging dock provided with this product. Failure to do so may result in damage to the product, electrical shock, or fire caused by high voltage.

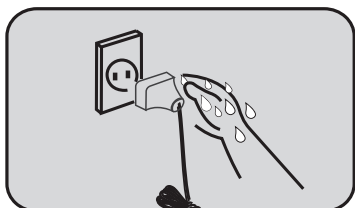

⚠ Do not use this product if the appliance and/or accessories are found to be damaged. Contact our service department. Except for the service technicians designated or authorized by our company, no one may disassemble, repair or modify this product.

⚠ Unplug the product before maintenance.

⚠ Do not touch the power plug or the product when your hands are wet, as this may result in electrical shock.

⚠ If the power cord is damaged, it must be replaced by the manufacturer, its service department or a similar professional.

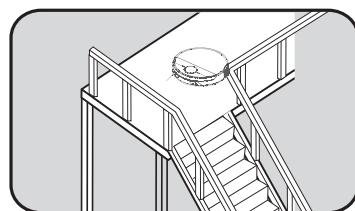

⚠ To prevent the product from falling accidentally, do not use in a suspended place without a protective fence, which may result in personal injury.

⚠ User should not attempt to replace the batteries. Contact the manufacturer for battery replacement.

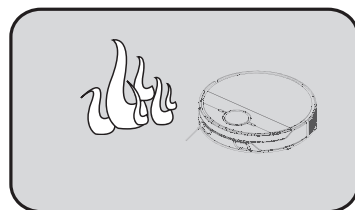

⚠ Prevent clothing or any part of your body (hair, fingers, etc.) from getting caught in the brush or wheel of the vacuum cleaner. Failure to do so may result in personal injury.

⚠ Do not place the product near fire or flammable, explosive or corrosive materials.

⚠ If the user manual is missing, contact your local dealer or call the manufacturer's service department to obtain an electronic user manual.

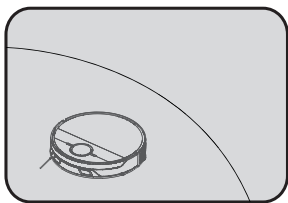
**Caution**

This product should only be used indoors.

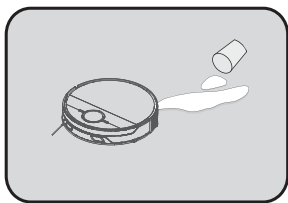

Prevent the suction of water, oil or other liquids, which may damage the vacuum cleaner.

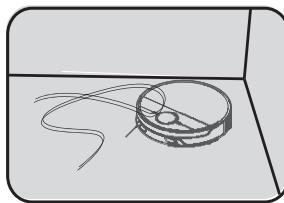

Remove scattered wires from floor before use to avoid affecting the normal operation of the vacuum cleaner.

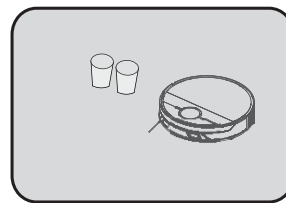

Remove fragile objects before use.

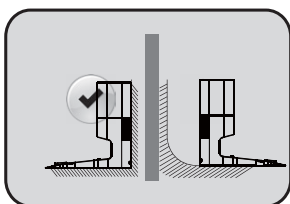

The charging dock should be placed on a flat floor by a wall to ensure proper product functionality.

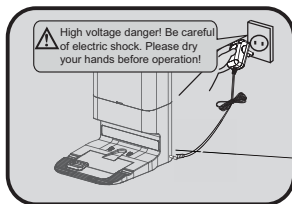

Unplug charging dock when unused for an extended period of time.

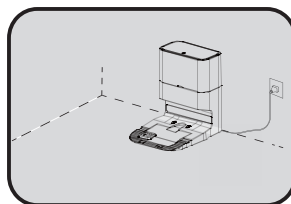

When the product is working, removal of the charging dock will affect the normal recharging of the machine.

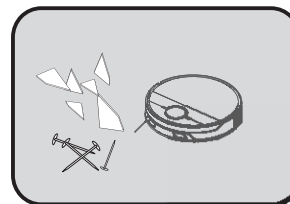

Do not use product to vacuum sharp objects (e.g., shattered glass, nails, etc.) to avoid damage to the product.

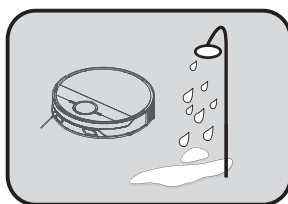

Do not use product in a wet, flammable, explosive or corrosive environment.

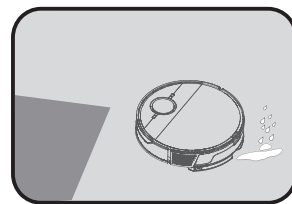

Do not use the mopping function on a carpet.

1.3 ABOUT CHILD SAFETY



- Keep away from children! This appliance should only be used by children aged eight (8) and above and/or persons with reduced physical, sensory or mental capabilities or lack of experience and knowledge if they have been provided supervision and/or instructions concerning safe use of the appliance, and fully understand the hazards involved.
- This is not a toy. Children should not play with the appliance.
- Children should not clean or do maintenance without supervision.

1.4 ABOUT THE BATTERIES



1. Only the batteries provided by the manufacturer are applicable to the product.
2. Before discarding the product, please remove the battery as follows:
 - Use a screwdriver to loosen the screws of the side brush and the base decoration plate;
 - Remove the base plate.;
 - Take out the battery and unplug the connection cable between the battery and the vacuum.
3. Make sure that the product is powered off before removing the battery. Battery should be disposed of properly.
4. Contact manufacturer's service department for battery replacement.
5. Use of incorrect batteries may cause injury or accident.
6. If the batteries leak, prevent the contact of the liquid with the skin or clothing. Immediately wipe it with a dry cloth and send it to the recycling station or designated maintenance point. Do not discard battery.
7. The batteries contain hazardous substances harmful to the environment. Battery should be disposed of properly. Please follow the local environmental regulations and send them to the designated recycling site.



1.5 SCOPE OF USE OF THE PRODUCT

Scope of application

The product is suitable for the following floors:



Wooden floor

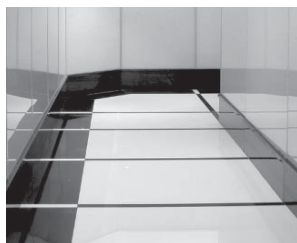

Ceramic tile

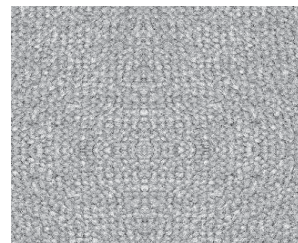

Short-staple carpet

1.6 DISCLAIMERS

Manufacturer's warranty will be null and void under any of the following circumstances:

- Damage due to the user's failure to operate the product in strict accordance with our user manual, or due to improper storage;
- The machine or parts have exceeded the free warranty period;
- Damage due to disassembly by those other than the manufacturer or maintenance personnel authorized by manufacturer.
- A valid purchase voucher number cannot be provided;
- The product model on the warranty card does not match the product to be repaired, or is altered in any way;
- Damage caused by uncontrollable factors such as natural disasters;
- Product failure or damage caused by unexpected factors or man-made causes (including operational errors, liquid ingress, improper plugging/unplugging, scratching, handling, bumping, input of inappropriate voltage, etc.)

i NOTE

Manufacturer provides a warranty for the product in accordance with the "National New Regulations on Warranty". For details, please check the warranty card provided with the product.

1.7 FCC STATEMENT

1. This device complies with Part 15 of the FCC Rules. Operation is subject to the following two conditions:

The following system is used in the operator manual to make it easier to understand:

- (1) This device may not cause harmful interference, and
(2) This device must accept any interference received, including interference that may cause undesired operation.

2. Any changes or modifications not expressly approved by the party responsible for compliance could void the user's authority to operate the equipment.

NOTE: This equipment has been tested and found to comply with the limits for a Class B digital device, pursuant to Part 15 of the FCC Rules. These limits are designed to provide reasonable protection against harmful interference in a residential installation. This equipment generates uses and can radiate radio frequency energy and, if not installed and used in accordance with the instructions, may cause harmful interference to radio communications. However, there is no guarantee that interference will not occur in a particular installation. If this equipment does cause harmful interference to radio or television reception, which can be determined by turning the equipment off and on, the user is encouraged to try to correct the interference by one or more of the following measures:

- Reorient or relocate the receiving antenna.
- Increase the separation between the equipment and receiver.
- Connect the equipment into an outlet on a circuit different from that to which the receiver is connected.
- Consult the dealer or an experienced radio/TV technician for help.

FCC Radiation Exposure Statement

This equipment complies with FCC radiation exposure limits set forth for an uncontrolled environment. This equipment should be installed and operated with minimum distance 20cm between the radiator & your body.

2 PRODUCT OVERVIEW

2.1 MACHINE AND ITS ACCESSORIES

TABLE 1: MACHINE

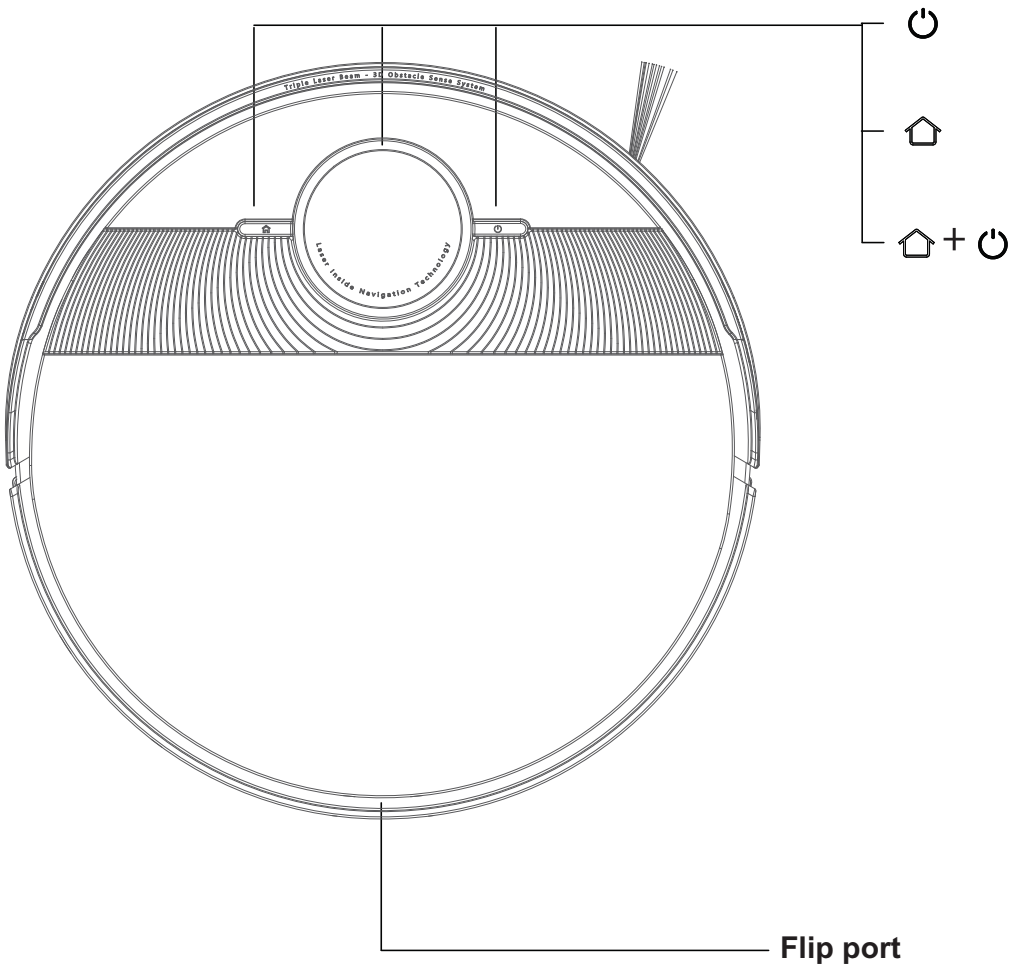

Home Button

- Press to return to dock for charging. Press again to pause
- Press and hold for 3 seconds to start fixed-point cleaning
- In the charging state, press once to start dust collection

LED Status Indicator

- White: working state light. Battery level $\geq 20\%$
- Yellow: low battery state light. Battery level $< 20\%$
- Red: Fault



Cleaning On/Off button

- Press and hold for 3 seconds to turn on or off (only when vacuum is not being charged).
- Press to start cleaning.
- Press to pause the task.

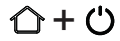

Home button + on/off button

- Press and hold both buttons simultaneously for 3 seconds to reset Wi-Fi connection.
- Flashing: charging or starting in progress
- Fast flashing in red: fault state

TABLE 2: ACCESSORIES

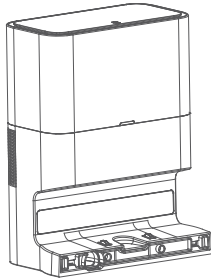

Dust collecting and charging dock ×1

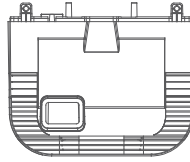

Bottom tray ×1

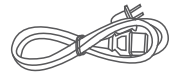

Power cord ×1

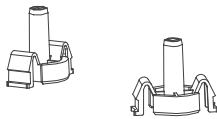

Tray Fastener ×2

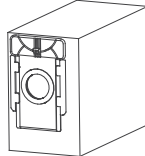

Disposable dust bag ×1

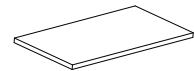
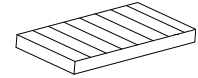

Filter combination ×2

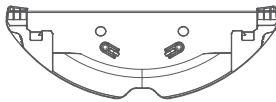

Mop holder ×1



Common mop ×1



User manual ×1

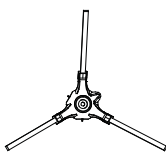

Side brush ×2

Note: A filter combination and battery have been installed in the vacuum cleaner; a disposable dust bag has been installed in the dust collection charging stand ; the illustrations in this manual are for reference only, and the actual appearance is subject to the actual product.

2.2 MACHINE AND DUST BOX

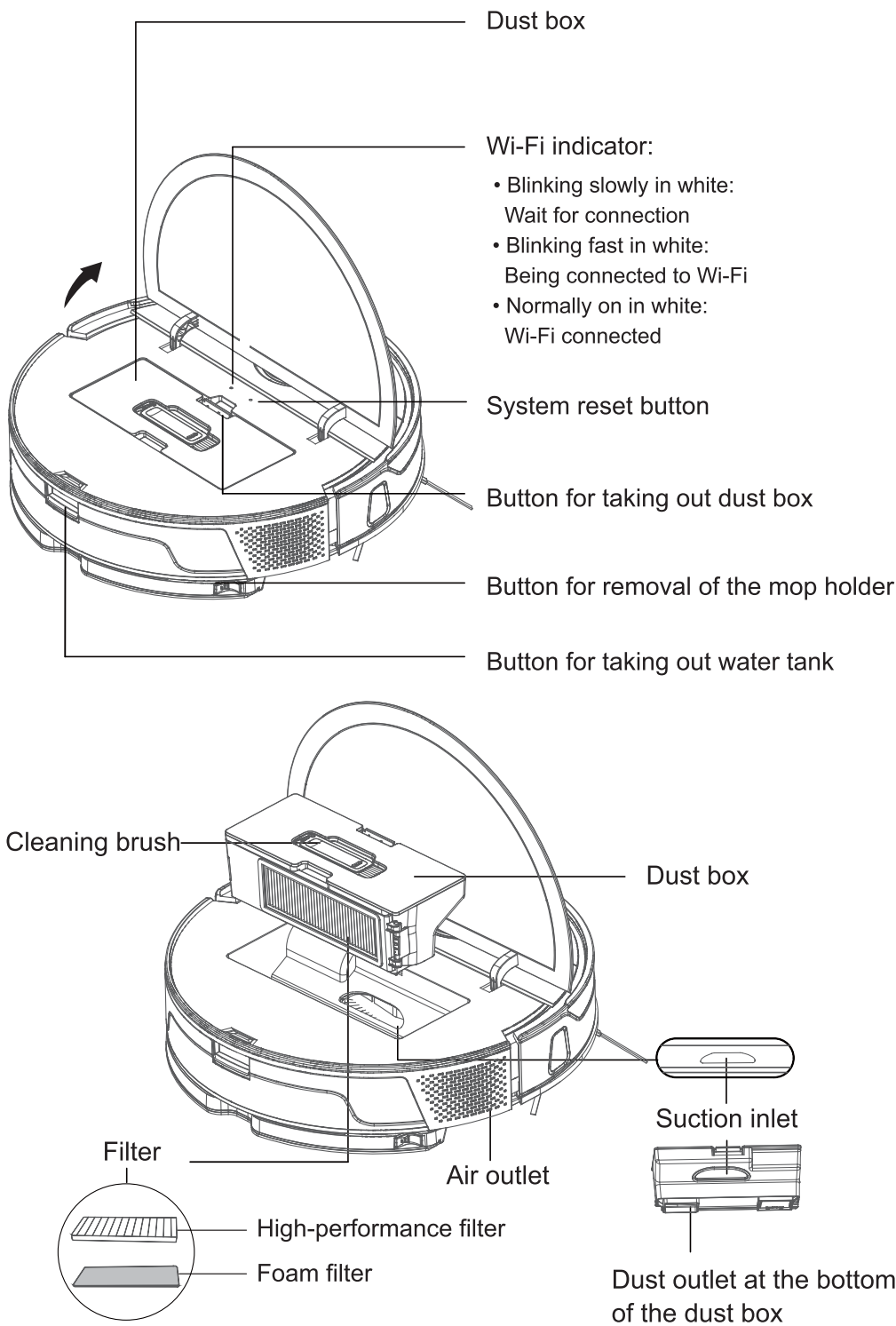

2.3 MACHINE AND ITS SENSORS

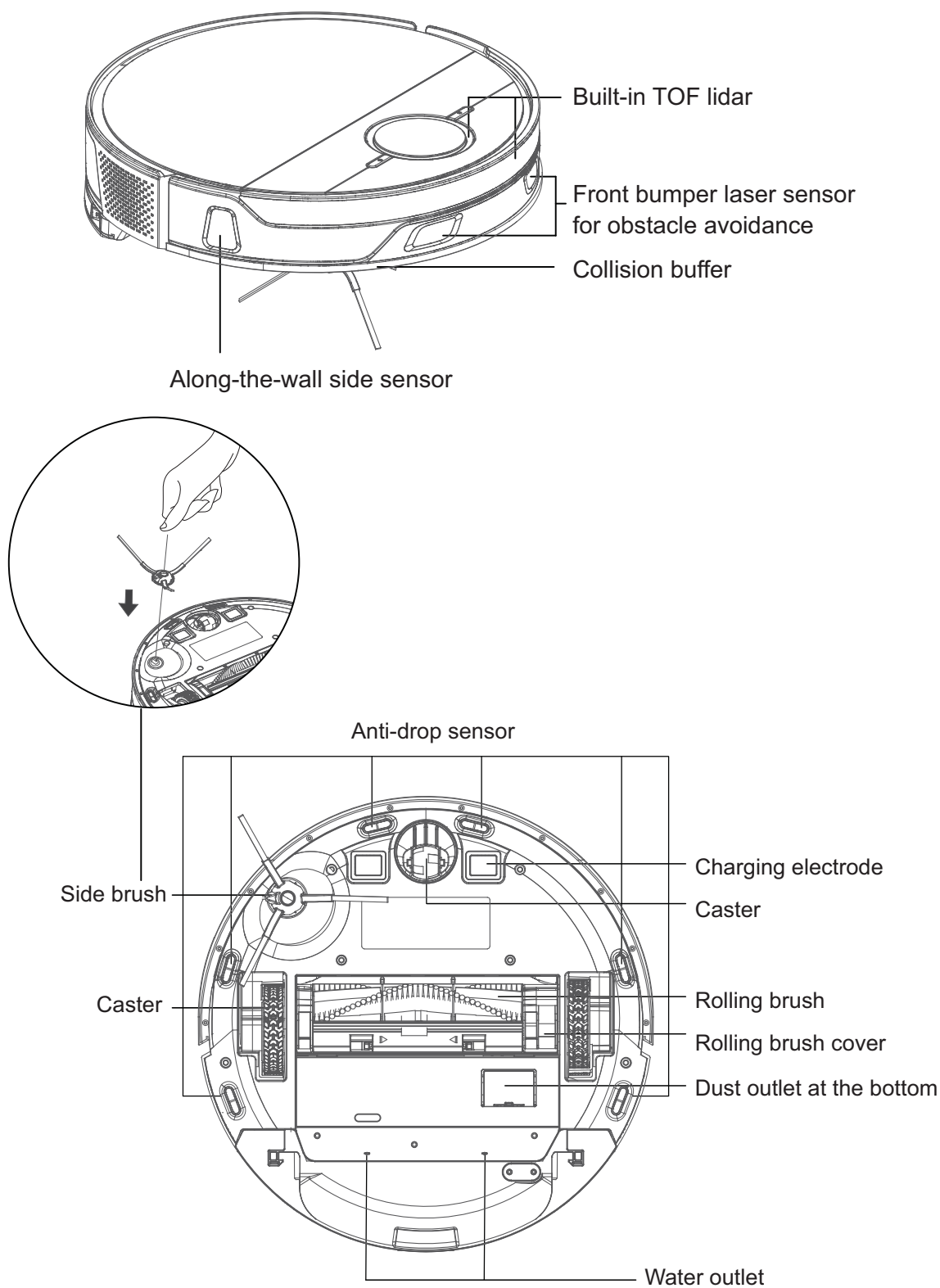

2.4 MOP MODULE

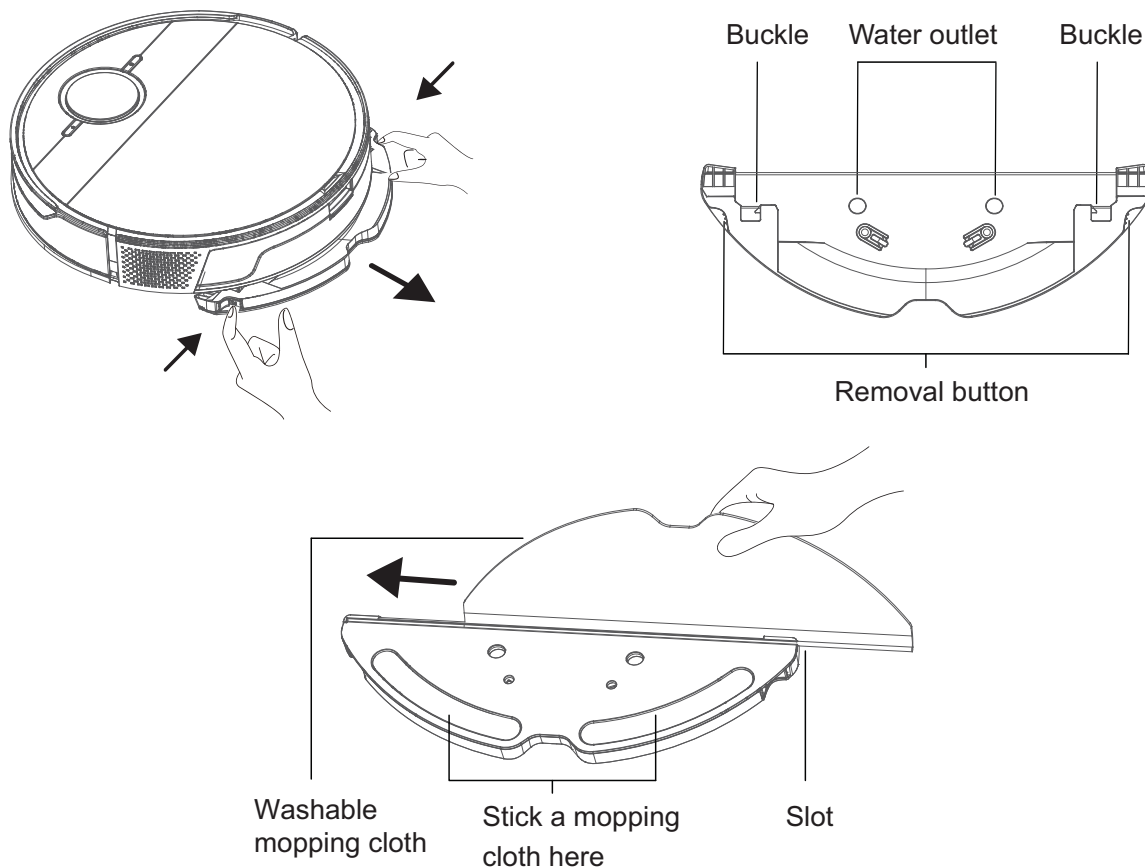

2.5 DUST COLLECTING AND CHARGING DOCK

Charging dock indicator

- Normally on in white: The charging dock has been connected to a power supply (when the machine is not connected to the charging dock);
- White light off: The machine is correctly connected with the charging dock;
- White light flashing 3 times: When a relevant instruction is received;
- Red light normally on: The dust bag or the dust collecting and charging dock cover is not installed in place;
- Red light flashing 3 times: When a dust collection error or wrong operation occurs.

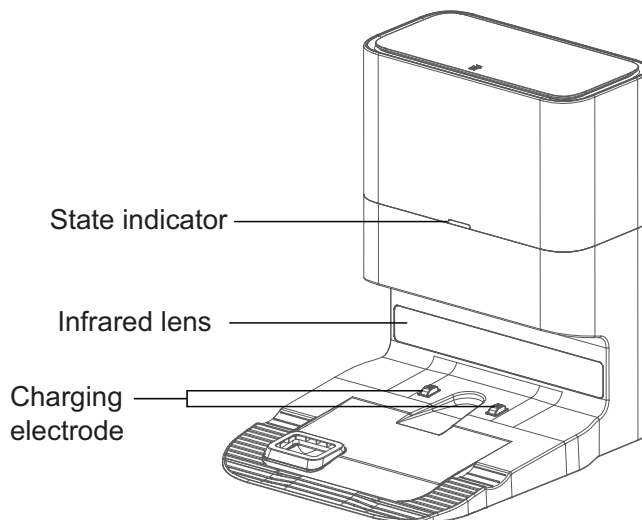

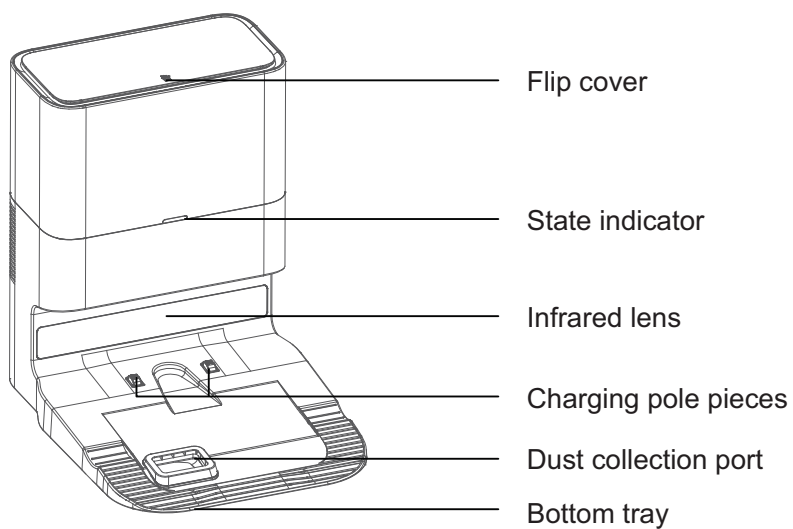
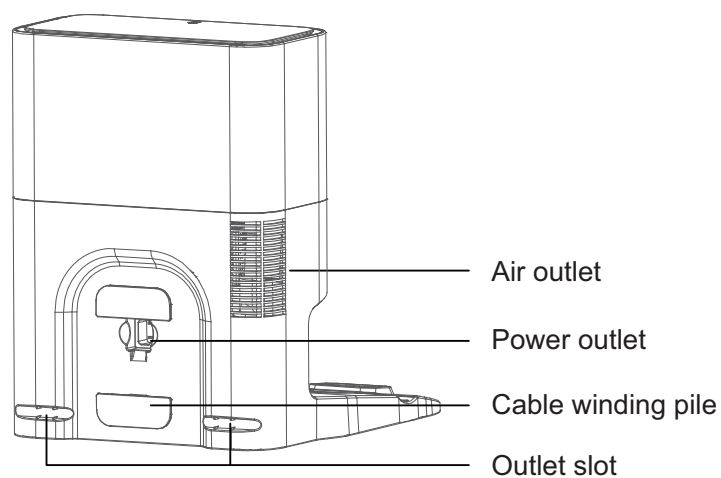
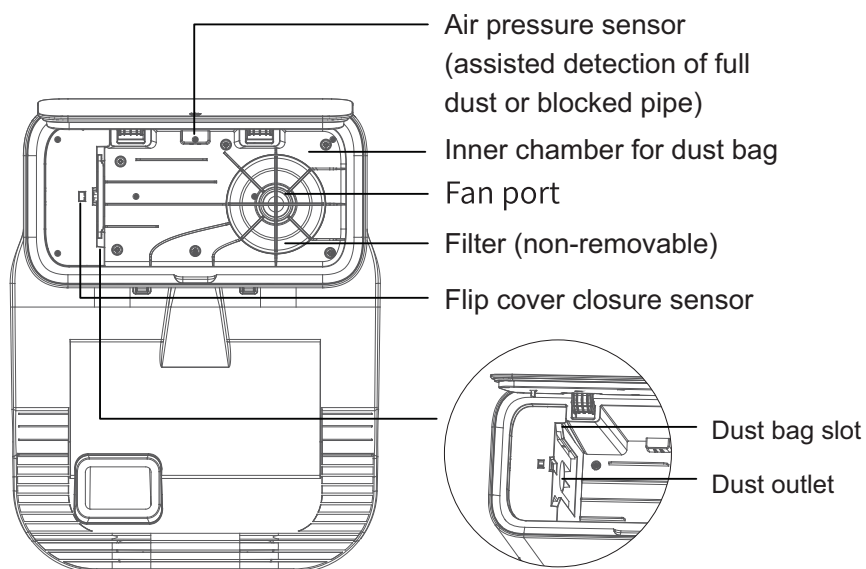

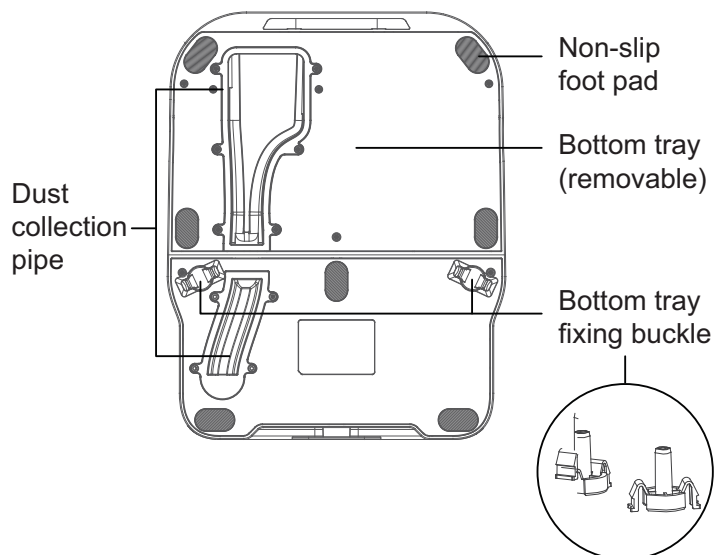

3 INSTALLATION

3.1 ASSEMBLE THE DUST COLLECTING AND CHARGING DOCK

1. Locate the dust collecting and charging dock, bottom tray, and bottom tray fasteners;

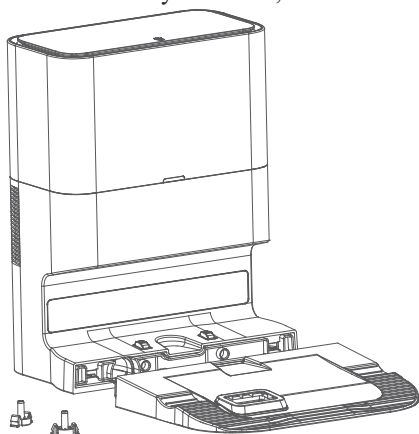

2. Connect the dust collecting and charging dock with the bottom tray, and ensure proper connection;

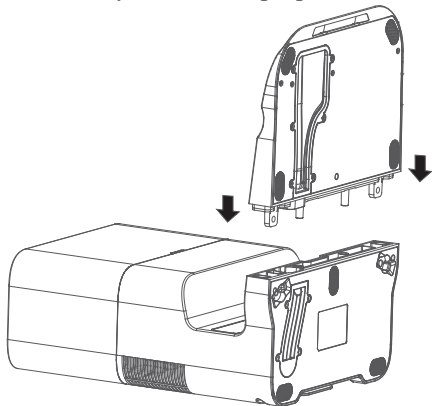

3. Insert the fasteners into the bottom tray and press until they click to complete the assembly of the dust collecting and charging dock;

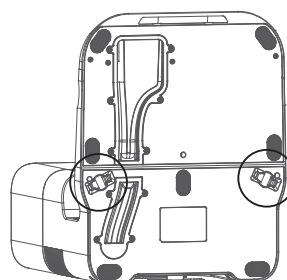
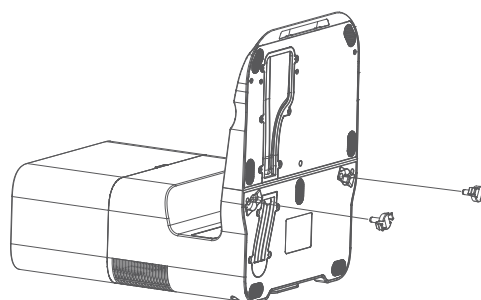

4. Take out the dust bag and check whether the dust bag is in good condition, open the cover, insert the dust bag into the dust bag slot to the bottom, close the cover, and it can be used after power on.

