



SENNHEISER

AMBEO Soundbar | Mini

Model: SB02S

- FI Pikaohje
- EL Σύντομες οδηγίες
- PL Krótka instrukcja obsługi
- TR Kısa Kılavuz
- RU Краткая инструкция
- JA クイックガイド
- KO 빠른 안내서
- ID Panduan ringkas
- ZH-HANS 快速指南
- ZH-HANT 快速指南



Sonova Consumer Hearing GmbH
Am Labor 1, 30900 Wedemark, Germany
www.sennheiser-hearing.com

Publ. 07/22, 591148/DVT

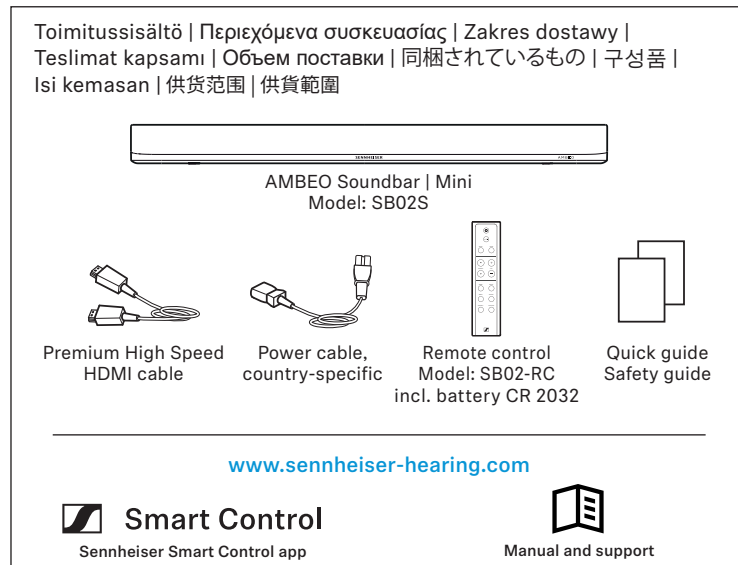

Amazon, Alexa and all related marks are trademarks of Amazon.com, Inc. or its affiliates. Alexa is not available in all languages and countries. Alexa features and functionality may vary by location.
Android, Google play, Google play logo, Google Chromecast built-in and OK Google are trademarks of Google LLC.
App Store is a service mark of Apple Inc. Use of the Works with Apple badge means that an accessory has been designed to work specifically with the technology identified in the badge and has been certified by the developer to meet Apple performance standards. To control this AirPlay 2-enabled speaker, iOS 11.4 or later is required.
The Spotify Software is subject to third party licenses found here:
https://www.spotify.com/connect/third-party-licenses. Use your phone, tablet or computer as a remote control for Spotify. Go to spotify.com/connect to learn how.

1 Soundbar-kaiuttimensijoituspaikan valinta
Εγκατάσταση Soundbar
Ustawianie zestawu soundbar
Soundbar ayarlama
Установка звуковой панели

サウンドバーの設置
사운드바 설치
Menginstal soundbar
搭起条形音箱
搭起条形音箱

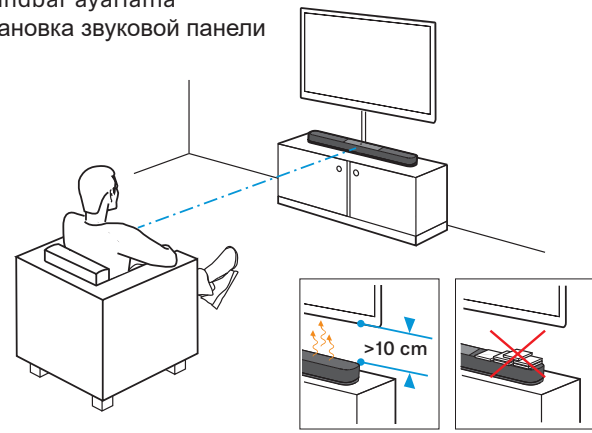

Wall mount SB02-WM
Seinäpäidike (valinnainen varuste)
Επιτοίχιο στήριγμα (προαιρετικό παρελκόμενο)
Uchwyt naścienny (opcjonalny)
Duvvar askaris (opsiyonel aksesuar)
Настенное крепление (опциональный аксессуар)
ウォールブラケット (オプションアクセサリ)
벽면 부착용 브래킷(옵션 액세서리)
Braket dinding (aksesori opsional)
壁掛式支架 (可选附件)
壁掛式支架 (可选附件)

SB02-WM

Remote control SB02-RC
Kauko-ohjaus
Τηλεελεγκτήριον
Zdalna obsługa
Uzaktan kumanda

Дистанционное управление
리모콘

Pengendali jarak jauh
远程控制
遠程控制

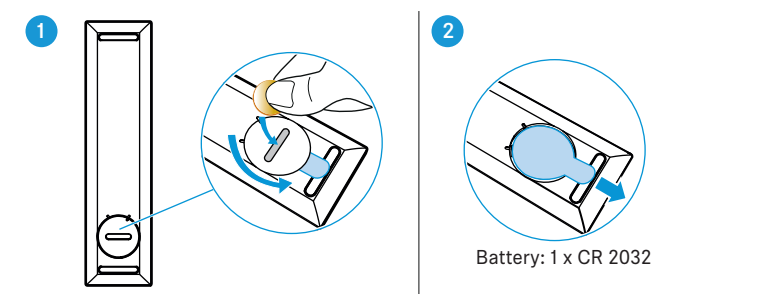

2 Soundbar-kaiuttimen yhdistäminen televisiovastaanottiin ja muihin audiolähteisiin
Σύνδεση του Soundbar με μια τηλεόραση και άλλες ηχητικές πηγές
Podłączenie zestawu soundbar do telewizora i innych źródeł dźwięku
Soundbar'ın televizyona ve diğer ses kaynaklarına bağlanması

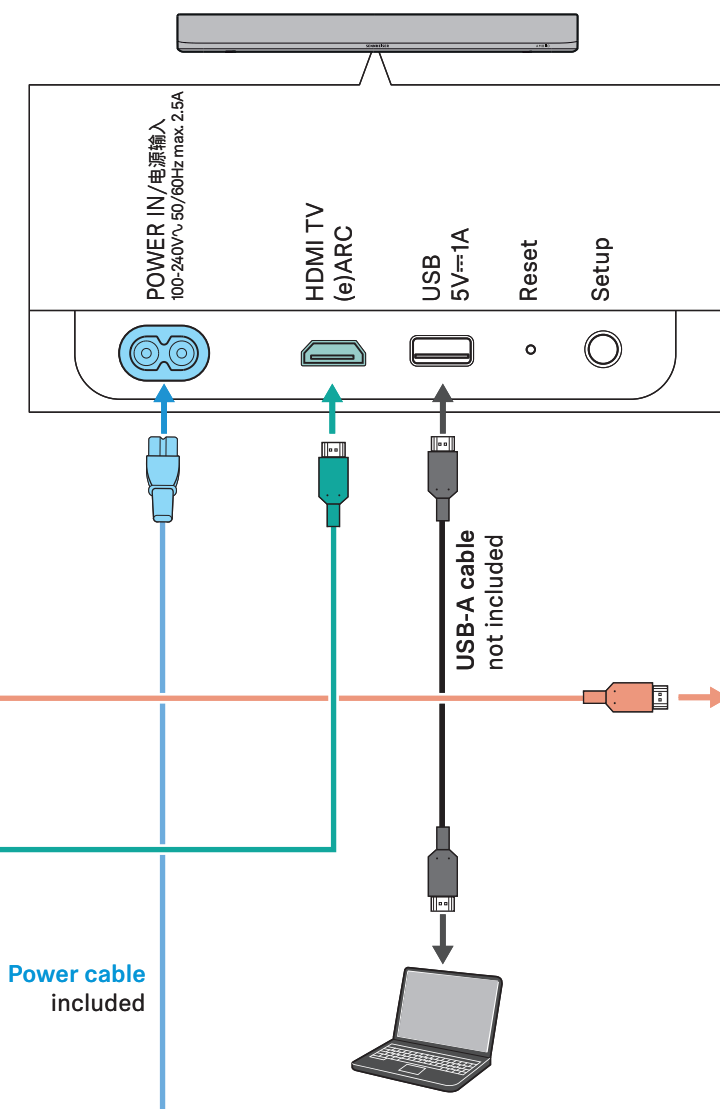
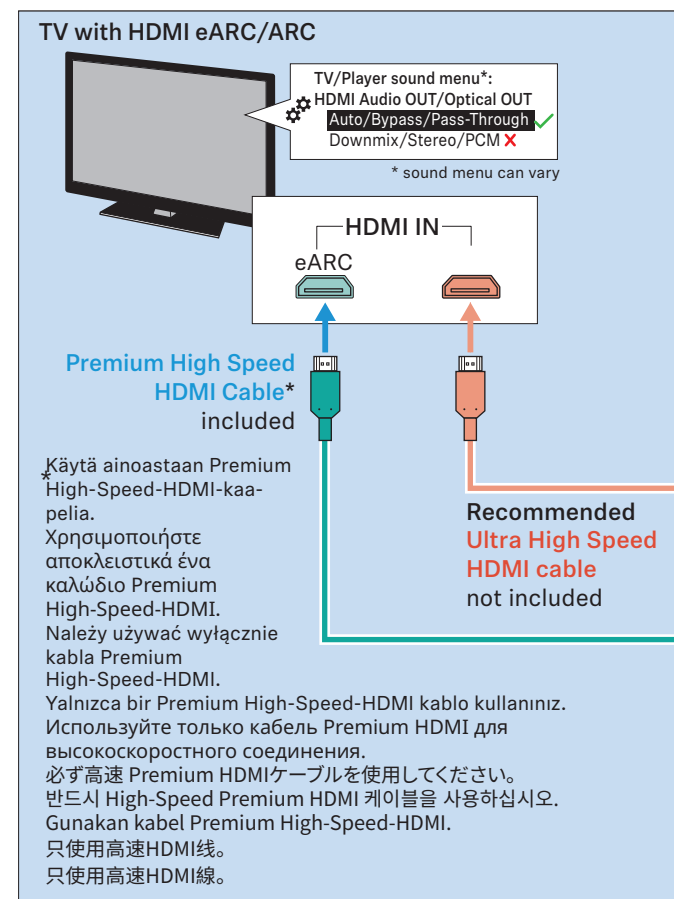

Подключение звуковой панели к телевизору и другим источникам аудиосигнала
Σαუნδβάρ-ελεχτήριον με μια τηλεόραση και άλλες ηχητικές πηγές
Podłączenie zestawu soundbar do telewizora i innych źródeł dźwięku
Soundbar'ın televizyona ve diğer ses kaynaklarına bağlanması

將音響連接器連接到電視和其他音訊源
將條形音響連接器連接到電視和其他音訊源

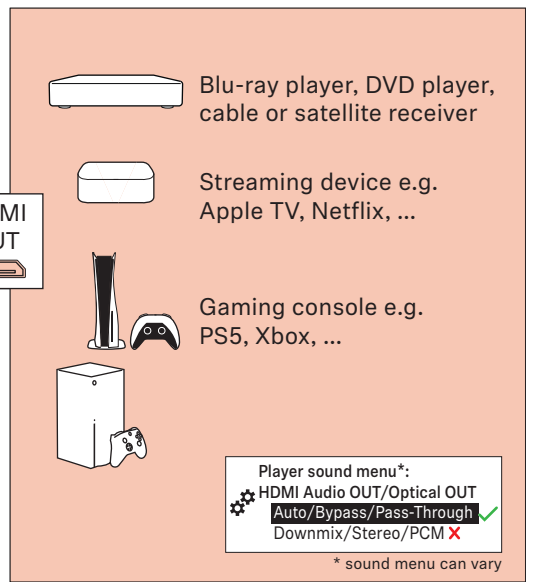

3 Smart Control

www.sennheiser-hearing.com/smartcontrol

Asenna älypuhelimieesi sopiva Smart Control -sovellus.
Εγκαταστήστε την εφαρμογή Smart Control για smartphone.
Instalacja aplikacji Smart Control na smartfonie.
Akıllı telefonunuz için Smart Control uygulamasının kurulması.
Установите приложение Smart Control для смартфона.
お使いのスマートフォン用の Smart Control アプリをインストールします。
스마트폰에 Smart Control App을 설치합니다.
Menetapkan pengaturan WLAN.
为您的智能手机安装 Smart Control App.
为您的智能手机安装 Smart Control App.

3.1 WLAN

Määrittele WLAN-asetukset
Ορίστε τις ρυθμίσεις WLAN
Wprowadź ustawienia WLAN
WLAN ayarlarını yap
Настройка Wi-Fi
Wi-Fi 설정을 구성합니다.
Menetapkan pengaturan WLAN
調整WLAN設定。
調整WLAN設定。

3.2 Smart Control

Huonekalibroinnin käynnistäminen Smart Control -sovelluksessa
Έναρξη βαθμονόμησης στην εφαρμογή Smart Control
Rozpocznianie kalibracji pomieszczenia w aplikacji Smart Control
Smart Control uygulamasında ortam kalibrasyonunun başlatılması
Запуск калибровки помещения в приложении Smart Control
Smart Control App에서 홈 보정 시작하기
Memulai kalibrasi ruang pada aplikasi Smart Control
在 Smart Control App中启动室内校准

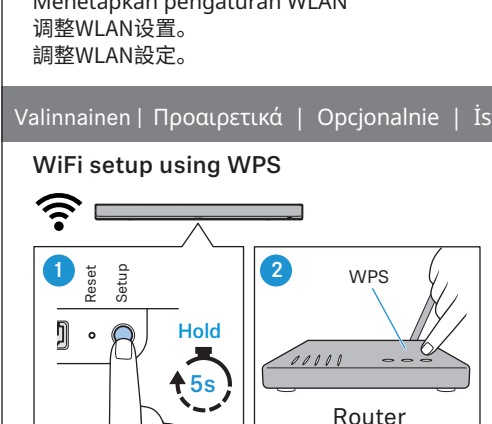

4 Käytä Soundbar-kaiuttimen puheohjaukseen:
Για φωνητικό έλεγχο του Soundbar χρησιμοποιήστε:
Do sterowania głosowego należy wykorzystać zestaw soundbar:
Soundbar'in sesli araması için kullanınız:
Для голосового управления звуковой панелью используйте:
Σαუნδβάρ-ελεχτήριον με μια τηλεόραση και άλλες ηχητικές πηγές
Podłączenie zestawu soundbar do telewizora i innych źródeł dźwięku
Soundbar'ın televizyona ve diğer ses kaynaklarına bağlanması

Configuration
Konfiguration
Configuración
Configuração
Configuratie
Configurazione
Konfiguration
Konfiguration

Internet connection and user account required. The availability of Amazon Alexa and Alexa Cast and Ok Google and Chromecast depends on region.

Valinnainen | Προαιρετικά | Opcjonalnie | İsteğe bağlı | Опция | オプション | 옵션 | Opsional | 可选 | 可選

AMBEO Subwoofer SW02 -kaiuttimen yhdistäminen langattomasti Soundbar-kaiuttimeen
Ασύρματη σύνδεση του AMBEO Subwoofer SW02 με το Soundbar
Bezprzewodowe połączenie subwoofera AMBEO SW02 z zestawem soundbar
AMBEO Subwoofer SW02'nin kablosuz Soundbar'a bağlanması
Беспроводное соединение сабвуфера AMBEO SW02 со звуковой панелью
AMBEO Subwoofer SW02를 Σαუნδβάρ-ελεχτήριον με μια τηλεόραση και άλλες ηχητικές πηγές
Podłączenie zestawu soundbar do telewizora i innych źródeł dźwięku
Soundbar'ın televizyona ve diğer ses kaynaklarına bağlanması

enintään 4 laitetta mahdollisia
Δυνατότητα έως 4
możliwa do 4
4 aygıtta kadar mümkün
возможно до 4
最大4つまで可能
4대까지 연결 가능
hingga 4 dimungkinkan
最多4个
最多4個

Konfigurointi
Διαμόρφωση
Konfiguracja
Yapılandırma
Konfiguracija
設定
구성
Konfigurasi
配置

Auto connect

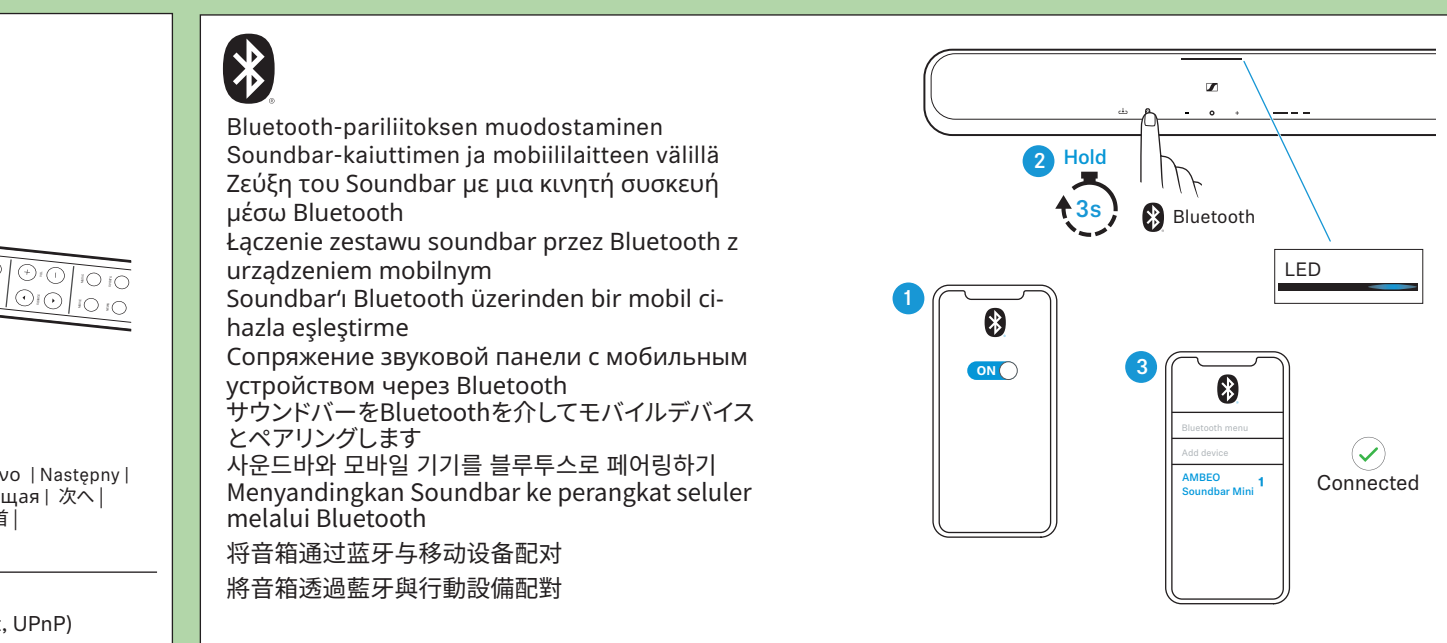
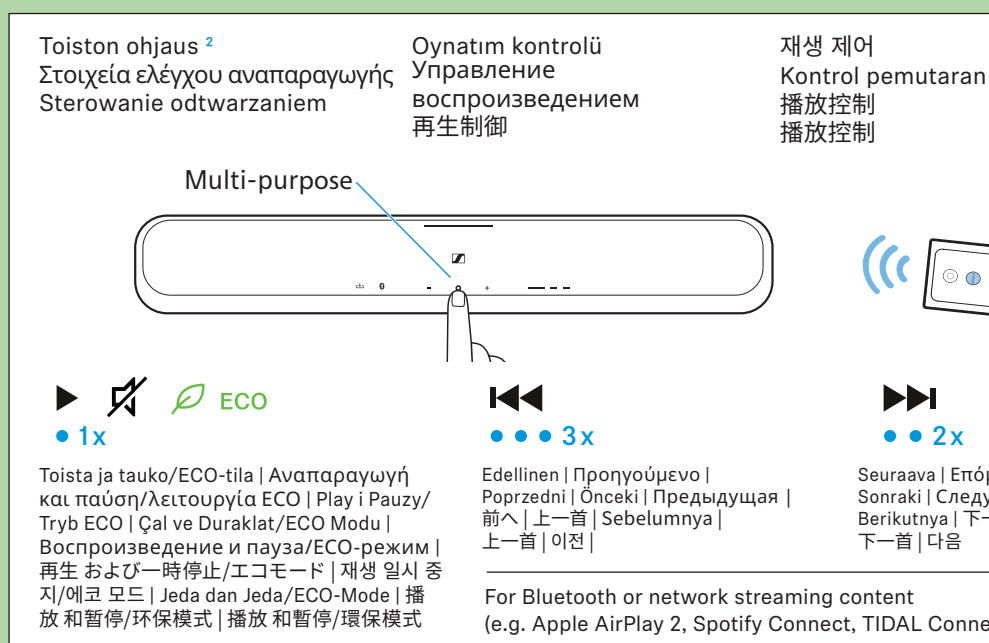
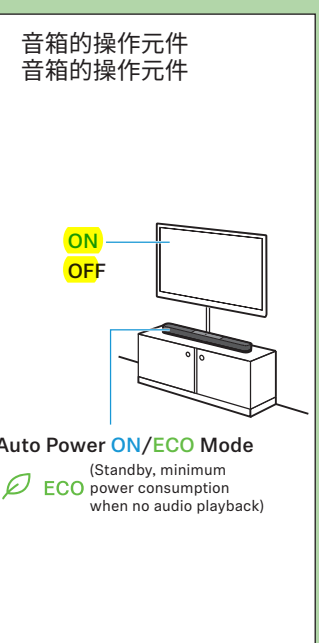
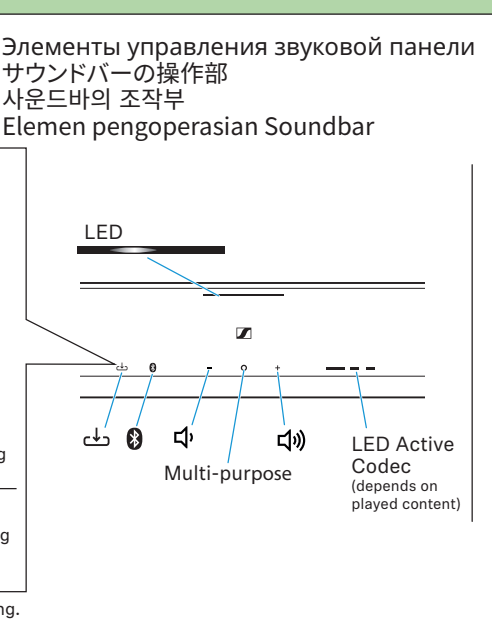
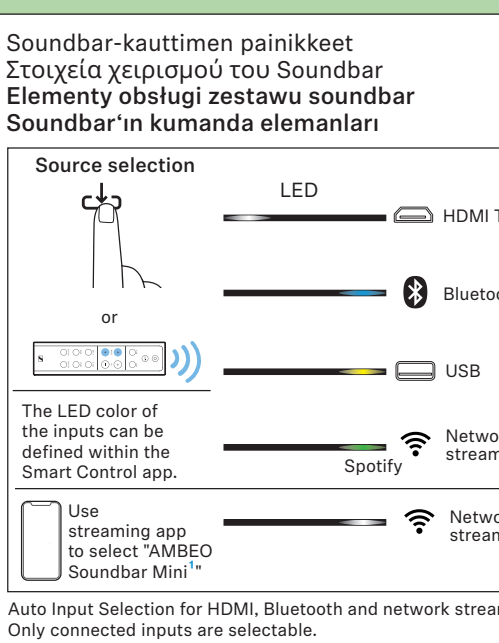

1 If Alexa is activated the Multi-purpose button will turn to Alexa action button to trigger Alexa. See instruction manual or Smart Control app for details.
2 The Bluetooth/network name can be defined within the Smart Control app