

#### Print specs:

Paper grammage outside: 120 gsm artpaper - matt finish	Guide delivery: booklet, landscape, 2x wire stitching
Paper grammage inside: 80 gsm, woodfree	
Print colours: 4 C (CMYK)	Paper quality:
Open size: 114 x 162 mm	Close size: 114 x 81 mm
Release date: 13. June 23 (A01)	



## ACCENTUM PLUS





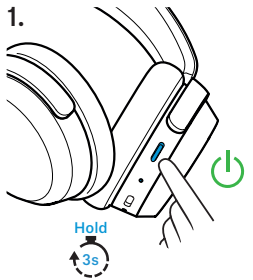
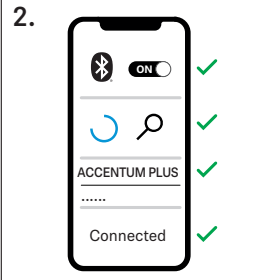
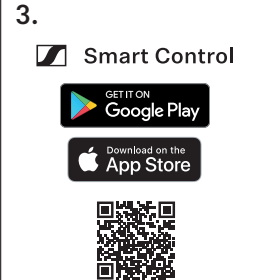



Model: ACPAEBT

## SENNHEISER

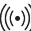
- 
- 
- 

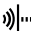
 → page 12

EN	Quick Guide
DE	Kurzanleitung
FR	Guide rapide
ES	Instrucciones resumidas
PT	Guia rápidos
NL	Beknopte handleiding
IT	Guida rapida
DA	Kort vejledning
SV	Snabbguide
FI	Pikaohje
EL	Σύνοψες οδηγιές
PL	Krótką instrukcja obsługi
TR	Kısa Kılavuz
RU	Краткая инструкция
JA	クイックガイド
ZH-HANS	快速指南
ZH-HANT	快速指南
KO	빠른 안내서
ID	Panduan ringkas

	Charging .....	3
	Power on / Power off.....	4
	Pairing.....	5
	Music control .....	6
	Call control .....	7
	Adaptive Noise Cancellation.....	8
	Transparency Mode.....	9
	Voice assistant .....	10
	Package includes.....	11
	Troubleshooting.....	12



## Charging

DE	Laden
FR	Charger
ES	Cargar
PT	Carregar
NL	Opladen
IT	Caricare
DA	Opladning
SV	Laddning
FI	Lataaminen
EL	Φόρτιση
PL	Ładowanie
TR	Şarj etme
RU	Зарядка
JA	充電
ZH-HANS	充电
ZH-HANT	充電
KO	충전
ID	Mengisi daya

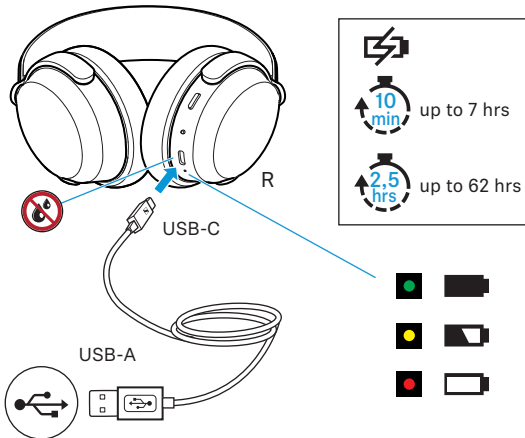



## Power on / Power off

- DE Einschalten/Ausschalten  
FR Allumer / éteindre  
ES Encender / Apagar  
PT Ligar/desligar  
NL Inschakelen/uitschakelen  
IT Accendere/Spegnere  
DA Tænd/sluk  
SV Sätta på/stänga av  
FI Virran kytkeminen ja katkaiseminen  
EL Ενεργοποίηση / απενεργοποίηση  
PL Włączenie / wyłączenie  
TR Açma/Kapatma  
RU Включение/выключение  
JA スイッチのオン/オフ  
ZH-HANS 接通/关闭  
ZH-HANT 接通 / 關閉  
KO 켜기/끄기  
ID Mengaktifkan/menonaktifkan

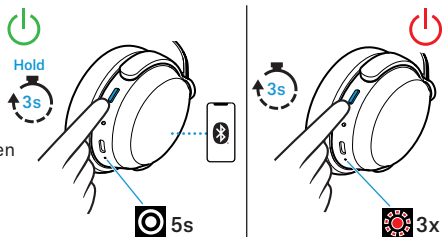



## Pairing

DE Koppeln  
FR Appairer  
ES Sincronizar  
PT Emparelhar  
NL Koppelen  
IT Accoppiare  
DA Parring  
SV Parkoppla  
FI Pariliitoksen muodostaminen  
EL Ζεύξη  
PL Parowanie  
TR Eşleştirme  
RU Сопряжение  
JA 連結  
ZH-HANS 配对  
ZH-HANT 配對  
KO 페어링  
ID Menyandingkan

1.

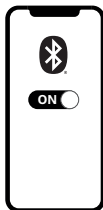

2.

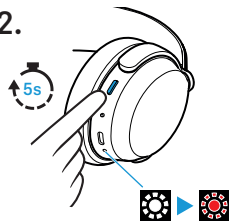

3.



4.

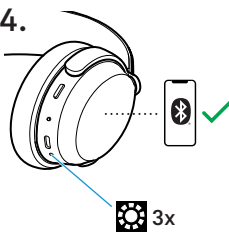



## Music control

- DE Musiksteuerung  
FR Contrôle de la musique  
ES Control de música  
PT Controlo/Controle da música  
NL Muziekbediening  
IT Gestione della musica  
DA Musikstyring  
SV Musikstyring  
FI Musiikin toiston ohjaus  
EL Χειρισμός αναπαραγωγής μουσικής  
PL Sterowanie muzyką  
TR Müzik kumandası  
RU Управление воспроизведением музыки  
JA 音楽制御  
ZH-HANS 音乐控制器  
ZH-HANT 音樂控制器  
KO 음악 제어  
ID Pengaturan musik

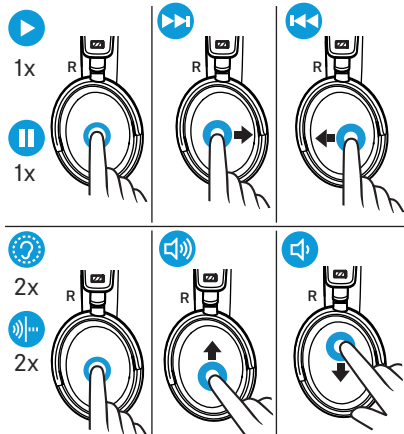



## Call control

- DE Anrufsteuerung  
FR Contrôle des appels  
ES Control de llamadas  
PT Controlo/Controle de chamadas  
NL Belbesturing  
IT Gestione delle chiamate  
DA Opkaldsstyring  
SV Samtalsstyrning  
FI Puhelujen ohjaus  
EL Χειρισμό κλήσεων  
PL Sterowanie rozmowami telefonicznymi  
TR Çağrı kontrolü  
RU Управление вызовами  
JA 電話制御  
ZH-HANS 来电控制器  
ZH-HANT 來電控制器  
KO 통화 제어  
ID Pengaturan panggilan

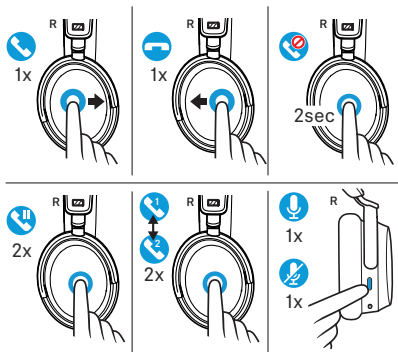



## Adaptive Noise Cancellation

- DE Aktive Geräuschunterdrückung  
FR Annulation active du bruit  
ES Atenuación activa del ruido  
PT Controlo/Controle ativo de ruído  
NL Actieve ruisonderdrukking  
IT Soppressione attiva dei rumori  
DA Aktiv støjundertrykkelse  
SV Aktiv brusreducering  
FI Aktiivinen melunvaimennus  
EL Ενεργή καταστολή θορύβου  
PL Aktywne tłumienie hałasu  
TR Etkin Gürültü Bastırma  
RU Система активного шумоподавления  
JA アクティブノイズキャンセリング  
ZH-HANS 主动降噪  
ZH-HANT 主動降噪  
KO 능동 소음 억제  
ID Peredaman kebisingan aktif

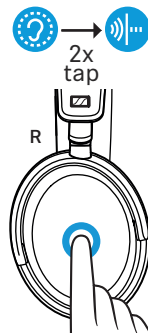





## Transparency Mode

- DE Hören von Umgebungsgeräuschen  
FR Écouter les bruits ambiants  
ES Escuchar el ruido ambiental  
PT Escutar ruídos externos  
NL Horen van omgevingsgeluiden  
IT Ascolto di rumori ambientali  
DA Lyd fra omgivelsesstøj  
SV Lyssna på bakgrundsljud  
FI Ympäristön äänien kuuluvuus  
EL Ακρόαση θορύβων περιβάλλοντος  
PL Słyszanie dźwięków z otoczenia  
TR Çevre seslerini dinleyin  
RU Пропускание шумов окружающей среды  
JA 周辺ノイズを聞きます  
ZH-HANS 环境噪音控制  
ZH-HANT 控制環境噪音  
KO 주변 소리 듣기  
ID Mendengarkan suara di sekitar

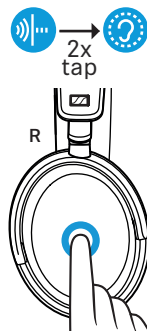



## Voice assistant

DE Sprachassistent  
FR Assistant vocal  
ES Asistente personal  
PT Assistente de voz  
NL Spraakassistent  
IT Assistente vocale  
DA Taleassistent  
SV Röstassistent  
FI Puheavustaja  
EL Φωνητικός βοηθός  
PL Asystent głosowy  
TR Sesli asistan  
RU Голосовой помощник  
JA 言語アシスト  
ZH-HANS 语音助手  
ZH-HANT 語音助手  
KO 음성 어시스턴트  
ID Bantuan bahasa

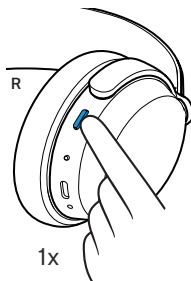

Siri, Google Assistant, ...



## Package includes

- DE Lieferumfang
- FR Contenu
- ES Volumen de suministro
- PT Material fornecido
- NL Omvang levering
- IT In dotazione
- DA Leveringsomfang
- SV Leveransomfattning
- FI Toimitussisältö
- EL Περιεχόμενα συσκευασίας
- PL Zakres dostawy
- TR Teslimat kapsamı
- RU Комплект поставки
- JA 同梱されているもの
- ZH-HANS 包装内含
- ZH-HANT 包裝包括
- KO 구성품
- ID Isi kemasan

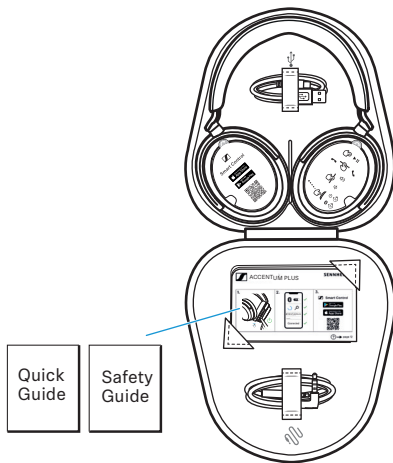

Quick  
Guide

Safety  
Guide

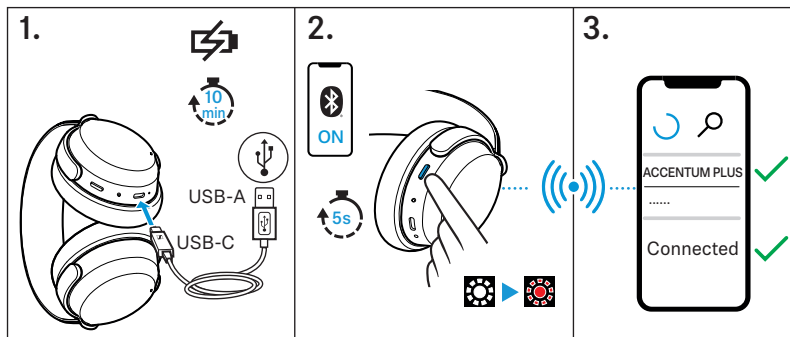

Sonova Consumer Hearing GmbH

Am Labor 1, 30900 Wedemark,  
Germany

[www.sennheiser-hearing.com](http://www.sennheiser-hearing.com)

Publ. 12/23, 596682/A01



Manual and support

[www.sennheiser-hearing.com/download](http://www.sennheiser-hearing.com/download)

