

# RETAVIS

( EN )

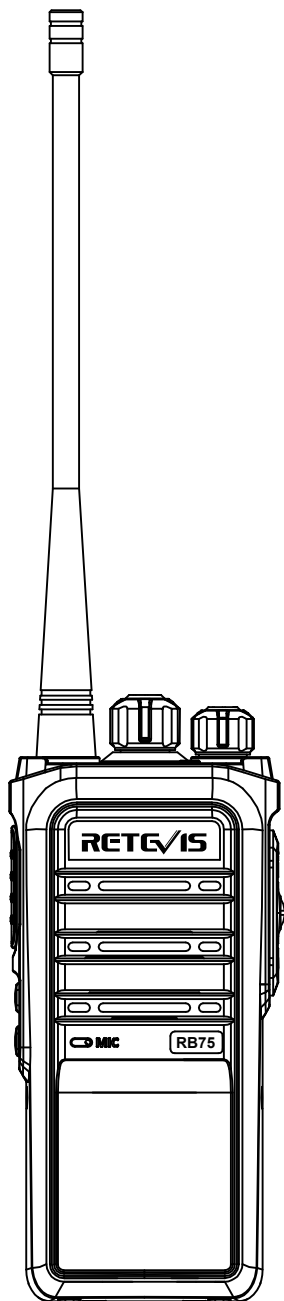

## **RB75** **Two Way Radio** **USER'S MANUAL**

## Safety notice

In order to your safe and efficient use of this walkie-talkie, please read the following information.

- ◆ The maintenance work of the walkie-talkie can only be carried out by professional and technical personnel, please do not disassemble the walkie-talkie by yourself.
- ◆ In order to avoid problems caused by electromagnetic interference or electromagnetic compatibility, please turn off the walkie-talkie in places where the "turn off the walkie-talkie" sign is affixed, such as hospitals and other healthcare and medical places. When taking an airplane, when the crew asks to turn off the walkie-talkie, please turn off the walkie-talkie.
- ◆ In a car with an airbag, do not place the walkie-talkie in the area that may be involved in the deployment of the airbag.
- ◆ Please turn off the walkie-talkie before entering the flammable and explosive environment.
- ◆ Do not replace or charge the battery in a flammable or explosive environment.
- ◆ Turn off the walkie-talkie before approaching the blasting zone and lightning zone.
- ◆ Do not use a walkie-talkie with a damaged antenna. The damaged antenna may cause slight burns if it touches the skin.
- ◆ Make sure that the antenna is correctly installed when the walkie-talkie is in use. A walkie-talkie without an antenna can easily damage the walkie-talkie when transmitting signals.
- ◆ When the portable walkie-talkie is transmitting, keep the walkie-talkie in a vertical position and keep the microphone about 5 cm away from the mouth.
- ◆ If you wear a portable walkie-talkie on your body, please make sure that the antenna is at least 2.5 cm away from your body when the walkie-talkie is transmitting.

## Battery

- ◆ If some conductive material on your body comes into contact with the exposed battery terminals, it may damage property and/or cause personal injury such as burns. These conductive materials include jewelry, keys or bead necklaces, which form a circuit with the battery (cause a short circuit), and quickly heat up and cause burns. Be cautious when handling charged batteries, especially when you put them in your pockets, purses, or other containers with metal objects. To reduce the risk of injury, the battery must not be exposed to fire, disassembled, or crushed.
- ◆ The maximum ambient temperature around the charger's power supply or transformer cannot exceed 40°C (104°F).
- ◆ When charging, turn off the power of the walkie-talkie with battery. Using the walkie talkie when charging prevents the battery from charging properly.
- ◆ Don't plug the walkie-talkie and battery into the charger when it is not needed. Continuous charging will shorten the battery life. Do not use the charger as a storage base for the walkie-talkie.
- ◆ In order to achieve the best use and safety effect, it is recommended to replace the battery after one year of use.

## Contents

Quick reference.....	1
Brief instructions for use.....	1
Open box to check.....	1
Battery information.....	2
Accessories installation.....	3
Familiar with this machine.....	3
Programmable buttons.....	4
LED indication.....	4
Basic operation.....	4
Channel settings.....	4
General functions and operations.....	4
Common failure phenomena and troubleshooting methods.....	5
warning.....	6
Warranty Card.....	9

## Quick reference

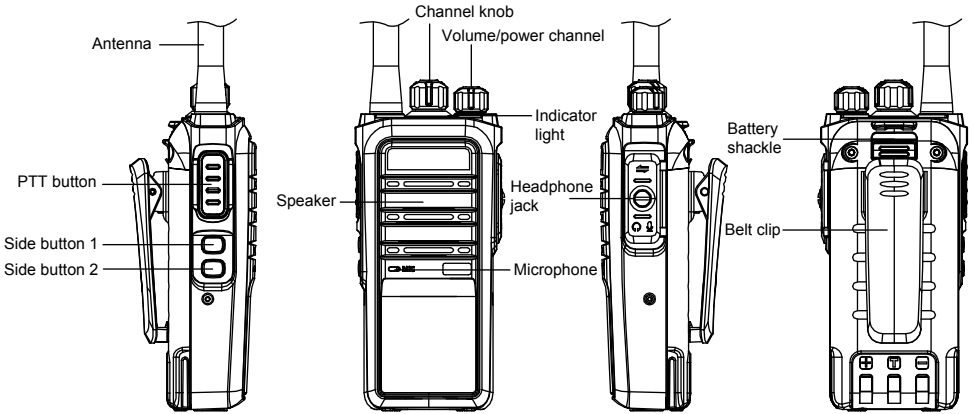

## Brief instructions for use

1. Power on: Turn the [Power/Volume] knob clockwise to power on.
2. Channel selection: Turn the [channel selection] knob to select the working channel.
3. Shut down: Turn the [Power/Volume] knob counterclockwise to shut down.
4. Side key function: Users can customize the side key long press and short press functions according to their needs. Please refer to 5.1 for the list of guillotine key functions

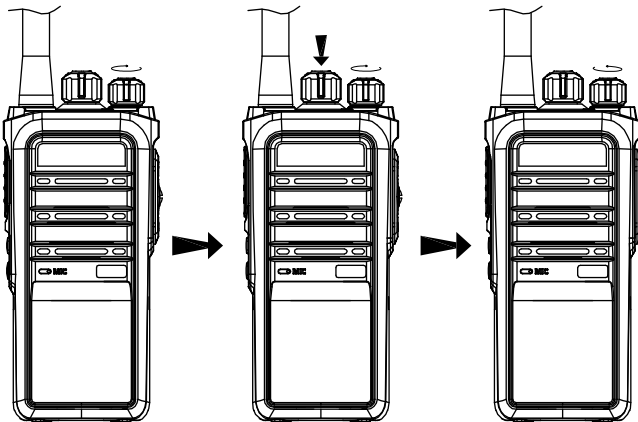

## 1 Open box to check

Please carefully open the box and confirm whether the box contains the items listed in the table below. If any items are missing or damaged, please contact your dealer in time.

## 1.1. Accessories

Package	Amount
Walkie talkie	1
Charger base	1
Battery	1
Belt clip	1
Sling	1
Manual	1

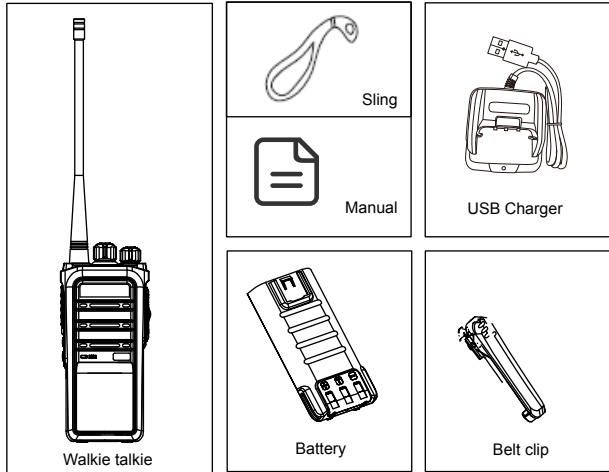

## 2. Battery information

### 2.1 Notes on charging

The optional battery is not charged at the factory. Please charge the battery before using it for the first time. If the battery has not been used for a long time or the battery is exhausted, please charge the battery before use. Two or three charge/discharge cycles can make the battery capacity reach the best condition. When the battery power is found to be low, the battery needs to be charged or replaced.

- ◆ Do not short-circuit the battery terminals or throw the battery into fire.
- ◆ When charging the battery into the walkie-talkie, turn off the walkie-talkie to ensure that the battery is fully charged.
- ◆ Don't leave the walkie-talkie and battery on the charger when not charging. Continuous charging will shorten the battery life.
- ◆ Do not put a fully charged battery back on the charger and then "power on", which may reduce the cycle life of the battery.
- ◆ Please try your best to keep the battery in an indoor environment of approximately 25°C. The battery is prone to failure in an environment where the temperature is lower than minus 10°C for a long time.
- ◆ When the temperature is higher than 35°C or lower than minus 10°C, the dischargeable capacity of the battery may be reduced, which is determined by the physical characteristics of the lithium battery.

### 2.2 Charging the battery

- (1) Plug the charging power adapter into an AC power outlet that meets the requirements.
- (2) Insert the cable of the charging stand into the adapter jack on the back of the adapter, the green indicator light is on.
- (3) Insert the battery to be charged or the walkie-talkie into the charging base.
- (4) Confirm that the battery is in reliable contact with the terminals of the charging base, and the red indicator light is on and charging starts.
- (5) After charging for about 6 hours, the red indicator light is off and the green indicator light is on, indicating that the battery is fully charged.
- (6) In the green light state, keep for 1~2 hours before removing the battery to achieve the best performance of the battery.
- (7) Remove the charging power adapter from the AC power outlet.

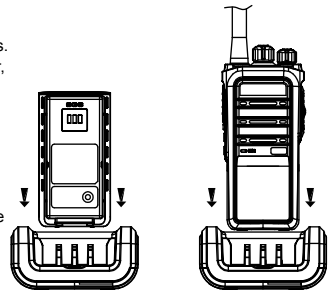

#### note:

- ◆ When leaving the factory, the battery of the walkie-talkie is not charged. Please charge the battery before using it for the first time.
- ◆ When the walkie-talkie is charged with battery, please turn off the walkie-talkie.
- ◆ The first charge of a new battery or the first charge of a battery stored for a long time (more than 2 months) should be repeated several times to reach the normal battery capacity, and the battery should be charged at least once every three months.
- ◆ When the battery is fully charged or the battery power is above the low-voltage alarm state of the walkie-talkie, do not charge the battery to avoid affecting battery life and performance. Please remove the battery from the charging stand after charging.
- ◆ When the walkie-talkie enters the low-voltage alarm state, please recharge the battery before using it, and do not force it on to use it, so as not to affect the battery life and performance.
- ◆ The lithium battery has a protection circuit inside. When the battery is too low, the power supply will be cut off. At this time, when charging on the charging stand, the indicator light will not light up immediately. After about 1-5 minutes, the charging indicator light will display.

### 3 Accessory installation

#### 3.1 Install/remove battery

##### ◆Install battery

- (1) Turn the volume switch to the off position.
- (2) Align the battery with the battery mount on the back of the walkie-talkie, and insert the battery.
- (3) Press the battery until the battery is pushed to the correct position and locked.

##### ◆Remove the battery

- (1) If you need to remove the battery, please turn off the walkie-talkie first.
- (2) Slide the battery push button to make the battery pop up automatically.
- (3) Remove the battery.

note:

- ◆Do not short-circuit the battery terminals or discard the battery in fire.
- ◆Do not disassemble the battery shell without authorization.

#### 3.2 Install/remove back clip

Align the buckle on the back clip with the slot on the back of the battery and push it in place along the bottom to fix it. When removing, press the push button of the back clip and push it out in the opposite direction to remove the back clip.

#### 3.3 Install the optional headset

When you need to use an external earphone to receive, first unscrew the fixing screw, then open the earphone cover to the outside, and align the plug of the earphone cable with the interface, finally, turn the fixing screw clockwise to use the headset

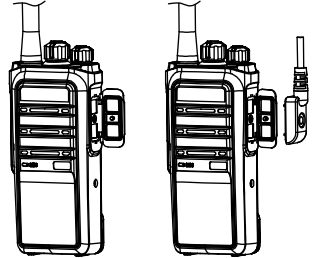

### 4 Familiar with the machine

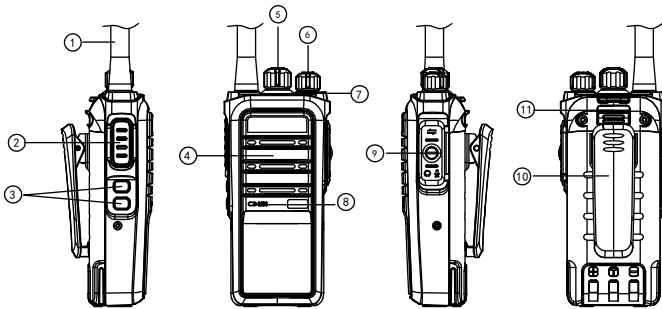

Number	Part Name
1	Antenna
2	PTT button Press PTT button to initiate a call and talk
3	Side button 1 (above) & Side button 2 (below) (programmable button) This button can be programmed to different functions by the dealer. For detailed functions, please refer to "5 Programmable Buttons".
4	Speaker Output voice.
5	Channel knob Turn this knob to select 1-30 channels.
6	Power/volume knob Turn clockwise to turn on the radio. To turn off the radio, turn it counterclockwise until you hear a "kada" sound. When turned on, turn this knob to adjust the volume.
7	LED indicate light The red light means the signal is transmitted; the green light means the signal is received; the red light flashing means the battery is insufficient.
8	Microphone Enter the voice.
9	External interface Open the cover to insert external speakers and microphones.
10	Belt Clip
11	Battery push button

## 5.1 Programmable buttons

In order to facilitate users to operate the walkie-talkie according to their own habits, this walkie talkie provides programmable keys (side keys) that can be programmed as function shortcut keys by the dealer.

Remarks:

Short press: Press and quickly release.

Long press: press and hold for a certain time.

Side button 1 short press: The default is the voice control function.

Side button 2 short press: The default is the scan function.

Number	Programmable function	use
1	Turn off	There is no response to the intercom when you press this button.
2	Static monitoring	If the current analog channel has sub-audio, press this key to switch to carrier squelch mode, that is, cancel the sub-audio function, and output sound when the carrier is matched, press again to return to the original state.
3	Scan	Turn on/off the scanning function and listen to communication activities on other channels.
4	VOX	Turn on/off the voice control function. When this function is turned on, speak at the MIC to make the walkie-talkie transmit.
5	Cancel squelch	Turn off the squelch function, and the current channel will always be monitored.
6	Type of newspaper	Switch the alarm sound

## 5.2 LED indication

Indicator status	Walkie-talkie working status
Red light on	transmitting
Green light on	Receiving signal
Red light flashing	The battery is low, it needs to be charged.
Green light flashing	Scanning channel

## 6 Basic operations

### 6.1 Turn on/off the radio

In the shutdown state, turn the [Power/Volume] knob clockwise until you hear a mechanical sound of "pa" to start the machine.

In the power-on state, turn the [Power/Volume] knob counterclockwise until you hear a mechanical sound of "pa" to turn it off.

### 6.2 Select channel

In standby mode, turn the [channel selection] knob to select the desired channel.

### 6.3 Adjust volume

When turned on, turn [Power Switch/Volume Control] clockwise to increase the volume, and turn counterclockwise to decrease the volume.

### 6.4 Initiate a call

Press the [PTT] key directly to initiate a call.

### 6.5 Receiving

When the walkie-talkie receives the radio frequency signal of the current channel, it reaches the squelch on level and the green LED lights up to indicate the carrier is received.

When an analog signal call on this channel is received, and the sub-audio of the call signal matches the sub-audio set of the channel of the local machine, or the sub-audio of the channel of the local machine is not set, the walkie-talkie will output the voice on the channel.

### 6.6 Reply to a call

After receiving the call, directly press the [PTT] key and speak into the microphone to reply.

## 7 Channel settings

- ◆Busy lock: When this function is turned on, if the current channel is used by others, the unit cannot transmit;
- ◆Scramble: When this function is turned on for both transmitting and receiving, the voice signal will be processed specially, and you can talk to each other, otherwise only some messy sounds can be heard. Using this function will sacrifice call quality;
- ◆Companding: a method to improve the quality of voice calls, depending on yourself whether it is turned on or not;

## 8 General functions and operations

### 8.1 Squelch level

This function requires dealers to set up through PC software. Level 0 opens squelch, and level 9 squelch is the deepest, which means that a stronger signal is needed to make the walkie-talkie work. The default squelch level is 3.

### 8.2 VOX level

This function needs to be set by the dealer through PC software. When the VOX function is turned on, set level 1, talking quietly can make the walkie-talkie transmit; set level 9, talking loudly can make the walkie-talkie transmit. The default VOX level is level 1.

### 8.3 VOX delay time

This function needs to be set by the dealer through PC software. Set the delay time of voice control. The default is 0.5S.

## 8.4 Scan channel

This function needs to be set by the dealer through PC software. Channel scanning can search for a signal channel. When there is a signal on the scanned channel, the walkie-talkie will stop on the channel for you to talk.

The scanning mode can be set to [Carrier] or [Time].

Set to [Carrier], that is, if the scanned channel has a signal, the walkie-talkie will always stay on this channel, and continue scanning when there is no signal.

Set to [Time], that is, the scanned channel has a signal, and the intercom will stay for a period of time. If the machine does not operate, it will continue to scan.

After the PC software is set up, by pressing the [Scan] shortcut key, the walkie-talkie can scan. When the walkie-talkie is in the scanning state, press the [Scan] shortcut key to stop scanning.

## 8.5 TOT

This function needs to be set by the dealer through PC software. The transmission time limit function prevents users from occupying the channel for too long. If the continuous transmission time exceeds the time programmed by the dealer, the two-way radio will stop transmitting and sound a warning tone. To stop the warning tone, release the [PTT] key. If you need to transmit again, you can press and hold the [PTT] key again.

## 9 Common failure phenomena and troubleshooting methods.

Number	Failure phenomenon	Causes and troubleshooting
1	Can't turn on	A. The battery is dead: please fully charge the dedicated charger and try again or replace with a new battery; B. Poor volume switch or other problems: please go to the designated repair station for repair;
2	The voice is too low	A. Too far away from the microphone of the walkie talkie when speaking: the best distance is 3-10cm; B. The volume setting is wrong: turn the volume switch clockwise to increase the volume;
3	Can't talk	A. The channel parameters are not set correctly: reset the parameters and try again; B. The group identity of the default call is incorrect: please select the correct person and try again; C. The call distance of the walkie talkie is exceeded;

## SPECIFICATIONS

GENERAL	
Channel:	30CH
Working voltage:	7.4V DC
Working temperature:	-25%~+60°C
Weight:	310g(including antenna and battery)
Dimension:	129X63X39mm
TRANSMITTER	
Frequency range:	GMRS
RF power:	5W/0.5W
Modulation type:	FM
Spurious radiation:	<-36dBm
Modulation noise:	>40dB
Modulation distortion:	<3%
Frequency stability:	2.5ppm
Max Fr. Deviation:	<5kHz
Current:	≤1.6A
Audio response:	+6.5~-14dB
Adjacent Ch. Power:	≥65dB
RECEIVER	
Frequency range:	GMRS
Receiving sensitivity:	<-121dBm
Occupied bandwidth:	≥2×3kHz
Selectivity:	>60dB
Inter mediation:	≥55dB
Audio power output:	1W@16R
Modulation distortion:	<3%@1W
Frequency stability:	2.5ppm
Current:	Current standby 55mA, working 300mA
Audio response:	+7~-12.5dB

## Frequency

CH.NO	RX Freq.(MHz)	TX Freq.(MHz)	CTCSS/DCS	ERP
1	462.5625	462.5625	67.0	5W
2	462.5875	462.5875	118.8	5W
3	462.6125	462.6125	127.3	5W
4	462.6375	462.6375	131.8	5W
5	462.6625	462.6625	136.5	5W
6	462.6875	462.6875	141.3	5W
7	462.7125	462.7125	146.2	5W
8	467.5625	467.5625	D243N	0.5W
9	467.5875	467.5875	D032N	0.5W
10	467.6125	467.6125	D047N	0.5W
11	467.6375	467.6375	D051N	0.5W
12	467.6625	467.6625	D053N	0.5W
13	467.6875	467.6875	D065N	0.5W
14	467.7125	467.7125	D116N	0.5W
15	462.5500	462.5500	123	5W
16	462.5750	462.5750	D743I	5W
17	462.6000	462.6000	D332I	5W
18	462.6250	462.6250	127.3	5W
19	462.6500	462.6500	D243I	5W
20	462.6750	462.6750	D606N	5W
21	462.7000	462.7000	D731I	5W
22	462.7250	462.7250	136.5	5W
23	462.5500	467.5500	136.5	5W
24	462.5750	467.5750	136.5	5W
25	462.6000	467.6000	136.5	5W
26	462.6250	467.6250	136.5	5W
27	462.6500	467.6500	136.5	5W
28	462.6750	467.6750	136.5	5W
29	462.7000	467.7000	136.5	5W
30	462.7250	467.7250	136.5	5W

**For further resources:** Brochures, Software/Firmware, Manual and Declaration-of-Conformity. Pls contact your direct reseller OR go to [web.retevis.com](http://web.retevis.com), and check "support" in the each product link to download it

# RF ENERGY EXPOSURE AND PRODUCT SAFETY GUIDE FOR PORTABLE TWO-WAY RADIOS



Before using this radio, read this guide which contains important operating instructions for safe usage and rf energy awareness and control for compliance with applicable standards and regulations.

This two-way radio uses electromagnetic energy in the radio frequency (RF) spectrum to provide communications between two or more users over a distance. RF energy, which when used improperly, can cause biological damage. All Retevis two-way radios are designed, manufactured, and tested to ensure they meet government-established RF exposure levels. In addition, manufacturers also recommend specific operating instructions to users of two-way radios. These instructions are important because they inform users about RF energy exposure and provide simple procedures on how to control it. Please refer to the following websites for more information on what RF energy exposure is and how to control your exposure to assure compliance with established RF exposure limits:<http://www.who.int/en/>

## Local Government Regulations

When two-way radios are used as a consequence of employment, the Local Government Regulations requires users to be fully aware of and able to control their exposure to meet occupational requirements. Exposure awareness can be facilitated by the use of a product label directing users to specific user awareness information. Your Retevis two-way radio has a RF Exposure Product Label. Also, your Retevis user manual, or separate safety booklet includes information and operating instructions required to control your RF exposure and to satisfy compliance requirements.

## Radio License

Governments keep the radios in classification, business two-way radios operate on radio frequencies that are regulated by the local radio management departments (FCC, ISED, OFCOM, ANFR, BFTK, Bundesnetzagentur...). To transmit on these frequencies, you are required to have a license issued by them. The detailed classification and the use of your two radios, please contact the local government radio management departments.

Use of this radio outside the country where it was intended to be distributed is subject to government regulations and may be prohibited.

## Unauthorized modification and adjustment

Changes or modifications not expressly approved by the party responsible for compliance may void the user's authority granted by the local government radio management departments to operate this radio and should not be made. To comply with the corresponding requirements, transmitter adjustments should be made only by or under the supervision of a person certified as technically qualified to perform transmitter maintenance and repairs in the private land mobile and fixed services as certified by an organization representative of the user of those services.

Replacement of any transmitter component (crystal, semiconductor, etc.) not authorized by the local government radio management departments equipment authorization for this radio could violate the laws.

## FCC Requirements:

This device complies with part 15 of the FCC Rules. Operation is subject to the condition that this device does not cause harmful interference. (Licensed radios are applicable);

This device complies with part 15 of the FCC Rules. Operation is subject to the following two conditions: (Other devices are applicable)

- (1) This device may not cause harmful interference, and
- (2) This device must accept any interference received, including interference that may cause undesired operation.

### NOTE:

•This equipment has been tested and found to comply with the limits for a Class A digital device, pursuant to part 15 of the FCC Rules. These limits are designed to provide reasonable protection against harmful interference when the equipment is operated in a commercial environment. This equipment generates, uses, and can radiate radio frequency energy and, if not installed and used in accordance with the instruction manual, may cause harmful interference to radio communications. Operation of this equipment in a residential area is likely to cause harmful interference in which case the user will be required to correct the interference at his own expense.

•This equipment has been tested and found to comply with the limits for a Class B digital device, pursuant to part 15 of the FCC Rules. These limits are designed to provide reasonable protection against harmful interference in a residential installation. This equipment generates, uses and can radiate radio frequency energy and, if not installed and used in accordance with the instructions, may cause harmful interference to radio communications. However, there is no guarantee that interference will not occur in a particular installation. If this equipment does cause harmful interference to radio or television reception, which can be determined by turning the equipment off and on, the user is encouraged to try to correct the interference by one or more of the following measures:

- Reorient or relocate the receiving antenna.
- Increase the separation between the equipment and receiver.
- Connect the equipment into an outlet on a circuit different from that to which the receiver is connected.
- Consult the dealer or an experienced radio/TV technician for help.

## CE Requirements:

•(Simple EU declaration of conformity) Shenzhen Retevis Technology Co., Ltd. declares that the radio equipment type is in compliance with the essential requirements and other relevant provisions of RED Directive 2014/53/EU and the ROHS Directive 2011/65/EU and the WEEE Directive 2012/19/EU; the full text of the EU declaration of conformity is available at the following internet address: [www.retevis.com](http://www.retevis.com).

### •Restriction Information

This product can be used in EU countries and regions, including: Belgium (BE), Bulgaria (BG), Czech Republic (CZ), Denmark (DK), Germany (DE), Estonia (EE), Ireland (IE), Greece (EL), Spain (ES), France (FR), Croatia (HR), Italy (IT), Cyprus (CY), Latvia (LV), Lithuania (LT), Luxembourg (LU), Hungary (HU), Malta (MT), Netherlands (NL), Austria (AT), Poland (PL), Portugal (PT), Romania (RO), Slovenia (SI), Slovakia (SK), Finland (FI), Sweden (SE) and United Kingdom (UK).

For the warning information of the frequency restriction, please refer to the package or manual section.



## •Disposal

The crossed-out wheeled-bin symbol on your product, literature, or packaging reminds you that in the European Union, all electrical and electronic products, batteries, and accumulators (rechargeable batteries) must be taken to designated collection locations at the end of their working life. Do not dispose of these products as unsorted municipal waste. Dispose of them according to the laws in your area.



## IC Requirements:

Licence-exempt radio apparatus

This device contains licence-exempt transmitter(s)/receiver(s) that comply with Innovation, Science and Economic Development Canada's licence-exempt RSS(s). Operation is subject to the following two conditions:

- (1) This device may not cause interference.
  - (2) This device must accept any interference, including interference that may cause undesired operation of the device.
- Le présent appareil est conforme aux CNR d'Industrie Canada applicables aux appareils radio exempts de licence. L'exploitation est autorisée aux deux conditions suivantes :

- (1) l'appareil ne doit pas produire de brouillage;
- (2) l'utilisateur de l'appareil doit accepter tout brouillage radioélectrique subi, même si le brouillage est susceptible d'en compromettre le fonctionnement.

## RF Exposure Information

- DO NOT operate the radio without a proper antenna attached, as this may damage the radio and may also cause you to exceed RF exposure limits. A proper antenna is the antenna supplied with this radio by the manufacturer or an antenna specifically authorized by the manufacturer for use with this radio, and the antenna gain shall not exceed the specified gain by the manufacturer declared.
- DO NOT transmit for more than 50% of total radio use time, more than 50% of the time can cause RF exposure compliance requirements to be exceeded.
- During transmissions, your radio generates RF energy that can possibly cause interference with other devices or systems. To avoid such interference, turn off the radio in areas where signs are posted to do so.
- DO NOT operate the transmitter in areas that are sensitive to electromagnetic radiation such as hospitals, aircraft, and blasting sites.
- Portable Device, this transmitter may operate with the antenna(s) documented in this filing in Push-to-Talk and body-worn configurations. RF exposure compliance is limited to the specific belt-clip and accessory configurations as documented in this filing and the separation distance between user and the device or its antenna shall be at least 2.5 cm.
- Mobile Device, during operation, the separation distance between user and the antenna subjects to actual regulations, this separation distance will ensure that there is sufficient distance from a properly installed externally-mounted antenna to satisfy the RF exposure requirements.
- Occupational/Controlled Radio, this radio is designed for and classified as "Occupational/Controlled Use Only", meaning it must be used only during the course of employment by individuals aware of the hazards, and the ways to minimize such hazards; NOT intended for use in a General population/uncontrolled environment.
- General population/uncontrolled Radio, this radio is designed for and classified as "General population/uncontrolled Use".

## RF Exposure Compliance and Control Guidelines and Operating Instructions

To control your exposure and ensure compliance with the occupational/controlled environment exposure limits, always adhere to the following procedures.

### Guidelines:

- User awareness instructions should accompany the device when transferred to other users.
- Do not use this device if the operational requirements described herein are not met.

### Operating Instructions:

- Transmit no more than the rated duty factor of 50% of the time. To Transmit (Talk), push the Push to Talk (PTT) button. To receive calls (listen), release the PTT button. Transmitting 50% of the time, or less, is important because the radio generates measurable RF energy exposure only when transmitting in terms of measuring for standards compliance.
- Transmit only when people outside the vehicle are at least the recommended minimum lateral distance away from a properly installed according to installation instructions, externally mounted antenna.
- When operating in front of the face, worn on the body, always place the radio in a Retevis approved clip, holder, holster, case, or body harness for this product. Using approved body-worn accessories is important because the use of Non-Retevis approved accessories may result in exposure levels, which exceed the IEEE/ICNIRP RF exposure limits.

### Hand-held Mode

- Hold the radio in a vertical position with the microphone (and other parts of the radio including the antenna) at least 2.5 cm (one inch) away from the nose or lips. The antenna should be kept away from the eyes. Keeping the radio at a proper distance is important as RF exposure decreases with increasing distance from the antenna.



### Phone Mode

- When placing or receiving a phone call, hold your radio product as you would a wireless telephone. Speak directly into the microphone.

## Electromagnetic Interference/Compatibility

**NOTE:** Nearly every electronic device is susceptible to electromagnetic interference (EMI) if inadequately shielded, designed, or otherwise configured for electromagnetic compatibility

## Avoid Choking Hazard



Small Parts. Not for children under 3 years.

## Turn off your radio power in the following conditions:



**WARNING**

- Turn off your radio before removing (installing) a battery or accessory or when charging battery.
  - Turn off your radio when you are in a potentially hazardous environments: Near electrical blasting caps, in a blasting area, in explosive atmospheres (inflammable gas, dust particles, metallic powders, grain powders, etc.).
  - Turn off your radio while taking on fuel or while parked at gasoline service stations.
- To avoid electromagnetic interference and/or compatibility conflicts
- Turn off your radio in any facility where posted notices instruct you to do so, hospitals or health care facilities (Pacemakers, Hearing Aids and Other Medical Devices) may be using equipment that is sensitive to external RF energy.
  - Turn off your radio when on board an aircraft. Any use of a radio must be in accordance with applicable regulations per airline crew instructions.

### Protect your hearing:



**WARNING**

- Use the lowest volume necessary to do your job.
- Turn up the volume only if you are in noisy surroundings.
- Turn down the volume before adding headset or earpiece.
- Limit the amount of time you use headsets or earpieces at high volume.
- When using the radio without a headset or earpiece, do not place the radio's speaker directly against your ear
- Use careful with the earphone maybe possible excessive sound pressure from earphones and headphones can cause hearing loss

**Note:** Exposure to loud noises from any source for extended periods of time may temporarily or permanently affect your hearing. The louder the radio's volume, the less time is required before your hearing could be affected. Hearing damage from loud noise is sometimes undetectable at first and can have a cumulative effect.



### Avoid Burns



**WARNING**

#### Antennas

- Do not use any portable radio that has a damaged antenna. If a damaged antenna comes into contact with the skin when the radio is in use, a minor burn can result.

#### Batteries (If appropriate)

- When the conductive material such as jewelry, keys or chains touch exposed terminals of the batteries, may complete an electrical circuit (short circuit the battery) and become hot to cause bodily injury such as burns. Exercise care in handling any battery, particularly when placing it inside a pocket, purse or other container with metal objects

#### Long transmission

- When the transceiver is used for long transmissions, the radiator and chassis will become hot.

### Safety Operation



#### Forbid

- Do not use charger outdoors or in moist environments, use only in dry locations/conditions.
- Do not disassemble the charger, that may result in risk of electrical shock or fire.

**WARNING**

- Do not operate the charger if it has been broken or damaged in any way.
- Do not place a portable radio in the area over an air bag or in the air bag deployment area. The radio may be propelled with great force and cause serious injury to occupants of the vehicle when the air bag inflates.

#### To reduce risk

- Pull by the plug rather than the cord when disconnecting the charger.
- Unplug the charger from the AC outlet before attempting any maintenance or cleaning.
- Contact Retevis for assistance regarding repairs and service.
- The adapter shall be installed near the equipment and shall be easily accessible

### Approved Accessories



**WARNING**

- Contact Retevis for assistance regarding repairs and service.
- The adapter shall be installed near the equipment and shall be easily accessible
- This radio meets the RF exposure guidelines when used with the Retevis accessories supplied or designated for the product. Use of other accessories may not ensure compliance with the RF exposure guidelines and may violate regulations.
- For a list of Retevis-approved accessories for your radio model, visit the following website: <http://www.Retevis.com>

## Guarantee

Model Number: \_\_\_\_\_

Serial Number: \_\_\_\_\_

Purchasing Date: \_\_\_\_\_

Dealer: \_\_\_\_\_ Telephone: \_\_\_\_\_

User's Name: \_\_\_\_\_ Telephone: \_\_\_\_\_

Country: \_\_\_\_\_ Address: \_\_\_\_\_

Post Code: \_\_\_\_\_ Email: \_\_\_\_\_

### Remarks:

1. This guarantee card should be kept by the user, no replacement if lost.
2. Most new products carry a two-year manufacturer's warranty from the date of purchase.  
Further details, pls read <http://www.retevis.com/after-sale/>
3. The user can get warranty and after-sales service as below:
  - Contact the seller where you buy.
  - Products Repaired by Our Local Repair Center
4. For warranty service, you will need to provide a receipt proof of purchase from the actual seller for verification

### Exclusions from Warranty Coverage:

1. To any product damaged by accident.
2. In the event of misuse or abuse of the product or as a result of unauthorized alterations or repairs.
3. If the serial number has been altered, defaced, or removed.



**CE FC RoHS**



**Shenzhen Retevis Technology Co.,Ltd.**

Add: 7/F, 13-C, Zhonghaixin Science&Technology Park, No.12 Ganli  
6th Road, Jihua Street, Longgang District, Shenzhen, China

Web: [www.retevis.com](http://www.retevis.com)

E-mail: [kam@retevis.com](mailto:kam@retevis.com)

Facebook: [facebook.com/retevis](https://facebook.com/retevis)



MADE IN CHINA

## 说明书要求

尺寸：145\*210mm

印刷：黑白印刷

装订：骑马订

纸张材质：双胶纸

**本页无需印刷**