

六折页 单面90x170mm 材质120G 双铜

SAFETY PRECAUTIONS

- When the room temperature is below 32°F / 0°C, please empty the water tank. If the water is allowed to turn to ice it can damage the components.
- Please use purified or distilled water so that your atomizer will not be damaged due to impurities in the water. If you use normal tap water, you may receive a white buildup of calcium or lime in the diffuser.
- The maximum water volume is 16.9 oz/500 ml. Exceeding the max capacity will affect the atomization effect or cause water leakage and damage to the machine.
- Do not let water splash into the base to avoid damaging the internal parts.
- After you use, please check the remaining water in the water tank to prevent damage to the motor. Do not leave your water sitting in the tank for several days without use.
- When adding or adding water to the device, always remove the AC adapter from the outlet. Do not touch or remove the AC adapter with wet hands. Doing so may cause electric shock or injury.
- Do not replace the power cord without authorization.
- In case of abnormality, do not attempt to disassemble or repair the device yourself. Please contact the manufacturer for assistance or instructions. Please stop operation and send an email to support for help.

WARNING Cancer and Reproductive Harm
www.p65warnings.ca.gov

PARTS

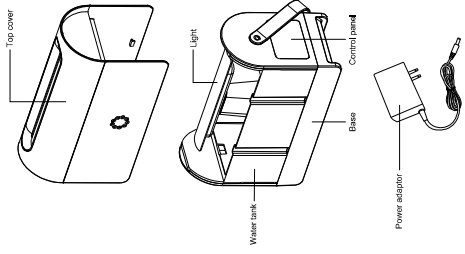

Note: The accessories in the package are exclusively used for the product. The appearance and quantity may be different for different batches. Please contact support if you have any questions.

SPECIFICATIONS

Model	LF500MS
Rated Voltage	DC 24V
Rated Power	12W
Water Tank Capacity	500 ml / 16.9 oz
Mist Output	35-65 ml/hr
Timer Setting	1-8 hours
Weight	2.0 lbs
Dimensions	9.4 x 3.9 x 8.3 in

OPERATION

- Remove the top cover.
 - Add water to the max fill line.
 - Add 2-5 drops of scented essential oil directly to the tank if needed.
- Note:
- The maximum water volume is 16.9 oz/500 ml. Exceeding the max capacity will affect the atomization effect or cause water leakage and damage to the machine.
 - When adding or adding water to the device, always remove the AC adapter from the outlet. Do not touch or remove the AC adapter with wet hands. Doing so may cause electric shock or injury.
 - Do not replace the power cord without authorization.
- Water so that your atomizer will not be damaged due to impurities in the water. If you use normal tap water, you may receive a white buildup of calcium or lime in the diffuser. While not harmful, these deposits may cause a white powdery deposit on the surface of the diffuser. These deposits can be cleaned with distilled white vinegar.

3. Place the top cover back onto the diffuser.

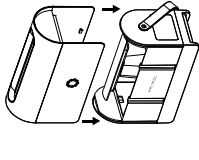

4. Insert the power adapter cord.



5. Press the power button and you will hear a beep sound. The standard settings are as follows:
Brightness: High
Lighting effect: Full Bright

6. Entering the Wi-Fi connection mode. Make sure your Wi-Fi router supports 2.4GHz (NOT 5GHz) and 802.11b/g/n bands.

Note: Most routers can also be set to 2.4GHz band or dual band. Make sure you have a 2.4GHz band. A smartphone or tablet supporting a 2.4GHz network. Download the App named AIRA from the App Store (iOS devices) or Google Play (Android devices).



Step 1 Long press the **Power** on the control panel, and the **Wi-Fi** on the screen will blink quickly.



Step 2 Press the phone to the 2.4 GHz network, you will see diffuser will use. Open AIRA and use the "Wi-Fi" icon in the top left corner. It will appear an added page, click "Go to add".



Step 3 Press the add steps. Enter the password when prompted (same Wi-Fi network on which your smartphone is connected) and then click confirm.

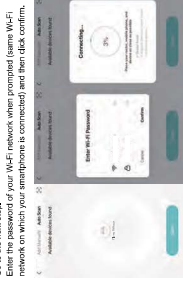

Preparation note: The flame diffuser must be connected to a 2.4 GHz Wi-Fi network. If your router is not connected to a 2.4 GHz Wi-Fi network, please refer to your router user manual to learn how to select the 2.4 GHz Wi-Fi band.

Step 4 Press the Wi-Fi icon is now connected successfully. You can find the diffuser in the device list.

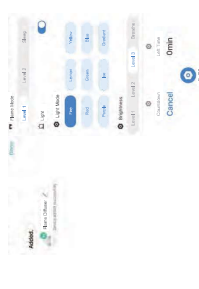

CONTROL Panel



Function selection	Operation
Switch	Power on / Power off
Timer or start delay	Timer: 1-8 hours Start delay: 1-8 hours Start the power cable, press the icon to start the timer. To cancel the start delay timer, press the power switch
Light brightness	1: Low 2: Medium 3: High 4: Max (Full Bright)
Lighting effect	Flame, Rain, Snow, Star, Rain-Clear, Blue-Purple, Red-Gradient
Mist level	1: Low (soft flame effect) 2: High (vapor flame effect) 3: Sleep mode (light on with low mist level)
Low water icon	Unit automatically power off (Click power switch to cancel the low water warning. The diffuser will restart after water refilling)

- Note:
- Powering on, there will be a beep sound.
 - There will be a beep each time you press a button.
 - When there is no water in the tank you will hear 2 beeps over 5 seconds and the diffuser will automatically power down. The low water icon will appear on the control panel.
 - When the timer is up you will hear a long beep sound before the diffuser automatically shuts down.

Mode control with AIRA app

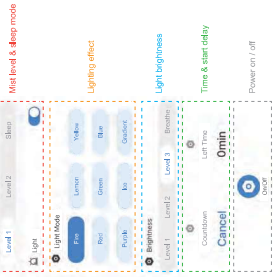

CLEANING INSTRUCTIONS

- Clean the water remaining in the water tank. Ensure the air outlet side is facing up during cleaning to avoid moisture getting inside the diffuser.
- Do not use any benzene, paint thinner, alcohol, or other types of chemicals during cleaning. Doing so may cause damage to the machinery.
- Use a soft cloth to clean the diffuser. Do not use detergents, chlorine, acid, and enzyme-type detergents remaining inside the diffuser. It is recommended for cleaning.
- If you do not intend to use the product for an extended period of time, clean it and dry it thoroughly before storage.

TROUBLESHOOTING

Symptom	Possible Causes	Approach
The power indicator light on the diffuser cannot be started	No power The water tank is short of water or too full. The water tank will fluctuate	Received the power adaptor and try again
The indicator light is on, but there is no mist produced	Too much water The water level is too high	Add purified water to the tank
The humidifier emits a weird smell	There is scale in the water tank and the water has evaporated, or the water has been left in the tank for too long	Pour water lower than the max capacity line, clean the water tank, and use distilled water
Too little mist produced	There is scale in the water tank and the water has evaporated, or the water has been left in the tank for too long	Remove the scale in the water tank and place it in a container. Clean the water tank. Use distilled water
The diffuser is too noisy	Too much water Too little water	Pour water lower than the max capacity line, clean the water tank, and use distilled water. Add water to the tank
The above methods cannot be improved. Please contact the customer service for assistance.		

FCC STATEMENT

This device complies with Part 15 of the FCC Rules. Operation is subject to the following two conditions:
1. This device may not cause harmful interference, and
2. This device must accept any interference received, including interference that may cause undesired operation.
Any changes or modifications not expressly approved by the party responsible for compliance could void the user's authority to operate this equipment.
This device complies with the requirements for Class B digital devices, pursuant to Part 15 of the FCC Rules. These limits are designed to provide reasonable protection against harmful interference in a residential installation. This equipment generates, uses and can radiate radio frequency energy and, if not properly used, may cause harmful interference to radio communications. However, there is no guarantee that interference will not occur in a particular installation. If this equipment does cause harmful interference to radio or television reception, you can stop the interference by one of the following measures:
• Reorient or relocate the receiving antenna.
• Increase the separation between the equipment and receiver.
• Connect the equipment to an AC outlet on a circuit different from that to which the receiver is connected.
• Consult the dealer or an experienced radio/TV technician for help.

FCC RADIATION EXPOSURE

This equipment complies with FCC radiation exposure limits set forth for an uncontrolled environment. End users must follow the specific operating instructions as documented in this manual. This transmitter must not be co-located or operated in conjunction with any other antenna or transmitter. The maximum permissible exposure (MPE) limit for the diffuser is 0.08 W/kg (averaged over 30 min) between the radiator and your body. The availability of some specific channels and/or operational frequency bands are country dependent, and are firmware programmed at the factory to match the intended destination. The firmware setting is not accessible by the end user.

LIMITED WARRANTY

We provide a 1-year warranty. For more information, please visit www.airthermal.com/warranty.

- What's not covered?**
Defects due to faulty materials and/or workmanship of the product.
- Changes caused by the owner** when attempting to fix or altering the product, damage caused by misuse, abuse, neglect, alterations or unauthorized repair.
- Normal degradation.**
- Warranty Period**
This limited warranty is effective from the date of original purchase and will last for 1 year.
- Who's covered?**
The limited warranty is only effective for the original purchaser, it is non-transferable.
- How to request warranty services?**
If you have any questions or need warranty services, please email support@airthermal.com. Our customer service will address your needs to the best of its ability.

ATTRIBUTIONS

Apple App Store is a trademark of Apple Inc., registered in the U.S. and other countries. The Google Play logo is a trademark of Google LLC. Amazon, Alexa and all related logos are trademarks of Amazon.com, or its affiliates in the U.S. and other countries. The Bluetooth word mark and logos are registered trademarks owned by Bluetooth SIG, Inc. and used here under license from Bluetooth SIG, Inc. All other marks and logos are the property of their respective owners.



FLAME DIFFUSER

MODEL: LF500MS

USER MANUAL

Please read the manual carefully before use and keep it for future reference.

