

# Introduction Manual



Invisible Wireless Charger

Model: H40D

### **Warning**

1. The charging distance is 15-45mm. Please don't place the phone directly above the charger when testing, otherwise there may be a red light flashing and unable to charge.
2. The smart sticker is necessary, it helps you locate the charger and concentrate the energy that is needed to charge.
3. The AC adapter is for the wireless charger ONLY! Please DO NOT charge your phone!

## **Product Introduction**

XE45 is a long-distance wireless charging device that can wirelessly charge mobile phones through surfaces of 15-45mm. It works for non-metallic surface such as marble, wood, glass, quartz, etc, and can be placed under the desktop. It can be used at home, office, hotel and many other places.

## **Before Installation**

1. Please make sure you are using the adapter that comes with the package.
2. Please make sure your phone case doesn't contain metal, centrally located magnets, card holders, pop sockets and kick stands. If it does, charge your phone with the phone case removed.

Sensor Template\* 1  
(With positioning  
light indicator)

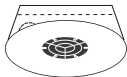

Smart Desk Sticker \* 1

Skin Colors Sticker \* 4



Cable Clips \* 2

Wireless Charger \* 1

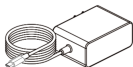

Adapter \* 1

## Installation Steps

Please make sure that the table surface is not made of metal and is less than 45 mm thick.

### 1 Install the charger

Remove the adhesive covers, and mount the wireless charger in your favourite position under your desk.

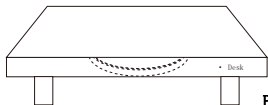
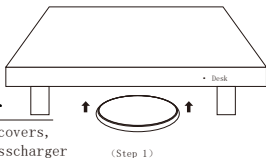

### 3 Fold the alignment template

Fold the sensor template up along the indentation line. (notice: do not stick this part to the desk at this time yet).

### 2 Plug in the adapter

Plug in the adapter and check if the green light is always on.

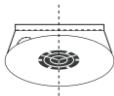

4

**Locate the charging position**

Place the sensor template on the desk, and move towards the lights, and continuously adjust the position until all 6 LEDs light up. Remove the adhesive cover at the back, and stick the template on the desk.

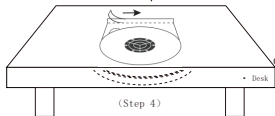

5

**Stick the smart sticker**

Remove the adhesive backing from the smart desk sticker and place it carefully in the blank area. Remove the sensor template.

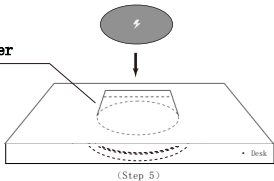

# 6

## Choose skin colors sticker

The skin colors sticker are used to match your desktop color better. Please cover it on the gray smart desk sticker.

**THEY CANNOT BE USED ALONE!**

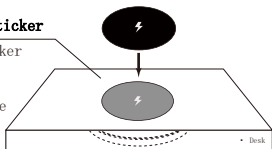

(Step 5)

# 7

## Easy charging begins

Place your phone in the center, easy charging begins!

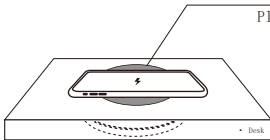

(Step 6)

Input: 24VIA      Charging distance: 15-45mm(0.59"-1.77")

Output: 10W(MAX)      Size: 106\*106\*10mm

Note: Please choose a table top installed on non-metallic materials such as marble, wood, glass, etc., and the thickness is within 45mm.

## **Safety Tips**

1. Do not pull the power cord forcibly to avoid breaking or falling off the power cord.
2. Do not throw it into fire or water to avoid short-circuit leakage.
3. Do not use H40D in severe high temperature, humid or corrosive environment to avoid leakage of electricity due to damage to the circuit.

## **Precautions**

1. Do not place metal debris or magnetic cards on the wireless charging table, which may cause damage or the charger will not work.
2. During use, if the receiving coil or the transmitting board is overheated to stop charging, please remove the charging device and try again after cooling down.

# Product After-sales Guide

Thank you for purchasing our XE45 wireless charger. In order to ensure you get reliable after-sales service, please read the following carefully.

## FAQ

Q: Is the desk sticker necessary?

A: Yes, it is very necessary.

The sticker greatly extends the charging distance. At the same time, it will better improve the charging efficiency and prevent overheating.

Q: Is it important to align the desk sticker with the charger?

A: Yes, it is crucial.

Only when aligned can the charge work properly and efficiently. Otherwise, it won't work or charge inefficiently, with overheating problems.

Please use the sensor template to assist alignment.

Q: Why does it not work when I put my phone directly on the charger?

A: The charging range is 15-45mm, below or beyond which it will not work.

Please use the charger together with the desk sticker to charge within the recommended range.

Q: Can the charger work properly under the marble table?

A: Yes, the charger can work normally.

It can penetrate all kinds of tabletop except metal, with a maximum thickness of 45mm.



## FCC Warning

This device complies with part 15 of the FCC Rules. Operation is subject to the following two conditions:

- (1) This device may not cause harmful interference, and
- (2) this device must accept any interference received, including interference that may cause undesired operation.

Any changes or modifications not expressly approved by the party responsible for compliance could void the user's authority to operate the equipment.

NOTE: This equipment has been tested and found to comply with the limits for a Class B digital device, pursuant to Part 15 of the FCC Rules. These limits are designed to provide reasonable protection against harmful interference in a residential installation. This equipment generates, uses and can radiate radio frequency energy and, if not installed and used in accordance with the instructions, may cause harmful interference to radio communications. However, there is no guarantee that interference will not occur in a particular installation.

If this equipment does cause harmful interference to radio or television reception, which can be determined by turning the equipment off and on, the user is encouraged to try to correct the interference by one or more of the following measures:

- Reorient or relocate the receiving antenna.
- Increase the separation between the equipment and receiver.
- Connect the equipment into an outlet on a circuit different from that to which the receiver is connected.
- Consult the dealer or an experienced radio/TV technician for help.

### FCC Radiation Exposure Statement

The device has been evaluated to meet general RF exposure requirement.

## Warranty

The product fails to work normally or malfunctions during normal use, and can enjoy our company's after-sales service commitment after being certified by our company.

The following conditions are not covered by the warranty:

1. The accessories are not warranted;
2. Failure due to improper operation by the user;
3. Failures caused by accidental disasters, man-made damage, self-disassembly, unpacking, and repairs by non-authorized maintenance centers of the company.

