

BONIDY

A10

Active Noise Cancellation
Earbuds User Guide



1 Package content

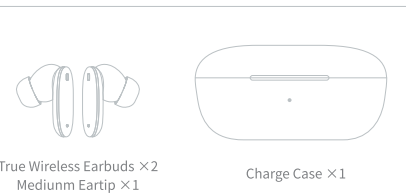

2 Overview

Earbuds

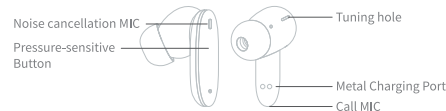

Charging Case

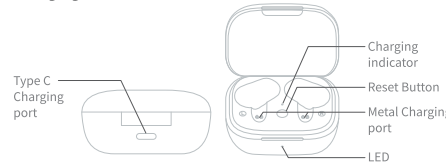

3 Fitting

1. Select eartips of the most fitting size provided (large, medium, small).
2. Please install the fitting eartips on the earphone.
3. Wear the earbuds.
Pick up the earbud accordingly (R/L).

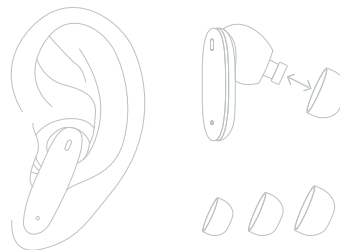

4 Instruction

1. Initial Use

Please put the earphone into the charging box to charge.

2. Pairing

Open the device's Bluetooth to search "A10" and hear the "dong dong" sound after to connect.

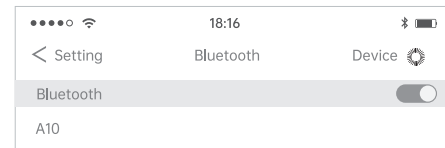

- ※ Either earbud can be used separately.
- ※ The earbuds can be automatically re-connected to the last connected devices.

5 Technical Specification

Item Number	A10
Bluetooth Version	BT 5.2
Speaker diameter	12mm
Wireless Range	10M
Sensitivity	117dB±3dB
Frequency response Range	20Hz-20KHz
Impedance	28Ω
Battery Type	Lithium ion Battery
Earbuds Capacity	3.7V/40mAh
Charging box battery capacity	3.7V/520mAh
Playtime	ANC ON 5.5hrs, ANC OFF 6.5hrs
Playtime with charging case	ANC ON 25 hrs, ANC OFF 30hrs
Charging Time	Charging case 2.5hrs, earbuds 1.2hrs

※ Battery Life :
Due to different systems, audio formats, personal usage habits (such as volume) of mobile phones and other devices, the battery life may vary for the specific situation

6 Operation

Function		Left Ear	Right Ear	Voice Prompt
Music Control	Play/Pause	Press	Press	"Du"
	Previous Song	Press Two		"Du"
	Next Song		Press Two	"Du"
Call Control	Answer	Press	Press	"Du"
	Hang up	Press Two	Press Two	"Du"
	Reject	Press for 1-2 Seconds	Press for 1-2 Seconds	"Du"
ANC/Transparency mode, On/Off	ANC ON		Press for 2 Seconds	"ANC Mode"
	ANC OFF		Press for 2 Seconds	"Normal Mode"
	Transparency ON	Press for 2 Seconds		"Transparency Mode"
	Transparency OFF	Press for 2 Seconds		"Normal Mode"
Three-way calling	If there is a second call, one press to answer the second call, Triple-press to switch between the first call and the second call, or long press to reject the second call, and double-press to end the call			
Power Off	Earphone power below 20%, low power to remind once, "Du Du". low power fast shutdown, low power to remind once. "Du Du"			"Du Du"

ANC Features

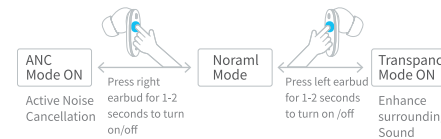

Charging

Two ways to charge charging case
Connect charging case with USB-C Cable to charge



※ Note: Wireless charger not included.

- >50%
Open the charging case, Green light is always on for 3 seconds when is above 50% power
- 20%~50%
Open the charging case, Orange light is always on for 3 seconds when is 20-50% power
- <20%
Open the charging case, the orange light flashes fast for 3s when is below 20% power.

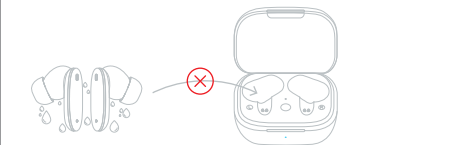
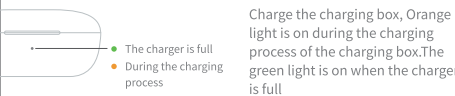

7 FAQ

- The earbuds do not turn on.**
Pls confirm the earbuds have power first, if not charged pls charge up and the power on.
- Unsuccessful Bluetooth Pairing.**
Make sure the earbuds are turned on and in pairing state, the pairing distance is kept within 1m.
- Some Bluetooth Devices Require a pairing Password.**
Please enter "0000"
- Automatically Re-connect.**
When power on, it will automatically re-connect to the last connected device.
- How long will it turn off automatically when it doesn't connect?**
The earbuds will automatically turn off after 5 mins if it doesn't connect with other Bluetooth devices.
- When the earbuds cannot be charged.**
Pls wipe the earbuds metal charging spots.
- Why I can't open ANC Mode?**
Pls press the right earbuds to turn on the ANC Mode.

8 Note

- This product contains a built-in lithium battery. Do not expose the product to strong sunlight or fire or it might explode. Dispose of the battery according to local regulations. Do not dispose of it as domestic waste.
- Do not remove or replace the product battery unless doing so is specified in the User Manual or in the Quick Start Guide, or you might damage the product.
CAUTION: RISK OF EXPLOSION IF BATTERY IS REPLACED BY AN INCORRECT TYPE. DISPOSE OF USED BATTERIES ACCORDING TO THE INSTRUCTIONS.
- Do not disassemble or refit the earphone for any reason as you may damage it or void the warranty.
- Avoid contact with liquid to avoid serious damage to the earphone. The manufacturer does not cover water damage.
- Avoid temperatures above 75 degrees and below minus 40 degrees.
- Keep the indicator light away from children's and animals' eyes.
- Do not use this product during thunderstorms to avoid electric shocks.

CE Note

Model number A10
Operation Temperature -10 °C to +45 °C
Storage Temperature -20 °C to +65 °C

This device is a portable device. To comply with RF exposure requirements, a minimum separation distance of 0cm must be maintained between the user's head and ear, including the antenna. Use only the supplied or an approved antenna. This device in compliance with the essential requirements and other relevant provisions of Directive 2014/53/EU. All essential radio test suites have been carried out.

- CAUTION : RISK OF EXPLOSION IF BATTERY IS REPLACED BY AN INCORRECT TYPE. DISPOSE OF USED BATTERIES ACCORDING TO THE INSTRUCTIONS;**
 - The device complies with RF specifications when the device is used at 0mm from your body.
- Declaration of Conformity



This device is a 2.4 GHz wideband transmission system, intended for use in all EU member states and EFTA countries.

RF working band (BR+EDR) 2.402-2.480 GHz
Maximum output RF power (BR+EDR) 7 dBm
RF working band (BLE) 2.402-2.480 GHz
Maximum output RF power (BLE) -4 dBm



Listen at reasonable volumes for reasonable periods of time. Excessive sound pressure from earphones and headphones can cause hearing loss.

9 Aftersales policy

Warranty period: one year warranty from the date of purchase.

The name and content of hazardous substances in the product

Part Name	Hazardous substances or elements					
	Pb	Hg	Cd	Cr(VI)	PBB	PBDE
Circuit template	○	○	○	○	○	○
Plastic Parts	○	○	○	○	○	○
Trumpet	○	○	○	○	○	○
Battery	○	○	○	○	○	○
Appendix	○	○	○	○	○	○

FCC ID: 2A3N5-A10

Federal Communications Commission (FCC) Statement. This device complies with part 15 of the FCC Rules. Operation is subject to the following two conditions:

- (1) This device may not cause harmful interference, and
- (2) this device must accept any interference received,

including interference that may cause undesired operation. Note: This equipment has been tested and found to comply with the limits for a Class B digital device, pursuant to part 15 of the FCC Rules. These limits are designed to provide Reasonable protection against harmful interference in a residential installation. This equipment generates, uses and can radiate radio frequency energy and, if not installed and used in accordance with the instructions, may cause harmful interference to radio communications. However, there is no guarantee that interference will not occur in a particular installation. If this equipment does cause harmful interference to radio or television reception, which can be determined by turning the equipment off and on, the user is encouraged to try to correct the interference by one or more of the following measures:

- Reorient or relocate the receiving antenna.
- Increase the separation between the equipment and receiver.
- Connect the equipment into an outlet on a circuit different from that to which the receiver is connected.
- Consult the dealer or an experienced radio/TV technician for help.

Warning: Changes or modifications made to this device not expressly approved by **Ancsonic (chongqing) Electronic Science & Technology Co., Ltd** may void the FCC authorization to operate this device. Note: The manufacturer is not responsible for any radio or TV interference caused by unauthorized modifications to this equipment. Such modifications could void the user's authority to operate the equipment.

RF exposure statement:

The device complies with the RF exposure requirement and can be installed and used without restriction.