

# LED BLUETOOTH MUSIC LIGHT STRIP

SSG-402

## User Instruction



### How to connect one set of light strip?

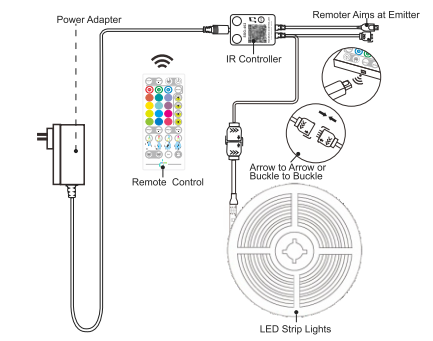

### How to connect two sets of light strip?

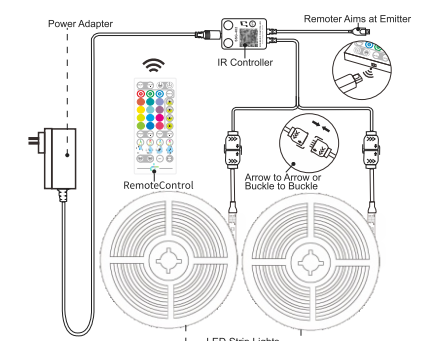

(Please don't connect two sets of LED strip lights in series directly)

### INSTALLATION

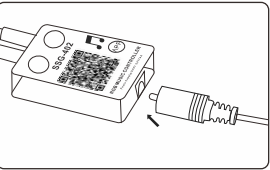

STEP 1: Connect the IR Receiver to the Power Adapter

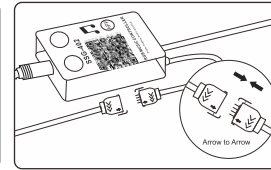

STEP 2: Arrow to Arrow or Buckle to Buckle

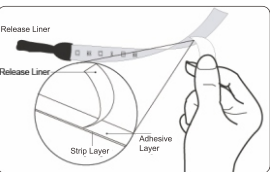

STEP 3: Tear off the plastic on the adhesive tape and stick the strip to any smooth, clean and dry places.



⚠ Please make sure the surface smooth, dry and clean. DON NOT stick the led strip on the surface, such as knotted/wool fabrics, dust wall, rough plastic surface, frosted glass.

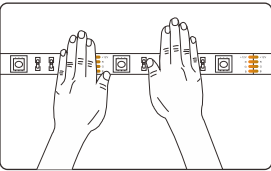
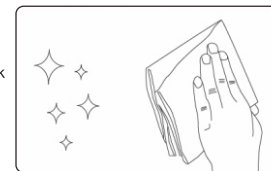

STEP 4: Stick the LED Strip and press the whole LED Strip. (You can also use the rubber buckles to fix the strip.)

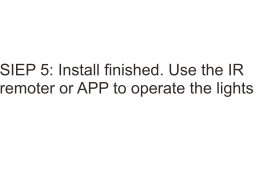

STEP 5: Install finished. Use the IR remoter or APP to operate the lights

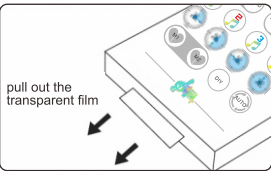

⚠ Please pull out the transparent film from the bottom of the remote to ensure that the battery is powered properly.

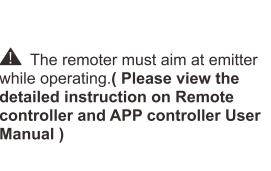

⚠ The remoter must aim at emitter while operating. (Please view the detailed instruction on Remote controller and APP controller User Manual )

### WARNING

⚠ Do not connect to the power supply before installation.

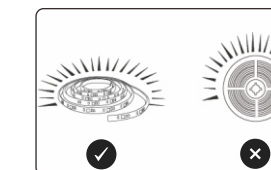
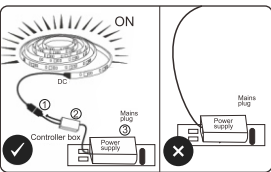

⚠ Please spread out the light strip before connecting the power supply.

### DIY LED STRIPS

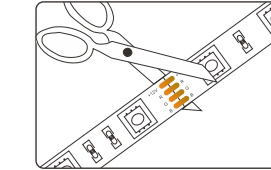

How to cut the LED Strip  
1. Please cut the LED strip through the lines marked on it.  
2. The 12V low voltage LED strip can be cut in every 3 LEDs.

### APP QR Code Infrared Receiver RGB Port Microphone Hole DC 4.5-24V



### IR Remote Controller

fine-tuning of colors (36 kinds of colors cycle switching).

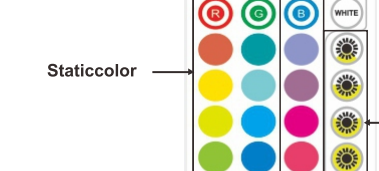

Staticcolor

Speed adjustment

4 Rhythm switches

Timing off

Storage memory mode

Brightness adjustment

Dynamic mode switching

Mode automatic In Cycle

DIY mode customization

First press the DIY button, select the color and brightness or mode you need, press M1 or M2 to confirm, the current status is retained. Press M1/M2 again to call up the current status.

### APP Operation



### Control with your phone

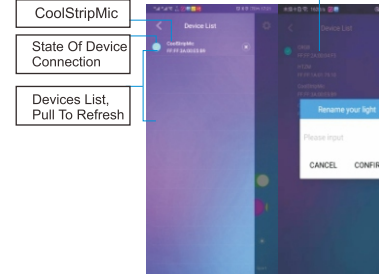
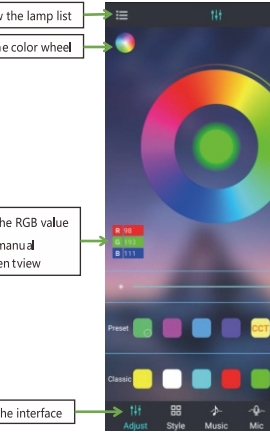

On the device page, swipe down to search for Bluetooth devices, and the searched devices will be loaded into the list. Click on any item to connect to control the device.

### WARNING

- ★ DO NOT IMMERSE IN FIRE
- ★ Note: The product cannot be excessively bent or stacked for use, which may cause damage to the lamp.

**FCC Warning Statement**

Changes or modifications not expressly approved by the party responsible for compliance could void the user's authority to operate the equipment. This equipment has been tested and found to comply with the limits for a Class B digital device, pursuant to Part 15 of the FCC Rules. These limits are designed to provide reasonable protection against harmful interference in a residential installation. This equipment generates uses and can radiate radio frequency energy and, if not installed and used in accordance with the instructions, may cause harmful interference to radio communications. However, there is no guarantee that interference will not occur in a particular installation. If this equipment does cause harmful interference to radio or television reception, which can be determined by turning the equipment off and on, the user is encouraged to try to correct the interference by one or more of the following measures:

- Reorient or relocate the receiving antenna.
- Increase the separation between the equipment and receiver.
- Connect the equipment into an outlet on a circuit different from that to which the receiver is connected.
- Consult the dealer or an experienced radio/TV technician for help.