



For use with the listed garage door openers manufactured (TABLE BELOW). The garage door opener activates when the programmed button on the remote control is pressed. The remote control can activate a garage door opener.

**Make sure the garage door opener has a working light bulb because it is a programming indicator.**

**WARNING:** This product can expose you to chemicals including lead, which are known to the State of California to cause cancer or birth defects or other reproductive harm. For more information go to [www.P65Warnings.ca.gov](http://www.P65Warnings.ca.gov)

**Package includes:**

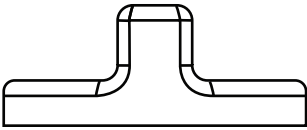

Locking tool

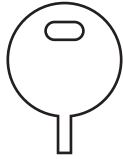

Programming safety pin

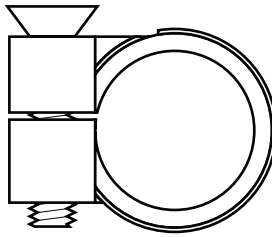

Handlebar clamp & screw

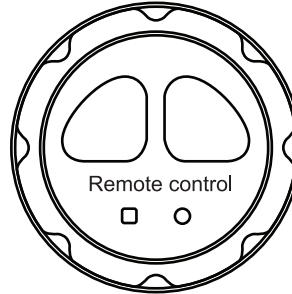

## PREPARE

Locate the **LEARN BUTTON** on the garage door opener. NOTE: Your garage door opener may look different.

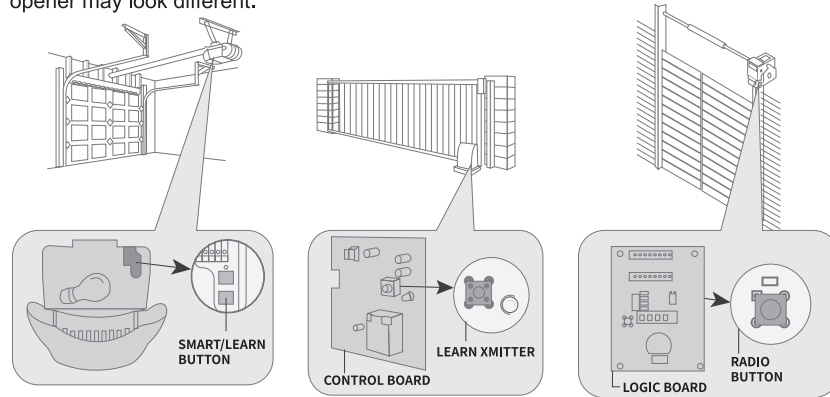

Locate the **PROGRAM BUTTON** on the remote control.

Locate your model of garage door opener in the table below to determine the number of button presses needed to program the remote control.

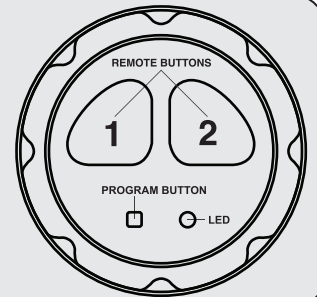

## PROGRAMMING THE REMOTE

**1** Using the provided safety pin, press and hold the **PROGRAM BUTTON** on the remote control until the **LED** on the front of the remote control turns on. This mode will last one minute.

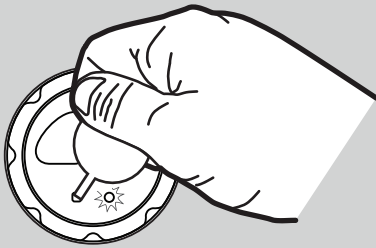

**2** Press and release the **REMOTE BUTTON** the number of times that corresponds with the garage door opener type:

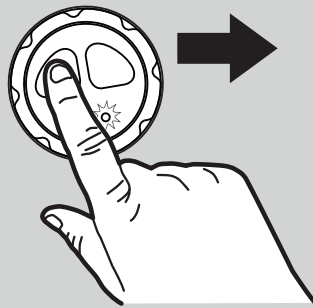

**3** To exit programming mode, press **PROGRAM BUTTON**.



**4** Press and release the **LEARN BUTTON** on the garage door opener.

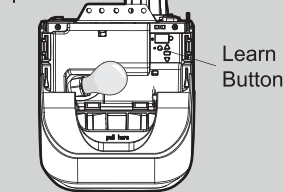

The Learn LED will light. Within 30 seconds...

**5** Press the **REMOTE BUTTON** programmed in step 2 until the garage door opener lights flash or two clicks are heard.

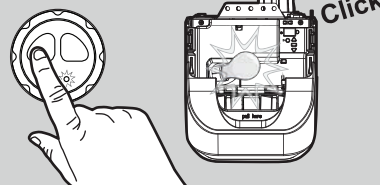

**6** To test, press the **REMOTE BUTTON** on the remote control... Repeat process for button 2 for a different door.

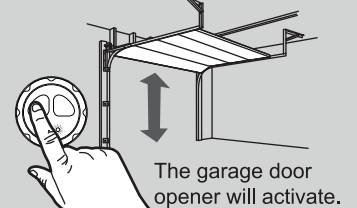

## WARNING

To prevent possible **SERIOUS INJURY** or **DEATH** from a moving gate or garage door:

- ALWAYS keep remote controls out of reach of children. NEVER permit children to operate or play with remote controls.
- Activate gate or door **ONLY** when it can be seen clearly, is properly adjusted and there are no obstructions to door travel.
- ALWAYS keep gate or garage door in sight until completely closed. NEVER permit anyone to cross path of moving gate or door.

## INSTALLING REMOTE CONTROL ON STEM

1. Ensure the stem and handlebars are installed, aligned, and torqued according to manufacturer's recommendations.
2. Remove the original top cap and mounting bolt.
3. Install Doormate 2 top cap on top of the stem.
4. Install, but do not fully tighten, M6 x 30mm bolt.
5. Install Doormate 2. Set the top cap mount to your desired position.
6. Remove the Doormate 2 with the locking tool.
7. Carefully tighten the top cap bolt (M6 x 30mm bolt) according to the manufacturer's recommendations for the headset.
8. Install Doormate 2 remote with locking tool.

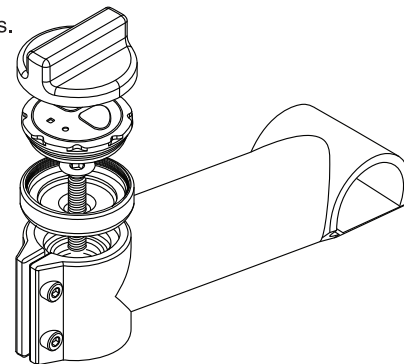

## INSTALLING REMOTE CONTROL ON HANDLEBAR

1. Install handlebar clamp in the desired location on the handlebar.
2. Align the Doormate 2 top cap to the top of the handlebar clamp.
3. Install, but do not fully tighten, M6 x 30mm bolt.
4. Install Doormate 2. Set the top cap mount to your desired position.
5. Remove the Doormate 2 with the locking tool.
6. Carefully tighten the top cap bolt (M6 x 30mm bolt) to the handlebar clamp.
7. Install Doormate 2 remote with locking tool.

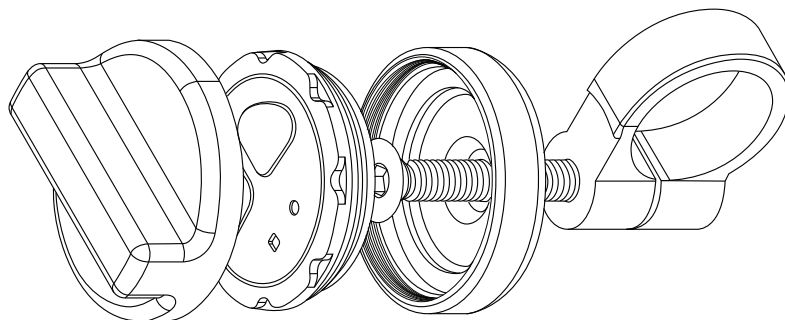

## HOW TO USE THE REMOTE CONTROL

Press and hold the **REMOTE BUTTON** down until the door or gate starts to move. Installations and conditions vary, contact an installing dealer for more information.

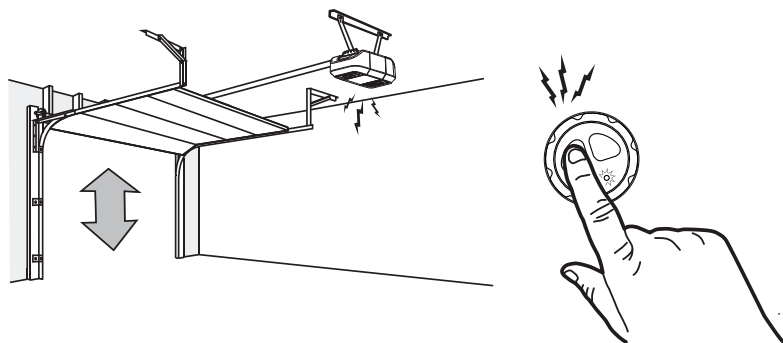

## BATTERY

The **LED(s)** on your remote control will stop flashing when the battery is low and needs to be replaced. To replace battery, open the case as shown. Remove the Doormate 2 remote from the top cap with the locking tool(1). Unscrew end cap counter-clockwise to expose the battery tray(2). Insert battery positive side down(+) in the end cap. Replace only with CR2032 battery(3). Dispose of old battery properly.

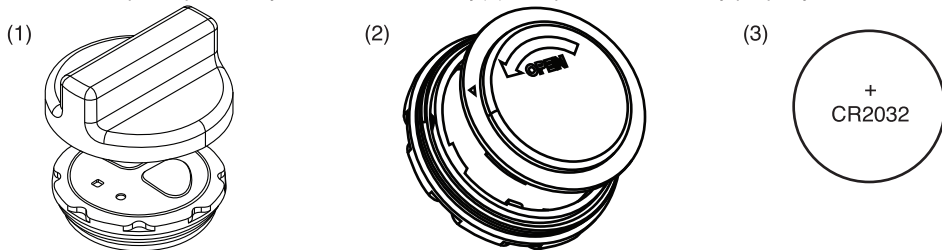

## WARRANTY

### ONE YEAR LIMITED WARRANTY

Twelve Speed Products warrants to the first consumer purchaser of this product that it is free from defect in materials and/or workmanship for a period of 1 year from the date of purchase.

**NOTICE:** To comply with FCC, adjustment or modifications of this receiver and/or transmitter are prohibited, except for changing the code setting or replacing the battery.

**THERE ARE NO OTHER USER SERVICEABLE PARTS.**

#### FCC Statement:

Any Changes or modifications not expressly approved by the party responsible for compliance could void the user's authority to operate the equipment. This device complies with part 15 of the FCC Rules. Operation is subject to the following two conditions:

- (1) This device may not cause harmful interference, and
- (2) This device must accept any interference received, including interference that may cause undesired operation.

**Note:** This equipment has been tested and found to comply with the limits for a Class B digital device, pursuant to part 15 of the FCC Rules. These limits are designed to provide reasonable protection against harmful interference in a residential installation. This equipment generates, uses and can radiate radio frequency energy and, if not installed and used in accordance with the instructions, may cause harmful interference to radio communications. However, there is no guarantee that interference will not occur in a particular installation. If this equipment does cause harmful interference to radio or television reception, which can be determined by turning the equipment off and on, the user is encouraged to try to correct the interference by one or more of the following measures:

- Reorient or relocate the receiving antenna.
- Increase the separation between the equipment and receiver.
- Connect the equipment into an outlet on a circuit different from that to which the receiver is connected.
- Consult the dealer or an experienced radio/TV technician for help.

#### RF warning for Portable device:

The device has been evaluated to meet general RF exposure requirement. The device can be used in portable exposure condition without restriction.

## ⚠ WARNING

To prevent possible **SERIOUS INJURY** or **DEATH**:

- **NEVER** allow small children near batteries.
- If battery is swallowed, immediately notify doctor.
- Replace **ONLY** with CR2032 battery.
- **DO NOT** recharge, disassemble, heat above 212° F (100° C) or incinerate.