

Wireless FM transmitter

User Manual

Packing List

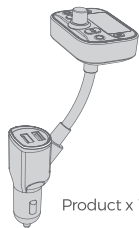

Product x 1

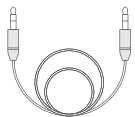

AUX Cable x 1



User Manual x 1

Specifications

Product Name:	CZ552
Operating Voltage:	12-24V
Effective Distance:	5 m
FM Tuning Range:	87.5MHz - 108.0MHZ
QC3.0 quick charge Output port:	DC 3.5-6.5 V/3 A,6.5-9 V/2 A, 9-12 V/1.5 A
PD30W quick charge Output port:	5V/3A, 9V/3A, 12V/2.5A
Support Audio Format:	MP3,WMA,WAV,FLAC ,AAC
Support Bluetooth Protocol:	A2DP/ AVRCP/ HSP/ HFP

Product Structure

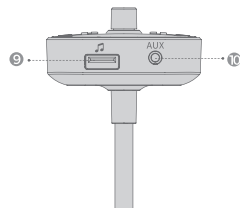
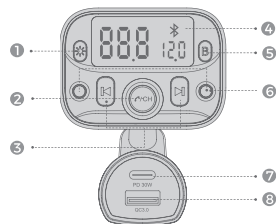

1. RGB light / Voice assistance
2. FM frequency adjustment / Music play,pause / Receive,hang up, reject a call / Redial the last number / Volume adjustment
3. Previous track/ Next track
4. LCD display screen (FM/ Tire pressure/ Bluetooth)
5. Power button/EQ deep bass
6. Dual microphones
7. PD30W charging port
8. QC3.0 quick charging port
9. USB port
10. Aux cable port

How to use

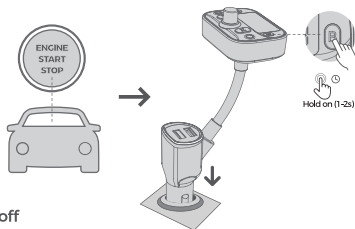

Turn on/off

Power On: Start your car and plug CZ552 into cigarette lighter. The product will power on after that. If CZ552 is in power-off state while being electrified, long press the "B" button for 1 second to turn it on.

Turn off: Cut its power and it'll turn off. In power-on state, long press the "B" button for 1 second to turn it off.

Note: When CZ552 is off via long pressing B button, its charging ports still work for charging.

FM Tuning

- 1 Tune to a blank frequency. For example: 88.8



FM 88.8

Adjust the frequency

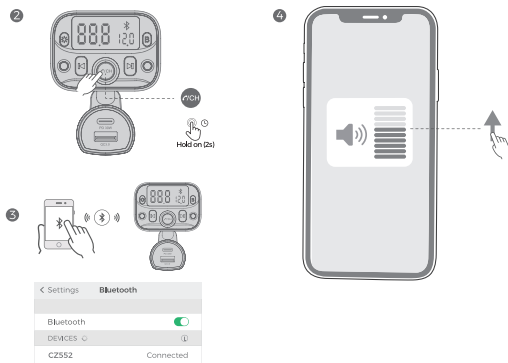

1. Start the car, adjust the car's FM to a blank FM frequency (a FM frequency that has not been occupied), such as FM88.8

2. Adjust CZ552 into a blank FM frequency with same one of your car, such as FM88.8

Long press CH button (CH) for 2 s to enter into FM tuning mode, and the LCD display screen will flash. Rotate the ring knob to adjust the frequency. Rotate clockwise/anticlockwise to increase/decrease frequency.

Meanwhile, there are 2 other ways to adjust frequency:

Method 2: Precise Tuning - Short press ► / ◀ button to increase / decrease frequency;

Method 3: Quick Tuning - Long press ► / ◀ button to increase / decrease frequency

3. Bluetooth Connection: Enable Bluetooth on the smart device, search "CZ552" and click to connect; (When you use CZ552 again, it'll reconnect the last-connected device automatically.)

4. Please adjust the volume of the mobile device appropriately.

Attention: for the initial use, you need to adjust the blank FM frequency of CZ552 to be the same as that of your car (Not a frequency of local broadcast/A frequency without any broadcast). For seeking a better sound enjoyment, please make sure that the blank FM frequencies of BH649 and your car are the same when every time you use the product (Not a frequency of local broadcast).

Music Playing Operation

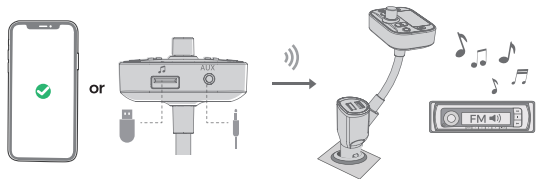

Important notice:

1. Please ensure successful input/out connection before using this function ;
2. To guarantee a smooth operation, please adopt only one audio method each time when you play the audio.

1. Audio Sources: Bluetooth / AUX in mode / U disk

A. Bluetooth mode: After Bluetooth connected successfully with your smart device(such as a smartphone) , play music on the smart device and the music can be synchronized to the in-car speaker.

B. AUX in mode: Connect Bluetooth FM transmitter to the smart device (such as a smartphone) via a 3.5 mm audio cable. Then, the in-car speaker can play music.

C. U disk mode: Insert the U disk, and Bluetooth FM transmitter will recognize automatically and play the music.

2. Music Playing Operation

A. Play/Pause: short press **⏸** button

B. Previous track/ Next Track: short press **⏮** and **⏭** button

C. Increase Volume: Rotate knob button clockwise.

D. Decrease Volume: Rotate knob button anticlockwise.

E. In U disk mode: long press **⏮** button to rewind or long press **⏭** button to fast forward.

3. Source Switch

A. Switch between Bluetooth/U disk: long press 2s the next song **▶** button to switch to Bluetooth/U disk

B. Automatic play option via U disk: Plug and play; play in order



C. Power-off memory: Reboot the product after power off, and it will enter the previous playing mode (In U disk mode, it will play music automatically; In Bluetooth mode, you need to play music manually).

4. Deepbass mode

Deepbass mode: short press the B button to enter the deepbass mode, the screen displays EQ1;

short press again to turn off the deepbass mode, the screen displays EQ0.

RGB lighting adjustment

Number of lighting colors: 9, including 7 single-color ring lights, 1 RGB static light, and 1 RGB dynamic light. Each time you press the light button , you can switch one light effect mode. Continuously short press the light button  to choose from 10 modes: RGB static, RGB dynamic, red, green, blue, yellow, purple, cyan, white, and light off; the RGB Lighting effect before power off will be remembered when the power is turned on again.

Hands-free Bluetooth Calling

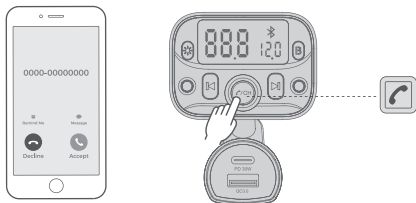

- A. Answer a call: short press  button
- B. Hang up a call: short press  button
- C. Reject a call: long press  button for 2s
- D. Redial the last number: double press  button

Voice Assistant

Long press the light  button for 1 second to enter or exit the voice assistant.

Friendly Tips:

For Android devices, when you're going to use your voice to directly wake up the voice assistant, please turn up your phone's and CZ552's volume to their maximum volume level first, and adjust the car speaker's volume according to your needs.

For iPhone, the instructions of "Hey Siri" function can refer to following:

Note: This function is not available for some phone brands. (Supported phone brands are iPhone, Samsung phones and original Android phones).

A. Turn on Siri settings on your phone.

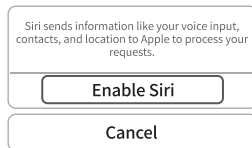
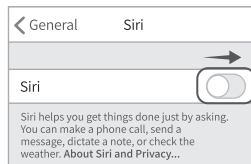
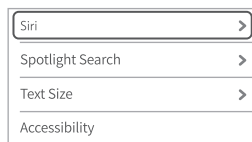
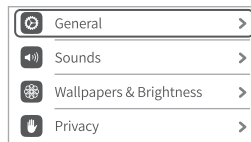

B. Complete the voice recognition according to Siri instructions.

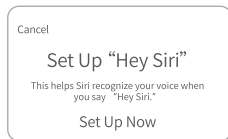

C. Use Siri function direct on your phone.

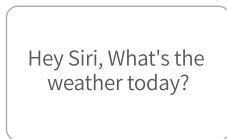

Note: This function is not available for some phone brands. (Supported phone brands are iPhone, Samsung phones and original Android phones)

Charging Description

QC3.0 charging port

A. For smart devices that do not support quick charge, the default output is 5 V/2.4 A.

B. For smart devices that support quick charge, the maximum charging voltage and current of QC3.0 are DC3.6-6.5V/3A, 6.5-9 V/2 A, 9-12 V/1.5 A.

PD charging port

A. For smart devices that do not support PD quick charge, the default output is 5 V/3A, For smart devices that support PD quick charge, meet PD 30W fast charging protocol: DC5V/3A, 9V/3A, 12V/2.5A.

B. (Please use Type-C to C data cable, or Type-C to Lighting data cable)

Note: Does not support simultaneous PD and QC3.0 fast charging.

Note

1. Do not turn up your radio's volume too loud in case of increasing its background noise.
2. Although the transmitting power of our FM transmitter is strong, for ensuring the best sound effect, please try to avoid adjusting to the frequency of local radio station with strong signal.
3. Do not use the product in too hot/cold, dusty or damp environment.
4. Do not break or throw the product to prevent surface or unit damage.
5. Do not disassemble the product personally. Please contact seller if you have any questions or problems.

FCC Statement

Any Changes or modifications not expressly approved by the party responsible for compliance could void the user's authority to operate the equipment.

This equipment has been tested and found to comply with the limits for a Class B digital device, pursuant to part 15 of the FCC Rules. These limits are designed to provide reasonable protection against harmful interference in a residential installation. This equipment generates uses and can radiate radio frequency energy and, if not installed and used in accordance with the instructions, may cause harmful interference to radio communications. However, there is no guarantee that interference will not occur in a particular installation. If this equipment does cause harmful interference to radio or television reception, which can be determined by turning the equipment off and on, the user is encouraged to try to correct the interference by one or more of the following measures:

- Reorient or relocate the receiving antenna.
- Increase the separation between the equipment and receiver.
- Connect the equipment into an outlet on a circuit different from that to which the receiver is connected.
- Consult the dealer or an experienced radio/TV technician for help

