

WIRELESS FM TRANSMITTER



USER MANUAL

EN

DE

FR

ES

IT

| | | |
|----------|-------|----|
| English | ----- | 01 |
| Deutsch | ----- | 12 |
| Français | ----- | 23 |
| Español | ----- | 34 |
| Italiano | ----- | 46 |

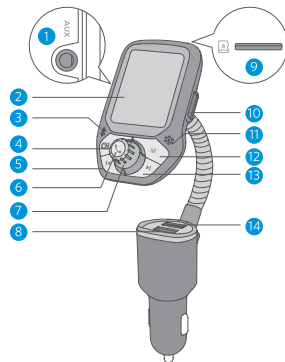

- ① AUX IN/OUT Port
- ② Display Screen
- ③ Microphone 1 (Noise Reduction for 2 Microphones)
- ④ CH Button
- ⑤ Previous Track/Fast Backward
- ⑥ Multifunctional Button: Pause/Play/Hands-free Phone Call (Answer/Hang Up/Decline the Call)
- ⑦ Knob (Increase/Decrease Frequency, Volume +/-)
- ⑧ QC 3.0 Output: DC 5V/3A, 9V/2A, 12V/1.5A
- ⑨ TF Card Slot (Max. 64G)
- ⑩ U Disk Port (Max. 64G)
- ⑪ Microphone 2
- ⑫ Menu Button
- ⑬ Next Track/Fast Forward
- ⑭ PD 20W Output: DC 5V/3A, 9V/2.22A, 12V/1.67A;

SCREEN DISPLAY MEANING

| Icon on Display Screen | | Icon on Display Screen | |
|------------------------|---|------------------------|--|
| | Bluetooth Connected/Bluetooth Disconnected | 97.6 | Frequency |
| | Pause/Play | | Volume |
| | AUX IN/U Disk/TF Card Mode | | EQ Mode |
| 10.7V | Car Voltage Monitor ≤ 12V: Abnormal battery; 12.0-12.8V: Normal voltage range before car gets started ; 13.0V-14.8V: Normal voltage range after car gets started | // | REPEAT ONE/REPEAT ALL/REPEAT FOLDER/RANDOM |

SPECIFICATIONS

| | |
|----------------------------|-------------------------------|
| Product Name | CZ446 |
| Effective Distance | 5 m |
| FM Tuning Range | 88.1-107.9MHz |
| Support Audio Format | MP3.WMA.WAV.FLAC.AAC |
| Support Bluetooth Protocol | A2DP/AVRCP/HSP/HFP |
| USB-A QC3.0 Output | DC 5V/3A, 9V/2A, 12V/1.5A; |
| USB-C PD20W Output | DC 5V/3A, 9V/2.22A, 12V/1.67A |

1. Turn On/Off

Turn On: Start your car and plug **CZ446** into the cigarette lighter. The product will turn on after that, and its screen will light up meanwhile. When it's connected to electrical power but in power-off state, long press **CH** button for 3s to turn it on.

Turn Off: Cut its power and it'll turn off. In power-on state, long press **CH** button for 3s to turn it off.

Tips: When the product is turned off through the button, its charging port is still available for charging.

2. Frequency Tuning/Bluetooth Connection Guide

Attention: When using for the first time, you need to adjust the blank FM frequency of **CZ446** to be the same as that of your car (Not a frequency of local broadcast/A frequency without any broadcast/A frequency only with white noise). For seeking a better sound enjoyment, please make sure that the blank FM frequencies of **BH446** and your car are the same when every time you use the product (Not a frequency of local broadcast/A frequency without any broadcast/A frequency only with white noise).

- Adjust your car's FM frequency to a blank frequency (An unoccupied frequency/A frequency only with white noise), such as FM88.8.
- Short press **CH** button to enter FM tuning mode. Then rotate the knob button to adjust the frequency. Rotate it clockwise to increase frequency and rotate it anticlockwise to decrease the frequency. Next, adjust the blank frequency of **BH446** to be the same as that of your car, eg. FM88.8.

Method 2: Precise Tuning - Short press **▶** button to increase frequency and **◀** button to decrease.

Method 3: Quick Tuning - Long press button **▶** to increase frequency and **◀** to decrease.

- Bluetooth Connection: Turn on Bluetooth on your smart devices. Search "**CZ446**" and connect it, and you can use the product after that. (When used again, **CZ446** will reconnect the last connected device.)

- A** Tune to a blank frequency. For example: 88.8



FM 88.8

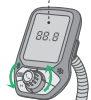

Rotate Knob
Button for Tuning

B



Short press to
enter into FM mode

C

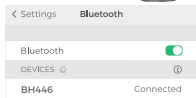

D

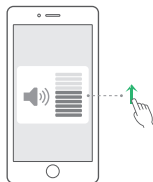

- D. Please appropriately turn up the volume of your phone. (Please refer to following content for AUX IN Cable/U Disk/TF Card Instructions)

3. Bluetooth Hands-free Function

- A. Answer a Phone Call: Short press
- B. Hang Up the Phone: Short press
- C. Redial the Last Number: Double press
- D. Reject a Phone Call: Long press for 2s.

4. Music Function (Please make sure it's successfully connected before using this function)

4.1. 4 Music Sources-Bluetooth/AUX IN Mode/U Disk/TF Card

- A. Bluetooth Mode: After your smart device (eg. Phone) is connected to product's Bluetooth successfully, the music will be synchronized to your car speaker if you play music on your phone.
- B. AUX IN Mode: Connect BH446 to your smart device (eg. Phone) with 3.5mm audio cable. The music will be synchronized to your car speaker if you play music on your phone.

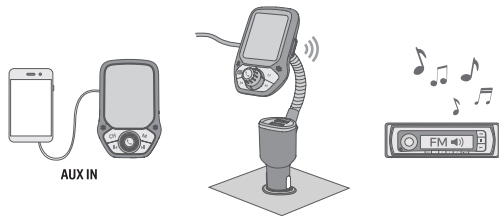

- C. TF Card/U Disk Mode: Plug TF Card or U Disk in product's port, and it will automatically recognize the device and play the music in it.

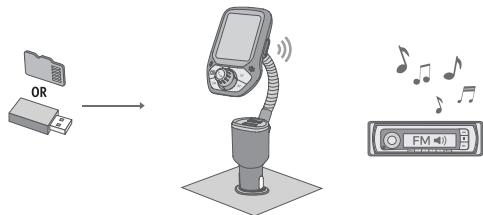

Important Note: For better user experience, please choose only one source to play music when every time you use the product.

4.2. Music Playing Operation

- A. Play/Pause: Short press **⏮** button.
- B. Previous Track or Next Track: Short press **⏮** or **⏭** button.
- C. Volume Up: Rotate knob button clockwise **⏪** (AUX IN mode doesn't support volume adjustment).
- D. Volume Down: Rotate knob button anticlockwise **⏩** (AUX IN mode doesn't support volume adjustment).
- E. In TF Card and U Disk mode, long press **⏮** to fast backward the song and long press **⏭** to fast forward it.

4.3. Music Source Selection

- A. Switch among Bluetooth/AUX IN Mode/TF Card/U Disk: Long press **M** button for 2s to enter switching interface. Rotate **⏪** to select mode among Bluetooth/AUX IN Mode/TF Card/U Disk. Then short press **⏮** to confirm operation.
- B. Auto Play Music in TF Card/U Disk Mode: Plug and Play.
- C. Power Cut Memory: When you reboot BH446 after power cut, it will automatically enter previous playing mode that is played before power cut (In U Disk/TF Card mode, it will automatically replay the song

that's played before power cut. In Bluetooth mode, you need to play music manually).

4.4. Folder and Playing Mode Selection

4.4.1. Folder Selection:

Shown as follow in TF Card or U Disk mode:

- A. Enter Folder-browsing Mode: Short press **M** button and rotate **⏪** to select "Folder". Short press **⏮** to confirm operation and short press **CH** button to go back to previous level.
- B. Select Folder: Select folders up and down by rotating **⏪**, and short press **⏮** to open the folder.
- C. Select Songs: Select songs by rotating **⏪**. Short press **⏮** to confirm operation and the product starts to play the song.

4.4.2. Play Mode Selection

Shown as follow in TF Card or U Disk mode:

- A. Enter Play Mode: Short press **M** button and rotate **⏪** to select "Play Mode", and short press **⏮** to confirm operation.
- B. Select Play Modes: Rotate **⏪** to select among "REPEAT ALL", "REPEAT ONE", "RANDOM" and "RPEAT FOLDER", and short press **⏮** to confirm operation.

4.4.3. EQ Mode Selection

- A. Enter EQ Mode: Short press **M** button and rotate **⏪** to select "EQ Mode", and short press **⏮** to confirm operation.
- B. Select Music Style: Rotate **⏪** to select among "NORMAL", "CLASSICAL", "POP", "ROCK" and "JAZZ", and short press **⏮** to confirm operation.

5. Charging Description

5.1 QC3.0 Quick Charge Port Description



- A. For some devices that don't support QC3.0 quick charge, the maximum output is 5V/2.4A.
- B. For some devices that support QC3.0 quick charge and meet QC3.0 quick charge protocol, its output is DC 5V/3A, 9V/2A, 12V/1.5A.

5.2 Type-C Quick Charge Port Description

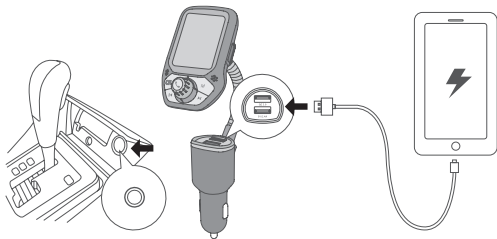
- A. For some devices that don't support PD quick charge, the maximum output is 5V/2.4A.
- B. For some devices that support PD quick charge and meet PD 20W quick charge protocol, the output is DC 5V/3A, 9V/2.22A, 12V/1.67A (Please use C to C or C to Lighting data cable).



6. Voice Assistant

- A. Long press  button for 2s to enter voice assistant.
- B. Long press  button for 2s to exit from voice assistant.

Selection of Input and Output Ways

Input Ways of Music Source: Bluetooth/U Disk/TF Card/AUX IN (Please select only one way to play in case of influencing the user experience).

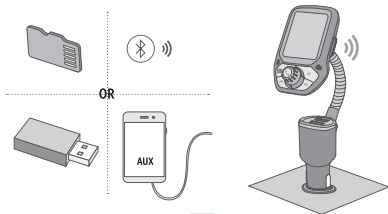

Output Ways of Music Source: FM/AUX OUT (Please select only one way to play in case of influencing the user experience).

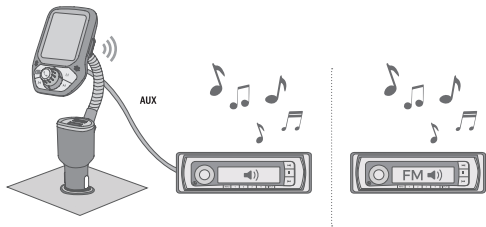

Friendly Tips: Instructions of AUX Output to Car

If your car has AUX port or there is only few blank frequencies in long-distance driving, you can connect the FM transmitter to your car with the AUX cable. This can reduce the noise and offer a better user experience in calling and listening music. (When you adopt "AUX Output to Car", the product's input ways are Bluetooth, TF Card and U Disk.)

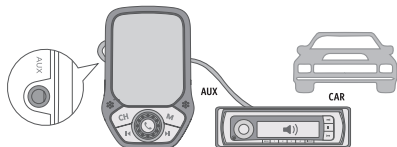

Friendly Tips:

For Android devices, when you're going to use your voice to directly wake up the voice assistant, please turn up your phone's and BH446's volume to their maximum volume level first, and adjust the car speaker's volume according to your needs.

For iPhone, the instructions of "Hey Siri" function can refer to following:

A. Turn on Siri settings on your phone.

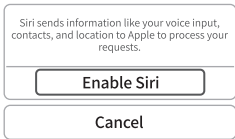
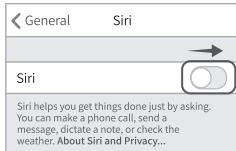
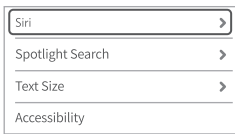
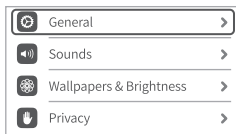

B. Complete the voice recognition according to Siri instructions.

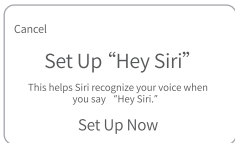

C. Use Siri function direct on your phone.

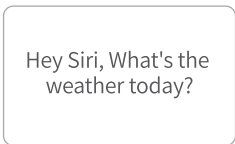

Note: This function is not available for some phone brands. (Supported phone brands are iPhone, Samsung phones and original Android phones)

7. Note

- Do not turn up your radio's volume too loud in case of increasing its background noise.
- Although the transmitting power of our FM transmitter is strong, for ensuring the best sound effect, please try to avoid adjusting to the frequency of local radio station with strong signal.
- Do not use the product in too hot/cold, dusty or damp environment.
- Do not break or throw the product to prevent surface or unit damage.
- Do not disassemble the product personally. Please contact seller if you have any questions or problems.

NOTE:

This equipment has been tested and found to comply with the limits for a Class B digital device, pursuant to part 15 of the FCC Rules. These limits are designed to provide reasonable protection against harmful interference in a residential installation. This equipment generates uses and can radiate radio frequency energy and, if not installed and used in accordance with the instructions, may cause harmful interference to radio communications. However, there is no guarantee that interference will not occur in a particular installation. If this equipment does cause harmful interference to radio or television reception, which can be determined by turning the equipment off and on, the user is encouraged to try to correct the interference by one or more of the following measures:

- Reorient or relocate the receiving antenna.
- Increase the separation between the equipment and receiver.
- Connect the equipment into an outlet on a circuit different from that to which the receiver is connected.
- Consult the dealer or an experienced radio/TV technician for help

Changes or modifications not expressly approved by the party responsible for compliance could void the user's authority to operate the equipment.

This device complies with Part 15 of the FCC Rules. Operation is subject to the following two conditions:

- (1) this device may not cause harmful interference, and (2) this device must accept any interference received, including interference that may cause undesired operation.