

成品尺寸80*160MM（红色外框线不要）

正面

Smart Wireless Meat Thermometer User Manual

FEATURES

- ✓ Dual probes technology, monitor two different meats simultaneously, available for the grill, oven and smoker.
- ✓ Programmed with preset USDA approved temperatures for different types of meat in APP.
- ✓ Programmed with preset USDA approved doneness levels for different types of meat in APP.
- ✓ Display the preset type of meat and doneness levels of dual probes in APP.
- ✓ User can define to add different meat types and alarm temperature in APP.
- ✓ Resolution: 1°.
- ✓ Measurement range: -20°C~300°C (-4°F~572°F).
- ✓ Measurement accuracy: ±1°C (±2°F) at -20°C~150°C (-4°~302°F).
- ✓ Fahrenheit and Celsius switchable.
- ✓ Low battery indicator.
- ✓ Max wireless transmission distance is 55m/180 ft (open filed).
- ✓ Automatic shut-off after 5 minutes if the two probes are not inserted or automatic shut-off after 10 minutes if the measured temperature is stable within 3°C (6°F) below 50°C (122°F) with probes in.
- ✓ Probes and wire can withstand temperature up to 380°C (716°F).

DEVICE STETCH

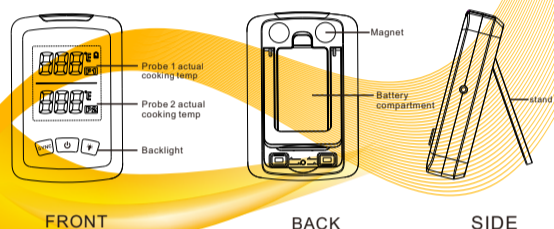

FRONT

BACK

SIDE

108A-1

BUTTON FUNCTION

	Press this button once to turn the device on/off.
	In normal mode, press this button to turn the backlight on/off.
	In normal mode, long-press this button for 2 seconds to pair the device with the APP.

INSTALLING BATTERIES

1. Remove the battery compartment cover located at the bottom of the device by pushing the elastic clasp.
2. Installing two AAA batteries according to the polarity sign shown in the battery compartment.
3. Close the battery compartment cover back in place.

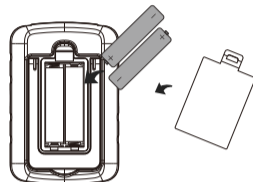

HOW TO USE THE DEVICE

1. Take off the protective film on the front panel.
2. Turn on the device by pressing the button.
3. Plug the probes into the socket of probe 1 and probe 2 respectively, the LCD will display the temperature of probe 1 and probe 2 immediately.
4. Press the button to light the LCD.
5. Download and install the APP for free. Search the keyword 'Tuya Smart' in Appstore or Google Play, or scan the following QR Code with your phone.



108A-2

6. Turn the blue-tooth switch and Location System of your phone on.
7. Long-press the button on the device for 2 seconds until it beeps.
8. Launch the APP, click the button at the top right corner to manually add the device, which will be matched automatically and immediately, then follow the instructions to pair and activate the APP.

Once Paired the device with your phone successfully, you don't need to do it again, unless you change to other phones.

ENJOY YOUR BARBECURE TIME

Choose food type and doneness for the food where each probe is inserted, the APP will display its current and target temperature. See the user interface below for more details.

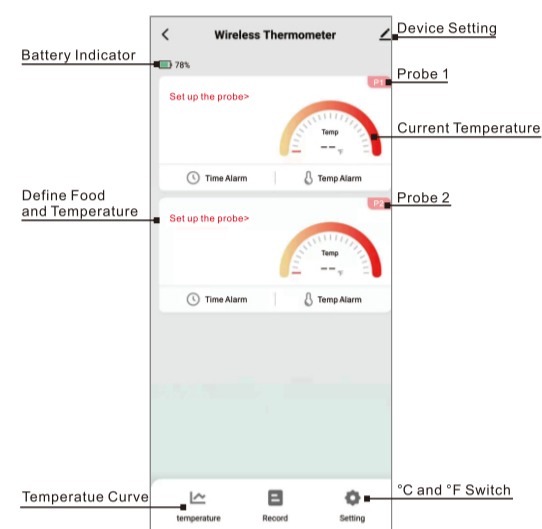

108A-3

背面

The user interface of the APP may be changed when update. Please follow the instructions in the APP.

HOW TO USE THE APP

1. Setting : Press this button in APP to choose °F or °C as the temperature unit.
2. Temperature alarm setting: Log in Tuya Smart APP, press the button to edit the temperature available from -20°C to 300°C (-4°F~572°F).
3. Time Alarm setting: Press the button to edit the alarm time available from 00 Hour 01 Minute to 23 Hour 59 Minute to trigger alarm reminder when the set time is over.
4. Probes setting: Click the displayed 'Set up the probe', set up different meats types and temperature, or add needed food types of P1 and P2 separately.
5. Temperature curve checking: Press the temperature on the left bottom of APP to check the trend of cooking temperature .

HOW TO MAKE A COOKING RECORD

1. Click the temperature button on the APP, then click P1 or P2 where shows a button of 'Generate record' on the top right corner, to start record the temperature curve.
2. Then click the button 'End record' to end which will be automatically saved in the 'Record'.
3. To check the record saved, click the button 'Record' to review the History Record or add your Favorite Records as needed.

HOW TO ALARM

When the alarm goes on, your phone will ring and the device will alarm for 60 seconds until it returns to the normal range. The alarm can be turned off from pressing any buttons on the device or setting on the APP. After the alarm goes off, the alarm will continue only when the temperature returns to the normal range and exceeding the alarm temperature setting.

108A-4

TROUBLESHOOTING

No display of temperature	Check whether the probes are inserted.
Display screen not working	Make sure the battery is installed correctly. Battery may need to be replaced.
"Low battery" indicator flashing	Battery may need to be replaced.

CLEANING & MAINTENANCE

- Do not disassemble the product, which may cause product damage.
- Always wear a heat resistant glove to touch the probe sensors or wires during or just after cooking. Do not touch with bare hand.
- Wash the metal probe tips with hot soapy water and dry thoroughly. Do not immerse the product into water while cleaning.
- Clean the product by wiping with a soft cloth.
- Do not drop the product or force it to sudden shock or impact.
- The probes are only waterproof for the part of steel tube, do not immerse the wire or the plug into water.
- Do not put it into the dishwasher.

108A-5

This device complies with part 15 of the FCC Rules. Operation is subject to the following two conditions: (1) this device may not cause harmful interference, and (2) this device must accept any interference received, including interference that may cause undesired operation.

Any changes or modifications not expressly approved by the party responsible for compliance could void the user's authority to operate the equipment.

NOTE: This equipment has been tested and found to comply with the limits for a Class B digital device, pursuant to Part 15 of the FCC Rules. These limits are designed to provide reasonable protection against harmful interference in a residential installation. This equipment generates, uses and can radiate radio frequency energy and, if not installed and used in accordance with the instructions, may cause harmful interference to radio communications.

However, there is no guarantee that interference will not occur in a particular installation.

If this equipment does cause harmful interference to radio or television reception, which can be determined by turning the equipment off and on, the user is encouraged to try to correct the interference by one or more of the following measures:

- Reorient or relocate the receiving antenna.
- Increase the separation between the equipment and receiver.
- Connect the equipment into an outlet on a circuit different from that to which the receiver is connected.
- Consult the dealer or an experienced radio/TV technician for help.

The device has been evaluated to meet general RF exposure requirement. The device can be used in portable exposure condition without restriction

FCC ID: 2A3IC-DT-108A