

折叠后成品尺寸：85X120mm
材质：100G书写纸 单黑 两面印 四折页

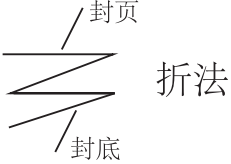

English

Installing the Batteries

Wireless keyboard are use one AA alkaline batteries,
Wireless mouse are use one AA alkaline batteries

Installing Batteries in the Mouse

- Step 1. Open the battery compartment
Step 2. Insert the batteries as shown inside the battery compartment.
Step 3. Replace the cover.

Install the batteries in the keyboard

- Step 1. Remove the battery compartment cover on the bottom of the keyboard by squeezing the cover in from the tab to release it.
Step 2. Insert the batteries as shown inside the battery compartment.
Step 3. Replace the cover.

Connecting the Receiver

The receiver is insert to USB port immediata, or by a extra USB cable.
1. Connect the USB plug to USB port of your computer.

Obtain the receiver on the mouse

- 1.when you want use the mouse, you can take out the receiver to computer
2.when you need stop the work or to travel, you can store the receiver on the mouse for the moving

product description

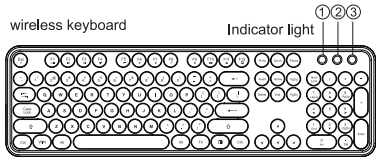

- 1.Num Lock
2.Caps Lock
3.Low power and wireless connection indicator light

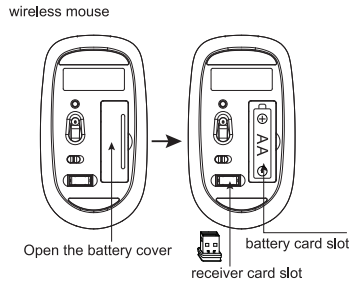

Restoring factory default settings

When you find this set doesn't work, you can make the mouse in working condition by restoring the mouse back to factory default settings.

- 1: Check the battery volume is normal; if the battery is used out, please replace new batteries.
2: For mouse, Press the right button and middle button (under the scroll wheel) simultaneously; then ...
3: Insert the nano receiver onto the USB port of PC or notebook.
4: For the keyboard, Press the "Esc" and "K" key simultaneously; then...
5: Insert the nano receiver onto the USB port of PC or notebook.

State of standby and wake up the mouse

Your RF2.4GHz mouse have economize model, that when your mouse no any click or scroll or moving, the mouse will come to sleep state for the economize after about 8 seconds; for the wake up, you can scroll the wheel or click any button for this. (On this economize state, the optical LED will turn off, so, the mouse moving will not be respond)

Power-Save function:

* This mouse is equipped with Traveling-Power-Save function. When you are traveling with this mouse, the LED of the mouse will be switched off automatically for the purpose of power-save, but he pre-condition is that the receiver is disconnected with your notebook or PC.

* when your mouse no any click or scroll or moving, the mouse will come to sleep state for the economize after about 8 seconds; for he wake up, you can scroll the wheel or click any button for this

维修服务: 公司全面遵照国家质量监督检验检疫总局和信息产业部联合颁布的《微型计算机商品修理更换退货责任规定》

以下情况不属于保修服务范围:

1. 不能出示产品有效质保凭证; 或产品原序列号标签有涂改、替换、损毁现象, 或产品没有序列号、或质保凭证上的产品型号、编号与产品实物不相符合的。
2. 产品超出公司所规定的质保期限。
3. 未依据产品使用说明书或未依据说明书所指示的电脑工作环境使用、维护、保管所导致的故障和损坏。
4. 非公司授权的维修人员对产品修理、更改或拆卸而造成的故障或损坏。
5. 使用盗版软件或因病毒感染而导致故障或损坏的。
6. 意外事故或其它不可抗力造成的损坏。

● 销售人员承诺的产品之外的服务及附加的配置、赠品, 不在本保修服务范围内。

保修期限:	起 年 月 日 止 年 月 日
购买日期:	年 月 日
购买地点:	
产品序列号:	
盖 章	
产 品 维 修 记 录	
日 期	维 修 情 况

备注: 请清楚填写各条目, 请勿擅自涂改, 并妥善保管好本保修卡, 以维护您的合法权益。如需服务或有任何疑问, 请与我们联系。

深圳市虹欣时速科技有限公司
Shenzhen Hxss Technology Co., Ltd.
地址: 深圳市龙华区民治街道民乐社区民乐工业区9栋609
Add.: 609,c Building,minle Technology Area,minzhi Street,
longhua Distict,shenzhen Guangdong Province,china
电话(传真): 0755-23744139

JAR-OWL

V2020

无线键鼠 用户手册
USER'S MANUAL

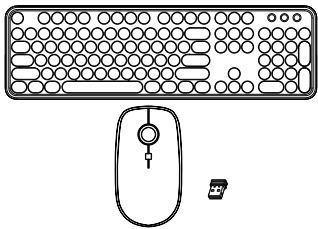

注意: 在第一次使用此设备时, 为保证达到较好的使用效果, 请仔细阅读此说明书。

使用说明书

感谢您的支持, 为了使您更进一步的了解此无线键鼠套装的使用, 请您在使用前认真阅读此说明书!

1. 包装内内容物

- 无线键盘.....1PCS
无线鼠标.....1PCS
接收器.....1PCS
使用说明书(含质保卡).....1PCS
电池.....2PCS

2. 产品安装说明

1. 从鼠标底部取出USB接收器, 插到电脑的USB端口。
2. 打开鼠标底部电池盖, 将一节AA(5号)电池装入电池仓中(注意电池的正负极性必须正确)鼠标底部LED灯将会点亮一次后熄灭, 盖上电池盖。
3. 打开键盘底部电池盖, 将一节AA(5号)电池装入电池仓中(注意电池的正负极性必须正确), 盖上电池盖。
4. 外出携带及不使用时, 也可以将USB接收器装入鼠标底部的接收器槽内。

3. 产品描述

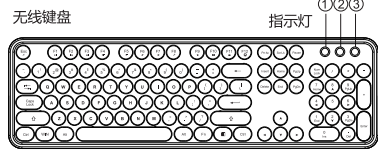

1. 小数字切换指示灯
2. 大小写切换指示灯
3. 低电量与无线连接指示灯

无线鼠标--NANO接收器

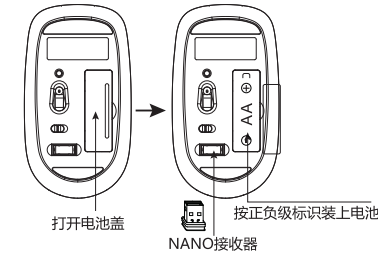

产品中有害物质含量

部件名称	有害物质					
	铅 (Pb)	汞 (Hg)	铜 (Cu)	六价铬 (Cr(VI))	多溴联苯 (PBB)	多溴二苯醚 (PBDE)
印刷电路板组件*	X	○	○	○	○	○
外壳及附件	X	○	○	○	○	○

* 本表格按照RoHS指令(2002/95/EC)的要求编制。
○ 表示在有害物质含量符合RoHS指令要求的范围内。
X 表示在有害物质含量不符合RoHS指令要求的范围内。
注: 本表格仅用于标识, 不作为法律依据。如产品中含有有害物质, 请参照国家环保标准GB/T 26572-2008《电子产品有害物质含量要求限值》执行。
根据产品型号不同, 您所购买的产品可能不会含有以上所有部件。
在中华人民共和国境内销售的电子产品必须标识此标志, 标志内的数字代表产品在正常使用状态下的产品的环保使用期限。



封底

FCC Statement

This equipment has been tested and found to comply with the limits for a Class B digital device, pursuant to part 15 of the FCC rules. These limits are designed to provide reasonable protection against harmful interference in a residential installation. This equipment generates, uses and can radiate radio frequency energy and, if not installed and used in accordance with the instructions, may cause harmful interference to radio communications. However, there is no guarantee that interference will not occur in a particular installation. If this equipment does cause harmful interference to radio or television reception, which can be determined by turning the equipment off and on, the user is encouraged to try to correct the interference by one or more of the following measures:

- Reorient or relocate the receiving antenna.
- Increase the separation between the equipment and receiver.
- Connect the equipment into an outlet on a circuit different from that to which the receiver is connected.
- Consult the dealer or an experienced radio/TV technician for help.

To assure continued compliance, any changes or modifications not expressly approved by the party.

Responsible for compliance could void the user's authority to operate this equipment. (Example- use only shielded interface cables when connecting to computer or peripheral devices).

This equipment complies with Part 15 of the FCC Rules. Operation is subject to the following two conditions:

- (1) This device may not cause harmful interference, and
- (2) This device must accept any interference received, including interference that may cause undesired operation.

RF warning statement:

The device has been evaluated to meet general RF exposure requirement.
The device can be used in portable exposure condition without restriction.