



Buds Live (LV08JL)

User Manual

<https://en.pisengroup.com>

Thank you for purchasing PISEN Wireless Earphone. Please read and keep this manual to ensure safety and future reference.

Specifications

Model	LV08JL
Standby Time	Approx 70h
Earbud Battery	45mAh
Capsule Battery	500mAh
Rated Voltage	3.7V
Charging Time	Approx 1.5h
Playback Time	Approx 4.5h
Input	DC=400mA

Above data is from Pisen lab, they may vary from working conditions or other possible reasons.

2

Package Contents

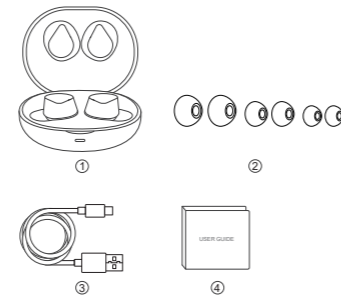

- 1 Boltune True Wireless Stereo Earbuds (Buds live)
- 2 6 x Ear Tips (two are equipped on the earbuds)
- 3 1 x Type-C Charging Cable
- 4 1 x User Guide

3

Product Diagram

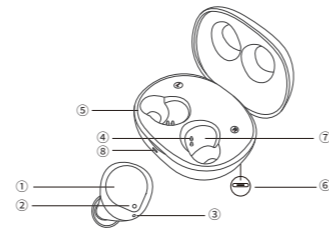

- 1 Multifunction Touch Control
- 2 LED Indicator
- 3 Microphone
- 4 Charging Contacts
- 5 Charging Case
- 6 Type-C Charging Port
- 7 Charging Slot
- 8 Charging Indicator

Important Safety Instructions

Please read the instructions thoroughly before using this product and retain it for future reference.

4

Hearing Safety

- Do not wear earbuds with high volume for a long time to avoid damaging your hearing.
- Set the earbuds to low volume before you put them on, then increase the volume gradually as per your preference.
- Do not set volume too high to stay aware of your surroundings.
- Please refer to local laws and regulations if you want to answer phone calls via this device during driving.
- For your safety, avoid distraction from music or phone calls when you are driving or doing other activities with potential dangers.

Warning: Please set the volume to proper level to avoid hearing damages.

Caution

- Do not expose this product to high temperatures.
- Do not immerse the earbuds into water or expose them to humidity for a long time.
- Do not clean the product with detergent containing alcohol, ammonia, benzene or abrasives.
- Avoid dropping.
- Place the earbuds back into the charging case when not in use and keep it away from children and pets to avoid choking hazard.

5

- Unauthorized disassembly of any parts of this product is forbidden, which may cause fire hazard, warranty voidance, and/or property loss.
- Close attention is needed when using near children.
- Keep the charging case away from water, rain or any other liquid.
- Don't use the product in thunderstorm to avoid malfunction or electric shock.
- Always ask a professional technician or authorized personnel for repair.

Warning: This product contains lithium battery. Never expose it to excessive heat such as direct sunlight or fire to avoid explosion.

How To Wear

Choose the Right Tips

Ear tips with different sizes are included in the package, try all sizes and choose the ones fitting you best.



6

Wear the Earbuds

Please wear the earbuds as shown below.



Pictures only for reference.

Bluetooth Caution

- When the device is connected wirelessly to another device, place the two devices close to each other to achieve their normal functionalities and avoid possible signal interference.
- When using a wireless connection, make sure there are no obstacles between the two devices. Obstacles including walls and fences may shorten the effective range.

Using Your Earbuds

Charging

1. Put the earbuds into the charging case as per the L (left) and R (right) marks
2. Cover the lid and charging will start automatically.

7



- Note:
- Please fully charge the earbuds when using them for the first time.
 - When battery is low, a "Battery low" voice prompt will be heard (if you are wearing the earbuds). Please charge it in time or the earbuds will turn off automatically around 10 minutes later.
 - Charge the earbuds at least once every 3 months when not using for a long time.

Charging the Charging Case

1. Connect the charging port with any USB charging adapter or active computer/USB port.
2. The charging indicators will flash slowly.



- Note:
- Unplug the charging cable (timely) once fully charged.

8

Power On

Remove the earbuds from the charging case and it start automatically.



Power Off

1. Put it in the charging Case and it shuts off automatically.
2. long Press for 10 seconds when the machine is on (it cannot be turned off when playing music or talking).
3. Automatically shuts down after 3 minutes without connection.

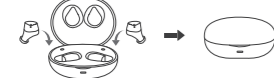

Pairing

- You can use one earbud or both earbuds as per your preference. Please refer to the corresponding pairing instructions.

9

- Before pairing, please turn off other Bluetooth devices and place the device to be connected close to the earbuds.
- When the earbuds are disconnected from your device for more than 10 minutes, they will turn off automatically.

Couple Earbuds Mode

1. Lift the lid and take out the earbuds, and they connect to each other. The LED indicator on the main ear flashes alternately red and blue to indicate that the earbuds is now paired with the phone.
2. Turn on the Bluetooth function on your device and search for nearby devices. Find "Buds live" in the searching results, tap on the name to connect.
3. Connection successful. The indicator is off.

Note: It is not recommended to wear the two earbuds on different people. If needed, please keep the 2 earbuds within 3 meters / 9.8 feet in couple earbuds mode.

Single Earbud Mode

1. Take out one earbud from the charging case, and make sure the other one is placed in the charging case.
2. Tries to pair with the last device it pairs, and then goes into pairing mode. When pairing fails, its LED indicator blinks alternately red and blue.

10

3. Turn on the Bluetooth function on your device and search for nearby devices. Find "Buds live" in the searching results, tap on the name to connect.
4. Once connected, the LED indicator will go off.

Note: If you want to change to couple mode, simply take out the other earbud from the charging case, they will pair with each other automatically.

Clear Pairing List

- If you failed to pair your device with the earbuds, please clear the pairing history as instructed below:
1. Place both earbuds in the charging case.
 2. When the left and right earphones are off, press and hold for 5 seconds to prompt a "beep" sound, and the red and blue lights flash twice at the same time.
 3. If you have paired your device with the earbuds before, remove "Buds live" from the Bluetooth device list and pair again.
 4. Re-pair with your Bluetooth device as instructed in "Pairing" section.

Note: If you want to pair the earbuds with another device when you have already paired them with a device, deactivate the Bluetooth function on the paired device or clear "Buds live" from its Bluetooth list. Restore the earbuds to factory settings as instructed above if pairing failed.

11

Operation and Functions

Function	Operation	Voice Prompt
Power on	Remove the earbuds from the charging case and it start automatically	Power on
Power off	1. Put it in the charging case and it shuts off automatically 2. long Press for 10 seconds when the machine is on (it cannot be turned off when playing music or talking) 3. Automatically shuts down after 3 minutes without connection	Power off
Pairing	Lift the lid and take out the earbuds and they connect to each other. The LED indicator on the main ear flashes alternately red and blue to indicate that the headset is now paired with the phone	/
volume +	Long press your right ear while playing music or talking	Beeeps at maximum volume
volume -	Long press the left ear while playing music or talking	Beeeps at minimum volume
previous song	Double click on the left ear	Toot
The next song	Double-click on the right ear	Toot

12

Function	Operation	Voice Prompt
Pause/ Play	When the music is playing, Pause music: Click left ear or right ear Music playing: Click the left or right ear	/
Answering calls	Double-click the left or right ear	/
Hang up the call	Double-click the left or right ear	/
Decline a call	Press left or right ear for 2 seconds	Toot
SIRI	Three strikes left or right ear	Toot
Clear pairing information with the mobile phone	Press long for 5 seconds while the earbuds is off	Toot

Note: Only when you are wearing the earbuds can you hear the voice prompt.

Cleaning and Maintenance

1. Clean the earbuds and the charging case on a regular basis.
2. Use dry and soft cotton cloth to wipe the unit.
3. Keep away from sharp objects to avoid scratches.
4. Put the unit in a dry and shady place if it is to be idle for a long time.
5. Do not clean the product with detergent or chemicals.

Note: Do not insert anything into the product.

13

Troubleshooting

No.	Problem	Solution
1	Failed to turn on the earbuds	Earbuds low battery, please charge them
2	Failed to charge the earbuds	• Place the earbuds into the charging case properly • Make sure the charging case is fully charged
3	Can't charge the charging case	Make sure the charging cable is intact and plugged in properly
4	Can't find "Buds live" in the Bluetooth device list	The earbuds reconnected with previously paired device automatically. • Deactivate the Bluetooth function of previously paired device or clear "Buds live" from its Bluetooth device list, and then search again
5	Failed to pair the earbuds with your device	• Turn on the device and activate its Bluetooth function before pairing • Bring the earbuds into pairing mode as instructed in the "Pairing" section

14

No.	Problem	Solution
6	No sound in one of the earbuds in couple earbuds mode	Place both earbuds back to the charging case then take them out, they will pair with each other automatically. If pairing failed, restore them back to the factory settings as instructed in the "Clear Pairing List" section
7	Poor sound quality	• Wear the earbuds properly and keep them close to each other. • Place the connected device close to the earbuds or remove the obstacles between them • Clear the debris on the earbuds
8	Unstable connection	• The effective distance may shorten with obstacles in the way • Turn off other Bluetooth devices to decrease the interference
9	Can't hear the other party during a phone call	Set the volume to higher level
10	The other party can't hear your voice during a phone call	Free the built-in microphone of any covers
11	Touch Control of the earbuds is unresponsive	Place the two earbuds into the charging case and cover the lid, disconnect the Bluetooth connection, Uncover the lid to turn on the earbuds and pair again.

15



For FAQs and more help information, please visit: [pisengroup.com/support](https://en.pisengroup.com/support)

Contact: support@pisengroup.com

Design By Pisen Made in China
Guangdong PISEN Electronics Co., Ltd
Add: No. 8, Qunfa 1st Street, Changyi Industrial Park, Henggang Town, Longgang District, Shenzhen, P.R. China
PISEN® The brand belongs to Guangdong PISEN Electronics Co., LTD.
<http://www.pisengroup.com>



LABEL

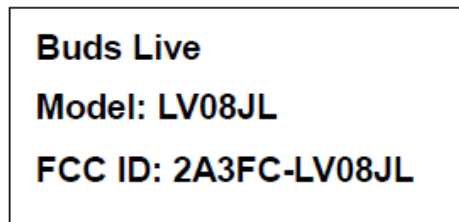

FCC Statement

This device complies with part 15 of the FCC rules. Operation is subject to the following two conditions: (1) this device may not cause harmful interference, and (2) this device must accept any interference received, including interference that may cause undesired operation.

Changes or modifications not expressly approved by the party responsible for compliance could void the user's authority to operate the equipment.

NOTE: This equipment has been tested and found to comply with the limits for a Class B digital device, pursuant to part 15 of the FCC Rules. These limits are designed to provide reasonable protection against harmful interference in a residential installation. This equipment generates uses and can radiate radio frequency energy and, if not installed and used in accordance with the instructions, may cause harmful interference to radio communications. However, there is no guarantee that interference will not occur in a particular installation. If this equipment does cause harmful interference to radio or television reception, which can be determined by turning the equipment off and on, the user is encouraged to try to correct the interference by one or more of the following measures:

- Reorient or relocate the receiving antenna.
- Increase the separation between the equipment and receiver.
- Connect the equipment into an outlet on a circuit different from that to which the receiver is connected.
- Consult the dealer or an experienced radio/TV technician for help.

The device has been evaluated to meet general RF exposure requirement. The device can be used in portable exposure condition without restriction.