

Wireless Touchless Switch (WPS100)

Instruction Manual

The WPS100 is a wireless proximity switch that is easy to install. It can control the opening and closing of automatic doors and similar devices by detecting hand or object movement without direct contact. For the safe and correct use of the product, please read this instruction manual carefully.



1 Product composition and specification

Components	Quantity	Notes
WPS100	1EA	
Double-sided Tape	1EA	
Battery (CR123A)	2EA	
Fixing Screw (4*16)	2EA	
Front Plate (2 types)	2EA (Hand and Wheelchair)	
User Manual	1Copy	

Specifications	Value
Power Supply	DC3V
Technology	Infrared - Reflective
Detection Range / Method	1~15cm ±5cm / LED or BUZZER
Detecting Target	Hand or Object (Touchless) ※ Detecting distance varies depending on the color of the object
Output	2.4GHz
Transmitting distance	<10m (2m or less when attached a metal structure)
Reaction sensitivity	<1sec.
Battery Lifespan	Approx. 12 months (500 usages per day)
Current Consumption	<0.5mWh
Operating Temp / Humidity	-20°C ~ 50°C / 0~90%
International Protection	IP65
Product size / weight	95 x 95 x 20 mm

2 General Information

- LED Red : Detecting
- LED Red : Replace battery
(Battery symbol will flash 5 times after detecting)

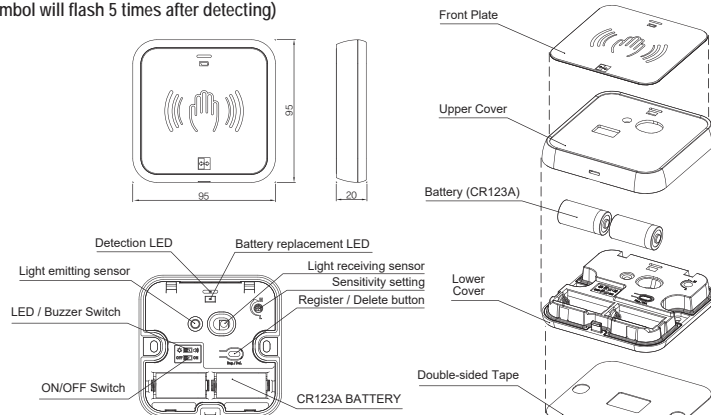

3 Installation Guide

- 1 If the protective film is not removed from the Front Plate it may interfere with the function of this product, therefore remove the protective film from the Front Plate and disassemble the WPS100 cover using a screwdriver.

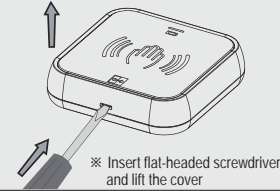

- 2 Install batteries and turn the WPS100 ON. Register the transmitter using the Register/Delete button (See section 4).

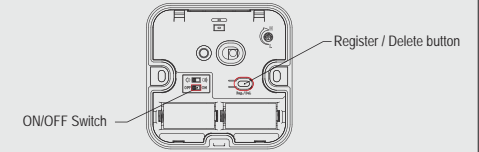

- 3 Attach the Lower Cover to where you want to install the sensor using the Double-sided Tape and/or screws provided.

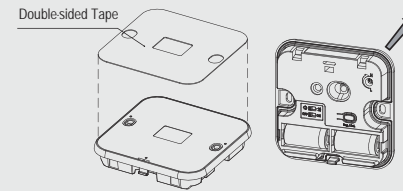

- 4 Set the detection distance as required by adjusting the Sensitivity setting using a screwdriver. Select whether you want detection to be indicated with an LED or a Buzzer, then attach the Upper Cover to the sensor.

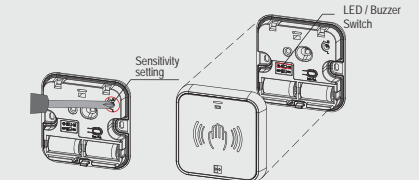

4 Registering the WPS100 transmitter with the R24 receiver

※ Up to 10 AerWave can be registered with one WR-24 receiver.

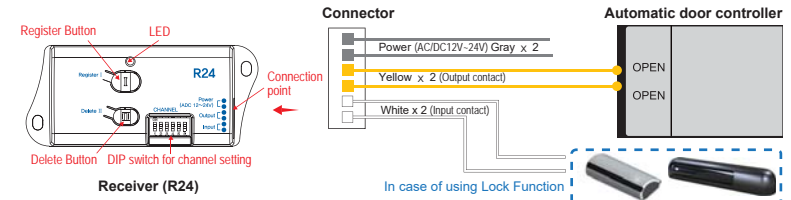

※ Make sure to check that all dip switches are in the down (OFF) position before proceeding

1. How to register an WPS100 Transmitter

- Connect power to the WR-24 receiver.
- Press the Register/Delete button on the AerWave switch for 3 seconds whilst simultaneously pressing the Register I button on the WR-24 receiver.
- The red LED will flash on the WR-24 to indicate registration.

2. How to delete an WPS100 Transmitter

- Connect power to the WR-24 receiver.
- Press the Register/Delete button on the AerWave switch for 3 seconds whilst simultaneously pressing the Delete II button on the WR-24 receiver.
- The blue LED will flash on the WR-24 to indicate deletion.

3. How to delete all registered WPS100 transmitters

- Press the Register I button and Delete II button on the WR-24 receiver at the same time for 5 seconds.
- The blue LED will flash three times indicating that all registered AerWave transmitters have been deleted.



5 Precautions

- 1 Remove the protective film attached to the front plate
- 2 Do not install in places exposed to strong sunlight
- 3 Avoid moving objects in front of the sensor
- 4 Do not install in humid areas

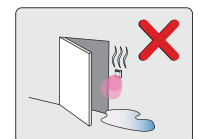
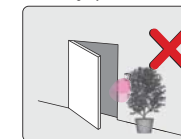
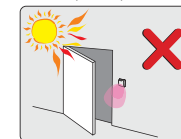

FCC Compliance Statement

This device complies with part 15 of the FCC rules. Operation is subject to the following two conditions: (1) This device may not cause harmful interference, and (2) this device must accept any interference received, including interference that may cause undesired operation.

FCC Interference Statement

This equipment has been tested and found to comply with the limits for a Class B digital device, pursuant to part 15 of the FCC Rules. These limits are designed to provide reasonable protection against harmful interference in a residential installation. This equipment generates, uses and can radiate radio frequency energy and, if not installed and used in accordance with the instructions, may cause harmful interference to radio communications. However, there is no guarantee that interference will not occur in a particular installation. If this equipment does cause harmful interference to radio or television reception, which can be determined by turning the equipment off and on, the user is encouraged to correct the interference by one of the following measures:

- Reorient or relocate the receiving antenna.
- Increase the separation between the equipment and receiver.
- Connect the equipment into an outlet on a circuit different from which the receiver is connected.
- Consult the dealer or an experienced radio/TV technician for help.

FCC Caution

Any changes or modifications not expressly approved by the party responsible for compliance could void the user's authority to operate this equipment. This transmitter must not be co-located or operating in conjunction with any other antenna or transmitter.