

The ONE Polaris Drum ^{TOD1}
User Guide

Packing list

Dear user, after you receive this product, please check whether the following items are included:

Components



• Cymbal*3

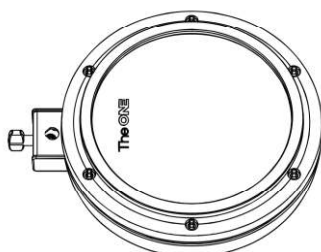

• Snare*1



• Tom*3

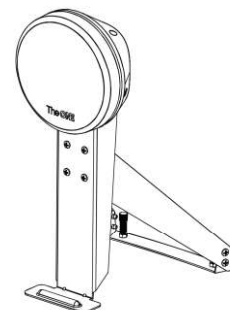

• Kick*1

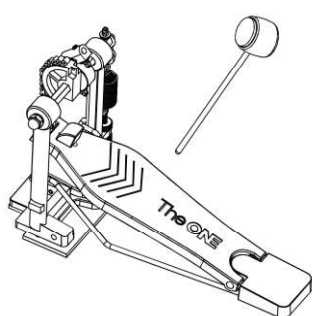

• Kick Pedal*1

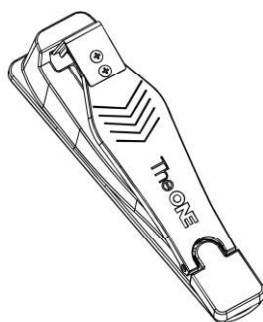

• Hi-Hat Pedal*1



• Drum Module*1

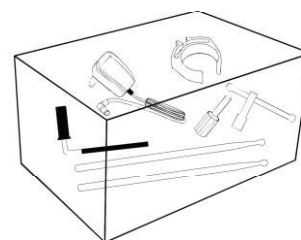

• Accessory Box

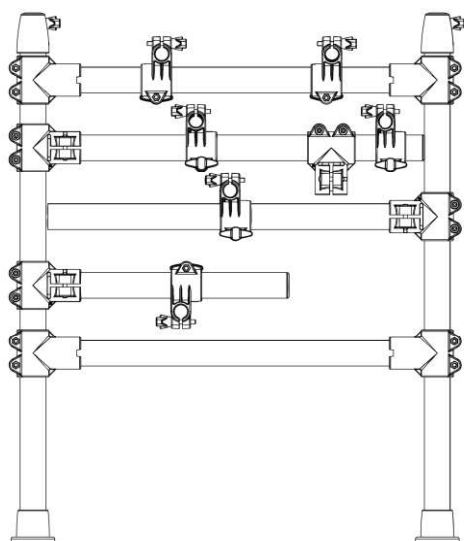

• Drum Rack



• Pillar



• Pillar



• Cymbal Holder*3



• Headphone



• Connection Cable

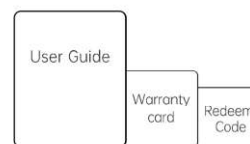

• User Guide

Product Introduction

- TheONE Polaris Drum

TheONE Polaris Drum is an intelligent instrument that teaches people to play drums with a brand-new concept, breaking the traditional electronic drum learning style and interactive way. It is suitable for music lovers and beginners who want to learn drums. It can connect with mobile phones or tablet computer above Android 7.0 and IOS10.0 or above via Bluetooth or dedicated connection cable, together with THE ONE drum learning APP for more functions.

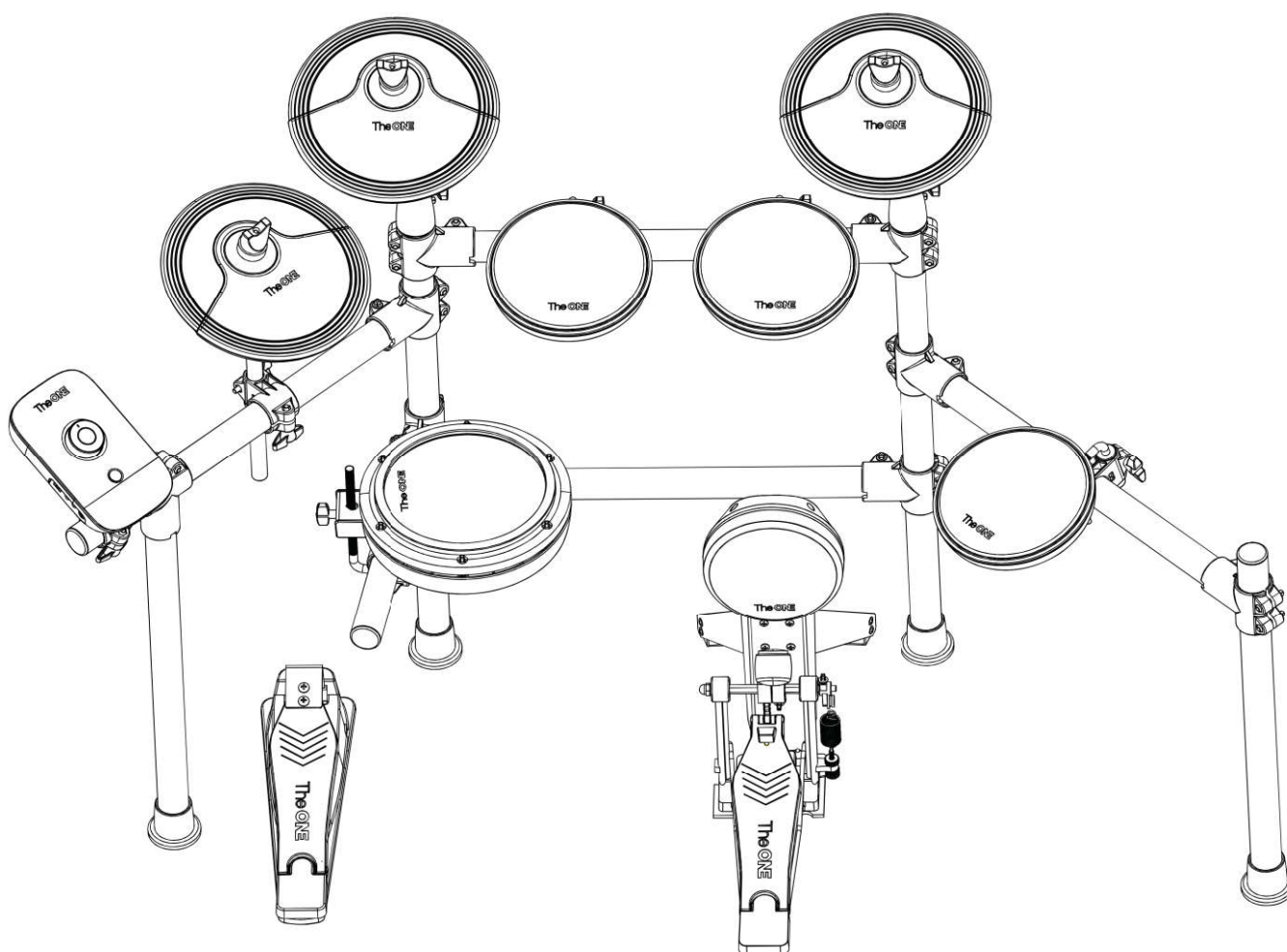

- Have more fun in learning drums with THE ONE's drum learning APP InstaDrum
Please scan the QR code on the right to download and use the APP.



InstaDrum

Parts Guide

Open the accessory box and remove the drum key when you are ready to assemble the smart drum.

Please confirm that the following described parts are in the box.

(Note: There are many spare parts. Each drum and cymbal has its own nameplate on the back, please confirm carefully according to the nameplate)

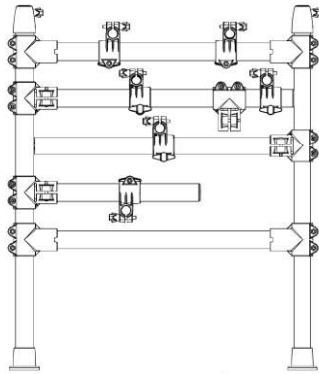

Drum Rack

1



Pillar

2



Pillar

3



Cymbal Holder

4



Cymbal Holder

5



Cymbal Holder

6



Hi-Hat

7



Crash

8



Ride

9

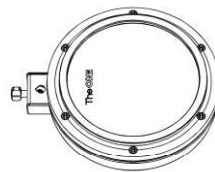

Snare

10



Tom1

11



Tom2

12



Tom3

13



Kick

14

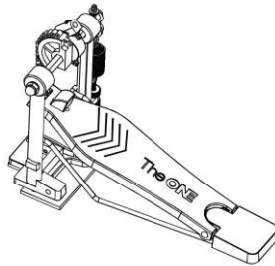

Pedal hammer

15



Beater

16

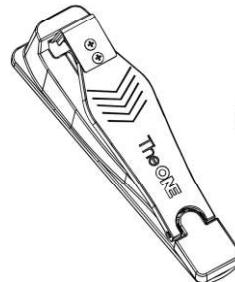

Hit-Hat pedal

17



Drum Module

18



Connection Cable

19



20 L-shaped Holder



21 L-shaped Holder



24 Harness Buckle



25 Harness Buckle



26 Harness Buckle



Hand Bolt

30



Drum Key

32

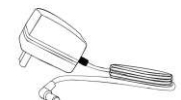

Power Adapter

33



22 L-shaped Holder



23 L-shaped Holder



27 Harness Buckle



28 Harness Buckle



29 Harness Buckle



Hand Bolt

31



34 Data Cable

Packing list

A. Install the drum rack

1. Open the pre-installed drum rack, pull holders **a** and **b** at different angles to the left, and **c** to the right as shown in the illustration below.
2. Insert pillar **2** into the sleeve pipe of holder **a**, and pillar **3** into that of holder **c**. Lock the screw with the drum key **32**.

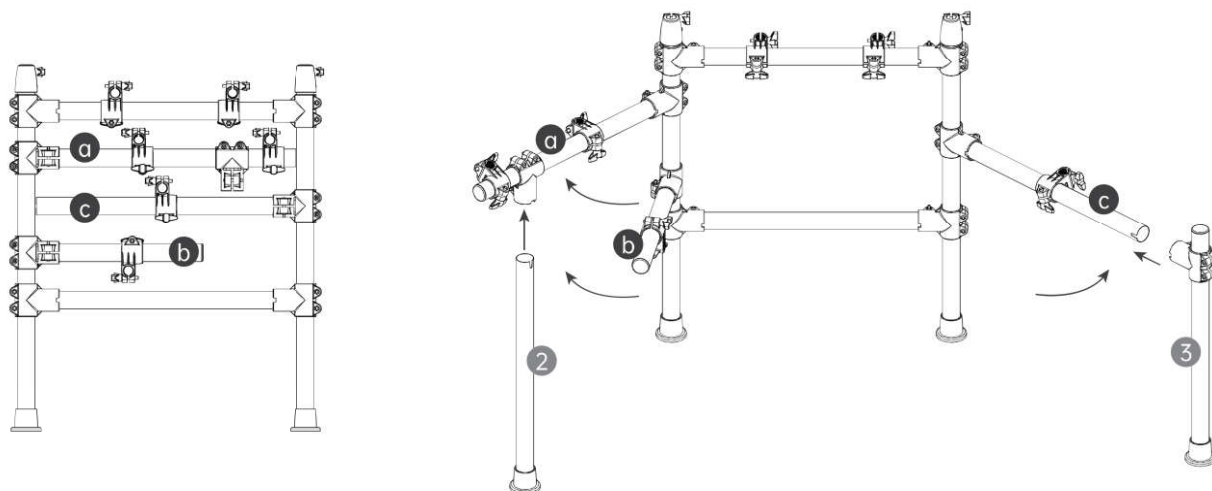

B. Install the holders

1. Insert the cymbal holders **4**, **5**, and **6** into the sleeve pipes and tighten the butterfly nut.
2. Insert L-shaped holders **20**, **21**, **22** and **23** into the sleeve pipe of the drum rack as shown and tighten the butterfly nuts.

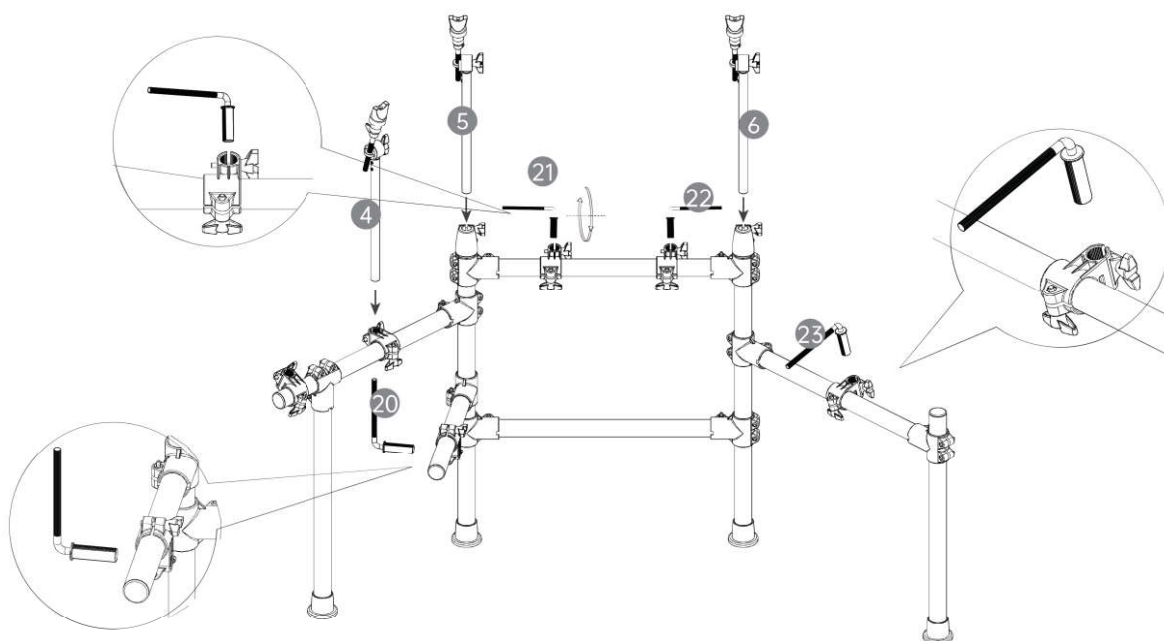

Packing list

C. Install the cymbals

1. Disassemble the nut and felt gasket at the upper end of cymbal holders ④ ⑤ and ⑥ (as shown in the illustration below).
2. Put the "Hit-Hat" cymbal ⑦ into the cymbal holder ④, successively cover the felt gasket, tighten the nut on the top, adjust the position of the cymbal, and tighten to position the butterfly nut.
3. Put the "Crash" cymbal ⑧ into the holder ⑤, successively cover the felt gasket, tighten the nut on the top, adjust the position of the cymbals, and tighten the butterfly nut.
4. Put the "Ride" cymbal ⑨ into the holder ⑥, successively cover the felt gasket, tighten the nut on the top, adjust the position of the cymbal, and tighten the butterfly nut.

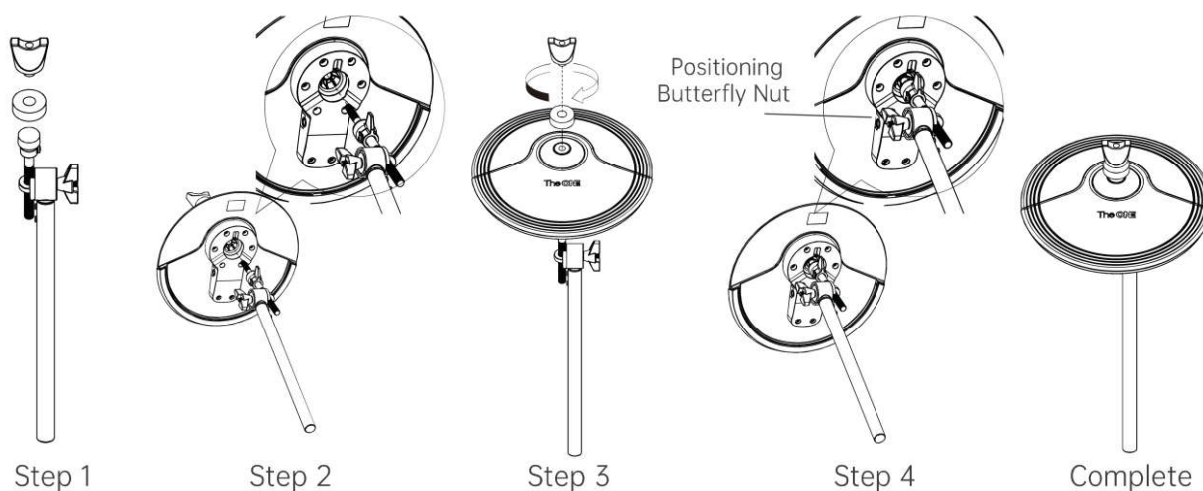

D. Install the drum pads

1. Insert snare drum 10 into L-shaped holder ⑳ of holder ①, adjust to proper position and lock the upper nut of the snare drum ⑩.
2. Insert "Tom Drum 1" ⑪ into L-shaped holder ㉑ on the horizontal holder of the drum rack, adjust to the proper position and lock the upper nut of the snare drum 10.
3. Insert "Tom Drum 2" ⑫ into L-shaped holder ㉒ on the horizontal holder of the drum rack, adjust to the proper position and lock the upper nut of the snare drum 10.
4. Insert "Tom Drum 3" ⑬ into L-shaped holder ㉓ on the horizontal holder of the drum rack, adjust to proper position and lock the upper nut of the snare drum 10.

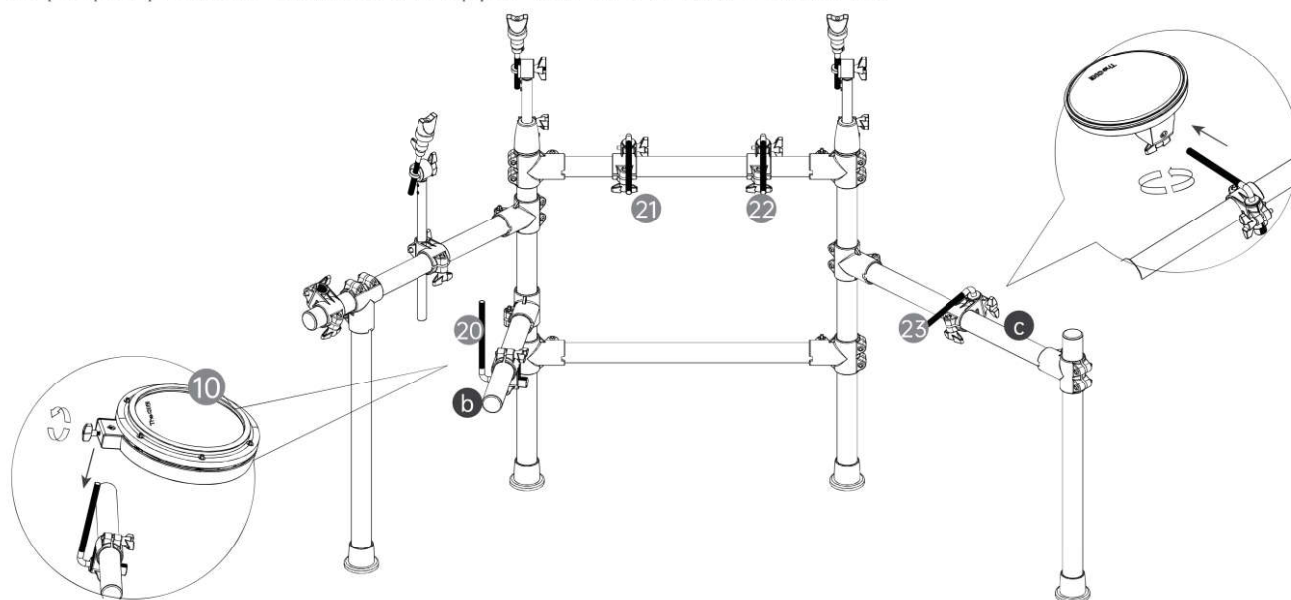

Packing list

Note: The snare drum's surface is in the mesh structure with great tension, which changes with the drum usage time. If the drum's surface is loose and the tension of it is insufficient, the tension can be changed by adjusting the tuning screw.

Operate as follows:

Find the ❸② drum key and slowly adjust each tuning screw in the sequence shown in the illustration below.

During adjustment, the tightness of each tuning screw shall be approximately the same and tightened gradually to make the drum surface's tension uniform.

Note: When adjusting the tuning nut, it shall not be tightened in place at one time, otherwise uneven tension of the drum surface will occur.

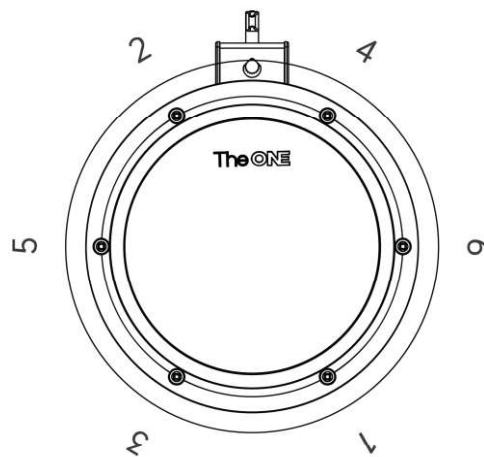

E. Install the drum module

- 1、 Find the connection cable ❶⑨ and drum module ❶⑧ , and insert the plug of the connection cable into the connector of the drum module harness.
- 2、 Take hand bolts ❶⑩ and ❶⑪ and tighten the 2 screws as indicated in the illustration below.
- 3、 After tightening, insert drum module ❶⑧ into the sleeve pipe at the front end of the supporter ❶ⓐ of drum frame, tighten it and to a fixed position.

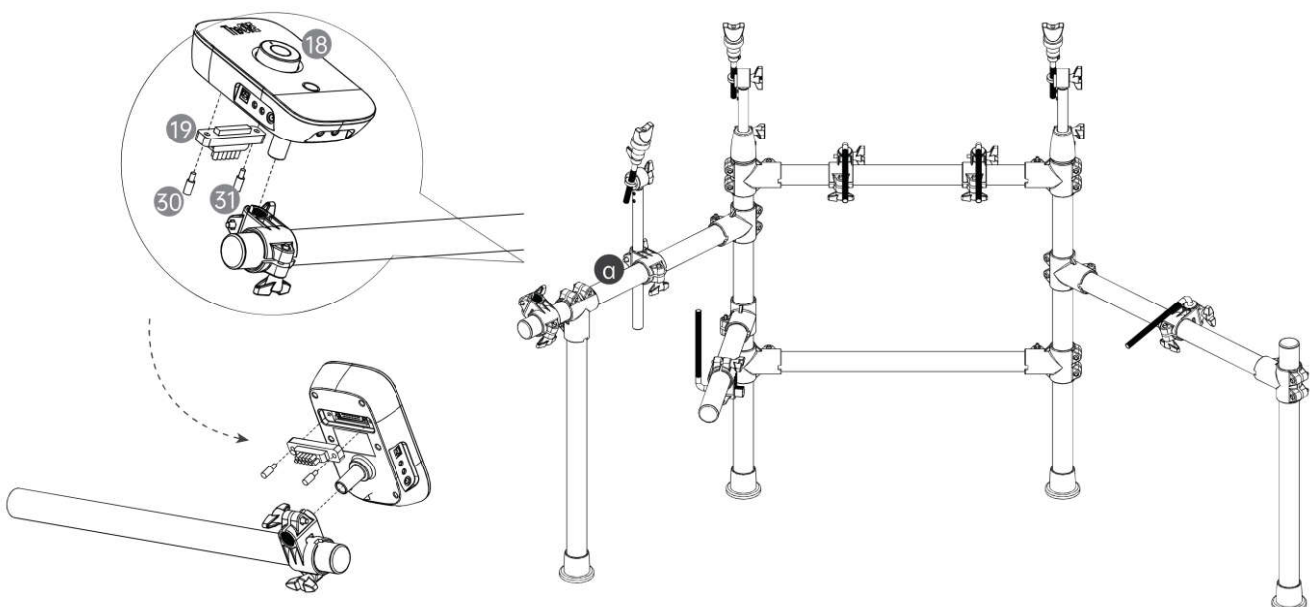

Packing list

F. Install the kick pad and pedal

1. Insert the beater **16** into the interface **15** of the kick pedal, see the illustration below, and then lock the screw with the drum key.
2. Pull the kick pedal **15** on the convex surface of kick pad **14** to make them just get stuck with each other.
3. Hook & loop fastener is provided at the bottom of the kick pedal. In order to prevent the kick pad from moving while using it, the kick pedal can be stuck to the carpet and the set screw of the kick pad can be locked. (see the illustration below)
- 4) Take out the hit-hat cymbal pedal **17** , and there is hook & loop fastener at the bottom of the hit-hat cymbal pedal, which you can stick the hit-hat cymbal pedal **17** to the carpet and fix the pedal position.

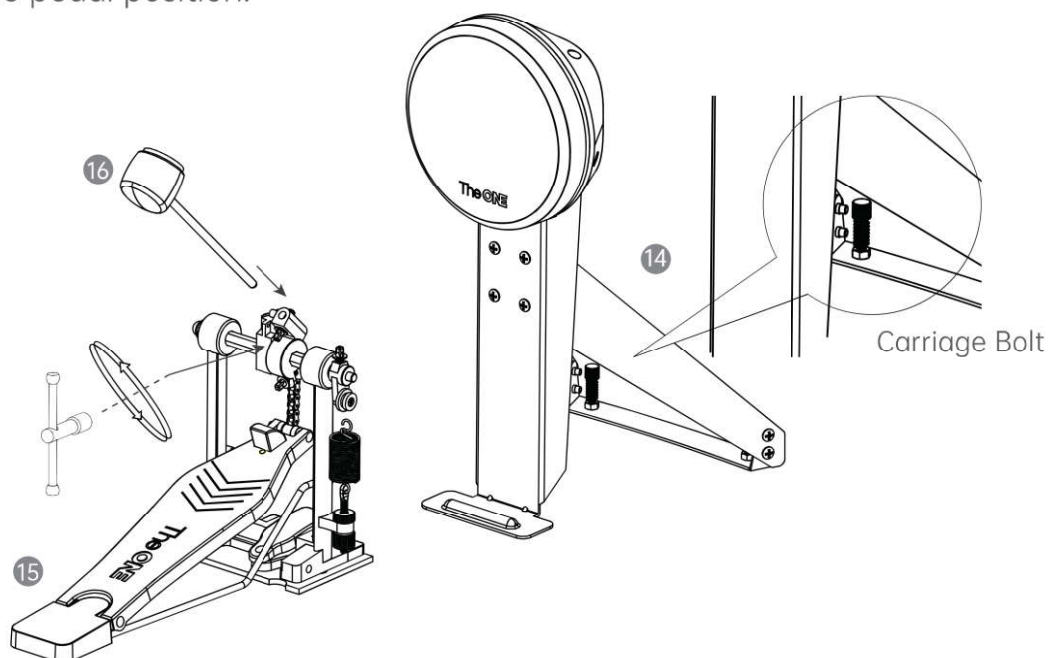

G. Connect the drum module

In order to conveniently connect the drum cable, each connection sleeve pipe of the connection cable plug is marked with the name of the corresponding drum module to be connected, and users can insert them into the drum pad and snare drum one by one according to the corresponding name of the connection cable.

Note: Except for snare drum, other drum pads and cymbals have 1 plug each.

The snare drum has 2 plugs, 1 LED plug and 1 MIDI plug. Please carefully check the name of the jack on the back of the snare drum when inserting plugs (as shown in the illustration below).

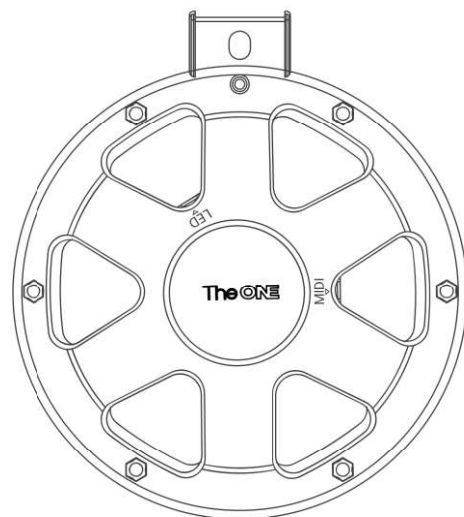

The back view of the snare

User Guide

Drum module Function Panel

- Volume Adjustment Knob

Used for adjusting the volume. Turn the volume clockwise to increase and rotate counterclockwise to decrease the volume.

- Power Switch

Press this button to turn on or off the power supply.

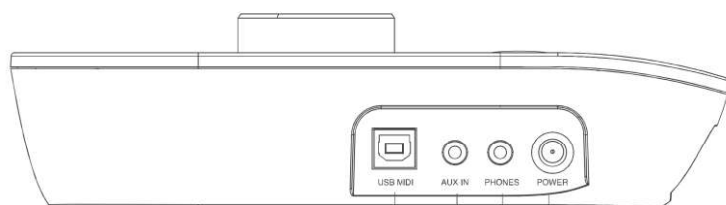
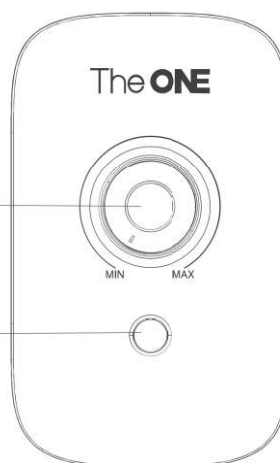

- USB MIDI Interface

The drum module can be connected to a computer or other USB hosts.

- AUX IN Interface

Connect to external audio signals such as MP3. Connect to your.

- PHONES Interface

Connect to stereo headphones.

- POWER Interface

Connect to 12V DC power supply.

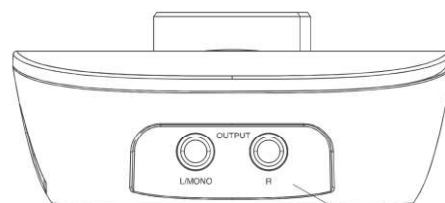

- OUT PUT Port (L/MONO, R)

Connect to audio system or power amplifier equipment. Connect to L/MONO and R jacks if it is stereo output; Connect to the L/MONO jack only if it is mono output.

Powering On

1. Take out the power adapter and plug into the POWER INTERFACE of the jack panel on the left side of the drum module. Insert the other end into the socket.

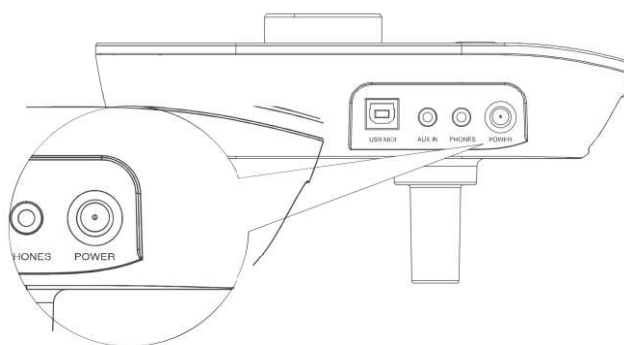

2. Press the power switch of the drum module, and the drum set lights up and flashes.

Note: This product has full-drum lighting and flashing effect during switching on and off; This product has no loudspeaker. After hitting, there is no sound when beating on the drum surface, which is normal. If you want to experience the sound of the product, please plug in the headphone.

Device Connection

• Connect headphones

This product has no loudspeaker, headphones should be inserted when being used to hear the drum sound.

Note: Using headphones at high volume for a long time will cause ear fatigue and hearing damage. The headphone jack of this product is the typical 3.5mm stereo headphone jack.

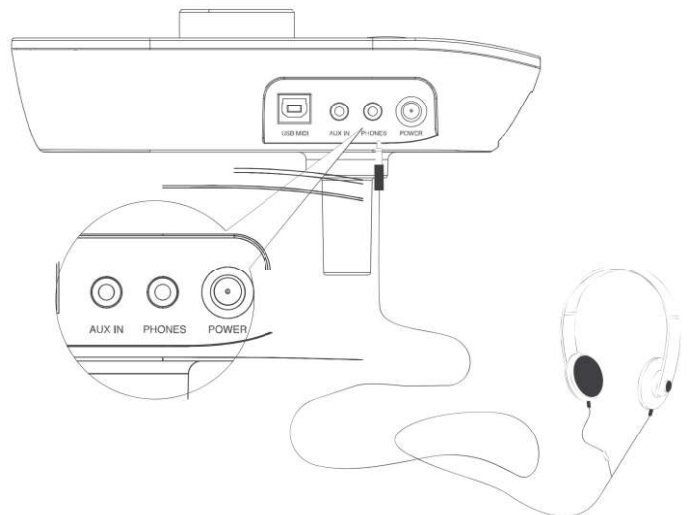

• Connect smart devices

We are dedicated to creating a new type of intelligent instrument integrating networking, learning and entertainment, to make users play drums with great fun. When connecting to your mobile device via Bluetooth or a dedicated data cable, you'll find more unexpected surprises.

• Data cable connection

This products comes with a dedicated data cable.

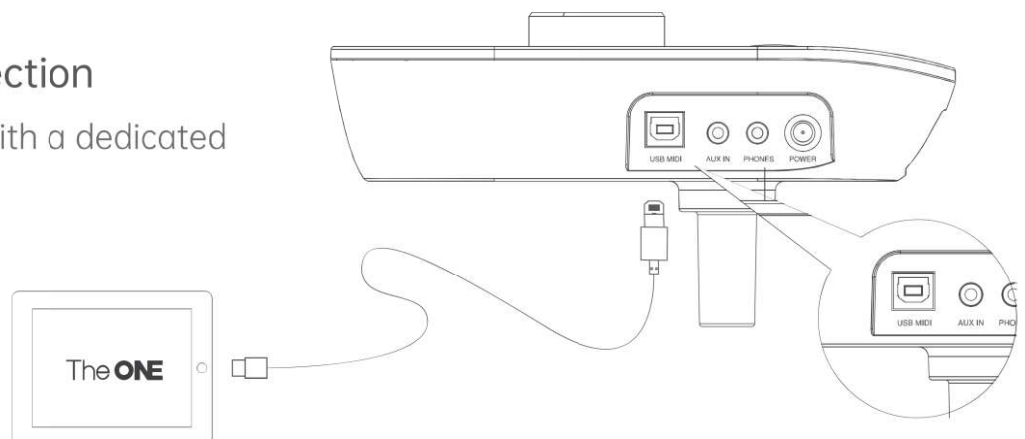

• Bluetooth connection

This product's dual-mode Bluetooth can simultaneously connect to audio and MIDI signals.

Operating procedures are as follows:

Bluetooth audio connection:

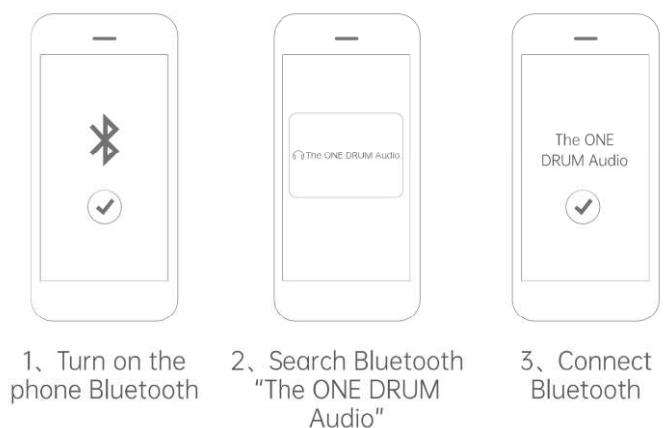

Device Connection

Bluetooth MIDI Connection:

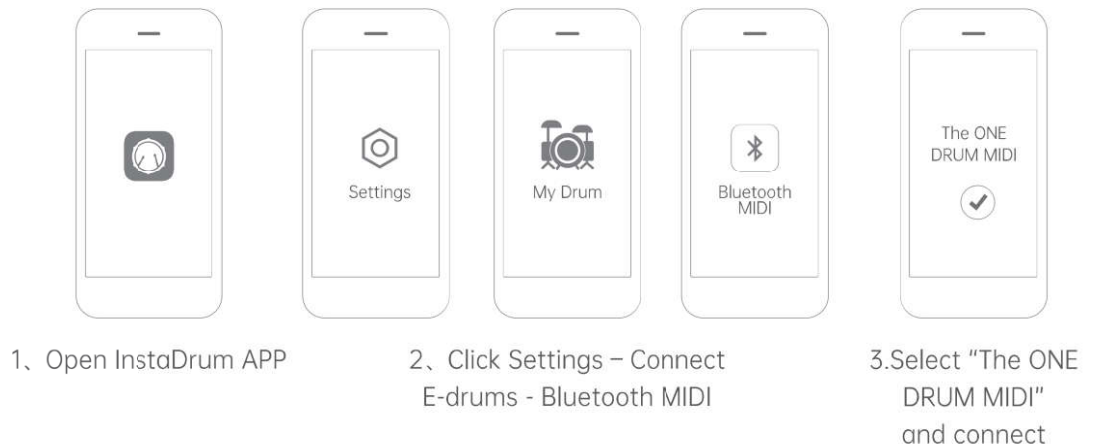

• Bluetooth dual-mode signal transmission

This instrument can be connected to your smart device, and you can learn and play drums with music in the "InstaDrum" APP wirelessly.

Note: When connecting your drum set to InstaDrum through Bluetooth for the first time, you can go through the Bluetooth delay calibrating according to the APP prompt. This will improve your playing experience with InstaDrum.

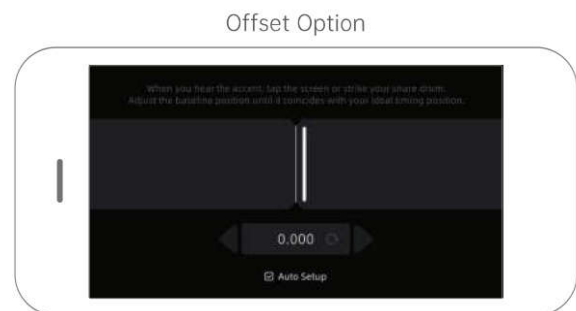

• Dual transmission of USB MIDI and Audio data

Connect this instrument to the smart device, the music of the smart device and the sound of your beating on the drum are all transmitted from the headphones or the connected loudspeaker.

• Connect audio equipment

The audio system or amplifier can be connected via the 6.35mm OUT PUT interface at the bottom of the drum module.

Note: Before connecting other devices, make sure that all devices are powered off. Also, when turning on the device, make sure that the volume of each device has been adjusted to a minimum.

Extended functions

In addition to the built-in functions of the drum module, you can connect the product to the "InstaDrum" APP for more extended functions.

- **Choose rich playing sounds**

Connect to the "InstaDrum" APP through Bluetooth Midi or data cable. In the APP, you can select 308 playing sounds (main sounds, auxiliary sounds, and effect sounds) and 8 sets of hit-hat sounds, which can well satisfy your performance needs.

- **Drum Group Settings**

This product has the function of drum kit selection. Connect InstaDrum APP and select drum set in the APP; It includes 25 preset drum kits and 9 GM drum kits.

- **Drum kit sound control**

The volume of the drum pad can be adjusted in the APP and you can adjust a certain drum pad.

- **Store user-defined drum kit sound**

The APP can store 5 sets of user-defined drum kit sounds.

- **Initialization function**

This product is equipped with initialization function, and users can operate the drum module to restore factory settings in the APP.

- **Automatic switch-on/off**

This product automatically powers off after 30 minutes of no operations by default; This function can be turned on/off and adjusted in the APP.

- **Triggering Function Settings**

This product is equipped with trigger performance setting. The users can adjust the drum sensitivity parameter and velocity curve, and adjust the crosstalk value and anti-jamming value to prevent double sound and crosstalk.

- **Lighting function**

This product's lighting mode can be set in the APP, such as full-light hitting and lighting after hitting.

Download "InstaDrum" APP for to discover and experience more cool features.

Details such as the connection version of APP and Smart Device can be consulted with Customer Service.

Product Specifications

Maximum Polyphony	64
Weight	25.5kg
Connection Mode/ Equipment	Data Cable Connection/Dual Bluetooth Connection iOS System 10.0 and above, and Android 7.0 and above, support USB Host/OTG Support Bluetooth EDR/BLE5.1 device connection
LED	LED of 8 colors
Interface	DC Power Interface, 12V
	1 Headphone interface, 3.5mm
	1 AUX IN interface, 3.5mm
	2 OUT PUT interfaces, 2*6.3mm
	USB MIDI Interface
	Drum Harness Interface
Bluetooth	Dual Bluetooth
Lighting Effect during Switching On/Off	The whole module is lightened with flash during switching on
	The whole module's light goes dim gradually during switching off
Data Cable	USB MIDI to TYPE-C Interface

* Warm Tips: In case of any change in specifications, the actual commodities shall prevail, and The ONE has the final interpretation right to the product.

Troubleshooting

Issues	Causes and Solutions
After powering on, there is no sound from the drum module.	This product has no loudspeaker. You can plug in the headphone or external audio.
After powering on, the snare drum doesn't light up.	Check whether the connection cable of the MIDI interface and the LED interface of the snare drum is wrong.
After hitting the kick pad, other cymbals or drum pads sound simultaneously.	Check whether the kick pad is flattened against the drum rack, and whether the force of foot on the kick pad is strong. If the kick pad is flattened against the drum rack, the kick pad after being beaten will cause resonance and the shake of drum rack, which is easy to cause consequent noise.

• FCC Caution:

Any Changes or modifications not expressly approved by the party responsible for compliance could void the user's authority to operate the equipment.

This device complies with part 15 of the FCC Rules. Operation is subject to the following two conditions: (1) This device may not cause harmful interference, and (2) this device must accept any interference received, including interference that may cause undesired operation.

• FCC RF Radiation Exposure Statement:

- 1 This Transmitter must not be co-located or operating in conjunction with any other antenna or transmitter.
- 2 This equipment complies with RF radiation exposure limits set forth for an uncontrolled environment.
- 3 This equipment should be installed and operated with minimum distance 20cm between the radiator & your body.

Note: This equipment has been tested and found to comply with the limits for a Class B digital device, pursuant to part 15 of the FCC Rules. These limits are designed to provide reasonable protection against harmful interference in a residential installation. This equipment generates, uses and can radiate radio frequency energy and, if not installed and used in accordance with the instructions, may cause harmful interference to radio communications. However, there is no guarantee that interference will not occur in a particular installation. If this equipment does cause harmful interference to radio or television reception, which can be determined by turning the equipment off and on, the user is encouraged to try to correct the interference by one or more of the following measures:

- Reorient or relocate the receiving antenna.
- Increase the separation between the equipment and receiver.
- Connect the equipment into an outlet on a circuit different from that to which the receiver is connected.
- Consult the dealer or an experienced radio/TV technician for help.

CONTACTUS:

Tel:833-970-2670(US)

E-mail:Support@theonemusic.com

Web:www.theonemusic.com

Note: This product will be constantly updated and optimized. The manual may not be synchronized with the product update in time. Please understand.

The **ONE**

NO.TOD12303009