

Safety



This section covers safety-related information, so please read it carefully before riding.

The basics

- Please comply with the local road and traffic laws in your country or region.
- Wear a helmet that meets the latest safety testing standards, and follows the helmet manufacturer's instructions for use. It may help prevent injury in an accident.
- Wear appropriate safety equipment according to the riding you plan to do.
- Do not ride while intoxicated or while using medications that can make you drowsy or less attentive.
- Refer to the previous two sections to check the bicycle before riding it.
- Brake discs will become hot during use and will stay hot for a short period of time. Ensure you do not touch the discs right after use.
- Do not park the bicycle in building lobbies, on evacuation stairs, fire exits or on sidewalks.
- Once you have come to a stop, do not apply pressure to the pedals, this could engage the power assist function. Or you can hold the brake lever firmly to ensure that the power is cut off.
- During folding and unfolding, as well as during use and maintenance, avoid putting your hands or fingers anywhere they may be caught or trapped.
- It is recommended that the bicycle shall be used by users over 16 years old, younger users must use the bicycle under the guidance of an adult or guardian.
- Only use the supplied charger cable and plug. Ensure the charger cable is fully inserted in the charger before connecting the charger to a power outlet. Plug the charger's plug into an outlet (100-240V), using the appropriate plug / adaptor for the country's standards, then connect to the charging socket on the battery.
- If there is any damage to the protective layer of the wire harness of the bicycle, please contact Honbike as soon as possible to prevent injury to the user.

Safe riding

- During the ride, please stay focused, watch out for passing pedestrians and vehicles, and keep a safe distance.
- During the ride, please do not hang anything on the handles to avoid losing control of the bicycle and causing an accident.
- When braking, please avoid sudden braking, try to reduce speed slowly. Please use the rear brake first, and then the front brake. Do not brake too hard. Braking sharply on the front wheel may cause the bicycle and rider to lose grip and cause injury, and braking sharply on the rear wheel may cause a change of direction and injury.
- Please keep a reasonable safe distance while riding between yourself and motor vehicles. Do not follow them too closely as they may slow down and turn at any time.
- When riding, keep a distance from motor vehicles parked on the roadside and be aware of car doors opening suddenly to avoid crashing into them.
- Please do not wear earphones or headphones that can affect your hearing during the ride.
- Please ride along in a straight line in designated bicycle lanes. Please ride with the flow of traffic and do not travel against it.
- It is prohibited to ride up and down stairs or jump over any obstacles on the HF01.
- It is forbidden to ride without holding the handles or when holding an umbrella. Failure to keep your balance may result in an accident.
- Do not use HF01 with bicycle trailers, mounts, frames or accessories that have not been tested for safety and compatibility standards by Honbike.
- After any accident, you must consider that the current HF01 is unsafe. Contact Honbike for a maintenance check, and confirm that it is safe before you can ride the HF01 again.
- Ride defensively. Make others aware of your presence and avoid entering any vehicle's blind spot. Remember to avoid accidents by using your bicycle bell and brakes.
- Do not ride while intoxicated or while using medications that can make you drowsy or less attentive.

Riding in bad weather conditions

- Rain, snow, slippery roads and other conditions will affect the braking effect and increase the braking distance, so please brake early in these situations.
- Riding on slippery roads can make it difficult for you and other riders to control speed, and you are more likely to slip in turns. So you need to stay alert, watch out for oncoming vehicles, reduce your speed and make sure you can brake safely.
- When you are wearing a raincoat, pay close attention to avoid the raincoat being caught in the wheels or being hooked by any stationary or moving vehicles.
- Try not to ride in heavy rain and standing water. If it is cold, and the temperature is near or below the freezing point, pay attention to ice on the road and avoid drain/ man hole covers.
- Honbike HF01 can withstand light rain and small splashes. The electrical parts of HF01 have an Ingress Protection rating of IP65. But it does not mean that the bicycle and its mechanical and electrical components are waterproof. We do not recommend storing or using the bicycle in excessively wet conditions. The warranty for the HF01 does not cover water damage.

Riding in low light conditions

- Riding at dusk, at night, or in any poor light conditions is much more dangerous than in daytime, please ride more cautiously, and choose appropriate products to aid your vision and make yourself more visible.
- Ensure your front and rear lights are turned on and adjusted such that other people on the road can see them clearly.
- Make sure both front and rear reflectors are clean, undamaged and visible before riding off.



Removing lights and reflectors can reduce your visibility to others and could result in an accident that may cause injury or death.

Maintaining your Honbike



Please visit the official website at www.honbike.com for the latest and important information about products, manuals and maintenance activities before trying to maintain your HF01.

Compared with conventional ebikes, the Honbike HF01 is low maintenance with fewer complicated parts that require less attention for simplicity. After riding for a period of time, like any bicycle, some parts may loosen, wear or become damaged, so inspection and maintenance at regular intervals will extend the service life of your HF01 and prevent damage and potential accidents.

Store your Honbike HF01 in a clean, dry place to avoid rust and corrosion.

The maintenance of HF01 is generally divided into the following tasks:

- **Cleaning:** Wipe the whole bicycle and parts with a damp rag and a low residual cleaner. Dry your HF01 thoroughly after cleaning to prevent corrosion and rust. Remove any oil residue on the brake discs.
- **Inspection:** Brakes, tires and lights should be inspected regularly. Please refer to the sections "Before the First Ride" and "Before Every Ride".
- **Tightening:** The fasteners of the whole bicycle should be tightened periodically by referring to the section of **Recommended Torque Values**.
- **Lubricate:** Clean and lubricate the following moving parts regularly.



- **Adjustment:** Brakes should be adjusted periodically. Ensure front and rear brakes work properly. Check brake cable tension, replace brake cables if necessary.

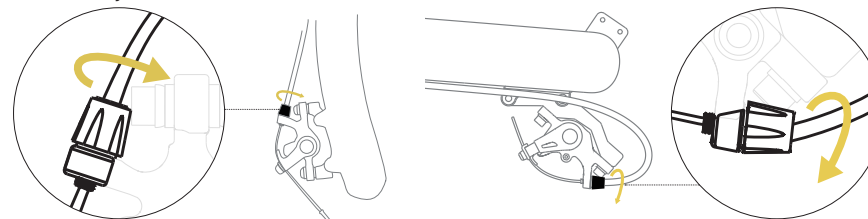

- **Replacement:** If a part is damaged or unusable or has any cracks, scratches or color changes, the part has reached the end of its service life and should be replaced promptly.

Service interval

The user shall be responsible for safe riding and regular maintenance. Your bicycle needs a regular service. Below is our recommended service frequency based on how often you ride.

Monthly (or every 500kms/ 300 miles)

- Check tire pressure. Press the tires with your thumbs, which shall be solid and firm. If the tire pressure is insufficient, inflate to an air pressure of 3.4-3.6 bar, avoid over inflating your tyres.
- Clean and lubricate moving parts regularly.
- Check that all hardware is tightened to the torque specifications listed in the **Recommended Torque Values** section of this manual.
- Check your brake pads for signs of wear. Replace if necessary.
- Check the frame, front fork and kickstand for any damage, deformation or cracks.
- Check all wiring harnesses (such as brake wires, front light wires and rear light wires) of the whole bicycle for any damage or wear.
- Check the charger and its wiring harness for damage and check if the bicycle can be charged normally.

Quarterly (or every 1500kms/ 900miles)

- Check all items on the monthly service list above.
- Check tire tread for excessive wear. Replace if necessary.
- Check and update to the latest firmware version.



This maintenance interval is based on normal usage. If you ride your Honbike HF01 more than average, or in rain, snow, or bad road conditions, maintain your bicycle more often than the suggested interval.

Replacing parts

Except for the tires, brake pads and brake discs that are commercially available in the market, all other parts of HONBIKE HF01 are specially designed by Honbike. If your parts fail, please contact Honbike for support.

(Tire: 20 x 2.125; Brake disc: diameter \varnothing 160mm)

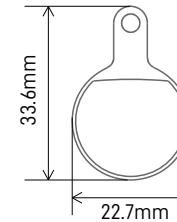

Front brake pad
Thickness: 4mm

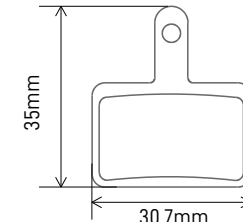

Rear brake pad
Thickness: 4mm

Other parts: brake levers, grips, bell, crank, folding pedals, folding stand, front fender, rear fender, front light, rear light, disc brakes, brake pads, kickstand, saddle & seat post set, charger.



Please use Honbike original parts only. If you use parts not approved by Honbike, you will solely be responsible for any consequences, damage or accidents caused.

Maintenance notes

- Please do not replace any parts or change battery capacity or motor power unless instructed to do so by Honbike to avoid damage and danger. If you have made any changes without permission, you shall solely be responsible for any consequences.
- Honbike HF01 is equipped with a high speed motor, when you roll the bicycle backward, you will feel resistance at the front hub motor and may accompany with a sound, which is normal; when you are pushing the bicycle forward, this phenomenon will not occur. If the motor makes a sound when the bicycle is pushed forward, it means the internal clutch of the motor is malfunctioning, please contact us as soon as possible.
- When cleaning Honbike HF01, do not pour water directly on the bicycle to prevent water from entering some parts and affecting the performance and life of the bicycle; do not use steam or high-pressure water guns when washing the bicycle.
- After cleaning the bicycle or riding it in water, pay special attention to the working condition of the brakes. Cleaning it with water or riding it in water may reduce the braking effect. In such case, you should ride slowly and pay attention to your safety.

Warranty

Please go to www.honbike.com to view the latest warranty terms.

Honbike warrants each new frame, front fork, handlebar, and original components against defects in workmanship and materials

For two years:

- Frame, Front fork and Handlebars

For one year:

- All original parts, such as battery, charger, motor

This warranty is expressly limited to the repair or replacement of a defective item and is the sole remedy of the warranty. This warranty commences from the date of purchase.

Claims under warranty will only be valid with proof of purchase and frame number of Honbike products through the Honbike official website or Honbike authorized dealers for the original owner only. Warranty is not transferable.

Register your Honbike

To ensure the validity of your warranty, please register your account and your bicycle through the Honbike APP before you use your Honbike. This enables us to contact you if needed and provide important information related to the safety of our products.



The Owner's Manual is labeled with a unique frame number and validation number on the back. Please keep the two numbers safe. They are proof of your bicycle ownership.

Warranty notes

- Users shall follow the instructions for proper operation and use of the bicycle. Any unreasonable, reckless use or modifications may invalidate the warranty.
- Our company will perform warranty obligations for any performance failures caused by product quality issues.
- Should a product defect become known, the owner should stop riding the bicycle and transport the bicycle or part(s) to Honbike for warranty repair (within the applicable warranty period). The transport of the bicycle or any bicycle part to and from Honbike is the owner's responsibility and at the owner's expense.



Please visit Honbike.com to find out how to pack your Honbike HF01 to ensure safe transport.

- Upon receiving your bicycle, please check and test it immediately. We will replace any parts deemed to have been damaged during shipping. Shipping damage must be reported to Honbike within 5 working days of shipment arrival, please preserve evidence of any damage. This applies to all products including bicycles and accessories. You will NOT be refunded or compensated for your time or labour replacing damaged parts.
- Bicycles or parts returned without proper documentation may result in delayed service or denied warranty coverage. Warranty return shipping costs along with duties and taxes are the responsibility of the claimant. All unauthorized returns will be refused.

Exclusions

- Malfunction due to the user's failure to use, maintain and adjust the bicycle in accordance with the provisions of the Owner's Manual.
- Malfunction caused by the user's unauthorized assembly, change or addition of parts and non-compliance to the user rules.
- Malfunction caused by improper installation, use, or storage by the user, or by collision.
- Bicycles for which proof of purchase, frame number and other relevant documents cannot be provided.
- Normal wear and tear on parts such as tires, brake pads and paint are not covered by the warranty.
- Damage caused by water such as rusting and or corrosion.
- Bicycle loss or theft.

Special notes

Our liability is limited to repair or replacement of the product. If you need any repair service outside of the warranty period, you will be charged for the appropriate parts, labor and shipping costs.

In the event of a conflict between this warranty statement and the laws in force at the place of sale, the laws in force shall prevail. Our company reserves the right to amend the above terms and conditions without prior notice. If any part of this warranty does not comply with local law, then it shall be deemed separable from the rest of this warranty, which remains enforceable and shall be interpreted as the closest meaning of that written above, in English, or the minimum required by such local law.

This warranty does not affect the statutory rights of the consumer.

Disclaimer

Declaration of conformity

This declaration relates exclusively to the machinery in the state in which it was placed on the market and excludes components which are added and/or operations carried out subsequently by the final user. The declaration is no longer valid if the product is modified.

Honbike declares that HF01 conforms to the requirements of: Machinery Directive (2006/42/EC), the EMC Directive (2014/30/EU), and the Radio Equipment Directive (2014/53/EU), and DIN EN 15194:2017.

Federal Communications Commission (FCC) Compliance Statement for USA

This device complies with part 15 of the FCC rules.

Caution: Changes or modifications not expressly approved by the party responsible for compliance could void the user's authority to operate the equipment.

Operation is subject to the following two conditions: (1) This device may not cause harmful interference, and (2) this device must accept any interference received, including interference that may cause undesired operation.

Note: This equipment has been tested and found to comply with the limits for a Class B digital device, pursuant to part 15 of the FCC Rules. These limits are designed to provide reasonable protection against harmful interference in a residential installation. This equipment generates, uses, and can radiate radio frequency energy; if not installed and used in accordance with the instructions, it may cause harmful interference to radio communications. There is no guarantee that interference will not occur in a particular installation. If this equipment does cause harmful interference to radio or television reception, which can be determined by powering the equipment off and on, the user is encouraged to try to correct the interference by using any of the following measures:

- Reorienting or relocating the receiving antenna.
- Increasing the separation between the equipment and receiver.
- Connecting the equipment into an outlet on a circuit different from that to which the receiver is connected.
- Consult the dealer or an experienced radio/TV electronics technician for help.

The distance between user and radiator should be no less than 20cm.

Prop 65 Warning

This product can expose you to chemicals including lead, which is known to the State of California to cause cancer and birth defects or other reproductive harm. For more information go to: <http://www.p65warnings.ca.gov>.

Liability Disclaimer

The specifications, information and performance regarding the HF01 in this document are subject to change without notice. It is the buyer's and/or rider's responsibility to determine the correct and safe selection of settings and conditions of use of the products and to periodically check the products for secure and proper operation.

To the extent that the law permits, any liability which may be incurred as a result of the use of a product manufactured by or sold under license granted by Honbike is limited to the cost of repairing or replacing the failed product or component at the discretion of Honbike, either within or outside of warranty periods, and does not extend to any loss or damage which may be caused as a consequence of misuse or failure of the products.

Legal

The HF01 is a 250W pedal-assist electric bicycle (Pedelec). Each country has its own guidelines around cycling, which we highly recommend reviewing before riding your Honbike.

If you want to use your bicycle on public roads, it has to comply with the respective legal requirements. These requirements may vary in each country. The fittings of your pedelec are, therefore, not necessarily complete. Inform yourself about the laws and regulations applicable in your country or in the country you intend to use the HF01 pedelec. Have your pedelec equipped accordingly before using it on public roads.

Frame Number

Validation Code

