

## Operation (continued)

### 3 Setting The Airflow Direction

- Choosing the correct airflow direction of the ceiling fan will enhance the fan's performance and make its use more enjoyable. To change the direction of airflow, use the remote control.



**NOTE:** The ceiling fan will first come to a complete stop in 1 or 2 seconds before changing the fan's direction.

- Aim the remote control at the remote receiver position and press the **AIRFLOW DOWN** button to provide a downward air flow. In warmer weather, this direction will provide a constant breeze, creating a wind chill effect for the room's occupants.

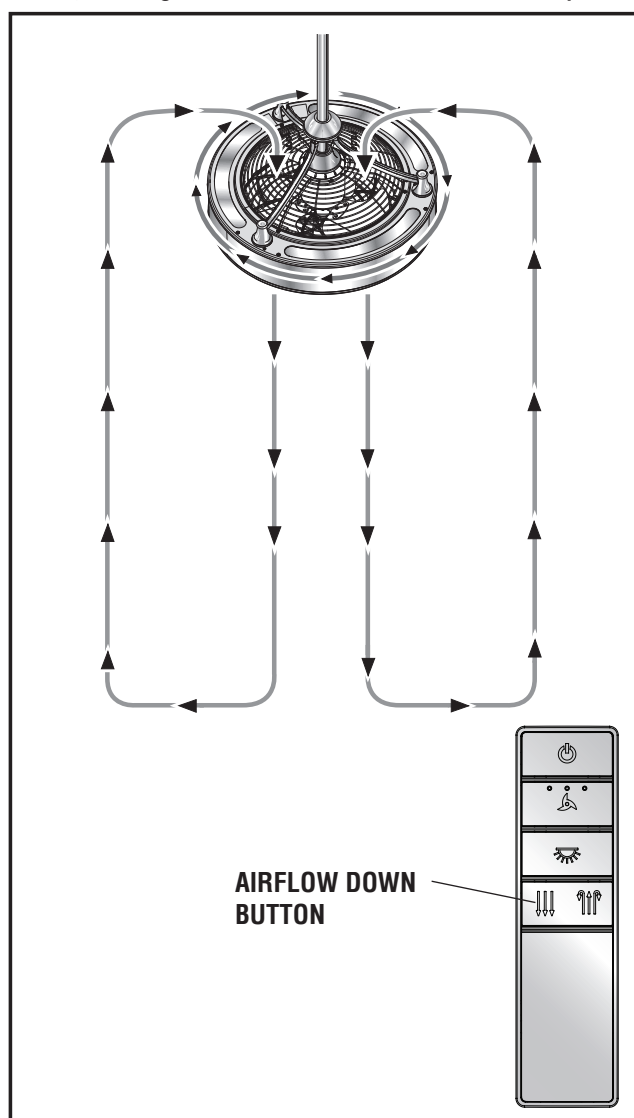

- In cooler weather, aim and press the **AIRFLOW UP** button on remote control to provide an upward direction of air travel. This will help circulate warm air off the ceiling and back down into the room.

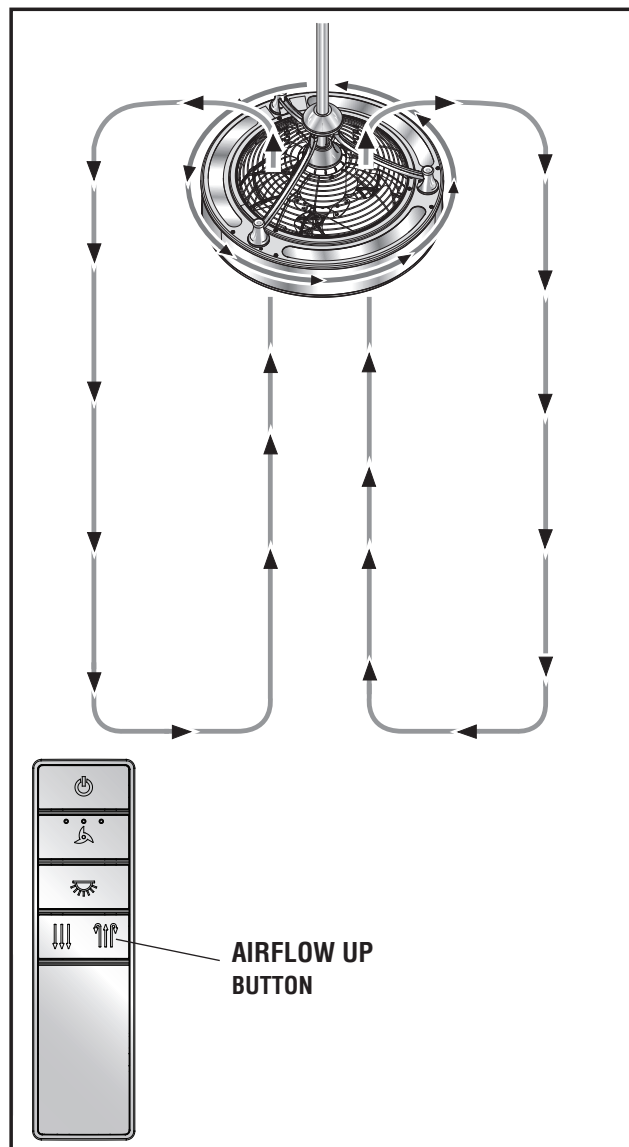

# Maintenance

## GENERAL CARE AND CLEANING

- Due to the natural movement of a ceiling fan, connections can become loose over time. Check all the ceiling fan's connections (not including the electrical connections) at least twice a year.
- The fan has permanently lubricated sealed bearings, therefore no further lubrication is required.
- Clean your fan periodically to help maintain its new appearance over time. Use only a soft brush or lint-free cloth to avoid scratching the finish. The plating is sealed with a lacquer to minimize discoloration or tarnishing. Do not use water when cleaning, as this could damage the motor or cause an electrical shock. When shipped, the blade and guard on the ceiling fan are preassembled. To disassemble for cleaning purposes:



### WARNING

Turn off power to room and wall switch by removing fuses or turning off circuit breakers as needed before disassembling the ceiling fan. Failure to do so can cause serious personal injury.

- Remove the screws (CC) securing the decorative grill (Z), then remove the decorative grill (Z).
  - Remove the guard screws, then remove the blade guard (Y).
  - Remove the set screws at the top of the blade (X) head using a 3 mm hex wrench (not provided).
  - Remove the blade (X) from the motor shaft (W).
- To reassemble the fan:**
- Reinstall the blade (X) on the motor shaft (W) so the shaft (W) opening on the blade (X) straddles the recessed area on the blade shaft (W).
  - Reinstall the set screws and tighten securely.
  - Reinstall the blade guard (Y) and guard screws; tighten securely.
  - Reinstall the decorative grill (Z) and screws (CC); tighten securely.

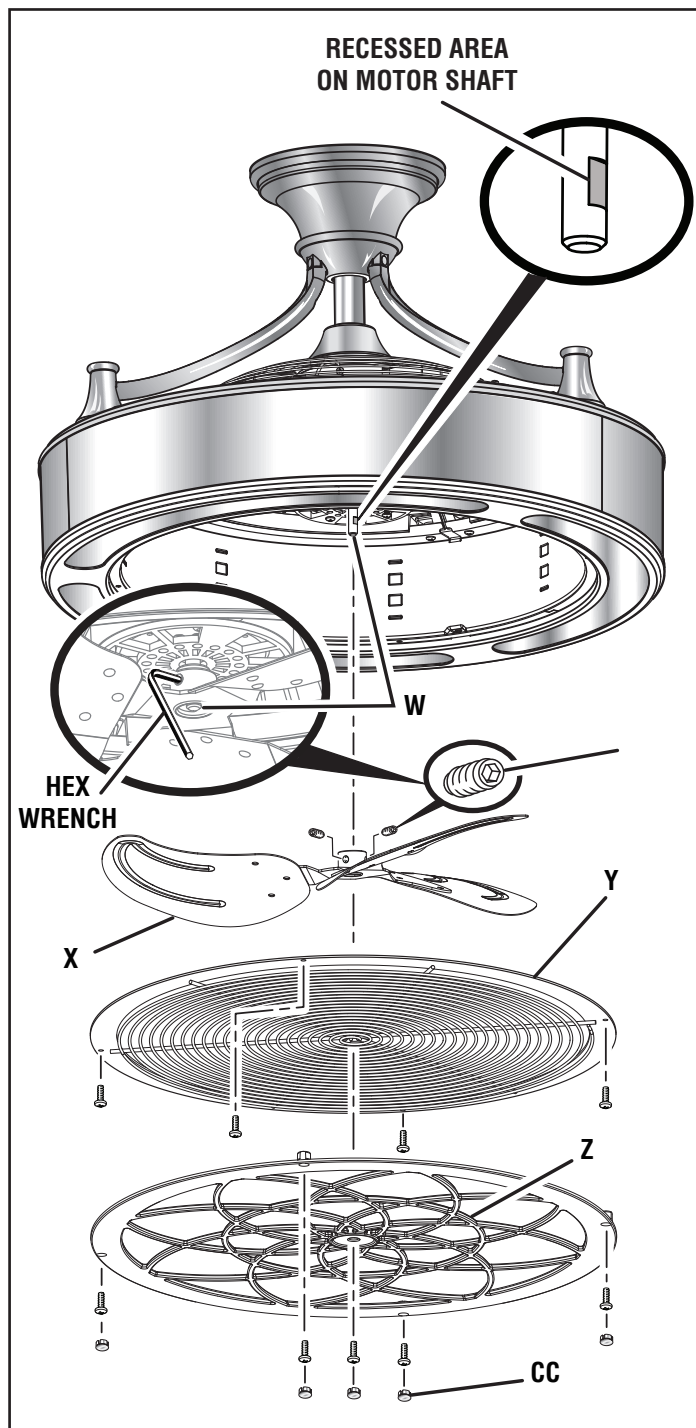

## FCC Statement

---

This equipment has been tested and found to comply with the limits for a Class B digital device, pursuant to Part 15 of the FCC Rules. These limits are designed to provide reasonable protection against harmful interference in a residential installation. This equipment generates, uses and can radiate radio frequency energy and, if not installed and used in accordance with the instructions, may cause harmful interference to radio communications. However, there is no guarantee that interference will not occur in a particular installation. If this equipment does cause harmful interference to radio or television reception, which can be determined by turning the equipment off and on, the user is encouraged to try to correct the interference by one or more of the following measures:

- Reorient or relocate the receiving antenna.
- Increase the separation between the equipment and receiver.
- Connect the equipment into an outlet on a circuit different from that to which the receiver is connected.
- Consult the dealer or an experienced radio/TV technician for help.

### **CAUTION:**

Any changes or modifications not expressly approved by the grantee of this device could void the user's authority to operate the equipment.

This device complies with Part 15 of the FCC Rules. Operation is subject to the following two conditions:

- (1) This device may not cause harmful interference, and
- (2) this device must accept any interference received, including interference that may cause undesired operation.

The following responsible party designated in FCC § 2.909 is responsible for this declaration:

Fan Model Number: SFL-550L1, SFL-550L2, SFL-550L3, SFL-550L4

Remote Control Model Number: EHU-669

Company Name: CM Development Inc.

Company Address: P.O. Box 90962, CA 91715, USA



Telephone Number: 562-283-8103

# Troubleshooting



## WARNING

Turn off power to room and wall switch by removing fuses or turning off circuit breakers as needed before attempting any repairs to the ceiling fan or the electrical connections. Failure to do so can cause serious personal injury.

Problem	Solution
Fan will not start.	<ul style="list-style-type: none"> <li>❑ <b>Wall switch is turned off.</b> Turn wall switch on.</li> <li>❑ <b>Circuit breaker is tripped or fuse is blown.</b> Reset circuit breaker or replace fuse.</li> <li>❑ <b>Ceiling fan wiring is incorrect.</b> Check the ceiling fan's electrical connections. If you are unable to detect the problem, consult a qualified electrician.</li> </ul>
Fan is noisy.	<ul style="list-style-type: none"> <li>❑ <b>Some noise is natural during the break-in period of the fan.</b> Allow a minimum 24 hours break-in period. Most noises associated with a new fan will be resolved during this time.</li> <li>❑ <b>Ceiling fan housing screws are loose.</b> Make sure all housing screws are snugly tightened.</li> <li>❑ <b>Blade set screw is loose.</b> Retighten the blade set screw.</li> </ul>
Fan wobbles.	<ul style="list-style-type: none"> <li>❑ <b>Pivot ball is not captured in slot on fan mounting bracket.</b> Refer to the instructions under <b>Hanging the Ceiling Fan</b> on page 11 to be sure the ceiling fan is hung correctly.</li> <li>❑ <b>Outlet box is not securely fastened to the ceiling joists.</b> Tighten the outlet box screws or use longer screws, if needed, to fasten securely.</li> </ul>
Remote control is not working.	<ul style="list-style-type: none"> <li>❑ <b>Wall switch is turned off.</b> Turn wall switch on.</li> <li>❑ <b>Remote batteries are dead.</b> Replace the batteries in the remote control.</li> <li>❑ <b>Wall switch has solid-state speed controls.</b> Do not use a wall switch that has variable speed control (i.e. a dimmer switch).</li> <li>❑ <b>The remote control and the receiver are not paired successfully.</b> Reset following the method on page 11 until the beep is played.</li> </ul>
Remote control and fan are working, but lights do not work.	<ul style="list-style-type: none"> <li>❑ <b>Verify the indicator light on the remote control lights up when you press the LIGHT  button.</b> This light indicates a signal is being sent from the remote control to the ceiling fan. If the indicator light does not illuminate when the LIGHT  button is pressed, the remote control may be damaged and need to be replaced. Contact a customer service representative. If the light on the remote illuminates, but the lights on the fan still do not work, contact a service representative.</li> </ul>

# HOME DECORATORS COLLECTION®

Questions, problems, missing parts? Before returning to the store,  
call Home Decorators Collection Customer Service  
8 a.m. - 7 p.m., EST, Monday - Friday, 9 a.m. - 6 p.m., EST, Saturday

**1-800-986-3460**

**[HOMEDEPOT.COM/HOMEDECORATORS](http://HOMEDEPOT.COM/HOMEDECORATORS)**

Retain this manual for future use.