

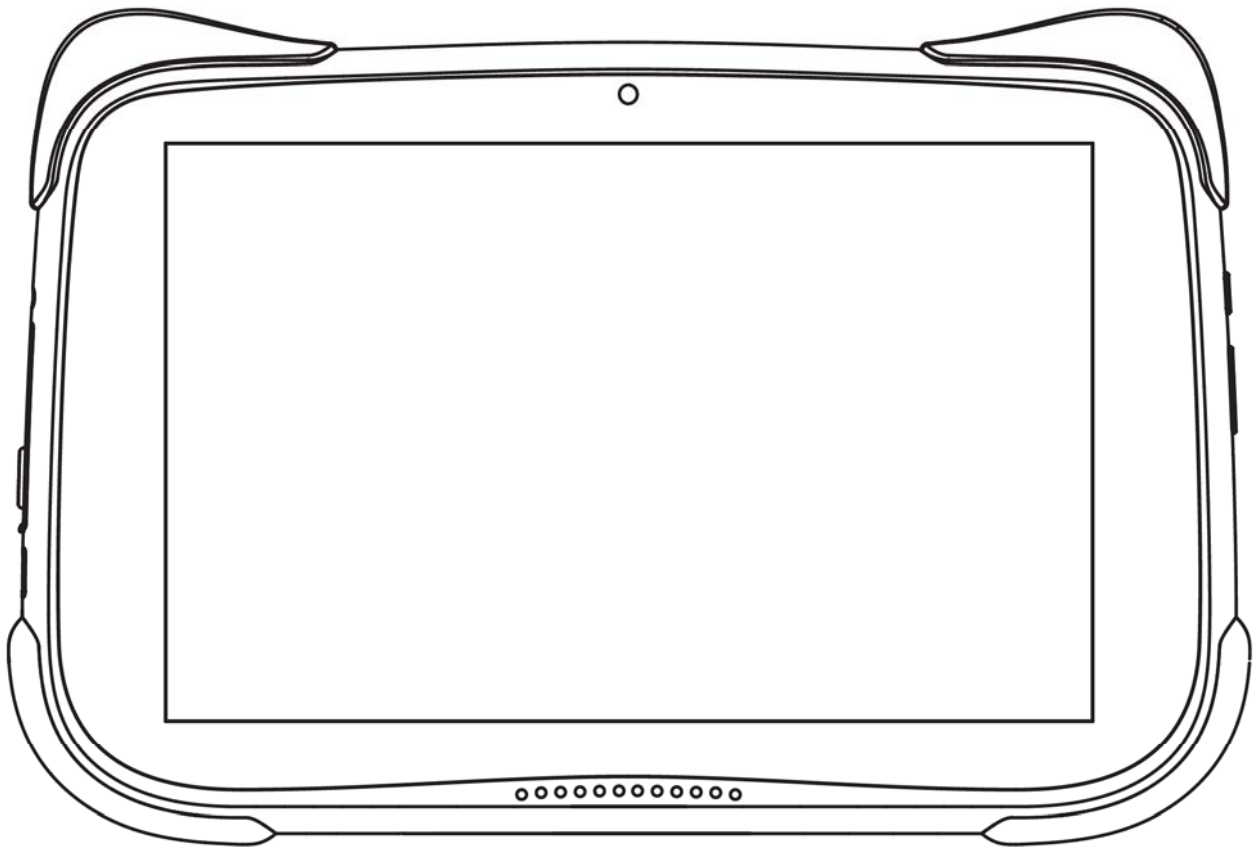

# Hot Pepper

kids tablet pc

HPPAP23



## User Manual

Note: Please carefully read the instruction manual before using and keep it properly for future reference.

# Contents

<b>I . Product Overview</b>	01
<b>II. Specifications</b>	02
<b>III. Getting Started</b>	04
Charging	04
Power ON/OFF	04
Battery	04
Sleep Mode	05
Screenshot	05
<b>IV. Home Page</b>	06
Home Page Overview	06
Home Settings, Widgets & Wallpapers	06
<b>V . Basic Settings</b>	07
Quick Settings	07
More Settings	09
<b>VI. Network Connection</b>	13
Wifi Connection	13
Bluetooth Pairing	13
<b>VII. APP Management</b>	14
APP Download and Installation	14
APP Management	14
<b>VIII. Web Browsing</b>	15
<b>IX. Multimedia</b>	15
Connect to A Computer	16
Connect to External Storage	16
<b>X. Troubleshooting</b>	17
<b>XI. Using Notes</b>	18
<b>XII. Certification Statements</b>	18

# I . Product Overview



- |                            |                         |
|----------------------------|-------------------------|
| <b>1</b> Headphone Jack    | <b>6</b> Power Key      |
| <b>2</b> TF Card Slot      | <b>7</b> Volume +/-     |
| <b>3</b> USB Charging Port | <b>8</b> Reset Hole     |
| <b>4</b> Camera            | <b>9</b> Handle Bracket |
| <b>5</b> Speaker           | <b>10</b> 8-Inch Screen |

\* Google, Android, Google Play and other marks are trademarks of Google LLC.

## II. Specifications



Basic Information	Size	230*154*12MM
	Shell Material	Plastic
	Net Weight	0.425kg
	Color	Yellow
Key Component	CPU	A133P 4* Arm Cortex-A53 1.6GHz
	GPU	GE8300
	Display Screen	8" 2.5D G+G 1280*800 IPS
	DDR Memory (RAM)	2 GB
	Flash Memory (ROM)	32 GB
	Battery Life	4000mAh
	Speaker	Speaker*1
	MIC	1 Built-in Microphone
Connect Port	MicroSD Slot	Support TF Card
	Audio	3.5mm Earphone Jack
	Power Adapter	5V2A
	USB Interface	Type-C
	SIM Card	NO, Not Support
Camera	Front+Rear	0.3M/2M
Wireless Connection	WiFi Connectivity	802.11 b/g/n
	GSM	NO
	WCDMA	NO
	FDD	NO
	Bluetooth Connectivity	4.2
	FM	NO
	GPS	NO
	Navigation Systems	NO
	NFC	NO

ensor	Gravity Sensor	No
	Fingerprint	No
	The Flash	No
	Light Sensor	No
	Gyroscope	No
	Compass	No
	Proximity Sensor	No
	NFC	No
	Ethernet	No
Physical Buttons	Power Button	Yes
	Volume+ Button	Yes
	Volume- Button	Yes
	Reset Button	Yes
	Face Unlock	No
	Finger Print Unlock	No
Operation System	OS	Android 13.0 go edition
System Language	Language	Multi-language
Multimedia Format	Video Support Format	H.264 1080p 30 fps/H.263/H.265, H.263, MPEG4 VP8, VP9, 1080P@30fps, H.264/H265
	Audio Support Format	MP3/AAC/AAC+/DRA/AMR-NB
	Image Format	JPG, JPEG, GIF, BMP, PNG
Certification	Charger	CE, UL etc.
	Certification	FCC, CE, RoHs, Drop Report, UN38.3 Test Summary, UN38.3 Test Report, MSDS, Sea Transport Report, Air Transport Certification, EN 62133, IEC 62133
Package Contents	Contents	1x Package Box; 1* Tablet KT10; 1* USB Cable; 1*5V/2A Charger ; 1* User Manual

## III. Getting Started

### 3.1 Charging

- \* If the tablet won't turn on, please charge it for at least 30 minutes and try again.
- \* It is recommended to fully charge the device before using it for the first time.  
[How to check the battery level:](#)
- \* Battery status will show on the upper right corner of the screen when the tablet is turned on.

Charging: 71%  Fully charged: 100% 

### 3.2 Power ON/OFF

**\*Power-on:** Long press the "power button" for 4-5 seconds to turn on the tablet. Select your language and initially set up the tablet following the start guide.

**\*Power-off:** Long press the "power button" for 2 seconds, the screen will show "Power off" and "Restart" options. Choose "Power off" to turn off the tablet.

**\*Forced Shutdown:** When the system crashes, long press the "power button" for 7-8 seconds to do a forced shutdown. OR insert the pin into the "Reset" hole to do a forced shutdown.

### 3.3 Battery

- \* The tablet has a rechargeable built-in Li-ion battery.
- \* Battery power will show on the upper right status bar. (You can set to show the battery percentage.)
- \* Low Battery Reminder: 15% remaining will pop up when battery may run out soon.

## Cautions

- \* Do not replace the battery by yourself, which may damage the battery and cause overheating, fire or injury..
- \* Do not dispose of the tablet into fire.
- \* Do not expose the tablet to any high temperature places, such as by a fire, near a radiator, under a stove, in direct sunlight, etc.
- \* Please be sure to use our original charger when charging.
- \* We recommend that you drain the battery once a month if you only use your tablet occasionally.
- \* Lithium-ion battery in the tablet are subject to maintenance or trade-in by law. It should be collected and disposed of separately from household waste.
- \* Disposing of the battery should obey your local environmental laws and regulations.

## 3.4 Sleep Mode

In the power-on state, press the power button once to enter "Sleep Mode". Press the power button again and the tablet will wake.

### **Tips:**

You can set the Screen Timeout: Settings > Display > Screen timeout

## 3.5 Screenshot

Simultaneously press the "Volume -" button and the "Power" button to get a screenshot.

# IV. Home Page

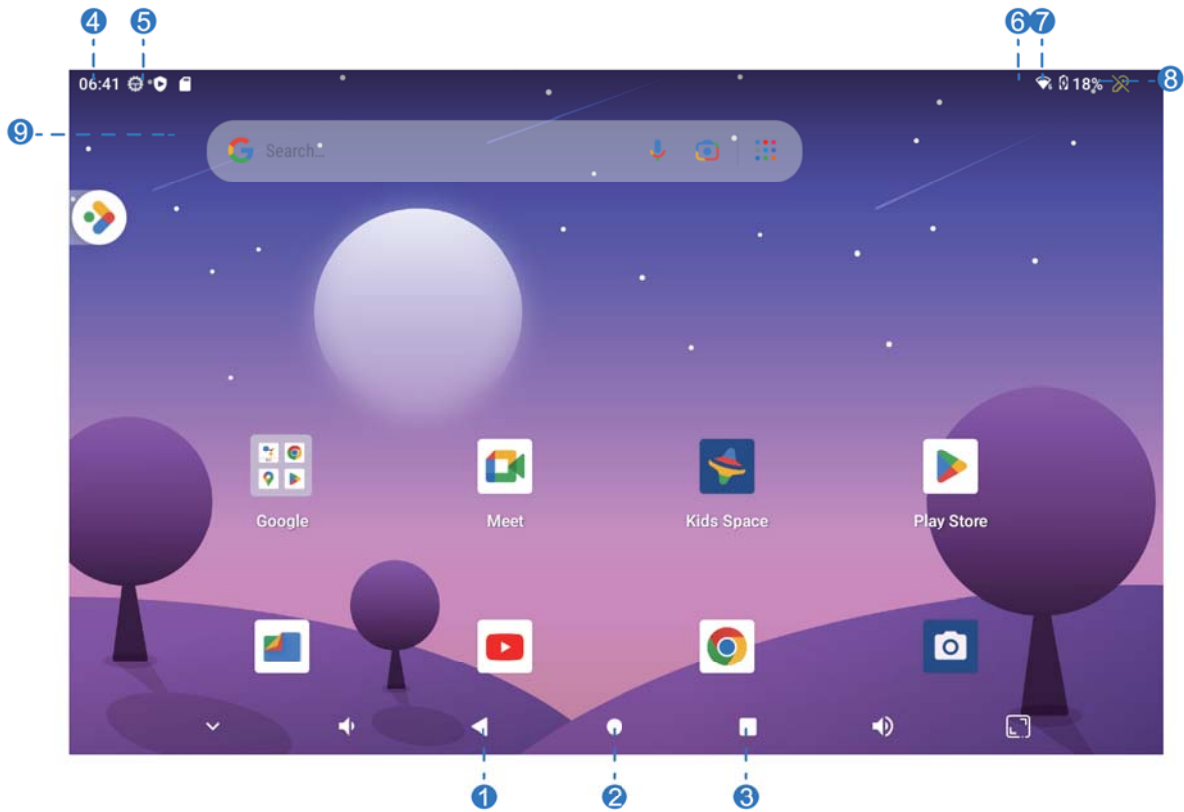

## 4.1 Home Page Overview

- |                        |                   |                      |
|------------------------|-------------------|----------------------|
| 1. Back                | 4. Current Time   | 7. Wifi Icon         |
| 2. Home Page           | 5. Status Icon    | 8. Battery Status    |
| 3. Recent Opening Apps | 6. Bluetooth Icon | 9. Google Search Bar |

## 4.2 Home Settings, Widgets & Wallpapers

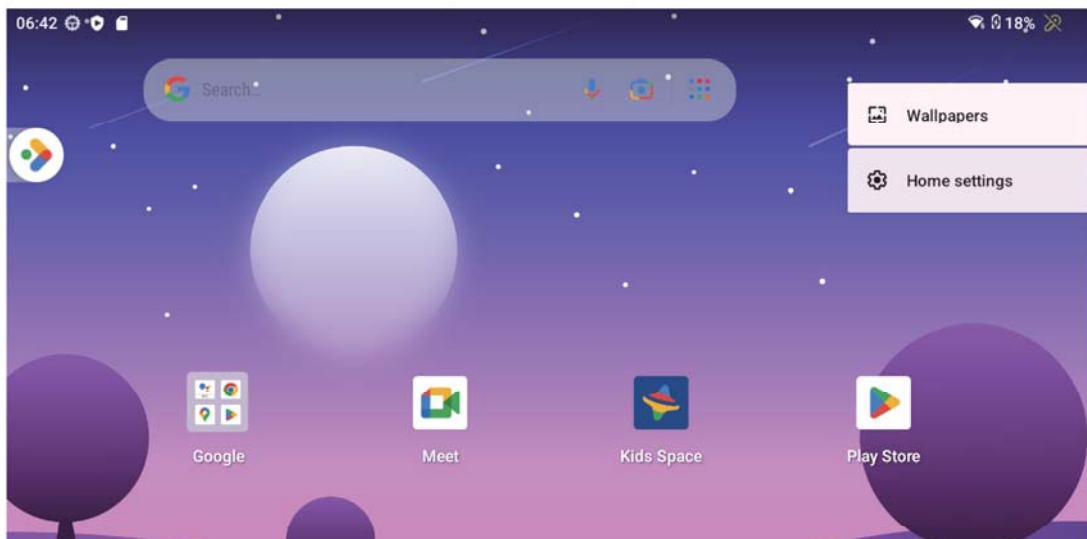



Touch and hold the empty section of the home screen, “Home settings”, and “Wallpapers” will be displayed.

### \*Home settings:

#### - Add app icons to Home Screen

Allow the new-installed apps to be displayed on the Home Screen

### \*Wallpapers:

Change the current wallpaper of the tablet from the default wallpapers, Live Wallpapers or your photos.

## V. Basic Settings





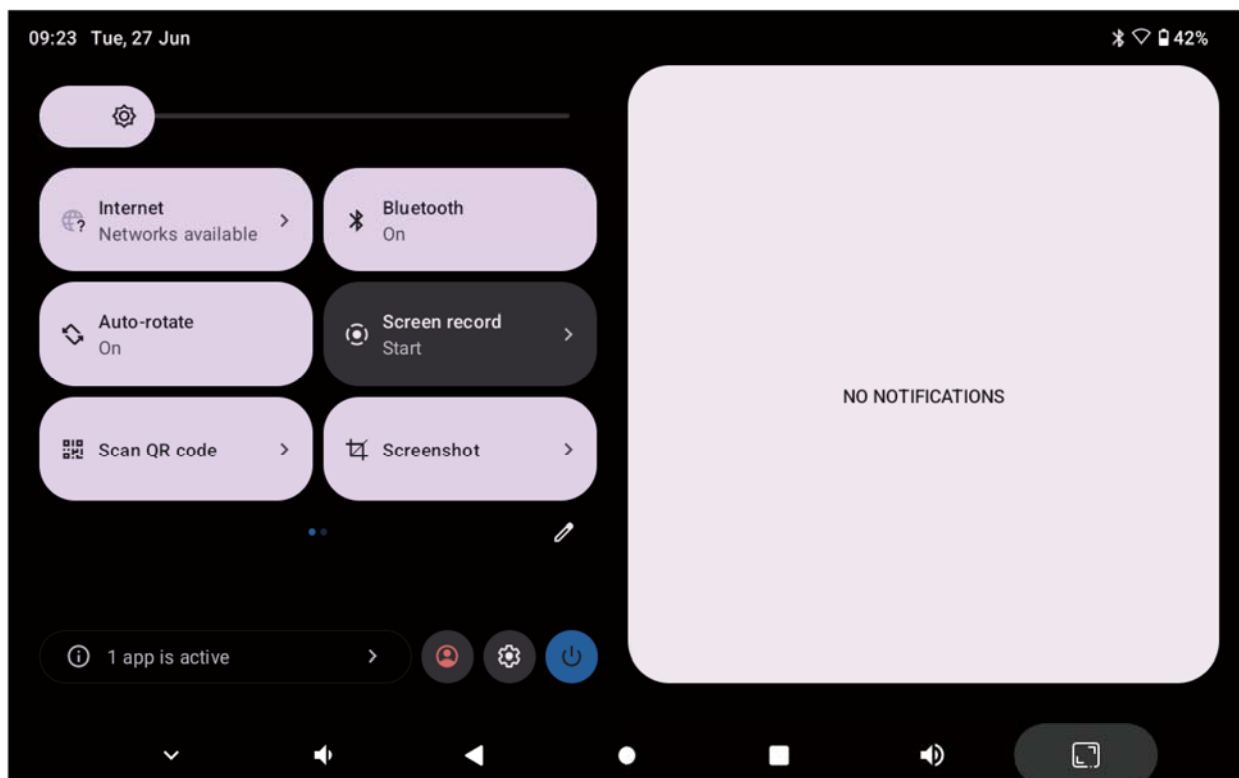



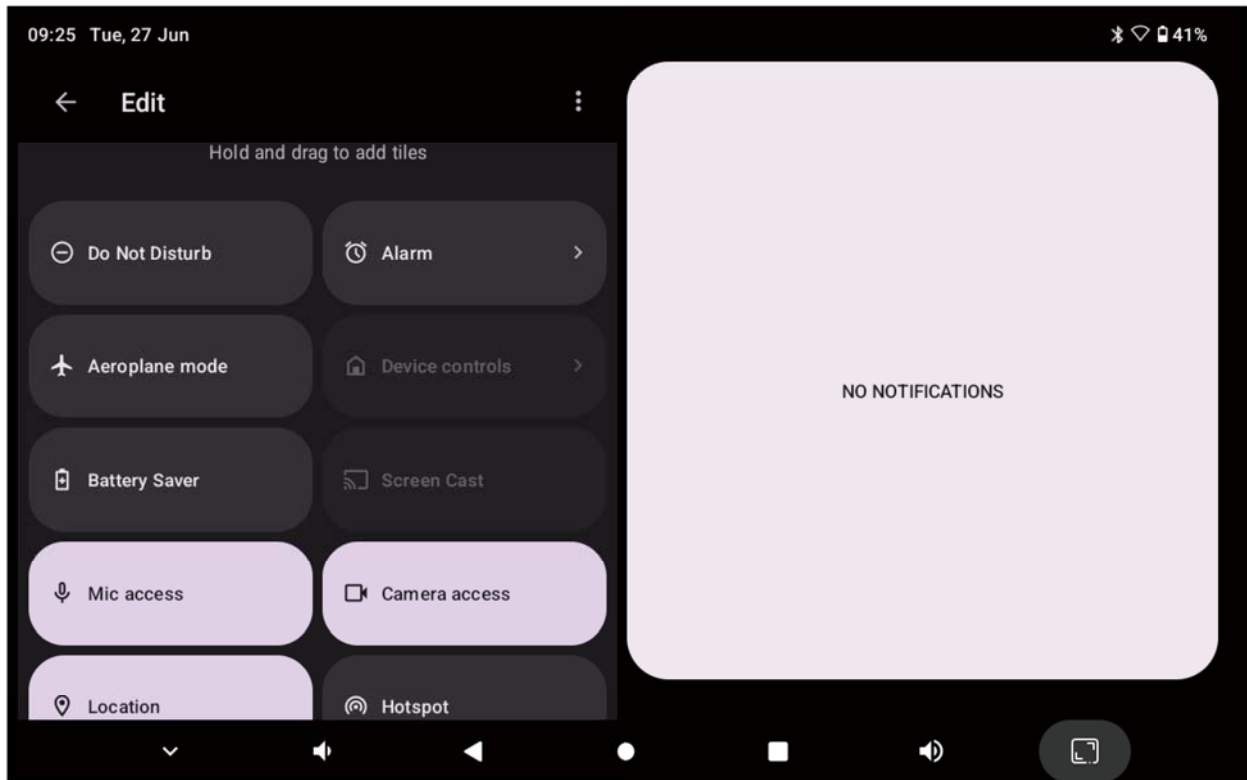



### 5.1 Quick Settings

Swipe down from the top of the screen to access Quick Settings.



Click "  " to show more



	Wi-Fi	Connect / disconnect to a wireless network.
	Bluetooth	Enable / disable the Bluetooth connection of the tablet.
	Do Not Disturb	When activated, the tablet will mute and stop vibrating.
	Auto-rotate	Turn on / off the auto-rotation of the screen.
	Battery Saver	To save the battery life.
	Airplane Mode	Turn on / off all the network connectivity.
	Night Light	When activated, the blue light is cut off and the screen turns yellow.
	Screen Record	Start and end the screen recording.
	Nearby Share	Anyone nearby can temporarily share with you.
	Add tiles into Quick Setting Page	Long press and drag each icon (Alarm, Bedtime mode, etc) to add it into the Quick Setting Page.
	User Setting	Add guest or other users
	Power off/Reset	Power off/Reset
	Settings	Enter all settings page

## 5.2 More Settings

\* Swipe down from the top of the screen, then tap the " ⚙️ " icon to enter the detailed setting page.\* Directly choose the "Settings" App on the Home screen.

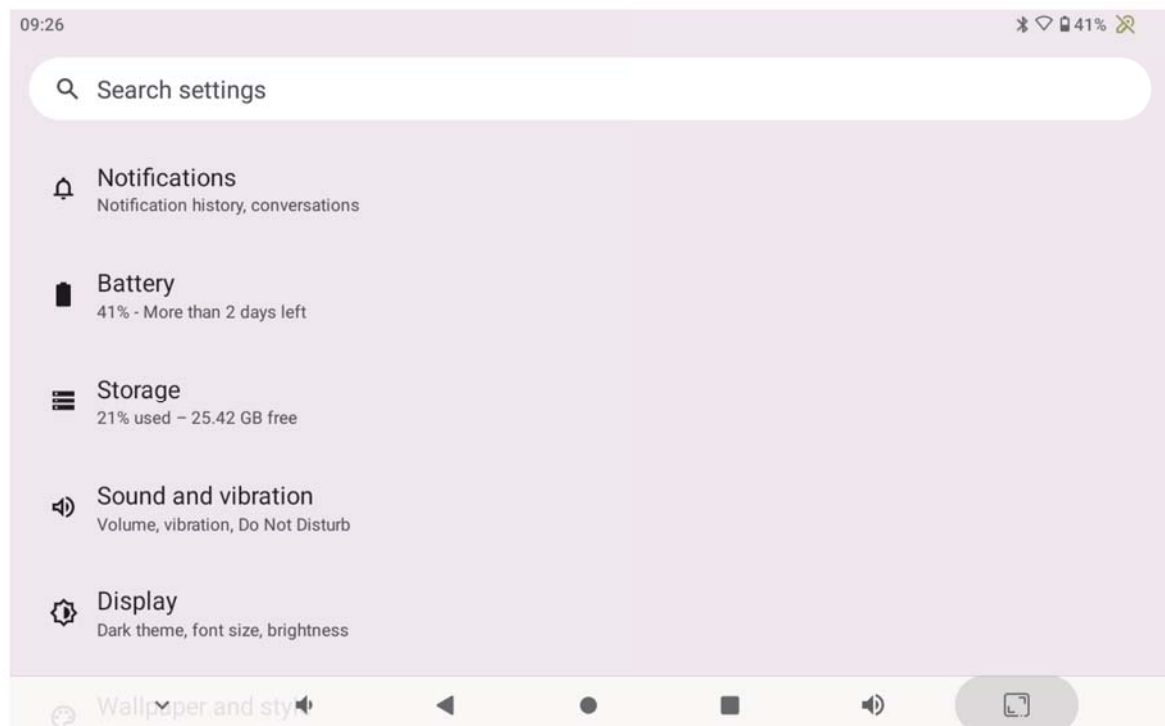
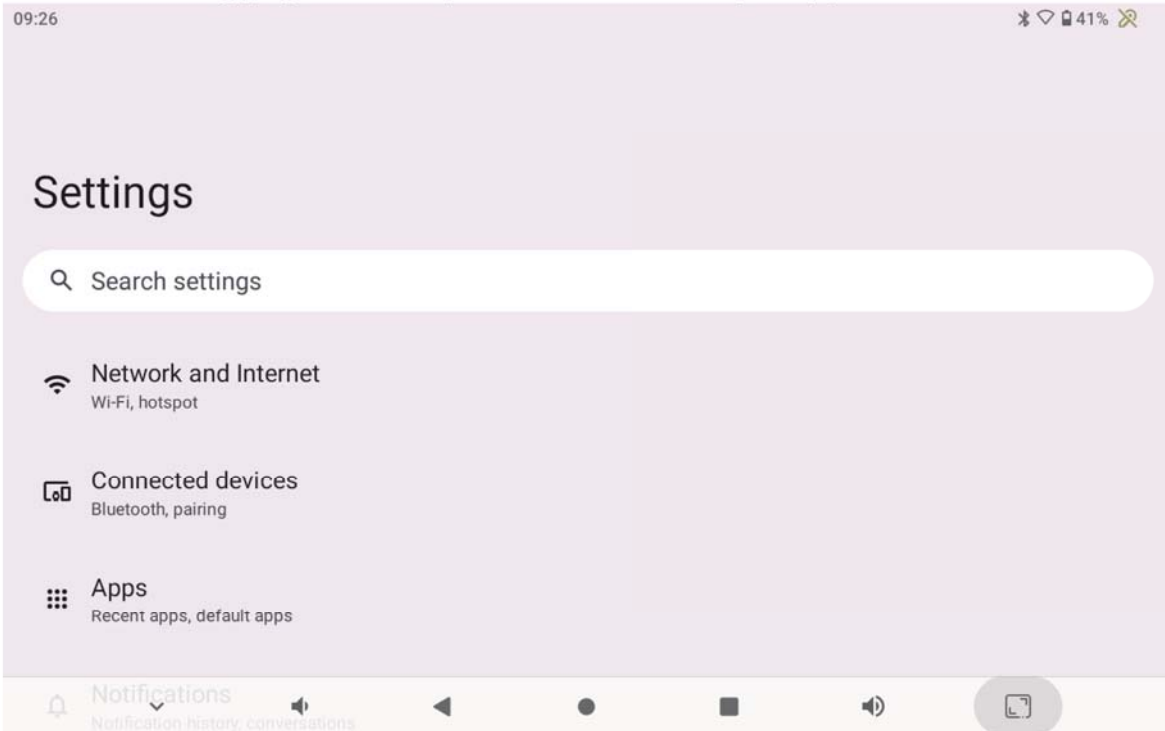

## Network & internet

- \* Connect to any working Wi-Fi
- \* Enable / Disable the Airplane mode
- \* Turn on / off the Data Saver
- \* Add VPN Connections
- \* Select Private DNS Mode

## Connected devices

- \* Pair with new available devices
- \* Check previously connected devices
- \* Turn on / off Bluetooth
- \* Check the received files from other devices via Bluetooth
- \* Link to a Chromebook
- \* Enable Nearby Share to share files with nearby devices that support this function

## Apps

- \* Check recently opened Apps
- \* Check all the Apps on the tablet
- \* Set default Apps (Browser App, digital assistant App, Home App, etc.)
- \* Check the screen time/received notifications/opened times for Apps
- \* Check Unused Apps
- \* Set special app access

## Notifications

- \* Turn on / off the notifications from each app
- \* Show / Hide the notification history
- \* Check priority and modified conversations
- \* Allow / Disallow apps to show bubbles
- \* Set privacy preferences for device & app notifications
- \* Turn on / off "Do Not Disturb"
- \* Show/Hide silent notifications in status bar
- \* Allow/ Disallow notification snoozing
- \* Enable / Disable notification dot on an app icon
- \* Enable / Disable enhanced notifications

## Battery

- \* Check the remaining battery percentage and usage time
- \* Check the battery usage data since full charge
- \* Enable / Disable Battery Manager (detect when apps drain battery)
- \* Show / Hide the remaining battery percentage on the upper right status bar

## Storage

- \* Check and manage your storage space
- \* Enable / Disable Storage Manager

## Sound

- \* Set volume for Media, Alarm and Notification
- \* Enable / disable “Do Not Disturb” to mute sound
- \* Show / Hide the media player and media recommendations
- \* Set default notification sound and alarm sound
- \* Turn on / off Screen locking sound, Charging sounds, Touch sounds

## Display

- \* Adjust the screen brightness
- \* Enable / Disable the Dark theme
- \* Turn on / off Night Light
- \* Change the wallpaper
- \* Set the Screen timeout
- \* Turn on / off the Auto-rotate screen
- \* Adjust the font size and display size
- \* Enable / Disable screen saver
- \* Set what to show when the tablet is locked

## Wallpaper

- \* Change the wallpaper

## Accessibility

- \* Manage settings for Downloaded apps (accessibility menu shortcut, select to speak shortcut, use switch access, use TalkBack)
- \* Set text and Display, screen extra dim, dark theme, magnification
- \* Set Interaction controls: timing controls and system controls
- \* Set Caption preferences, Audio adjustment, Accessibility shortcuts, Text-to-speech output

## Security

- \* Check the security status
- \* Set screen lock pattern, e.g., Password, PIN, Pattern, Swipe etc.

## Privacy

- \* Check and manage app permissions
- \* Enable / Disable the Camera access and Microphone access
- \* Show / Hide the characters when you input a password
- \* Set what to show when the tablet is locked and more
- \* Show / Hide all notifications on locked screen
- \* Enable / Disable Autofill with Google

## Location

- \* Turn on / off the location services
- \* Check apps that have requested location recently
- \* Manage apps that have access to location
- \* Check and manage Location services and more

## Passwords accounts

- \* Add and remove the google accounts
- \* Manage google passwords
- \* Turn on / off automatically sync app data

## Digital Wellbeing & parental controls

- \* Check your app usage based on Screen time, Notifications received, or Times opened from Dashboard
- \* Set daily timers for apps
- \* Manage notifications to reduce interruptions
- \* Set up Parental controls to add content restrictions and other limits to help your kids balance their screen time

## Google

- \* Set the preferences for Google™ related services

## System

- \* Set Language & input (Languages, Keyboards, Spell Checker, Text-to-speech output)

Tap “Languages & input” > Tap “Languages” > Tap “+ Add a language” to add your language. After adding, hold and slide it to the top to change the language.

- \* Set gestures of using the tablet
- \* Set the date and time
- \* Turn on / off the option of Backup the data
- \* Check and update the tablet's system
- \* Manage multiple users and profiles
- \* Restore factory setting

Tap “Reset options” > Tap “Erase all data ( factory reset )”

- \* Reset Wi-Fi, mobile & Bluetooth, and app preferences

## About tablet

- \* Check the detailed information about the tablet

# VI. Network Connection

## 6.1 Wi-Fi Connection

- \* Enter “Settings” > Tap “Network & internet” > Tap “Wi-Fi” OR Long press the Wi-fi icon on Quick Setting page.
- \* Turn on Wi-Fi and all available Wi-Fi connections will display.
- \* Select your Wi-Fi and input the correct password.

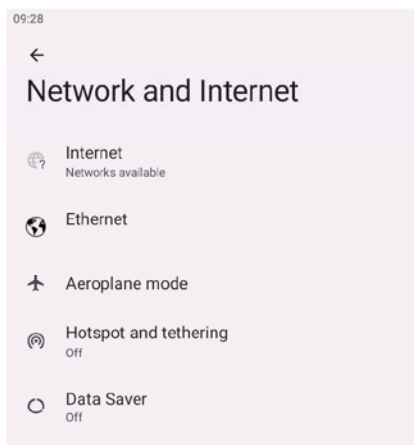

## 6.2 Bluetooth Pairing

- \* Enter “Settings” > Tap “Connected devices” > Tap “Pair new device” OR Long press the Bluetooth icon on Quick Setting page.
- \* Enter Bluetooth scanning page and all available devices will display after a few seconds.
- \* Select the desired device to get a pairing code and click “PAIR” on both devices. Automatic connection is applied to some devices.

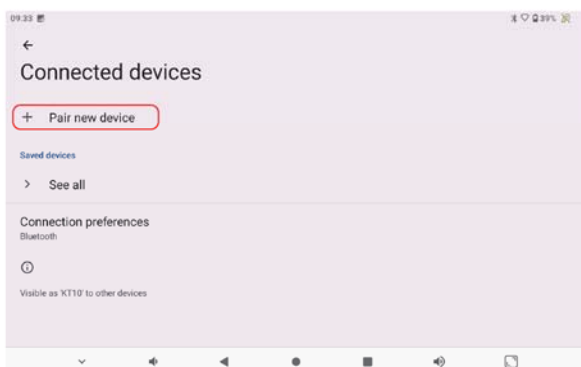

# VII. APP Management

Swipe up from the bottom of the screen and then you can see all the Apps.

## 7.1 APP Download and Installation

- \* Tap the "Play Store" app to open it.
- \* Sign in your google account, search and download the App you need.

## 7.2 APP Management

### \* Move App

Touch and hold the App icon, and then slide it to the desired screen.

### \* Remove APP from Home Screen

Touch and hold the App, then slide it to  to remove it from your Home screen.

### \* Uninstall APP

Touch and hold the App, then slide it to the  to uninstall the App.

### \* Clear the Cache of APP

1. Tap "Settings" > Tap "Apps" > Tap "See all apps"
- 2 . Select an App > Tap "Storage & cache" > Tap "CLEAR CACHE" to clear the cache



## VIII. Web Browsing

Please make sure the tablet is connected to a working Wi-Fi network before browsing the web. You can use the pre-installed “Chrome” browser or other browsers downloaded from “Play Store”.

## IX. Multimedia

### 9.1 Connect to A Computer

1. Connect your tablet to the computer through the included USB Type-C cable.
2. Access to your computer and find “DT40” to transfer files between your tablet and computer.

- \* Go to Quick Settings, tap "USB file transfer turned on" > "Tap for more options" > Enter "USB Preferences" to select the option preferred.
- \* The default setting is “File Transfer”.
- \* Select "MIDI" to play MIDI instruments on the tablet.
- \* Select "PTP" to transfer photos between the devices.
- \* Select "No data transfer" to charge your tablet.

Note: If your computer does not respond, please try to connect another USB interface.

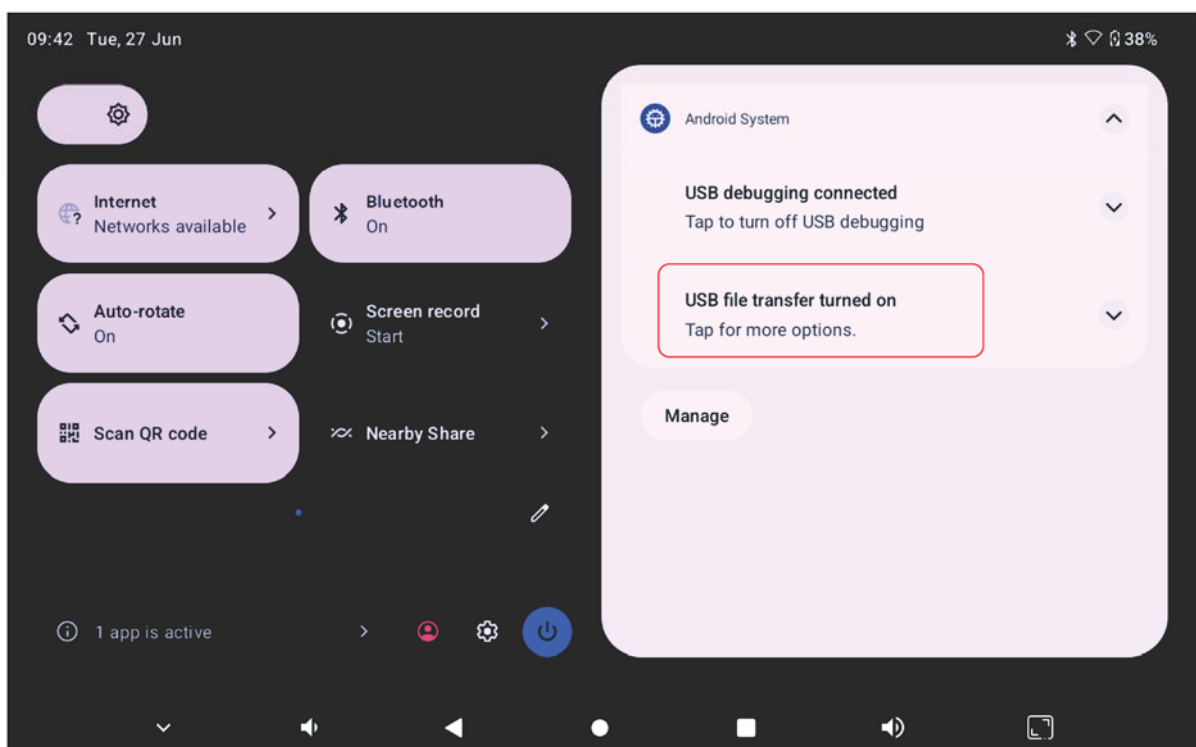



## 9.2 Connect to External Storage

1. Turn off the tablet. Insert a memory card into the Micro SD Slot using the pin in the box.
2. Turn on the tablet, and then go to Quick Settings > SD card > tap “SET UP”.
3. Set the memory card as a portable storage by selecting “Portable storage”. And then files can be transferred between the SD card and “KT10” tablet.

# X. Troubleshooting

## **Q1. The tablet won't turn on.**

- \* Charge the tablet for at least 30 minutes, and then power it on again.
- \* Press the "Power" button to check if the tablet is in "sleep mode".
- \* Long press the "Power" button for 7-8 seconds to do a forced shutdown, and then power it on again.
- \* Insert the pin into the "Reset" hole to do a forced shutdown, and then power it on again.

## **Q2. The tablet doesn't charge.**

- \* Make sure the USB cable is properly plugged into the charging port.
- \* Try another compatible USB cable and power adapter.

## **Q3. An error occurs during use.**

- \* Uninstall the app that caused the error, then try installing it again.
- \* Long press the "power button" for 7-8 seconds to do a forced shutdown. OR insert the pin into the "Reset" hole to do a forced shutdown.

## **Q4. The tablet cannot be recognized by the computer.**

- \* Make sure the tablet is powered on.
- \* Use a different USB cable.
- \* Plug it into another USB port on your computer.
- \* Choose "File Transfer" or "PTP" when the tablet is connected to the computer. Do not choose "No data transfer".

## **Q5. The tablet cannot connect to Wi-Fi.**

- \* Make sure the Wi-Fi of the tablet is "ON".
- \* Make sure you input the correct password.
- \* Restart the router.
- \* Make sure there is no filter setting or device connection limitation in the setting of the router.
- \* Ignore the previous Wi-Fi, restart the router and reconnect the Wi-Fi again.

## **Q6. The storage space of the tablet is not enough.**

- \* Delete the Apps you don't use,
- \* Clear the cache of the Apps regularly.
- \* Install an external memory card to expand the storage.

**Q7. The screen is unresponsive.**

\* Check if the screen has dust or oil stains. If yes, please gently wipe the screen with a soft cloth to clean it.

\* Long press the "power button" for 7-8 seconds to do a forced shutdown. OR insert the pin into the "Reset" hole to do a forced shutdown. And then power on again.

**Q8. The font is too small to read clearly.**

\* Go to Settings > Display > Advanced Settings > Font Size.

**Q9. Does this tablet support OTG function?**

\* Yes, you can connect a USB driver, keyboard, mouse to your tablet. However, OTG adapter cable is not included in the package. Please order it separately.

**Q10. The tablet comes with scratches on the screen.**

\* Check if the scratches are on the protective film. If so, remove the protective film.

**Q11. How to use voice search function?**

\* Tap the microphone icon on the Google search bar. Tell the tablet what you want to search.

**Q12. The sound disappears.**

\* Press the "volume+" button

\* Go to Settings > Tap "Sound" > Turn off "Do Not Disturb"

\* Restore factory settings, volume will be back to normal.

**Q13. The memory card cannot be recognized.**

\* The tablet only supports FAT32 formatted memory cards, so Go to "Settings" > Tap "Storage" > Choose "SD CARD" > Tap "⋮" on the upper right corner > Choose "Format"

**Q14. What unlocking functions does it support?**

\* KT10 tablet supports Password, PIN, Pattern, Swipe lock. Go to "Settings" > Tap "Security" > Tap "Screen Lock" > Choose Lock method.

**Q15. How to set the required regional time?**

\* Go to Settings > System > Date&time > Set time automatically > OFF > Select time zone > Region.

## XI. Using Notes

1. Please order extra tempered glass film and case to protect the screen of the tablet.
2. If you're not using your tablet, lock the screen.
3. Lightly touch the screen. Do not press the screen hard.
4. Hearing Damage Risk: Do not listen at high volume levels for long period.
5. Properly place/store it to avoid other objects fall on the tablet.
6. Do not place the tablet directly on the bed before going to bed because heavy pressure is likely to damage the screen during deep sleep.

## XII. Certification Statements

### FCC USA

#### FCC Caution:

This device complies with part 15 of the FCC Rules. Operation is subject to the following two conditions: (1) This device may not cause harmful interference, and (2) this device must accept any interference received, including interference that may cause undesired operation.

Any changes or modifications not expressly approved by the party responsible for compliance could void the user's authority to operate the equipment.

NOTE: This equipment has been tested and found to comply with the limits for a Class B digital device, pursuant to Part 15 of the FCC Rules. These limits are designed to provide reasonable protection against harmful interference in a residential installation. This equipment generates, uses and can radiate radio frequency energy and, if not installed and used in accordance with the instructions, may cause harmful interference to radio communications. However, there is no guarantee that interference will not occur in a particular installation. If this equipment does cause harmful interference to radio or television reception, which can be determined by turning the equipment off and on, the user is encouraged to try to correct the interference by one or more of the following measures:

- Reorient or relocate the receiving antenna.
- Increase the separation between the equipment and receiver.
- Connect the equipment into an outlet on a circuit different from that to which the receiver is connected.
- Consult the dealer or an experienced radio/TV technician for help.

The device has been evaluated to meet general RF exposure requirement. The device can be used in portable exposure condition without restriction.

#### Specific Absorption Rate (SAR) information:

This device meets the government's requirements for exposure to radio waves. The guidelines are based on standards that were developed by independent scientific organizations through periodic and thorough evaluation of scientific studies. The standards include a substantial safety margin designed to assure the safety of all persons regardless of age or health. FCC RF Exposure Information and Statement the SAR limit of USA (FCC) is 1.6 W/kg averaged over one gram of tissue. Device types: This device has also been tested against this SAR limit.

This device was tested for typical body-worn operations with the back of the This device kept 0mm from the body. To maintain compliance with FCC RF exposure requirements, use accessories that maintain an 0mm separation distance between the user's body and the back of This device. The use of belt clips, holsters and similar accessories should not contain metallic components in its assembly. The use of accessories that do not satisfy these requirements may not comply with FCC RF exposure requirements, and should be avoided.

## CE/RoHs

The company declares under its own responsibility that this product complies with the basic requirements of CE ( 2014 /30 / EU ) and ROHS ( 2011/ 65 / EU ) . Without the approval of our company or the distributor, unauthorized changes or modifications to the equipment may violate the CE regulations, may cause the user to lose the right to operate the equipment, and invalidate the warranty.