

bonoch

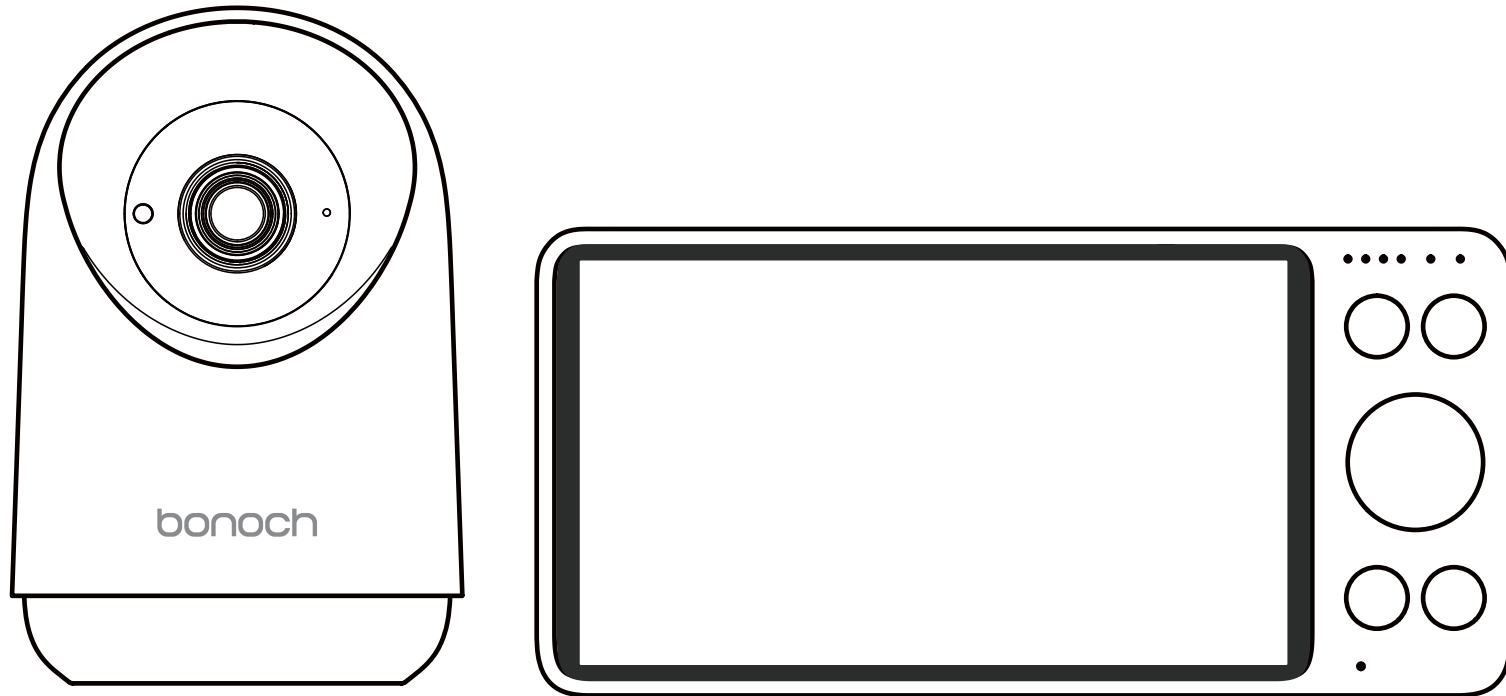

Video Baby Monitor



We will update the manual frequently, you can scan the QR code or visit the website to get the latest version of the manual

Contents

1. Overview (01-03)

Packing List (01)

Baby Unit (02)

Parent Unit (03)

2. Getting Started (04)

3. Camera Placement (on the wall) (05)

4. Function Operation (06-07)

5. Switching Cameras (08)

6. Replacing the Camera Len (09)

7. Maintenance and Warranty (10)

8. Information on Disposal of Product (10)

9. Warning and Safety Instructions (10)

10. Troubleshooting (11)

1. Overview

1.1 Packing List



Parent Unit x 1



Baby Unit (Camera) x 1

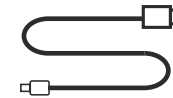

USB C Cable x 2

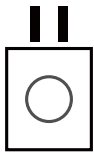

USB Charger x 2



Set Screw x 2



Wide-Angle Len x 1

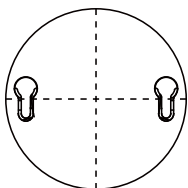

Positioning Card



User Manual x 1

1.2 Baby Unit



- 01. Light Sensor
- 02. Standard Camera
- 03. Microphone



- 04. Pairing Button
- 05. TF Slot
- 06. Reset Hole



- 07. USB-C Charging Port
- 08. Antenna
- 09. Temperature Sensor
- 10. Power Switch

1.3 Parent Unit

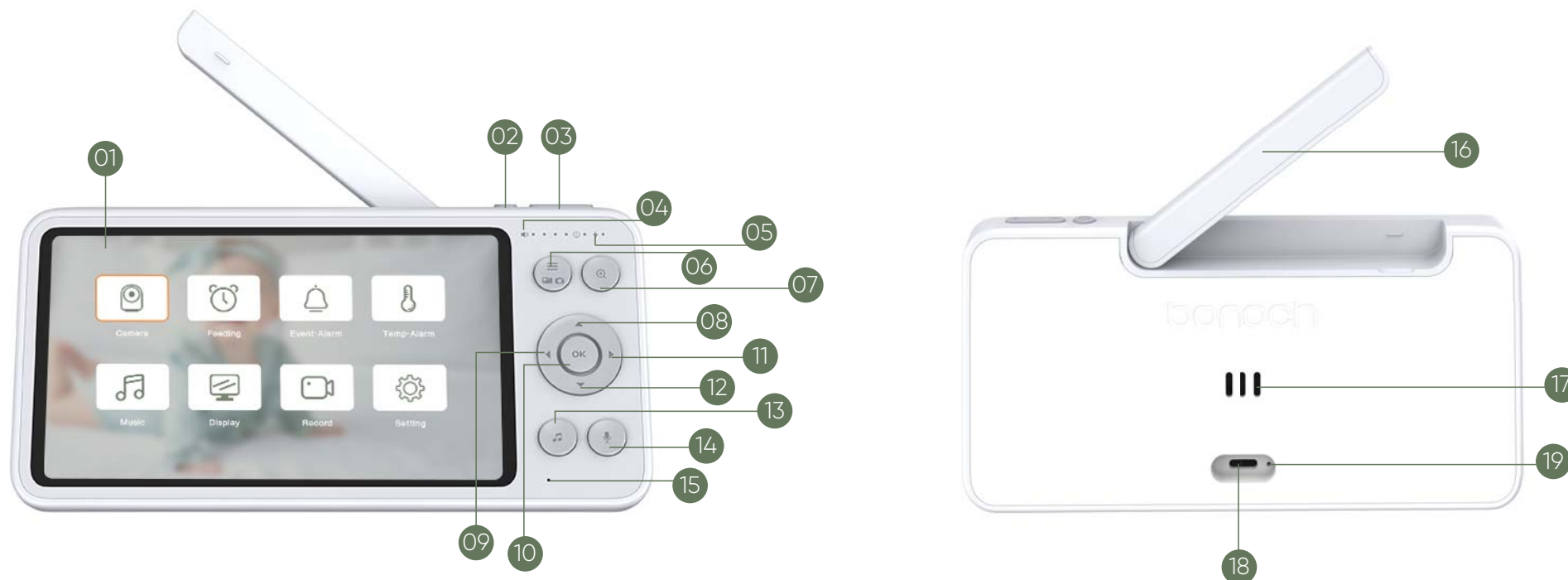

1. Display
2. Power Button
3. Volume
4. Volume Level Indicator
5. Power Indicator
6. Menu/Back/Camera/Video Recording

7. Zoom
8. Up Arrow Key
9. Left Arrow Key
10. OK Button
11. Right Arrow Key
12. Down Arrow Key

13. Play Music
14. Intercom
15. Microphone
16. Antenna
17. Speaker
18. USB-C Charging Port
19. Reset Hole

2. Getting Started



Step 1.

Connect the AC power adapter with camera. Plug the AC power adapter into power socket.



Step 2.

Press  for two seconds to turn on the parent unit.

Notes: The two units has already been paired in factory settings, so no repeated operation is needed in most cases. But if the auto pairing failed or you want to add more cameras, please try step 3 and step 4.



Step 3.

Set the parent unit to prepare for connecting.



Step 4.

Long Press PAIR button for five seconds until you hear the prompt tone.

3. Camera Placement (on the wall)

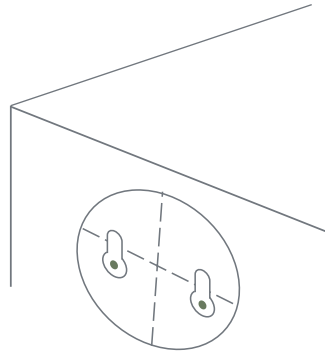

Step 1. Put the camera at the pre-installation angle, then viewing from the display monitor, check if the angle is OK
Using positioning card included, punch two holes horizontally apart with the same separation as the installation holes at the bottom of the camera

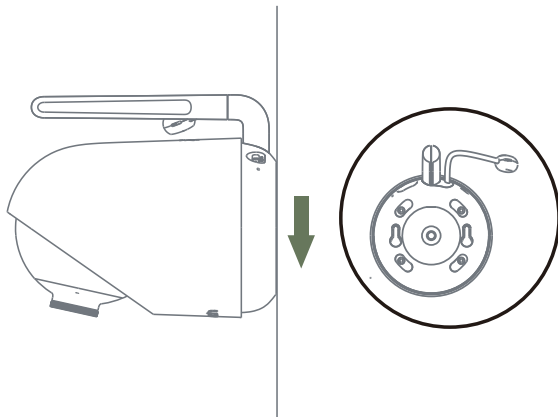

Step 3. Align the camera with the protruding screw, press and hold it down

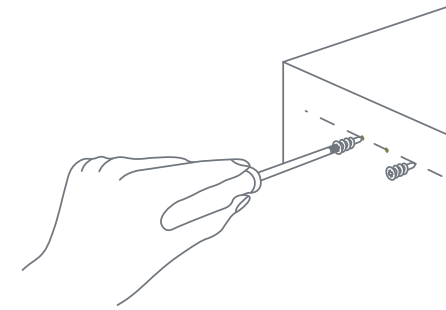

Step 2. Push the matching anchors into the holes.
Screw on with a screwdriver, leaving 1cm of the screw outside of the hole

4. Function Operation

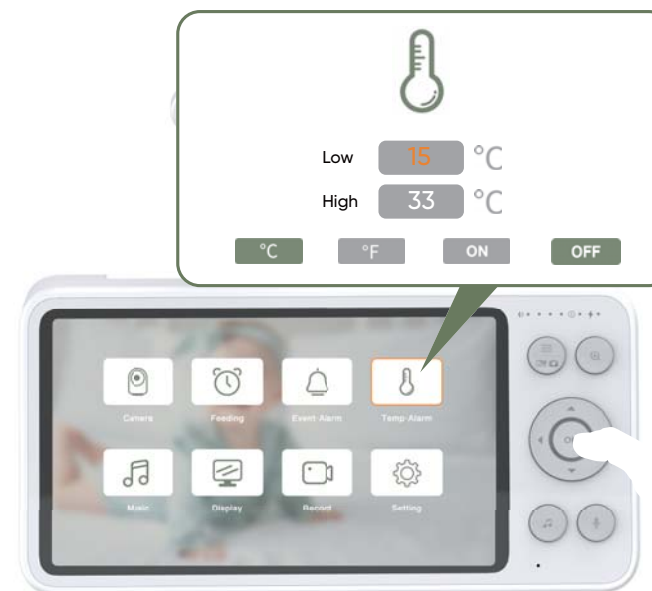
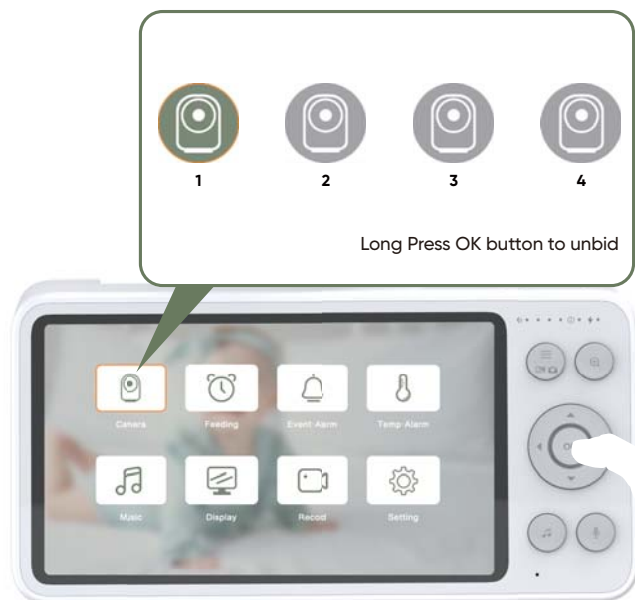

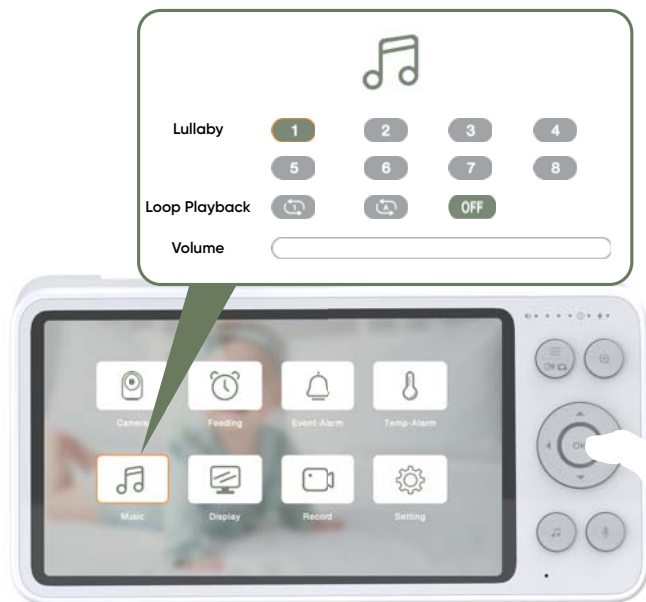

5. Switching Camera

5.1 Switch cameras manually



When two or more cameras are connected, Press the "OK" button to enter the split screen mode. You can now use the arrow keys to select a screen you want to zoom in, and press the "OK" button again to switch to the new camera screen.

5.2 Turn off multiple cameras scan mode



To turn off multiple cameras scan mode, press the "OK" button for 3 seconds, the loop logo of the camera at the top of the screen will disappear.

5.2 Turn on multiple cameras scan mode



When two or more cameras are connected, When the screen displays a single camera at the same time, press the "OK" button for 3 seconds, "Scan mode on" displays at the bottom left of the screen, and the loop logo of the camera appears at the top of the screen. The baby monitor will automatically loop real-time video from up to 4 cameras in single-screen mode every 15 seconds or in split-screen mode every 30 seconds.

6. Replacing the Camera Lens



Rotate to remove the decorative ring of the original lens (please keep the removed decorative ring properly, it needs to be reinstalled later when using the standard lens)



Take out the additional wide-angle lens, align it and screw it in, pay attention to make sure it is installed in place



Note: After installation, remove the lens protection cover for normal use

7. Maintenance and Warranty

Maintenance

All of the following maintenance procedures should only be performed when baby and parent units are unplugged and turned off. Clean the surfaces of the baby and parent units with a soft, fluff-free cloth.

Never use cleaning agents or solvents.

If the units become dirty, use a slightly damp cloth to wipe surfaces. Take care not to allow water into any openings.

Warranty terms

This baby monitor comes with a one-year warranty (replace or refund) and lifetime technical support. The warranty terms do not apply to any product that has been subject to abuse, misuse, negligence, or accident.

If you have warranty or support issues, please contact the customer service of Amazon seller before leaving your review.

8. Information on Product Disposal

Always dispose of your product (with a non-removable pre-installed battery) at the end of its life in an environmentally responsible way and in accordance with your local waste disposal requirements. All cardboard and paper packaging materials should be recycled in accordance with your local council waste regulations.

9. Warning and Safety Instructions

Follow these safety precautions to prevent fire, injury, or damage to the product and your baby.

Read and keep instructions handy: It's very important to read all the safety and operation instructions before use.

Warnings:

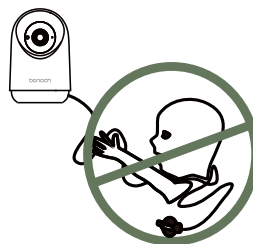
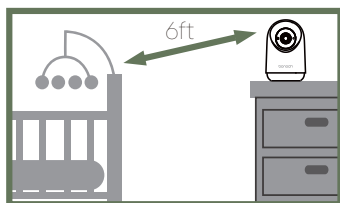

10. Troubleshooting

No signal on the Parent Unit

The power adapters may not be properly connected.

Confirm the toggle switch of the Baby Unit is in "Power On" position

Confirm the Parent Unit has power and is powered on

Ensure the Baby Unit and Parent Unit are not far from each other.

The baby Unit and Parent Unit may not be properly paired. Follow the PAIRING instructions.

Interference or poor connection

Opening the folded antenna upright improves signal reception

Move the Baby Unit closer to the Parent Unit.

The Baby or Parent Units may be too close to metal objects.

Other electronic devices may be interfering with the signal.

Maybe on a low battery.

Image frozen on the Parent Unit

Restart the Baby Unit (pull out the power adapter from the wall outlet, wait for approximately 5 seconds, and plug it back in).

Reset the Parent unit by opening the battery compartment and disconnecting the battery. Wait for 30 seconds and then reconnect the battery.

A high pitched piercing noise is heard from the units (feedback, static)

The Baby Unit and Parent Unit may be too close to each other. Move them further apart.

The volume on the Parent Unit may be set too high.

Cannot hear the baby sounds on the Parent Unit

Volume setting on the Parent Unit may be too low. Increase the volume.

Background noise

In a quiet environment surrounding the Parent Unit, decrease the volume on the Parent Unit to level 3 or below.

In a loud environment surrounding the Parent Unit, increase the volume on your Parent Unit to its maximum level.

If the above tips do not help, the system may crash. Please disconnect the battery and power adapter from your unit.

Then plug it in again and turn on your unit.

FCC WARNING:

This equipment may generate or use radio frequency energy. Changes or modifications to this equipment may cause harmful interference unless the modifications are expressly approved in the instruction manual. The user could lose the authority to operate this equipment if an unauthorized change or modification is made.

This device complies with part 15 of the FCC Rules. Operation is subject to the following two conditions:

(1) This device may not cause harmful interference, and (2) this device must accept any interference received, including interference that may cause undesired operation.

NOTE:

This equipment has been tested and found to comply with the limits for a Class B digital device, pursuant to part 15 of the FCC Rules.

These limits are designed to provide reasonable protection against harmful interference in a residential installation. This equipment generates, uses and can radiate radio frequency energy and, if not installed and used in accordance with the instructions, may cause harmful interference to radio communications. However, there is no guarantee that interference will not occur in a particular installation. If this equipment does cause harmful interference to radio or television reception, which can be determined by turning the equipment off and on, the user is encouraged to try to correct the interference by one or more of the following measures:

- Reorient or relocate the receiving antenna.
- Increase the separation between the equipment and receiver.
- Connect the equipment into an outlet on a circuit different from that to which the receiver is connected.
- Consult the dealer or an experienced radio/TV technician for help.
- The rating information is located at the bottom of the unit.

FCC RF Radiation Exposure and SAR Statements

This camera complies with RF radiation exposure limits set forth for an uncontrolled environment.

This equipment should be installed and operated with a minimum distance of 20 centimeters between the radiator and your body

This monitor has been tested for body-worn Specific Absorption Rate (SAR) compliance.

The FCC has established detailed SAR requirements and has established that these requirements.

RF Exposure Information The radio module has been evaluated under FCC Bulletin C95.1 and IEEE 1528 and found to be compliant to

RF Exposure from radio frequency devices. This model meets the applicable government requirements for exposure to radio frequency waves.

The highest reported SAR level for usage near the body (0mm) is 0.15 W/kg.

尺寸：125*90mm

专色：5615C

封面：157克双铜过亚膜

内页：105克双铜



support@bonoch.com