

- ③ First press will open the red galaxy , press again will close the red galaxy .
- ④ First press will open the green galaxy , press again will close the green galaxy .
- ⑤ Volume +
- ⑥ Previous song
- ⑦ Next song
- ⑧ Pause/Play
- ⑨ Volume -

- ⑩ First Press will open the blue galaxy , press again will close the blue galaxy .
- ⑪ First Press will open the white galaxy , press again will close the white galaxy .
- ⑫ Adjustment of galaxies' Light dynamic speed: First press galaxy will move slowly, Second press will make it move faster, Third press is static again, Circulate in turn.
- ⑬ Voice Control Button: Press the button will open the voice control. When the projector plays the music, the galaxy light and green stars will follow the sway with the musical rhythm; Press again will close the voice control.
- ⑭ The color gradient of galaxy Light: Press the button in turn: R-G- B-W-RG-RB-RW-GB-GW-BW
- ⑮ The color flash of galaxy Light: Press the button in turn: R-G-B-W-RG-RB-RW-GB-GW-BW
- ⑯ The color-changing of galaxy light: The default color is blue light (press the button in turn: R-G-W- RG-RB-RW-GB-GW-BW-single color gradually change - double color gradually change-single color breathing-double color breathing.
- ⑰ Adjustment of galaxy brightness: 100%---70%---40%---15%---40%---70%---100%; Circulate in turn
- ⑱ Timing 0.5 hour
- ⑲ Timing 1 hour
- ⑳ Timing 1.5 hours
- ㉑ Cancel timing

## UFO STAR PROJECTOR INSTRUCTIONS MANUAL



Product information			
Name	UFO Star Projector	Model	WH-E13
Size	Φ173mm*H86mm	Product Color	Blue /White
Product Specification	Remote Control & Bluetooth Type		
Light Color	Blue, Red, Green, White		
Input	DC 5V		
Current	2A		
Power	8W (1*4W/LED module+4*0.1W/LED module)		

Packing List: Projector\*1+Remote Control\*1+1.5m Type-c cable\*1+Manual\*1

#### Note:

- This power adapter of the product requires USB DC 5V/2A. Please use qualified adapter, otherwise it will influence the life of the product or damage it.
- Please operate it strictly according to the instructions. Please don't dismantle the main engine and parts.
- This product is suitable for indoor use.
- This product can regulate the angle of projection.

#### Instructions:

1. It's suitable for indoors, projecting towards the sky, wall or ceiling. The direction can be adjusted.
2. The following picture shows how to adjust the projection's direction.

3. You can connect the Bluetooth "WH-E13" with your phone to play music.

PS: The projector comes with a metal stand that allows adjusting projection angles.

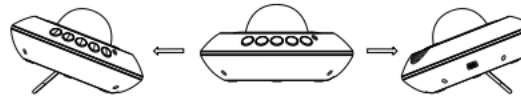

#### 4. The instructions of product's function button

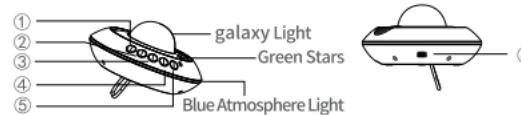

- ① The color-changing of galaxy Light: The default color is blue light (press the button in turn: R-G-W-RG-RB-RW-GB-GW-BW-single color gradually change - double color gradually change - single color breathing-double color breathing).
- ② Projective mode button: First press will turn on four kinds of color galaxy light and the blue atmosphere light around the projector; Second press will turn on green stars and the blue atmosphere light around the projector; Third press will turn on four kinds of color galaxy light, green star and the blue atmosphere light around the projector;

③ ON/OFF Button: Press it to turn the galaxy light on, the green stars will be in breathing mode, and the blue atmosphere light around the projector will always be on; the Bluetooth will turn on synchronously, you can connect the Bluetooth "WH-E13" with your phone to play music. (if Bluetooth is not connected for 10 minutes, it will be automatically disconnected). The projector will automatically turn off after 6 hours by default.

④ Adjustment of galaxies' dynamic speed button: Initial default is static. First press galaxy will move slowly, Second press will make it move faster, Third press is static again, Circulate in turn.

⑤ Voice Control Button:

Press the button to do the voice control. When the projector plays the music, the galaxy light and green stars will follow the sway with the musical rhythm; Press again to close the voice control.

⑥ TYPE-C Input port: 5V/2A

#### 5. The instructions of remote control:

① ON/OFF Button

② Projective mode switch:

First press will turn on four kinds of color galaxy light and the blue atmosphere light around the projector; Second press will turn on Green stars and the blue atmosphere light around the projector; Third press will turn on four kinds of color galaxy light, green star and the blue atmosphere light around the projector;

This device complies with Part 15 of the FCC Rules. Operation is subject to the following two conditions: (1) this device may not cause harmful interference, and (2) this device must accept any interference received, including interference that may cause undesired operation

NOTE: This equipment has been tested and found to comply with the limits for a Class B digital device, pursuant to Part 15 of the FCC Rules. These limits are designed to provide reasonable protection against harmful interference in a residential installation. This equipment generates, uses and can radiate radio frequency energy and, if not installed and used in accordance with the instructions, may cause harmful interference to radio communications. However, there is no guarantee that

interference will not occur in a particular installation.

If this equipment does cause harmful interference to radio or television reception, which can be determined by turning the equipment off and on, the user is encouraged to try to correct the interference by one or more of the following measures:

- Reorient or relocate the receiving antenna.
- Increase the separation between the equipment and receiver.
- Connect the equipment into an outlet on a circuit different from that to which the receiver is connected.
- Consult the dealer or an experienced radio/TV technician for help.

Warning: changes or modifications not expressly approved by the party responsible for compliance could void the user's authority to operate the equipment

The device has been evaluated to meet general RF exposure requirements, the device can be used in portable exposure conditions without restriction