

Wi-Fi Temperature & Humidity Sensor

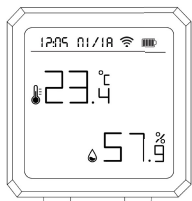

* Please read this manual carefully before use and keep it for future reference.

Product parameter

Size: 60*63*25mm
 Input voltage: DC4.5V LR03*3
 Quiescent current: ≤30uA
 Alarm current: ≤35uA
 Low power undervoltage: ≤2.7V
 WiFi: 802.11b/g/n 2.4GHz
 Working temperature: -10°C~55°C
 Working humidity: 10%~90%RH

1

Appearance introduction:

Time Date WiFi

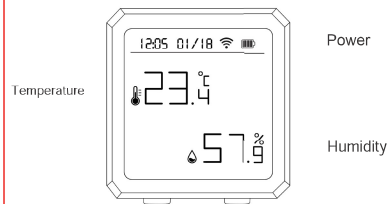

2

How to set up:

1. First scan QR code with your smartphone, or search "Smart Life" app in Google Play Store or APP Store to download and install app.



3

2. Register the app with email address, then click "Home" "+" on the app interface or click "Add Device". Then select "Sensors" and choose "Temperature and Humidity Sensor (Wi-Fi)".

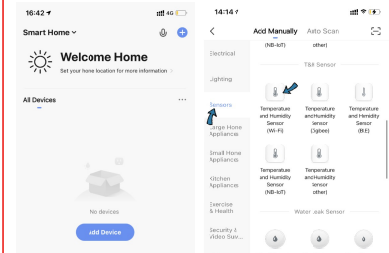

4

3. EZ Mode: (Easy-Connect Network, here called EZ mode); Press the button of sensor **once**, then the WiFi icon will indicate on sensor display. Then select the "EZ mode" of app in phone, then press "Next". Finally the sensor will enter the automatic network.

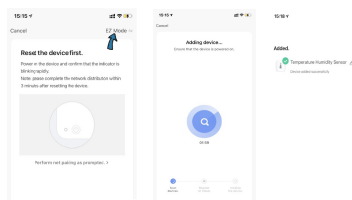

5

4. AP Mode (Access Point Connect Network, here called AP mode): First press the button of the sensor **twice**, whole icon will flash on sensor display, then select the "AP mode" of app in phone, then press "Next" and "Go to Connect", then choose "SmartLife-XXXX" in WiFi setting of phone, finally return the app interface, the sensor will connect WiFi automatically.

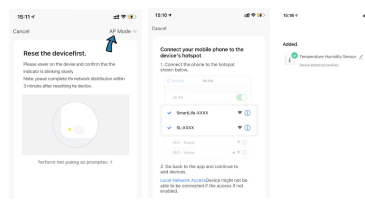

6

5. After connect WiFi successfully, click the sensor icon to enter the app interface and do some setting. You can preset the value of temperature and humidity for alarming from here.

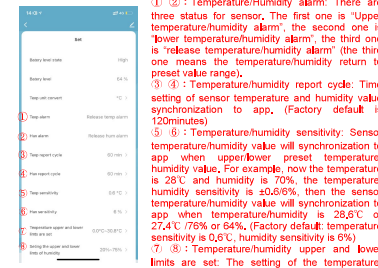

5

6. Intelligent Linkage

When the ambient environment change, you can do intelligent linkage. For example, the air conditioner will be on automatically when the room temperature surpass 35°C. And the humidifier will spray when the humidity is lower than 20% RH.

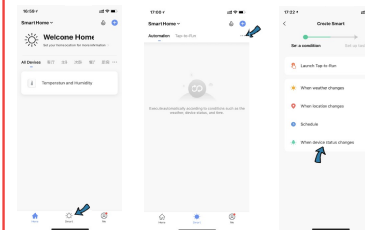

6

7. Share devices

You can share your added devices with your family members, so they can also monitor the ambient environment.

9. Screen on Sensor

You can do real-time monitor the temperature and humidity on the screen directly.

10. Temperature Unit Selection in APP
 You can choose °C or °F as the temperature unit through app.

11. Third-party Voice Control
 Works with amazon alexa, google assistant.

7

This equipment has been tested and found to comply with the limits for a Class B digital device, pursuant to part 15 of the FCC Rules. These limits are designed to provide reasonable protection against harmful interference in a residential installation. This equipment generates, uses and can radiate radio frequency energy and, if not installed and used in accordance with the instructions, may cause harmful interference to radio communications. However, there is no guarantee that interference will not occur in a particular installation. If this equipment does cause harmful interference to radio or television reception, which can be determined by turning the equipment off and on, the user is encouraged to try to correct the interference by one or more of the following measures:

- Reorient or relocate the receiving antenna.
- Increase the separation between the equipment and receiver.
- Connect the equipment into an outlet on a circuit different from that to which the receiver is connected.
- Consult the dealer or an experienced radio/TV technician for help.

Caution: Any changes or modifications to this device not explicitly approved by manufacturer could void your authority to operate this equipment.

This device complies with part 15 of the FCC Rules. Operation is subject to the following two conditions: (1) This device may not cause harmful interference, and (2) this device must accept any interference received, including interference that may cause undesired operation.

The device has been evaluated to meet general RF exposure requirement.