



Model: ES-VDAO01
Thank You Button
User Guide



To us, every thumbs up moment is an opportunity to add a little bit of brightness into each other's day. Use EASAY Thank You Button to spread some gratitude on the road.

Get Road Ready

The suction cup attachment can only be used in an SUV, car, van, truck or minivan. The Thank You Button is not designed to be used on motorcycles, mopeds, scooters or pushbikes.

Replace Your Batteries

NOTE: This product does not contain batteries, please purchase additional batteries before use.

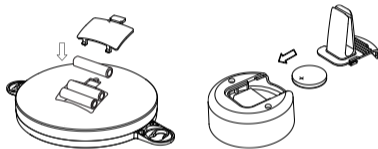

Remove the battery cover from the back, insert three AAA batteries and clip the cover into place.

Slide the back cover off, insert your coin cell battery and replace the back cover.



Ensure you insert batteries into your device correctly with the + (plus) and - (minus) terminals aligned. Make sure that the correct size and type of battery is used. The Thumbs Up Light uses three 1.5volt AAA batteries and the Thank You Button uses a CR2032 3volt lithium coin cell battery. Use alkaline batteries instead of carbon-zinc batteries.

If it is not used for a long time, take out the batteries to avoid battery leakage. Recycle used batteries at your nearest recycling center.



DO

Do use the correct fitting for your vehicle type. Do read these instructions before using your Thank You Button and save them for future reference.

Do be mindful that tinted back windows may affect the brightness and visibility of your Thumbs Up Light.

Do ensure your Thumbs Up Light is positioned in a manner that does not obstruct the driver's view.

Do periodically check to ensure your Thumbs Up Light is firmly fixed in place.

Do use inside your car as this product is not water-proof.

Do say thanks on the road by using your EASAY Thank You Button.



DON'T

Don't tamper with any internal components. Don't use on the exterior of your vehicle. Don't subject the unit to excessive smoke, dust, mechanical vibration or shock.

Getting Started

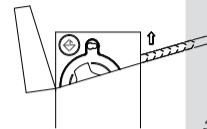

1. Unbox your Thank You Button.



2. Position your Thumbs Up Light in the rear window. The lower left hand corner is an ideal position.



It is important to position the Thumbs Up Light in such a way that it does not obstruct the driver's view.

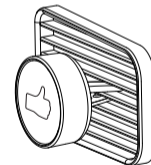

3. Clip your Thank You Button into your air vent in an easy-to-access position.



EASAY

Manufacturer: Shenzhen Danya Technology Co.,Ltd.
Address: Room 705, Building E, Galaxy World Phase II,
Minle Community, MinZhi Street, Longhua District,
Shenzhen, China



Rev_1.2_EN



4. Before first use, press and hold the Thank You Button until the indicator is blinking to pair with the Thumbs Up Light.

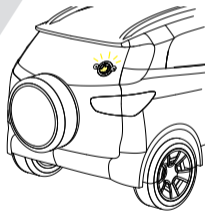

5. Press the Thank You Button to activate your Thumbs Up Light after pairing is successful.

Troubleshooting

Q: The Thumbs Up Light does not light up or work abnormally.

A: Replace batteries and try again.

Q: Thank You Button indicator does not light up or work abnormally after pairing successfully.

A: Replace the CR2032 coin cell battery.

Q: Failed to pair with the Thumbs Up Light.

A: Hold the Thank You Button until the indicator is blinking, keep holding and reload the battery of the Thumbs Up Light, wait until the indicator is blinking, then release the button.

Q: Why does the light delay sometimes?

A: In order to conserve power and extend the battery life, this product has optimized power consumption. It is normal that there is a delay occasionally after pressing the button.



**WARNING:
CHOKING HAZARD**

Small parts. Not suitable for children under 3 years old.

CHOKING HAZARD:

The Thank You Button contains a CR2032 3-volt lithium coin cell battery and is not suitable for children under 3 years old. If ingestion does occur, be aware that initial symptoms may be similar to other childhood illnesses such as coughing, drooling and discomfort. **Seek medical advice immediately.**



This product is not intended for use by young children or infirm persons without supervision.

Warranty

12 Month Warranty.

NOTE: This equipment has been tested and found to comply with the limits for a Class B digital device, pursuant to part 15 of the FCC Rules. These limits are designed to provide reasonable protection against harmful interference in a residential installation. This equipment generates uses and can radiate radio frequency energy and, if not installed and used in accordance with the instructions, may cause harmful interference to radio communications. However, there is no guarantee that interference will not occur in a particular installation. If this equipment does cause harmful interference to radio or television reception, which can be determined by turning the equipment off and on, the user is encouraged to try to correct the interference by one or more of the following measures:

- Reorient or relocate the receiving antenna.
- Increase the separation between the equipment and receiver.
- Connect the equipment into an outlet on a circuit different from that to which the receiver is connected.
- Consult the dealer or an experienced radio/TV technician for help

Changes or modifications not expressly approved by the party responsible for compliance could void the user's authority to operate the equipment.

This device complies with Part 15 of the FCC Rules. Operation is subject to the following two conditions:
(1) this device may not cause harmful interference, and (2) this device must accept any interference received, including interference that may cause undesired operation.