

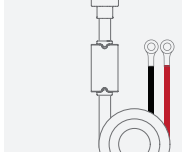
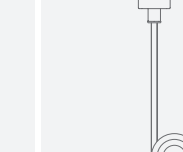
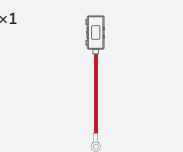
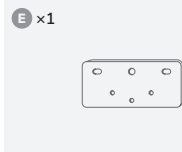

## What's In the Box

Lieferumfang | Contenu du coffret | Contenido | 包装清单 | 同梱物について | 구성품 | محتويات الصندوق

<b>A</b> x1 	<b>B</b> x1 	<b>C</b> x1 
<b>D</b> x1 	<b>E</b> x1 	<b>F</b> x3 
<b>G</b> x2 	<b>H</b> x2 	<b>I</b> x2 
<b>J</b> x2 	<b>K</b> x1 	<b>L</b> x1 

## Wiring Diagram

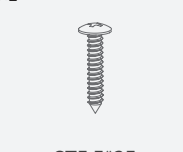
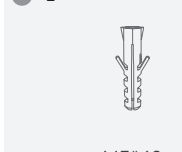
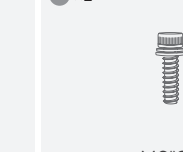
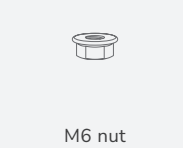
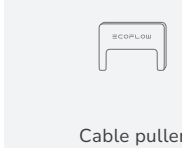
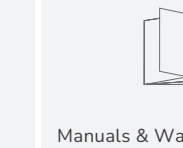
Schaltplan | Schéma de câblage | Diagrama de cableado | 连接示意 | 配線図 | 배선 다이어그램 | مخطط الأسلاك

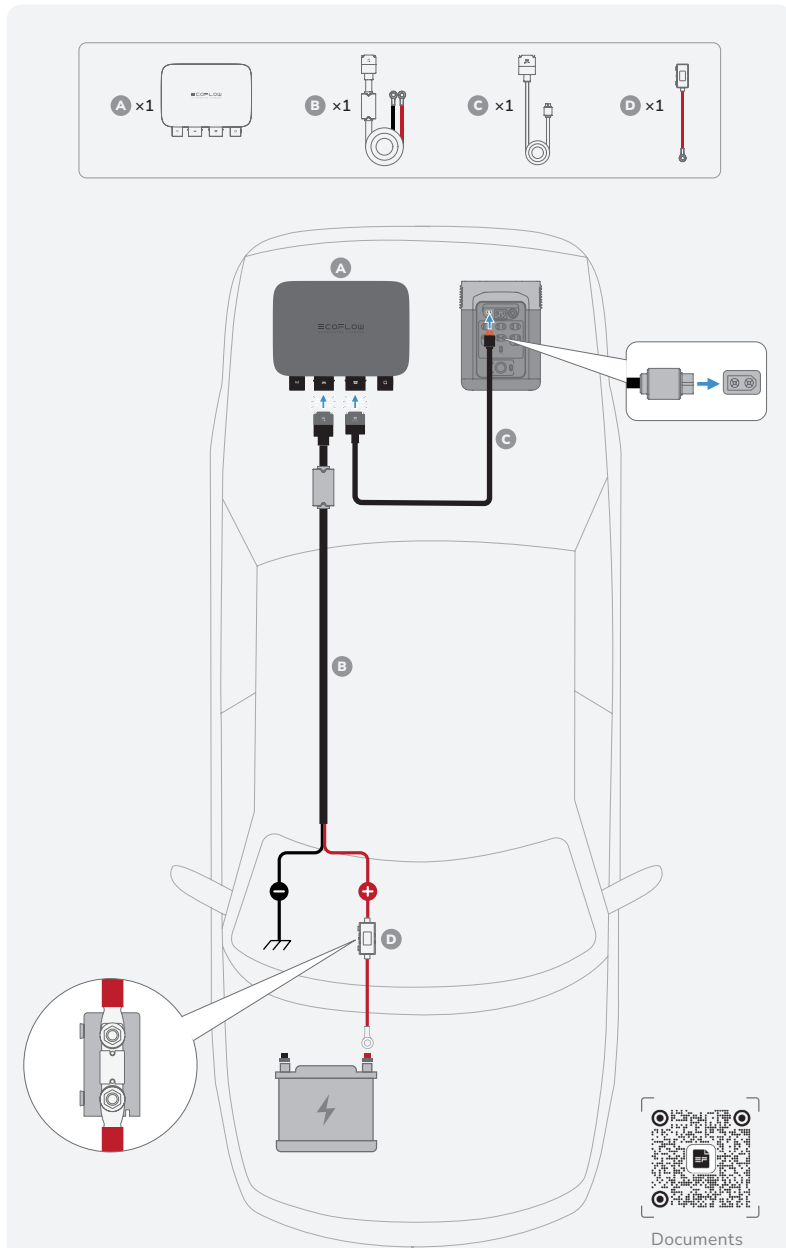

## Install

### the Charger (Optional)

Installieren Sie das Ladegerät (optional) | Installer le chargeur (en option) | Instalar el cargador (opcional) | 安装方式 (非必须) | 充電器の取り付け (オプション) | 충전기 설치 (선택 사항) | تثبيت الشاحن (اختياري)

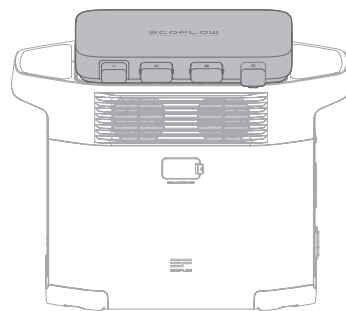

**EN** For smooth rides, you can place the charger on the power station. For bumpy rides, it's recommended to install the charger securely.

**DE** Bei ruhiger Fahrt kann das Ladegerät auf der Powerstation platziert werden. Bei holprigen Fahrten empfiehlt es sich, das Ladegerät sicher zu befestigen.

**FR** Si vous conduisez sur des routes lisses, il est suffisant de simplement poser le chargeur sur la station électrique. Pour des routes cahoteuses, il est recommandé de fixer fermement le chargeur.

**ES** En el caso de viajes sin baches, puede colocar el cargador sobre la estación de energía. En el caso de viajes con baches, se recomienda fijar y asegurar el cargador.

**CHS** 若路程较为平稳, 您可以将产品放置在户外电源上。若路程较为颠簸, 建议安装固定产品。

**JP** 振動が少ない環境では、ポータブル電源に充電器を置くことができます。振動が多い環境では、充電器を安全に設置することをお勧めします。

**KR** 원활한 주행을 위해 충전기를 전원 스테이션에 위에 놓을 수 있습니다. 거친 환경에서 주행 시, 충전기를 안전하게 설치하는 것이 권장됩니다.

**AR** لتحقيق قيادة سلسة، يمكنك وضع الشاحن على محطة الطاقة. بالنسبة للرحلات الوعرة، يوصى بتثبيت الشاحن بشكل آمن.

## Method 1

Method 1 | Méthode 1 | Método 1 | 方式一 | 方法 1 | 방법 1 | الأسلوب 1

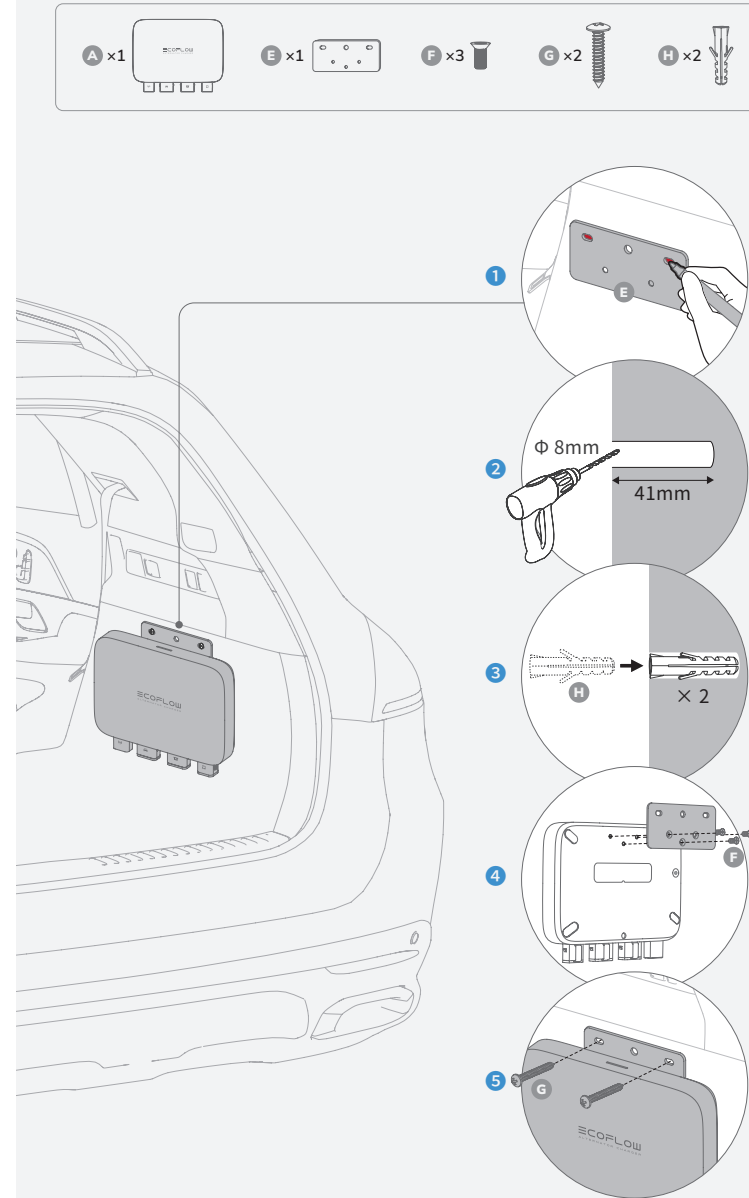

PAP 22  
Raccolta carta

© 2024 EcoFlow Inc. All rights reserved.

## Method 2

Methode 2 | Méthode 2 | Método 2 | 方式二 | 方法 2 | 방법 2 | الأسلوب 2

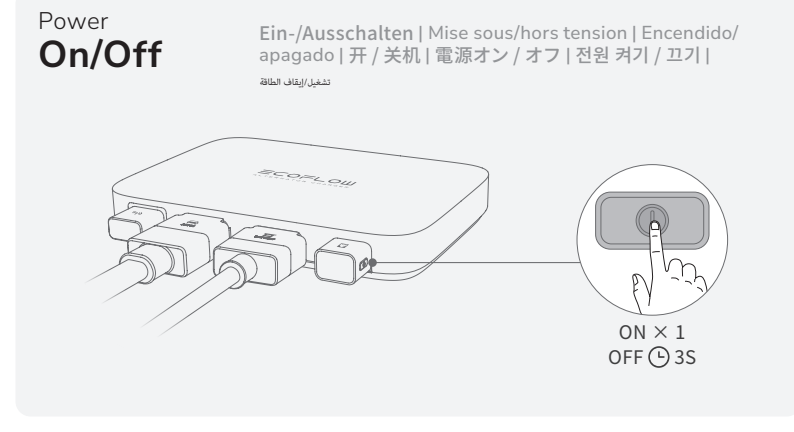
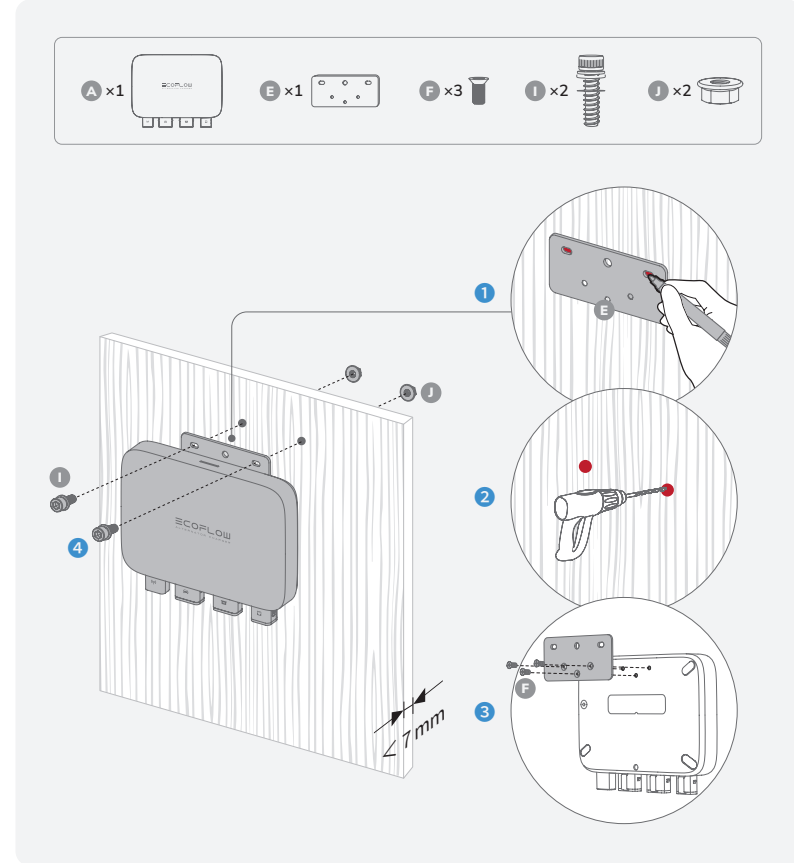

## Bind the Charger

Koppeln Sie das Ladegerät | Ajouter le chargeur à votre compte EcoFlow | Vincular el cargador | 如何绑定 | 充電器を紐づける | 충전기 연결 | ربط الشاحن

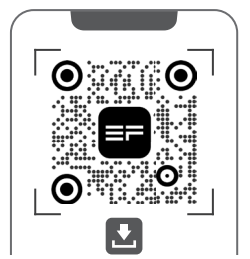

Download the EcoFlow app

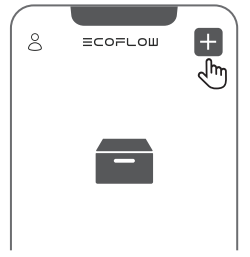

Tap to search for the charger



Bind the charger to your account

## How to Unbind

Entkoppeln | Dissocier le chargeur de l'application | Cómo desvincular | 解绑方式 | 紐づけを解除する方法 | 연결 해제 실패 | كيفية فك الارتباط

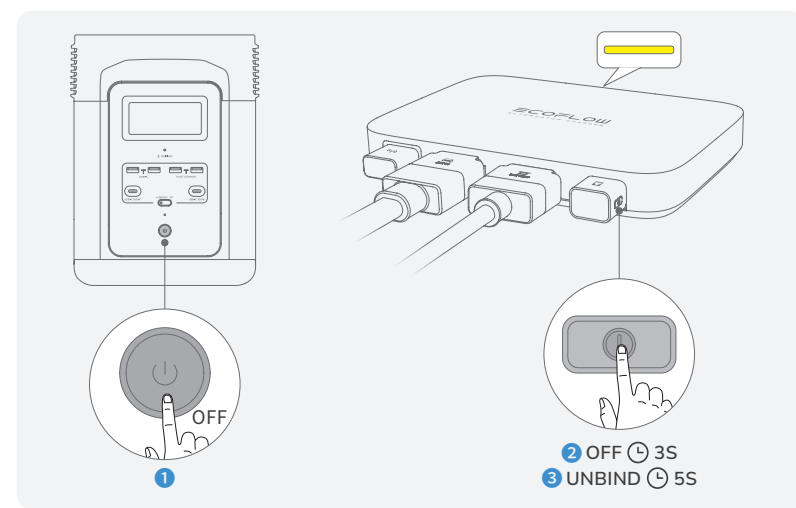

## Charge Mode

Lademodus | Mode de charge | Modo de carga | 充电模式 | 充電モード | 충전 모드 | وضع الشحن



## How to Disconnect

Verbindung trennen | Débrancher l'appareil | Cómo desconectar | 拔线方式 | ケーブルの外し方 | 연결을 끊는 방법 | كيفية قطع الاتصال

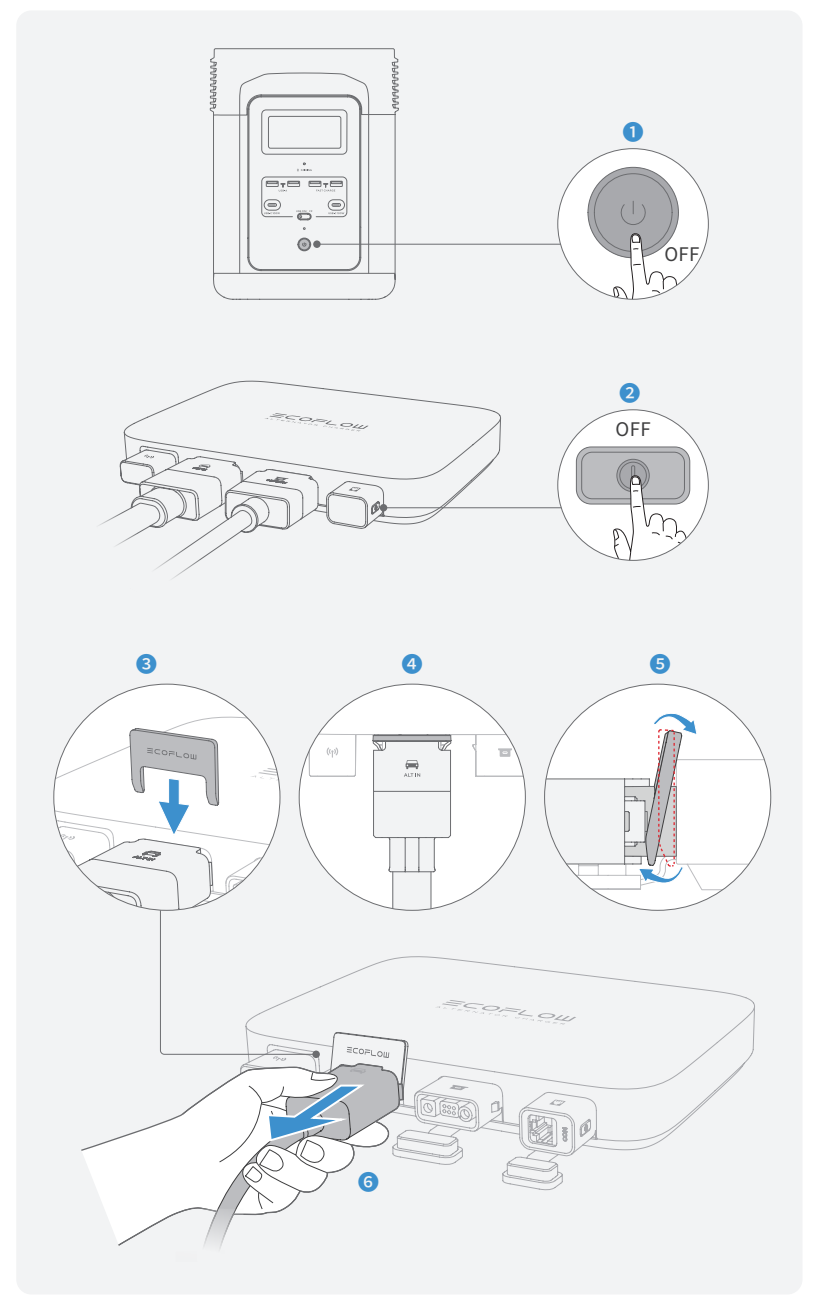

## QUICK START GUIDE

V1.0

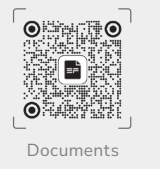
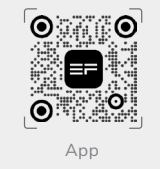
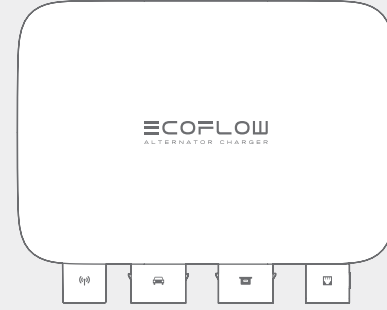

## EcoFlow Alternator Charger

For more details, check the latest user manuals or related documents. <https://www.ecoflow.com/support/download/alternator-charger-500w>

\*Images in this document are for reference only.