

# 87557

**LASER X<sup>™</sup> Walkie Talkies**

Ages 6+

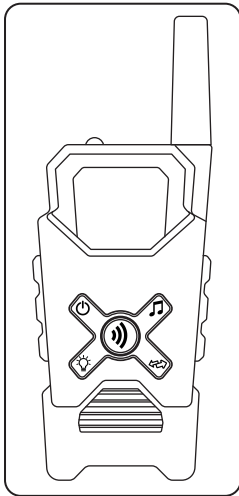

Dear Customer,  
NSI International, Inc. is the manufacturer of this product. We hope you enjoy your Laser X product. If you find that we have made an error or if something is missing or damaged, let us know so that we can correct the problem for you. Please include the following:

- Name of item
- Date of purchase
- Purchase price (please include sales slip)
- Model number
- Place of purchase
- Brief description of the problem

Send all correspondence to:

email: [custserv@nsi-int.com](mailto:custserv@nsi-int.com)

NSI International Inc., 235 W 23rd Street, 4th Floor, New York, NY 10011

Attn: Quality Control Department Telephone: 888-425-9113

**BATTERY SAFETY INFORMATION**

- Non-rechargeable batteries are not to be recharged.
- Rechargeable batteries are to be removed from the Laser X Walkie Talkies before being charged.
- Rechargeable batteries are only to be charged under adult supervision.
- Different types of batteries or new and used batteries are not to be mixed.
- Only batteries of the same or equivalent type as recommended are to be used.
- Batteries are to be inserted with the correct polarity (+ and -).
- Exhausted batteries are to be removed from the Laser X Walkie Talkies.
- The supply terminals are not to be short-circuited.
- Keep instruction sheet for reference since it contains important information.
- Do not mix old and new batteries.
- Do not mix alkaline, standard (carbon-zinc) or rechargeable (nickel-cadmium) batteries.

**FCC Compliance Statements**

This device complies with Part 15 of the FCC Rules. Operation is subject to the following two conditions: (1) this device may not cause harmful interference, and (2) this device must accept any interference received, including interference that may cause undesired operation

**Note:** This equipment has been tested and found to comply with the limits for a Class B digital device, pursuant to Part 15 of the FCC Rules. These limits are designed to provide reasonable protection against harmful interference in a residential installation. This equipment generates, uses and can radiate radio frequency energy and, if not installed and used in accordance with the instructions, may cause harmful interference to radio communications. However, there is no guarantee that interference will not occur in a particular installation. If this equipment does cause harmful interference to radio or television reception, which can be determined by turning the equipment off and on, the user is encouraged to try to correct the interference by one or more of the following measures:

- Reorient or relocate the receiving antenna.
- Increase the separation between the equipment and receiver.
- Connect the equipment into an outlet on a circuit different from that to which the receiver is connected.
- Consult the dealer or an experienced radio/TV technician for help.

**Caution:** Changes or modifications not expressly approved by the party responsible for compliance could void the user's authority to operate the equipment.

- (1) All controls, adjustments and switches that's instructed in the manual or follow-up instruction provided by the manufacturer that may be operated or adjusted without resulting in a violation of FCC rules.
- (2) Any adjustment that could result in a violation of FCC rules and it's recommended that could be performed only by or under the immediate supervision and responsibility of a person certified as technically qualified to perform transmitter maintenance and repair duties in this radio service by an organization or committee representative of users of that service.
- (3) Changes or modifications i.e. replacing any transmitter component (crystal, semiconductor, etc.) not expressly approved by the party responsible for compliance could void the user's authority to operate the product.
- (4) For a transmitter that can only be operated with an FCC license, warnings concerning compliance with applicable licensing requirements and information concerning license application procedures.

**ISED Compliance Statements**

This device contains license-exempt transmitter(s)/receiver(s) that comply with Innovation, Science and Economic Development Canada's license-exempt RSS(s). Operation is subject to the following two conditions:

- (1) This device may not cause interference.
  - (2) This device must accept any interference, including interference that may cause undesired operation of the device.
- L'émetteur/récepteur exempt de licence contenu dans le présent appareil est conforme aux CNR d'Innovation, Sciences et Développement économique Canada applicables aux appareils radio exempts de licence. L'exploitation est autorisée aux deux conditions suivantes :
- (1) L'appareil ne doit pas produire de brouillage;
  - (2) L'appareil doit accepter tout brouillage radioélectrique subi, même si le brouillage est susceptible d'en compromettre le fonctionnement.

**RF Exposure Information (SAR)**

Specific Absorption Rate (SAR) refers to the rate at which the body absorbs RF energy. This equipment has been tested and meets applicable limits for radio frequency (RF) exposure. During testing, device radios are set to their highest transmission levels and placed in positions that simulate use near the head and body, with 0 mm separation. Accessories with metal parts may change the RF performance of the device and use such accessories should be avoided.

The SAR limit is 1.6 W/kg over 1 gram of tissue in US/Canada.

**Informations sur l'exposition RF (DAS)**

Le débit d'absorption spécifique (DAS) renvoie au débit avec lequel le corps absorbe l'énergie RF. Cet équipement a été testé et est conforme aux limites applicables en termes d'exposition aux radiofréquences (RF). Pendant le test, les appareils radios sont configurés à leur niveau de transmission le plus élevé et placés dans une position simulant une utilisation près de la tête et du corps, avec 0 mm de séparation. Les accessoires possédant des pièces métalliques peuvent modifier la performance RF de l'appareil. L'utilisation de ces accessoires est donc déconseillée.

La limite DAS est de 1,6 W/kg pour 1 gramme de tissu aux États-Unis/au Canada.

### Installing Batteries

Insert 3 AAA (1.5V) batteries into Laser X Walkie Talkies.

Replace the battery door and screw it securely closed after installing batteries.

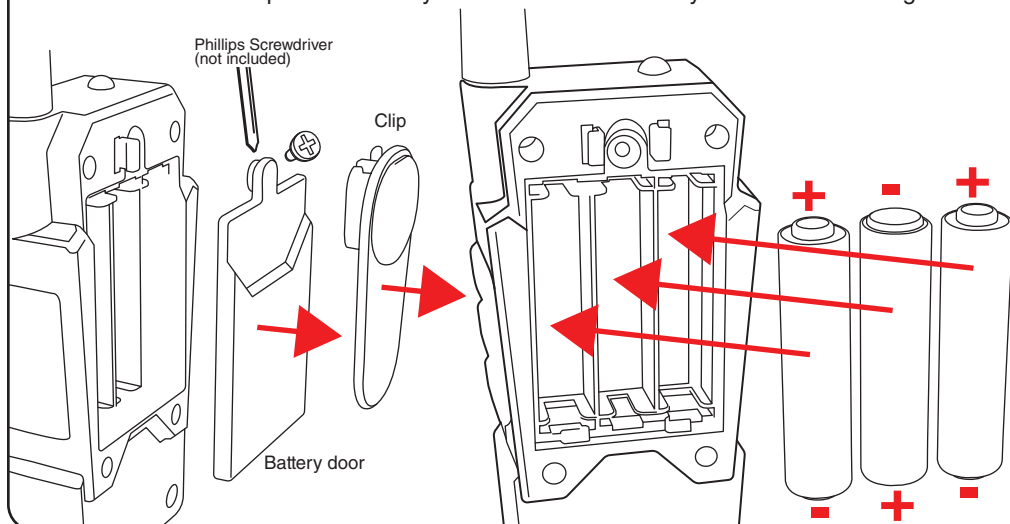

### Using your Walkie Talkie

#### CHANNEL INDICATOR

#### POWER

Press and hold to power on or off.

#### TALK

Press and hold to talk. Release when done talking.

#### FLASHLIGHT

Press and hold to activate Flashlight.

#### CALL ALERT

Press and hold to ring other Walkie Talkies on the same channel.

#### CHANNEL

- Press and hold to change the channel.
- There are three channels (Red, Blue, Purple).
- You can only communicate with others on the same channel as you.
- You can change channels at any time.