



## RAVENS TRUE WIRELESS NOISE CANCELLING EARBUDS



Good call on picking up the Outdoor Tech® Ravens True Wireless, Noise Cancelling Earbuds. Your experience of the universe will soon be enhanced powerfully. This manual exists to help make sure that you use them correctly, so you're definitely going to want to relax for a hot second and look through this.

Kisses,



OUTDOOR TECH.



IPX4 WATER RESISTANT

### ■ WHAT IS INCLUDED



Charging Case



Earbuds

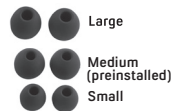

Large

Medium  
(preinstalled)

Small



USB-C to USB  
charge cable

### ■ ANATOMY

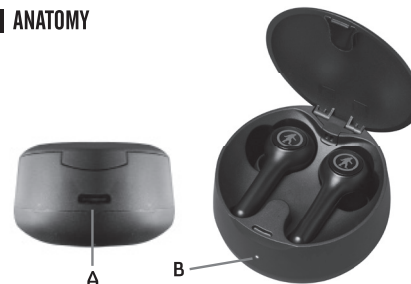

A. USB-C case charging port

B. Charging Case LED

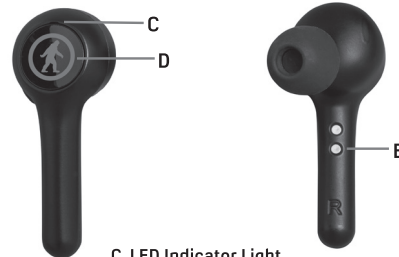

C. LED Indicator Light

D. Multi-function Button (MFB)

E. Charging pins

### ■ POWER ON/OFF

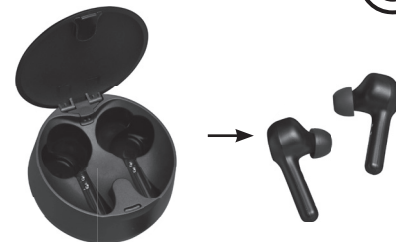

#### How to TURN ON:

Turn On: Method 1: Open the charging case. Take both earbuds out from the case, they will turn on and connect with each other automatically.

Method 2: Whilst the earbuds are off, press and hold the multi-function button on both earbuds for 2 seconds. LEDs on both earbuds will flash white for 1-2 seconds and you will hear a voice prompt "Power ON" from both earbuds.

#### How to TURN OFF:

Turn Off: Method 1: Put the earbuds back into the charging case, and close completely, they will automatically turn off.

Method 2: Whilst the earbuds are on, press and hold the multi-function button on both earbuds for 5 seconds. LEDs on both earbuds will flash red for 1-2 seconds and you will hear a voice prompt "Power OFF" from both earbuds.

### ■ PAIRING



Take both earbuds out of the charging case, they will power on and connect with each other automatically. On first use you will hear a voice prompt "pairing".



Enable Bluetooth on your device. Choose: "ODT Ravens" in your phone's Bluetooth settings.

VOICE PROMPT: "connected"

TOUCH CONTROLS



PLAY/PAUSE MUSIC	Short press the "MFB" button once.
VOLUME UP	Long press the "MFB" button on the right earbud (keep holding the "MFB" and the volume will keep going up, there will be a warning sound when you reach the maximum volume)
VOLUME DOWN	Long press the "MFB" button on the left earbud (keep holding the "MFB" and the volume will keep going down, there will be a warning sound when you reach the lowest volume)
NEXT TRACK	Double press "MFB" button on the right earbud.
PREVIOUS TRACK	Double press "MFB" button on the left earbud.
ANSWER/END CALL	Short press the "MFB" once.
REJECT INCOMING CALL	Press and hold the "MFB" for 2 seconds when call is coming in.
ACTIVATE VOICE ASSISTANT	Triple press the "MFB" on either earbud. Press it again to cancel.
FACTORY RESET	The earbuds must be charging in the case before resetting. Quick double press each of the earbuds successively.

LED INDICATOR GUIDE

STATUS	DESCRIPTION	VOICE PROMPT
Power On	White LED flashes about 1 second	"Power On"
Power Off	Red LED flashes about 1 second	"Power Off"
Pairing	White & Red LED flashes alternately on master earbud	"Pairing"
Connect	Both earbuds LEDs will turn off	"Connected"
Charging	Red LED is solid when the earbuds are charging	N/A

CHARGING EARBUDS



Charging the Earbuds

Ensure stickers are removed from the charging points on the stems of the buds.

Place ear buds into the charging case. Red light will illuminate on the earbuds to indicate charging.



CHARGING CASE



Charging the Case

Charge Case LED

Connect the USB-C end of the supplied charging cable to the charging case charge port.

Connect the USB end of the charging cable to a PC or AC/DC wall adapter (not provided). The charging case LED will be solid red to indicate charging. LED will turn off when charge is complete.



SPECS



Water/Sweat Resistance Rating: IPX4  
True Wireless/Noise Cancelling  
Operating Range Device to Earbud: 10 m (32 feet)  
Play Time: 8hrs at 50% Volume  
Earbuds Charge Time: 1.5 hrs  
Case Charging Time: 1.5 hours  
Number of Earbud Charges in the Case: 4 Charges  
Speaker Size: 6mm Drivers  
Speaker Sensitivity: 102±3dB, 1KHz  
Speaker Impedance: 32ohm  
Speaker Frequency Range: 20Hz-20KHz  
Bluetooth Version: BT5.0  
Earbud Battery Info: 901635/500MA  
Paired Devices: ODT Ravens  
Product Features: Answer Call, End Call, Reject Call, Volume Control, Track Control, Play/Pause Music, Siri/Google Assistant Activation

FCC Warning

This device complies with part 15 of the FCC Rules. Operation is subject to the following two conditions:(1) This device may not cause harmful interference, and (2) this device must accept any interference received, including interference that may cause undesired operation.

Any Changes or modifications not expressly approved by the party responsible for compliance could void the user's authority to operate the equipment.

This equipment has been tested and found to comply with the limits for a Class B digital device, pursuant to part 15 of the FCC Rules. These limits are designed to provide reasonable protection against harmful interference in a residential installation. This equipment generates uses and can radiate radio frequency energy and, if not installed and used in accordance with the instructions, may cause harmful interference to radio communications. However, there is no guarantee that interference will not occur in a particular installation. If this equipment does cause harmful interference to radio or television reception, which can be determined by turning the equipment off and on, the user is encouraged to try to correct the interference by one or more of the following measures:

- Reorient or relocate the receiving antenna.
- Increase the separation between the equipment and receiver.
- Connect the equipment into an outlet on a circuit different from that to which the receiver is connected.
- Consult the dealer or an experienced radio/TV technician for help.

The device has been evaluated to meet general RF exposure requirement. The device can be used in portable exposure condition without restriction.

