

## Warranty

You will enjoy 100% satisfaction service with your smart lock. We provide 30days full refund and 60 days replacement with any product issue. E-mail to us with your order information, you will get more.

Powered by **Oasbike Smart**

# Oasbike Smart Door Lock User Manual

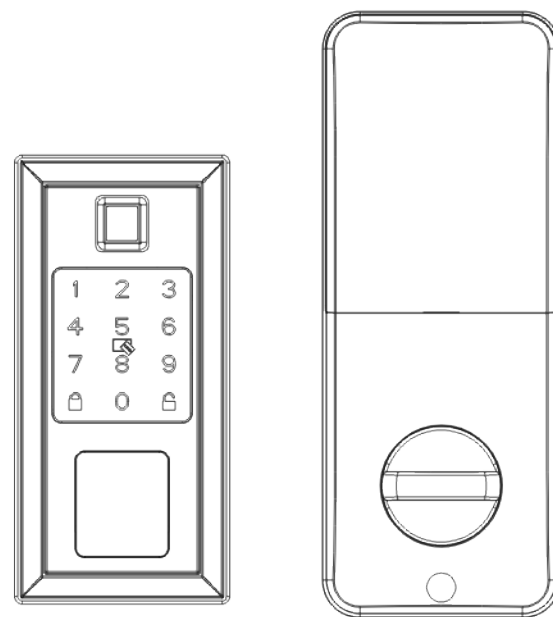

Powered by Oasbike Smart

Included in the box

Keypad

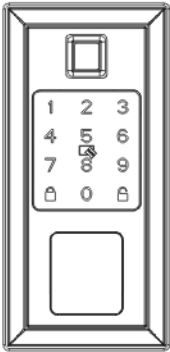

Interior Assembly

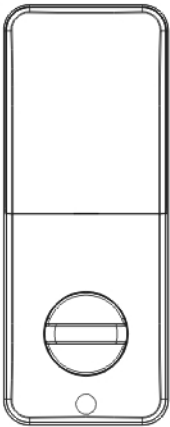

Mounting Plate

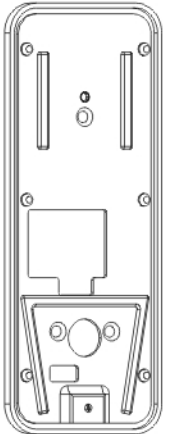

Deadbolt

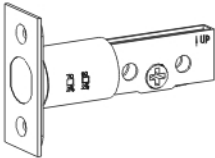

Strike Plate

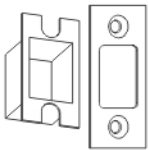

Back up KeysX2



CardsX3

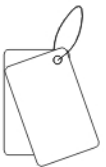

Cylinder



Screw A X4



Screw B



Screw C



Screw D



Connecting Solenoid FX3



Screw EX3



opening hole drawing

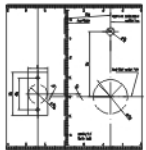

Lock Manual



Be aware of the door's operating direction

Left

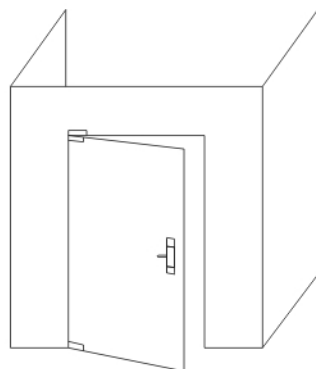

Right

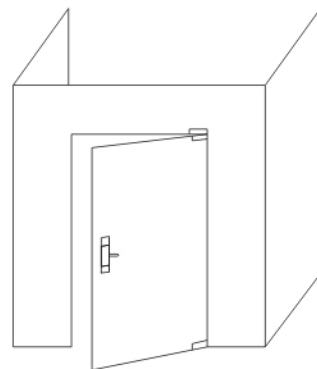

Disassemble your existing deadbolt from the door.

## Step1 Preparation

Check the door's dimensions

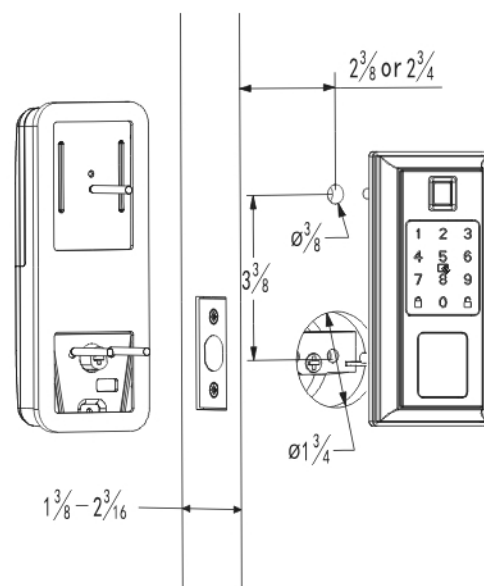

2

## Step2 Installing Deadbolt and Strike Plate

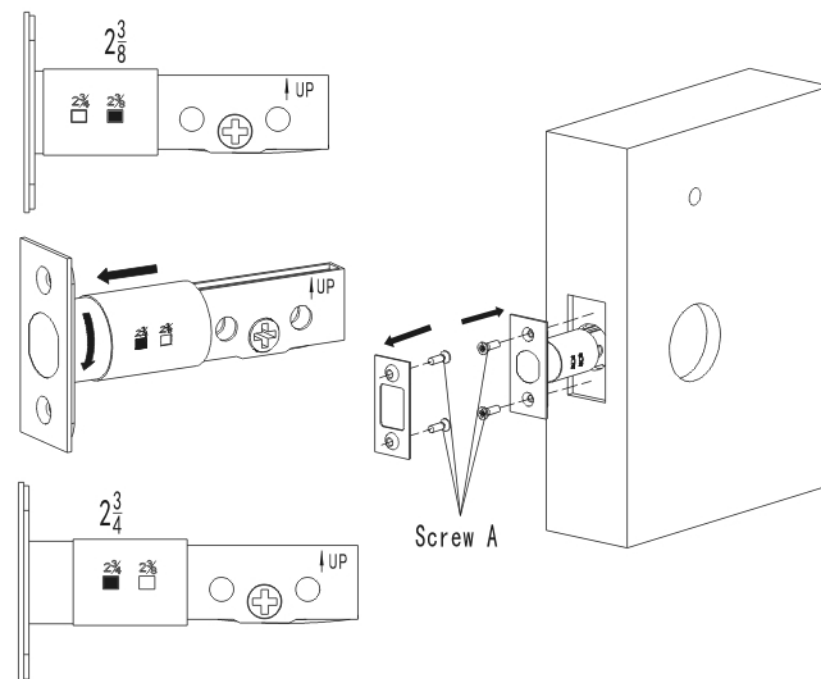

## Step3 Preparing Keypad

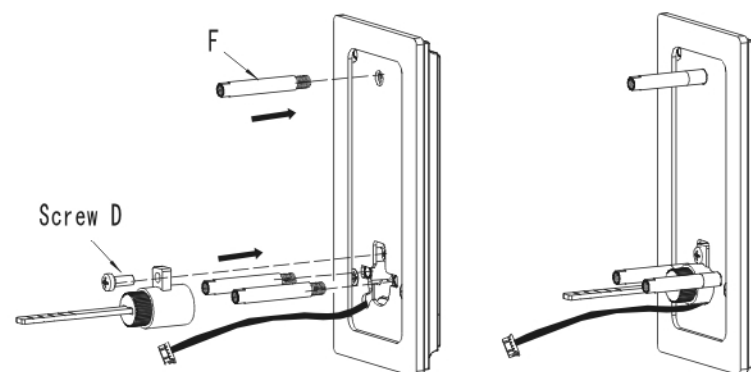

3

## Step4 Installing Keypad

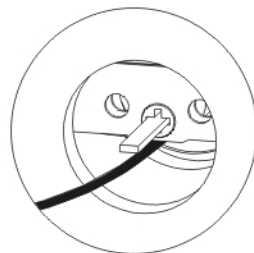
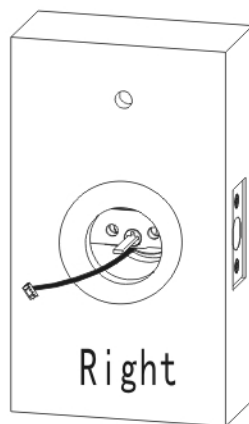
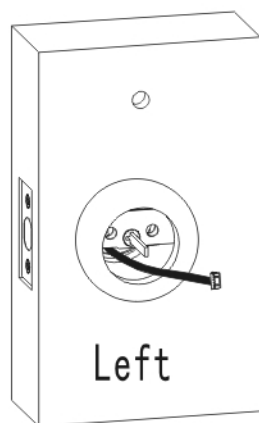
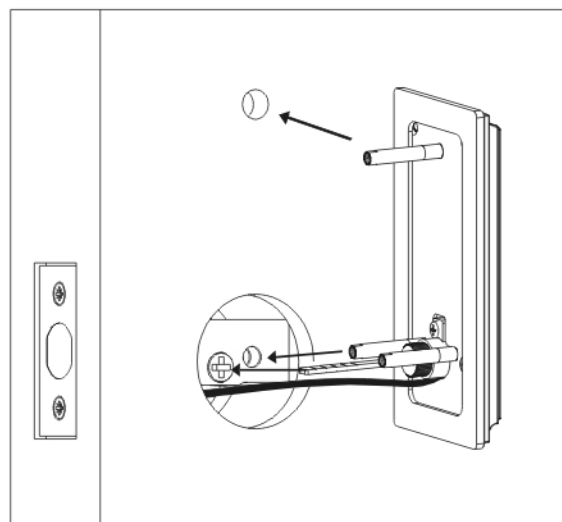

4

## Step5 Installing Mounting Plate

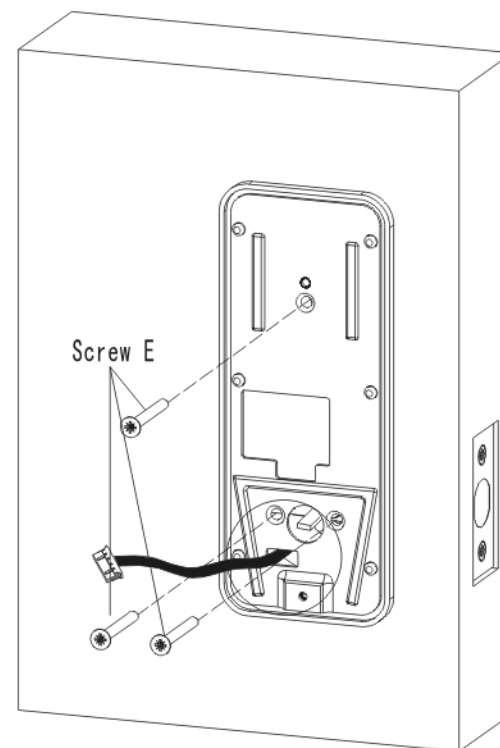
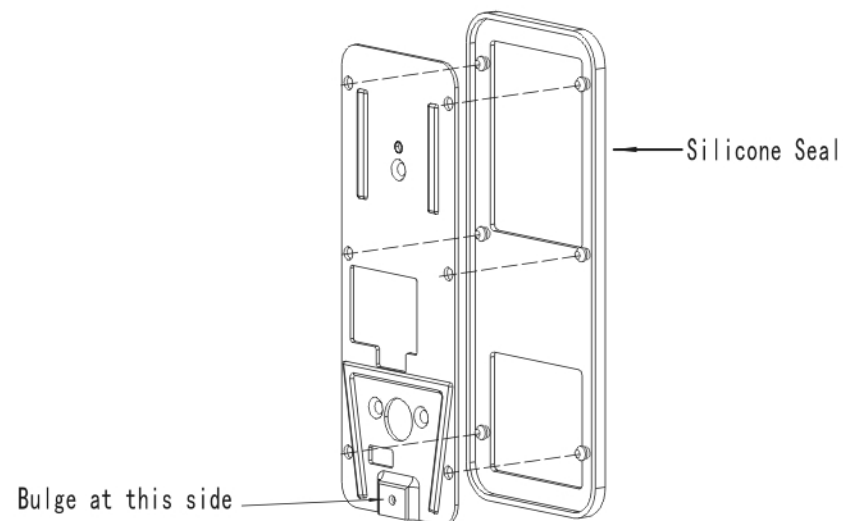

Route the wire through the hole

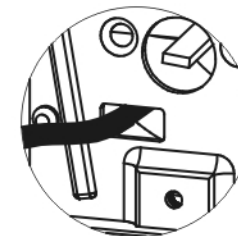

Turn the knob to test lock & unlock functions before fully tighten the screws  
Make sure the bolt extends and retracts smoothly.  
Do not over tighten the screws

5

### Step6 Preparing Interior Assembly

Make sure the switch and the knob are set to correct door handing

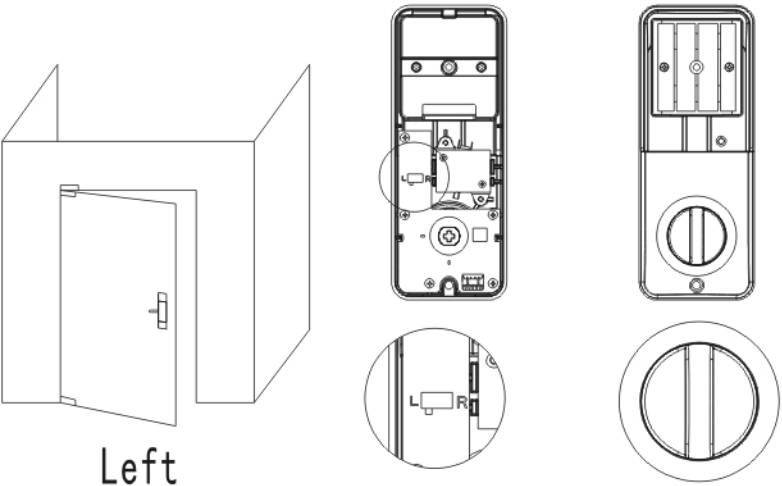

Left

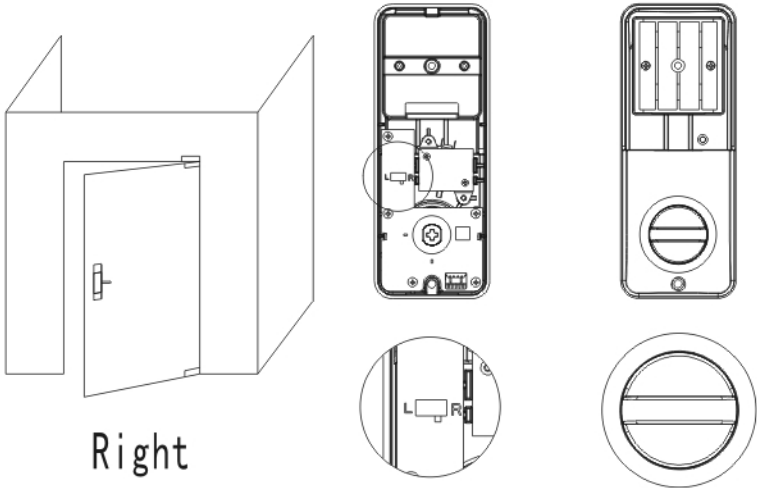

Right

### Step7 Connect the Cable

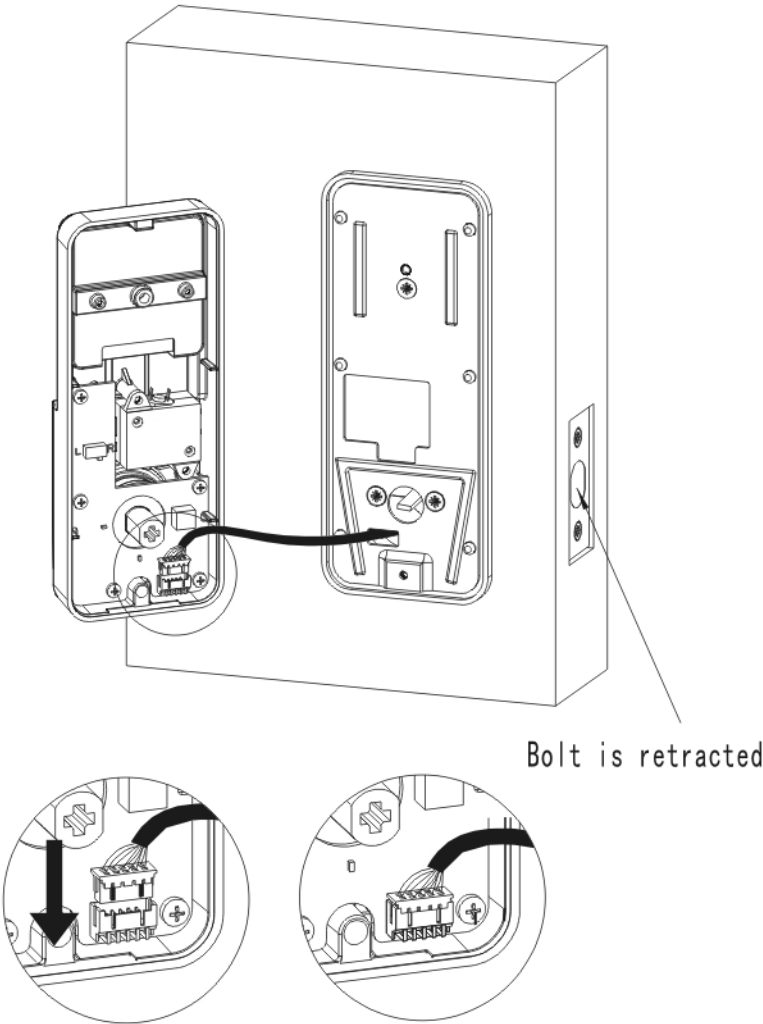

Bolt is retracted

## Step8 Installing Interior Assembly and Testing

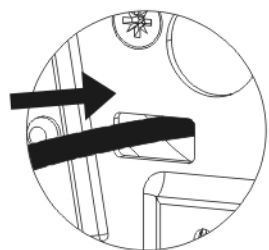
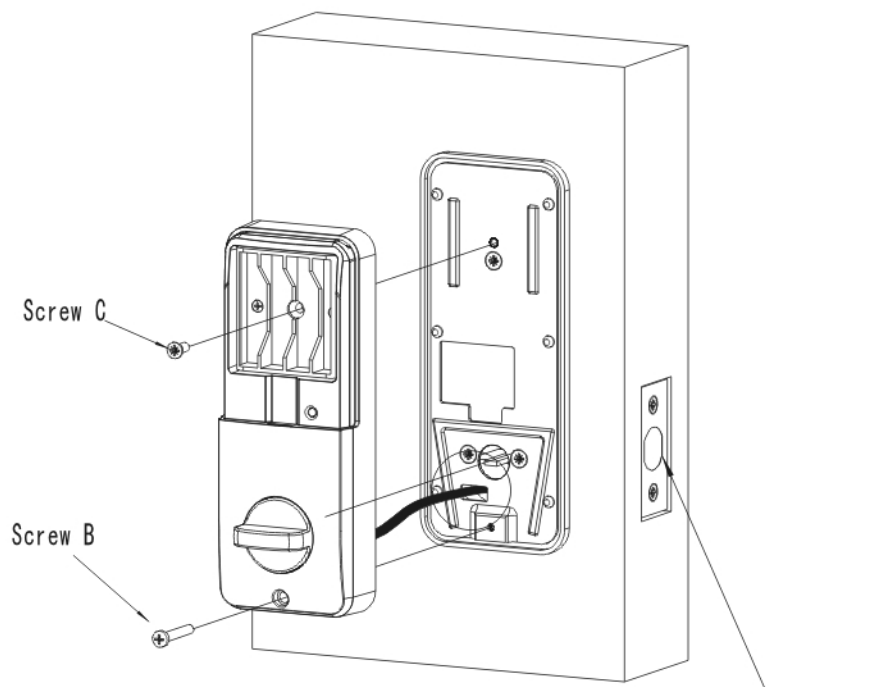

Push extra wire  
back into door hole  
thru this hole

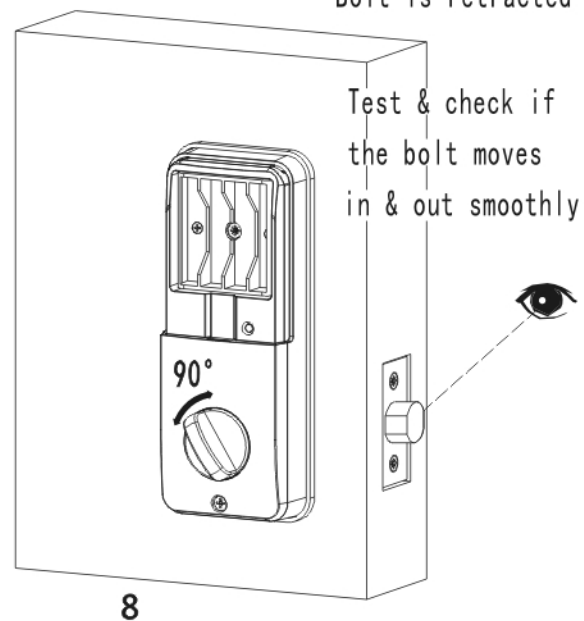

## Step9 Back Up Key Testing

Press the bottom side of the cover

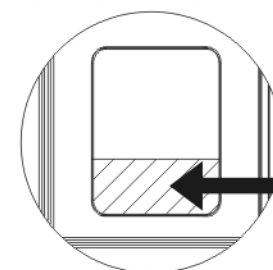
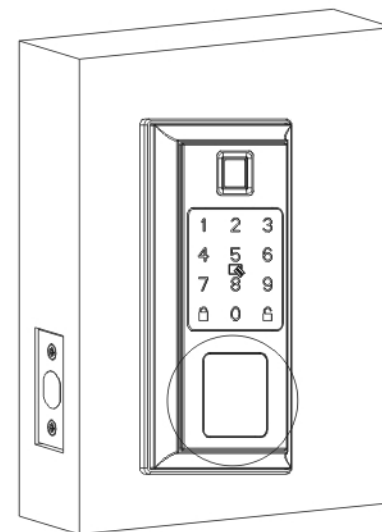

anti-clockwise rotate 120 degree

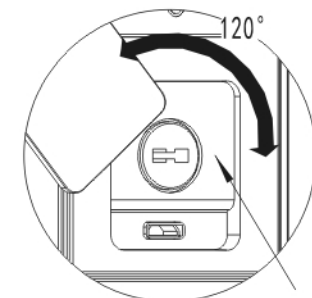

Emergency power

Test & check if  
the bolt moves  
in & out smoothly

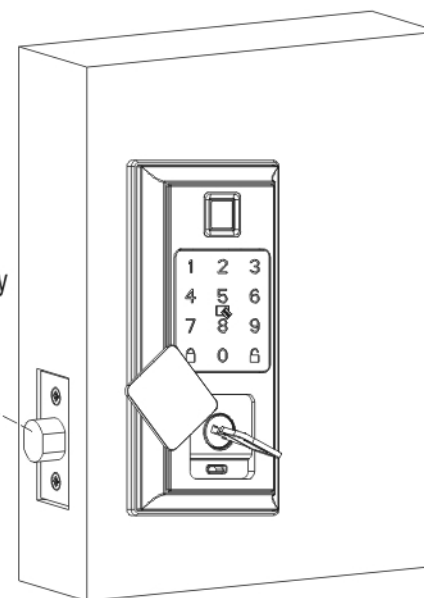

9

## Step10 installing Batteries & Cover

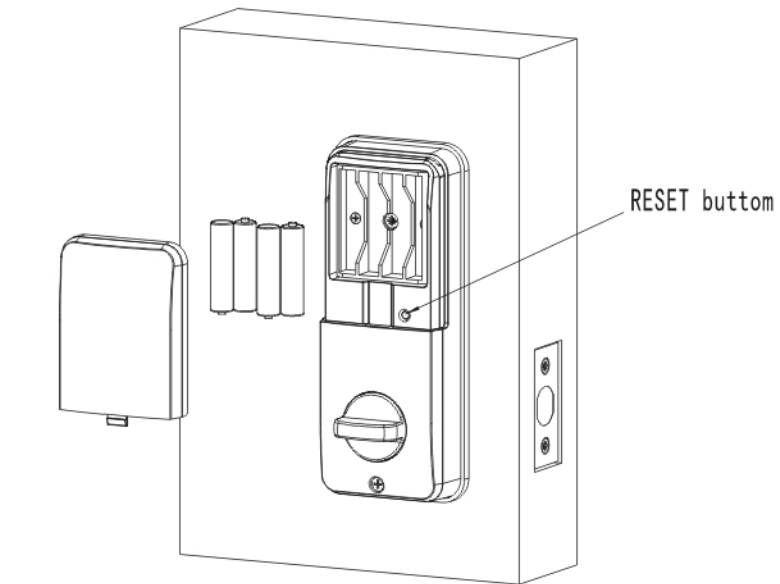

Slide the cover on

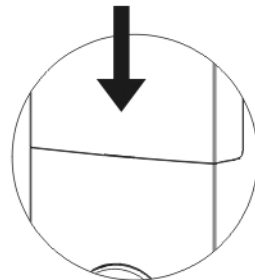

10

## Step11 Operation Testing

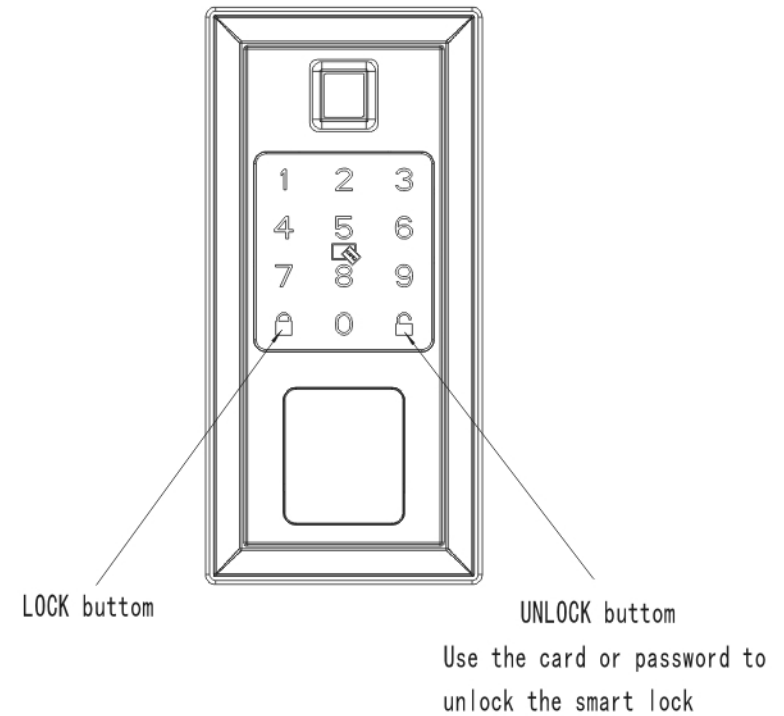

11

# Operation by APP via Bluetooth

## Part 1 Add lock

©Download and install **TTLock** from Google Play or APP Store



Google Play



APP Store

©Register account with phone number or e-mail and login

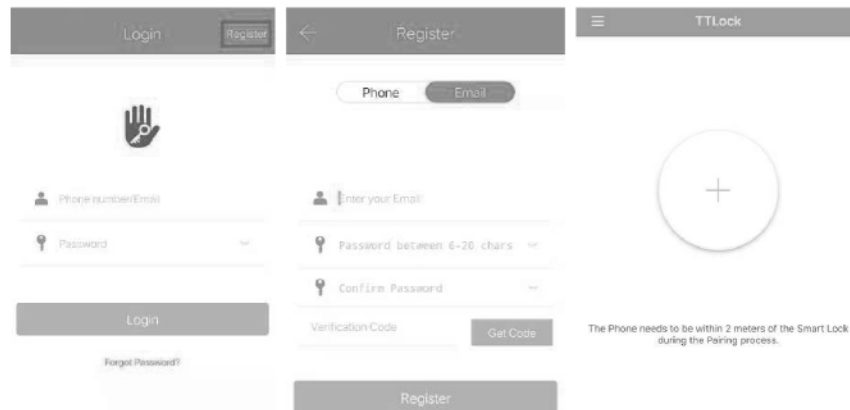

©Add your lock on APP

Please open Bluetooth setting on your phone before connection, and stay your phone within 2 meters away from your lock.

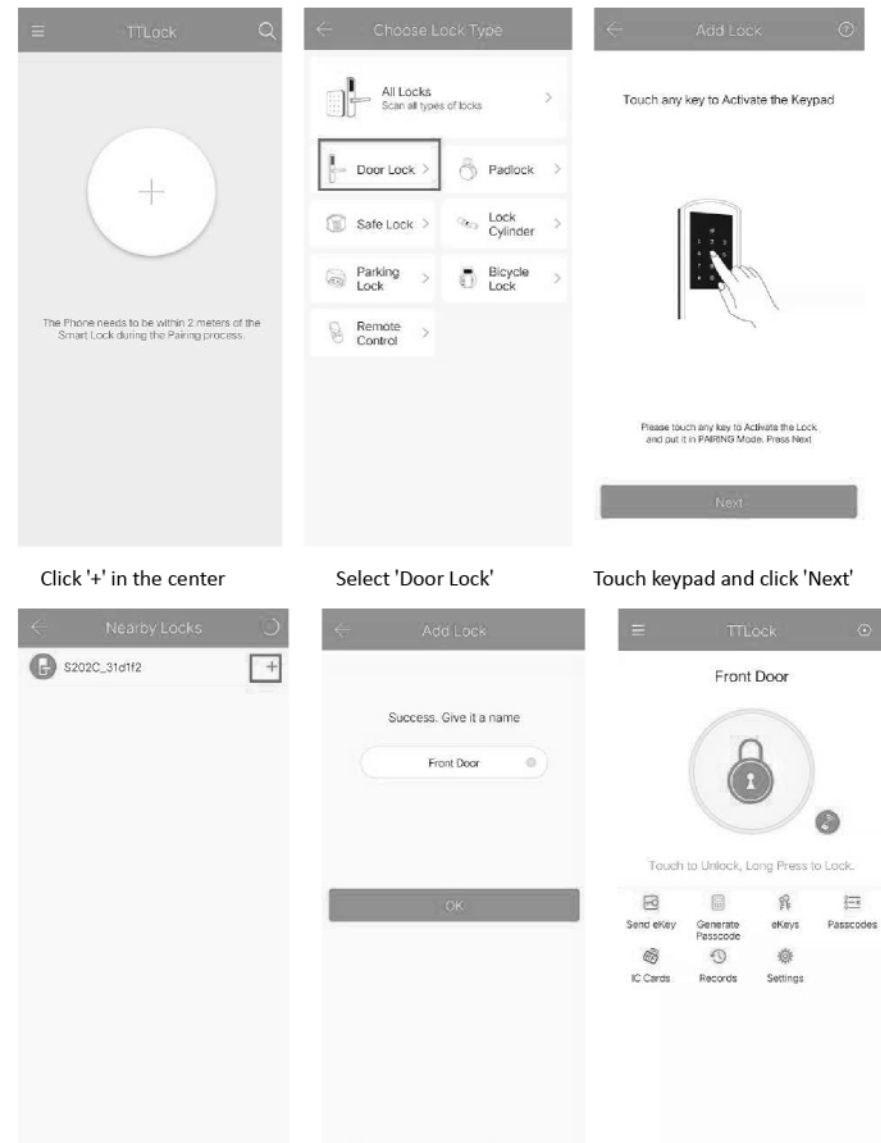

Click '+' with high-light device

Name your lock, and click 'OK'

Add completed

**Remarks:** Once there is no device or only has gray-label device on 'Nearby Locks' screen, please reset your smart lock and re-add it following steps below:

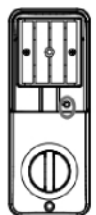



- ① Remove battery cover out
- ② Hold the reset button for 5 seconds

## Part 2 Unlock/lock by APP via Bluetooth

☉ Unlock by touching the lock button, it will pop up 'unlocked'

☉ Lock by long-pressing the lock button, it will pop up 'locked'

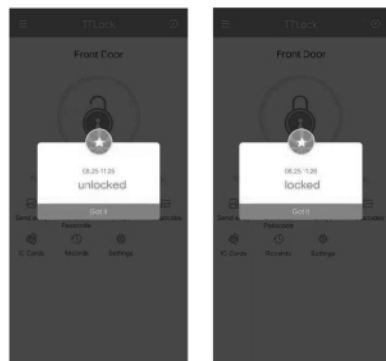

**Remarks:** Please check if your door lock operate in correct direction, once it reverse, please switch the toggle switch to other side and re-install it

## Part 3 Auto-lock setting

**Remarks:** Auto-lock is setting up only by the program, but couldn't be used to determine if your door is locked. And please stay your phone close to your lock during setting process.

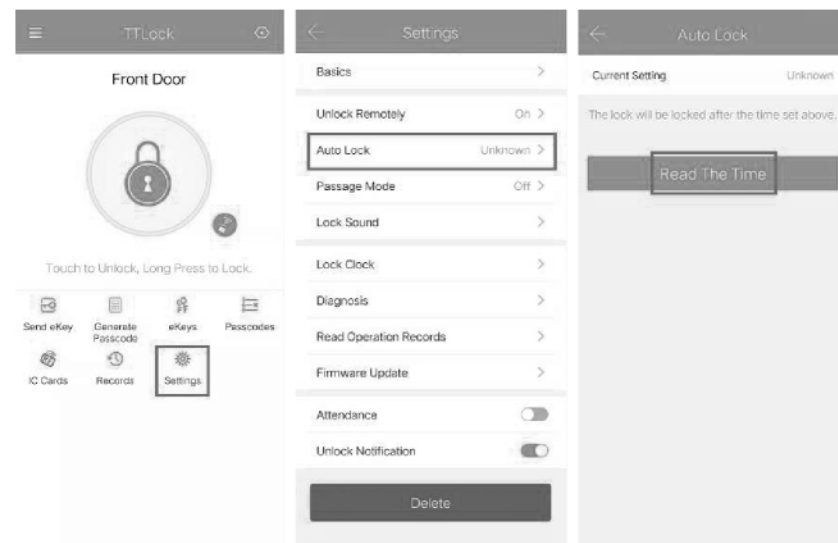

Click 'Settings'

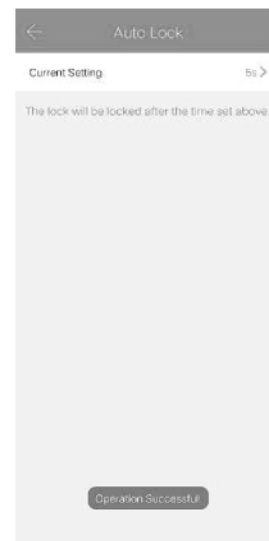

Click 'Current Setting'

Click 'Auto Lock'



Select period you need to set

Click 'Read The Time'

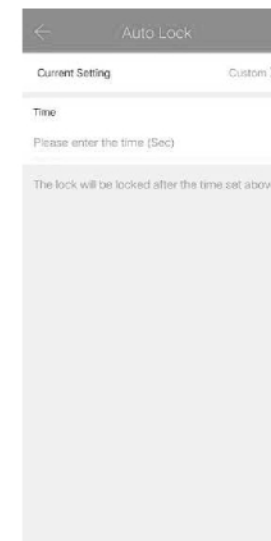

Or enter your time period

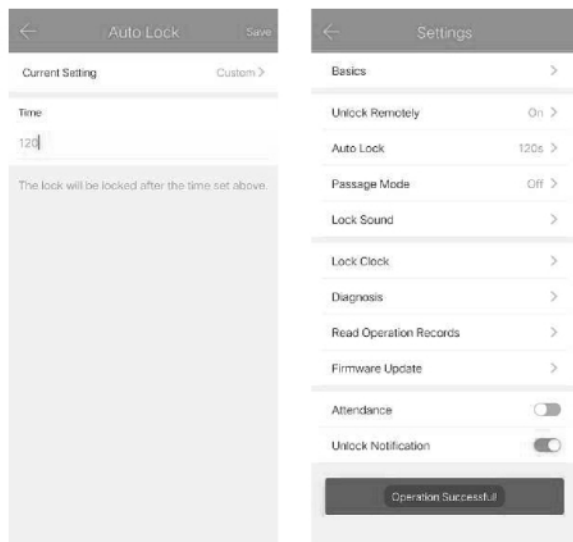

5-900S be your choice

Set up completed

#### Part 4 Share APP operation to your family/guests(ekey)

ekey is a function for you to authorize the rights to your family members and guests to unlock/lock your door by the same APP. eKey can be authorized to MAX. 20 smart phone users.

©Download TLock app and register a new account on new smart phone of family or guests.

© Click 'Send eKey' on the APP screen with admin account(The first account to add lock).

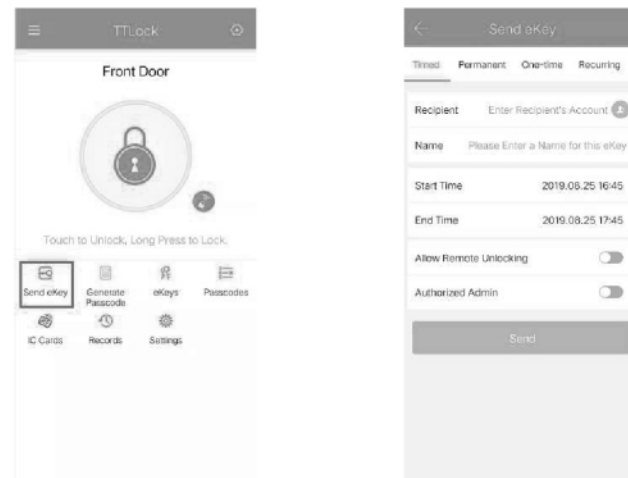

© Select Time, Permanent, One-time, Recurring eKey by yourself, then input Recipient account and name it.

©Select time period if necessary, then click 'send'.

©Refresh by pulling down on the APP screen with new smart phone APP, the smart lock will show up on the APP screen.

**Remarks:** Admin account can manage all guest accounts by clicking 'eKeys' on APP screen.

#### Part 5 Lock Sound

The original setting for this smart lock is Lock Sound On, but you can close it if you want.

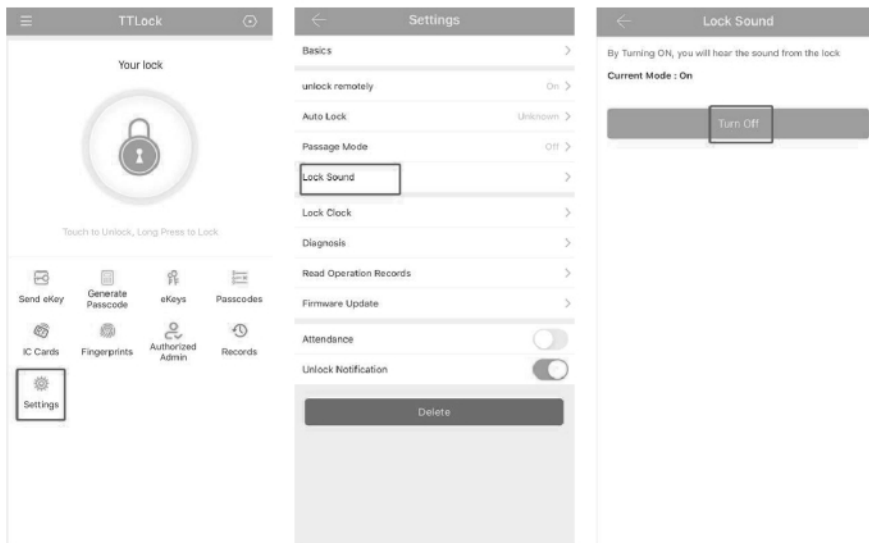

Click 'Settings'

Click 'Lock Sound'

Click 'Turn Off'

**Remark:** Please stay your phone close to your lock during setting process.

## Operation by keypad

### Part 1 Generate Passcode

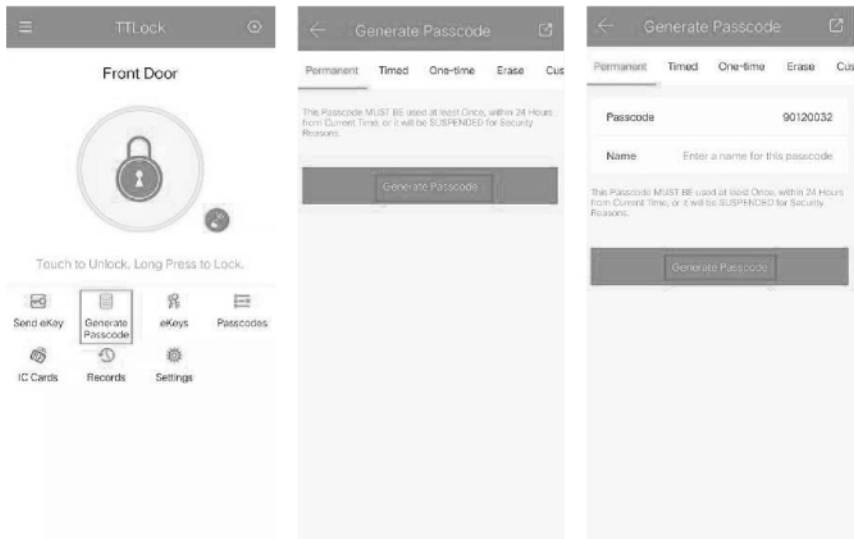

Click 'Generate Passcode' on APP

Select Passcode type

Passcode generated

18

### Part 2 unlock/lock by keypad

©Unlock by inputting Passcode, then press unlock button

©Lock Only by long-pressing lock button

**Remark:** For security, this smart lock supports Virtual Passcode(Add any digit in front of or back of Passcode. e.g. Your Passcode is 12345678, you can unlock by 5612345678 or 1234567802).

### Part 3 Manage Passcode

Admin account can manage all Passcodes by clicking 'Passcodes' on APP.

## Operation by IC cards

There are two IC cards included in the package, if you want more, please contact our service. IC Card can be used to unlock your door, but can not be used to lock your door.

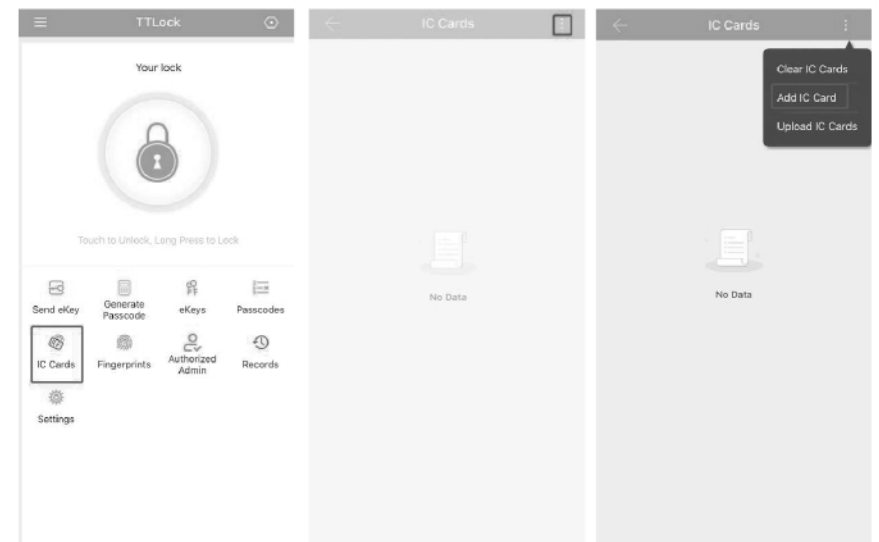

Click 'IC Cards' on APP

Click '+' upper right corner

Click 'Add IC Card'

19

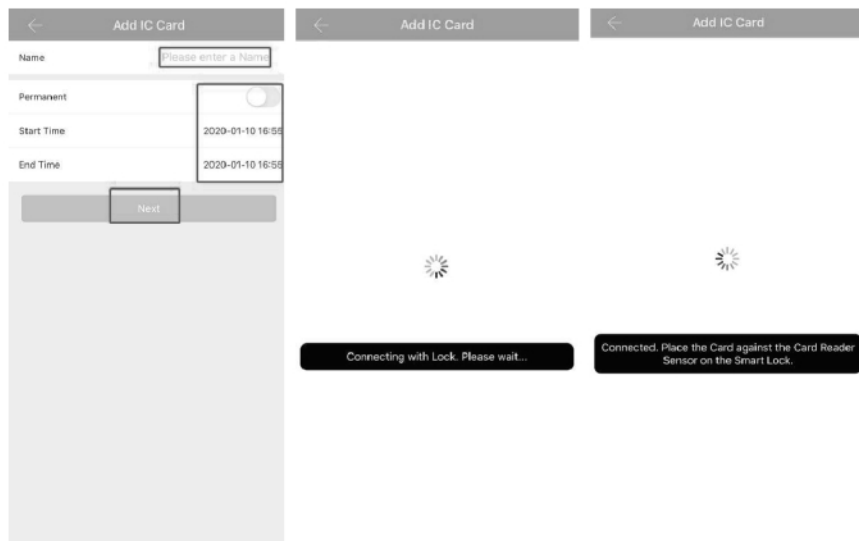

Name it and select time period

Waiting for connection

Connected



Place IC Card on the keypad , add completed

**Remark:** Please stay your phone close to your lock during setting process.

## Operation by Fingerprint

Please make sure if your lock has fingerprint function before operation.

Fingerprint can be used to unlock your door, but can not be used to lock your door.

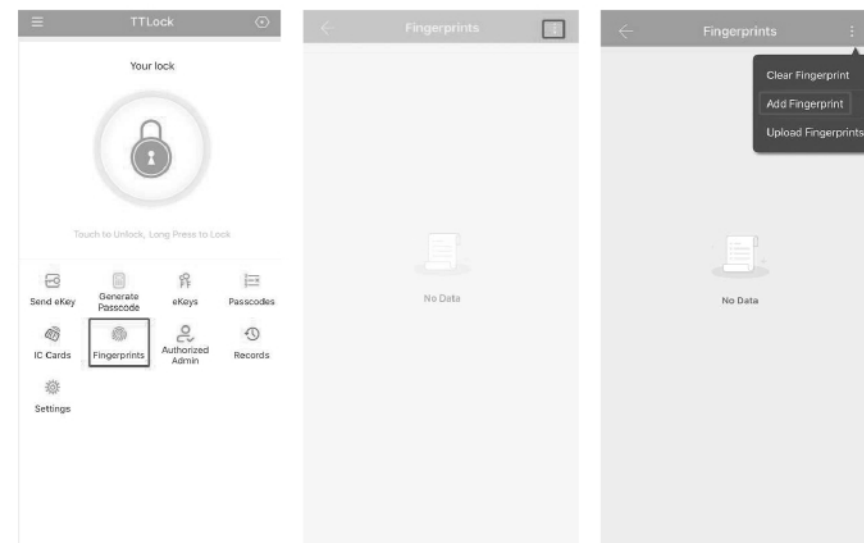

Click 'Fingerprint' on APP

Click '?' upper right corner

Click 'Add Fingerprint'



Name it and select time period



Click 'Start'



Place Finger 3 times

Fingerprint Recorded Successfully.

(3/3)



Follow the prompts... You will be required to Place and Remove your Finger from the Sensor 3 Times - Please be Patient.

Add completed

**Remark:** Please stay your phone close to your lock during setting process.

## Operation by mechanical keys

There are two compatible mechanical keys included in the package, Please keep it easily for backup.

◎ Press the keys cover, and turn it out

◎ Insert the keys to unlock your door

Press the bottom side of the cover anti-clockwise rotate 120 degree

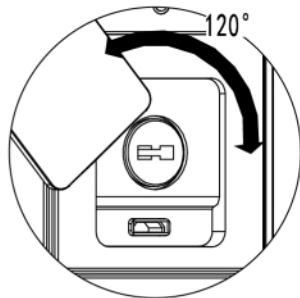
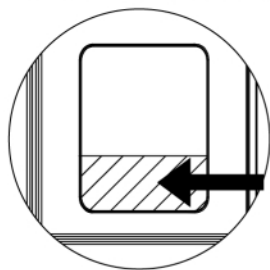

## Operation by APP via wifi remotely

We provide Bluetooth wifi gateway(Sold separately) for this smart lock to reach for remote control via internet, you can search for Oasbike smart wifi gateway to find it on [www.amazon.com](http://www.amazon.com)

**Remark:** About operation for wifi gateway, please refer to separate instructions of wifi gateway. But we have warm notice for you about unlock/lock remotely:

◎ Unlock by touching the little button

◎ Lock by long-pressing the same lock button

with Bluetooth local control



## More function

### Part 1 Alarm

**Anti-theft Alarm:** Once this smart lock get four times wrong Passcodes, it will be locked for 5 minutes, nobody can get in even if you have correct Passcodes.

**Low Voltage Alarm:** Once the batteries close to be dead, this smart lock will sound a beep alarm, and if you forget to replace the batteries before to be dead, you can use Type-C backup power to power for it(Under the keys cover).

## Part 2    Passage Mode

During the preset time period, this smart lock will remain unlocked until it is manually locked once Passage Mode activated

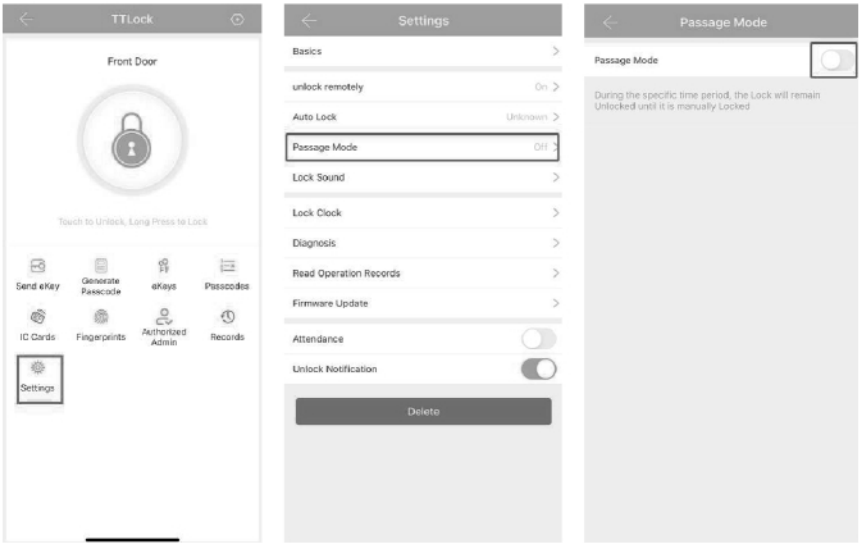

Click 'Settings'

Click 'Passage Mode'

Activate Passage Mode

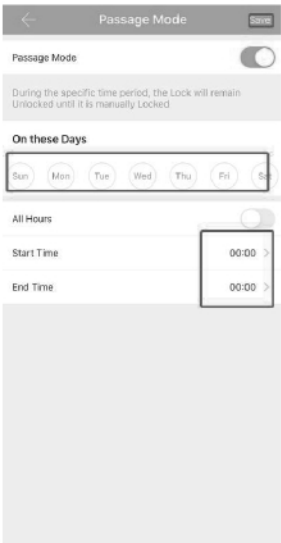

Select period and click 'Save'

This device complies with part 15 of the FCC Rules. Operation is subject to the following two conditions: (1) This device may not cause harmful interference, and (2) this device must accept any interference received, including interference that may cause undesired operation.

Any Changes or modifications not expressly approved by the party responsible for compliance could void the user's authority to operate the equipment.

**Note:** This equipment has been tested and found to comply with the limits for a Class B digital device, pursuant to part 15 of the FCC Rules. These limits are designed to provide reasonable protection against harmful interference in a residential installation. This equipment generates uses and can radiate radio frequency energy and, if not installed and used in accordance with the instructions, may cause harmful interference to radio communications. However, there is no guarantee that interference will not occur in a particular installation. If this equipment does cause harmful interference to radio or television reception, which can be determined by turning the equipment off and on, the user is encouraged to try to correct the interference by one or more of the following measures:

- Reorient or relocate the receiving antenna.
- Increase the separation between the equipment and receiver.
- Connect the equipment into an outlet on a circuit different from that to which the receiver is connected.
- Consult the dealer or an experienced radio/TV technician for help.