

DC307/DC313 Emitter Specification

Version:02A/00

T Type specification



DC313J

T Technical support

| Technical specification | Function instruction |
|--|---|
| <ul style="list-style-type: none"> Input voltage : 3V(G2430) Transmitting frequency : 433.92MHz Transmitting power : 10 milliwatt Operating temperature : -10°C—50°C Transmission distance : 200 meters open office, 35 meters on two walls | <p>DC313J is a channel emitter of DC313J. When channel emitter each channel had been installed with DC313J, One of LED indicator light will be on. Press "channel choose" button P1- (in number, descending) or P1+ (in number, ascending) to move to settable channel that you set, effective channel. If LED indicator light is on, that means the group control status. Under the status of group control, the channel will be available. Pressing "w" buttons will start the group control function of 5 ways, by way of all the channels will be available.</p> <p>CAUTION REPLACEMENT OF BATTERY IS REPLACED BY USER. PLEASE REFER TO THE INSTRUCTIONS TO THE INSTRUCTIONS. When you set transmitter, it is not of emission of radio wave for the FCC. Please change another same transmitter if there are any damage for receiving.</p> |

Caution:

- This device complies with Part 15 of the FCC. Operation is subject to the following two conditions:
- (1) This device may not cause harmful interference.
 - (2) This device must accept any interference received, including interference that may cause undesired operation.
- Any changes or modifications not expressly approved by the party responsible for compliance could void the user's authority to operate the equipment.

This equipment has been tested and found to comply with the limits for a Class B digital device, pursuant to part 15 of the FCC Rules. These limits are designed to provide reasonable protection against harmful interference in a residential installation. This equipment generates and uses and can radiate radio frequency energy and, if not installed and used in accordance with the instructions, may cause harmful interference to radio communications. However, there is no guarantee that interference can be avoided by the user. To correct the interference by one or more of the following measures:

- Reorient or relocate the receiving antenna
- Increase the separation between the equipment and receiver
- Connect the equipment into an outlet on a circuit different from that to which the receiver is connected
- Consult the dealer or an experienced radio/TV technician for help.

A Additional function

Matchable DT82TN Curtain Motor setting up

The motor which hasn't been matched the code; If press emitters open button, and the curtain close,pls do the operation to change direction;

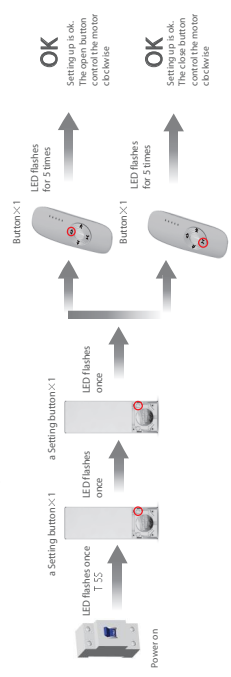

A DT82TN Curtain Motor add emitter

Additional function

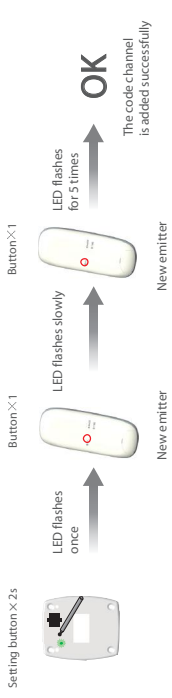

A Additional function

DC313J valid channels selection

In the setting state press the up or down button you can quit quickly, if you want to change the valid channels, reset it.

