

Thank you for choosing UNIWA V909T 4G flip phone, it is a feature phone, not smartphone, so cant install apps. It supports single Nano SIM (not included) and it is unlocked (SIM free). If any question during use, please email us and we will try our best to help you.

Our after-sales email:
2850699288@qq.com

① Safety instructions

- This phone is not water-resistant, keep it dry.
- To prevent possible hearing damage, do not listen at high volume levels for long time. Exercise caution when holding your device near your ear while the loudspeaker is in use.

Table of Contents

- ▶ External features 01
- ▶ Install SIM card / memory card 02
- ▶ Install the battery 02
- ▶ Turn on / off the phone 03
- ▶ Charging 03
- ▶ Save contact 04
- ▶ Make call 04
- ▶ Answer call / hang up 05
- ▶ Send and receive SMS 05
- ▶ Multimedia Settings 06
- ▶ FM radio 07
- ▶ Settings 07
- ▶ Tools 10
- ▶ SOS Settings 11
- ▶ Speed Dial 11
- ▶ Calendar 12
- ▶ Product specifications 13

▶ External features



▶ Install SIM card / memory card

Open back cover from the bottom left corner of the back and insert your SIM card (see figures below).

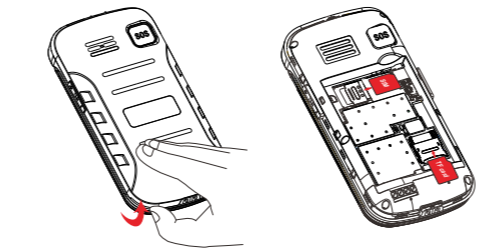

▶ Install the battery

Before power on the phone, please tear off the insulating paper on the battery contact, then install battery and cover the back cover, see the figures below:

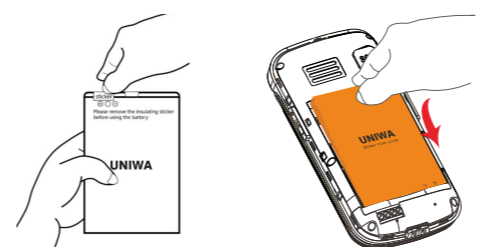

▶ Turn on / off the phone

Long press for 5 seconds, then phone will turn on. Long press for 3 seconds, the phone will turn off.

▶ Charging

When the battery is low, please charge the phone in time. There are 2 ways for charging:

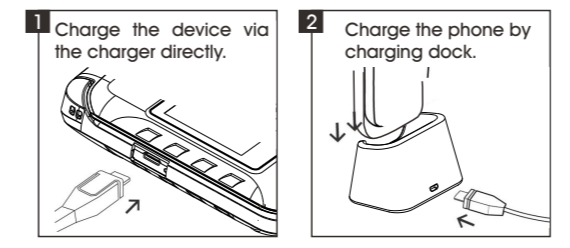

When charging, the indicator on the dock will get red. When fully charged, it will turn green.

If the phone is not placed properly with the dock, the indicator will display green, please reposition the phone until it is well placed.

▶ Save contact

For frequent contacts, you can save their phone numbers in contact list by step:

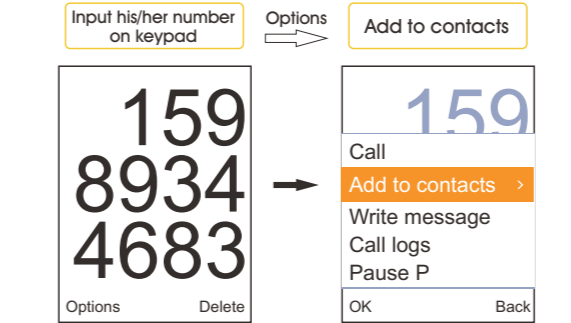

▶ Make call

Enter the phone number on keypad, and then press to dial.

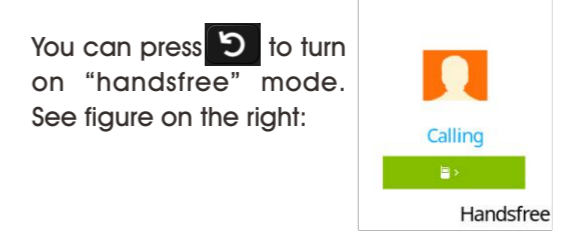

▶ Answer call / hang up

When coming call, open the flip to answer or close the flip to hang up.

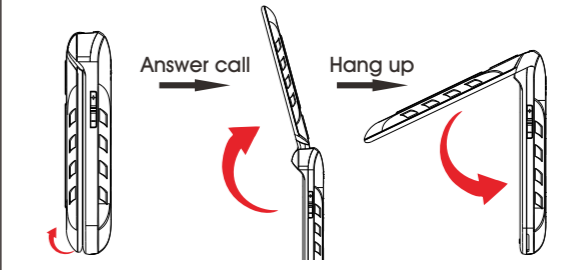

▶ Send and receive SMS

You can press key to reach "Message" menu, then press key to write message, and you can view received SMS in the "Inbox". see figures below:

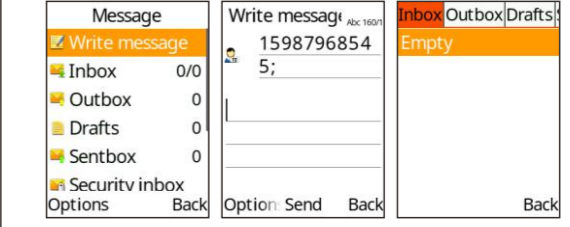

Under the information menu, you can set "Broadcast message" and "Voice mail server". See figures below:

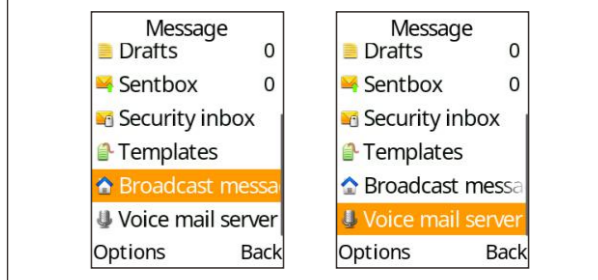

▶ Multimedia Settings

In "Multimedia" menu, you can press key to see submenu "camera, audio, video, image, recorder, my files", see figures below:

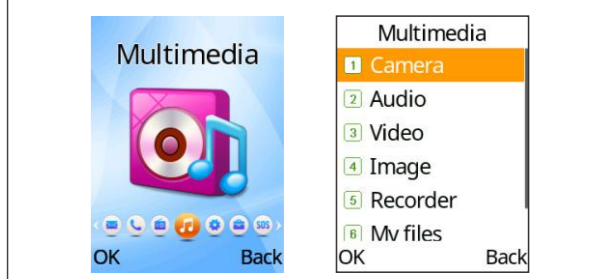

You can use to move the cursor and press key to enter "camera" mode. And then press key to take photo. Using the similar steps, you can use "audio, video, image, recorder, my files" functions.

▶ FM radio

When you enter "FM radio" menu, press key, then press "Options" to do "auto search and save" nearby radio channels. The volume of FM radio is large, you can press the side volume +/- key to adjust it. See figures below:

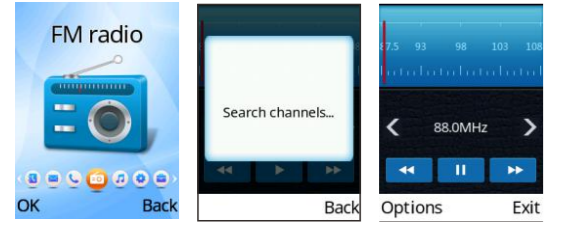

▶ Settings

In "Settings" menu, you can see submenu "Phone settings, Display, Security, Connections, Keypad voice setting, Profiles"

▶ Phone settings
Time& date, language settings, shortcut settings, auto power on/off, power management, restore factory settings". See figure on the right:



In "Phone settings" menu, you can restore the phone to factory settings. Please backup your data before restore factory setting. The default restore factory password is 1234

▶ Display

Wallpaper settings, Contrast, Backlight, Keypad backlight time, Sublcd setting. See figure on the right:

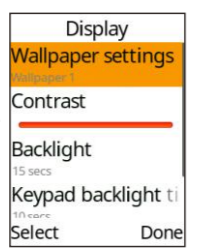

▶ Security

PIN, Modify PIN2, Phone locked, Modify the cellphone passwords, Privacy, Fixed Dialing number, blacklist.

In order to avoid forgetting the password and lock the phone, we do not recommend user to set passwords. Be careful to set and remember passwords for the phone.

▶ Connections

Network account, Data service, Data Roaming, Network selection, Network type, VoLTE.

▶ Keypad voice setting

You can activate keys reading out function by steps shown in figures below:

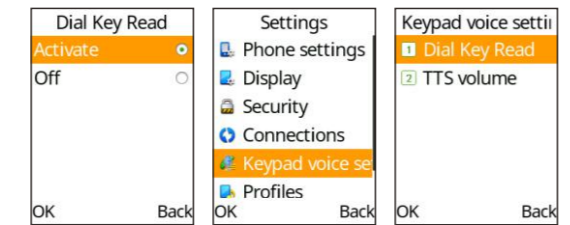

▶ Profiles

Normal, Silent, Meeting, Indoor, Outdoor. If you want to change "Profiles" setting, press key to enter "Options" menu, and then press key to make change.

You will see "Rename, Ring settings, Adjust volume, Ring type, Other alert rings" setting options. See figures below:

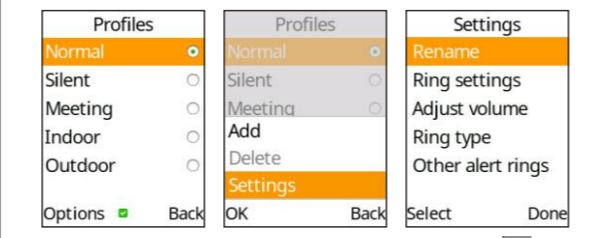

You can also press the volume +/- keys on the right side of the phone to adjust volume.

▶ Tools

you can see "Bluetooth, Calculator, Alarm, Internet, Torch". Regards "Bluetooth" function, you can use press key to activate it and then select "Paired device" to search nearby Bluetooth devices. See figures below:

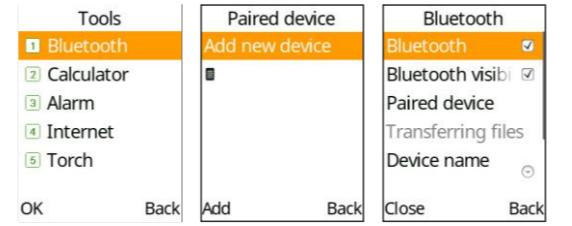

▶ SOS settings

When user is in an emergency, he/she can press button for 5 seconds on the back of the phone to call and send SMS to the pre-set emergency contacts. You can pre-set 5 contacts and one SOS message in the menu. See figures below:

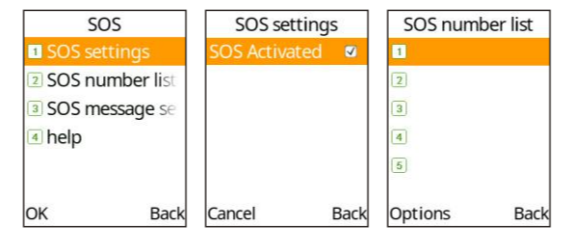

▶ Speed Dial

For frequent contacts, "Speed dial" can dial them quickly. Key 2-9 can be set as speed dial keys. See figure below:

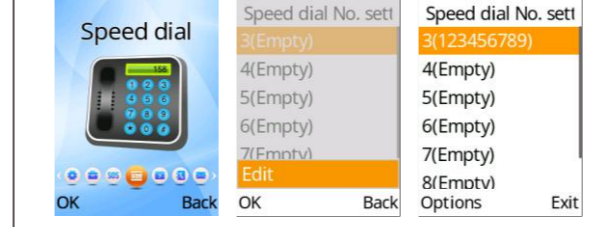

After frequent contacts are set, long press corresponding key for 3 seconds, the phone will call the corresponding person automatically.

▶ Calendar

In "Calendar" menu, you can add schedules and set reminders, see figures below:

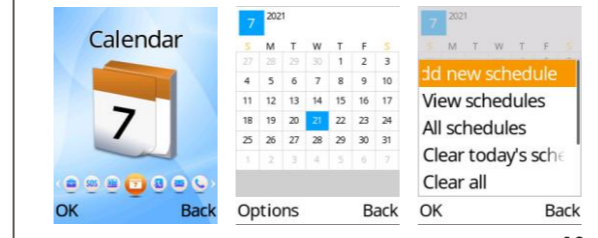

▶ Product specifications

Model No.	UNIWA V909T
Dimensions	110*56*22.4mm
Weight	135g (include battery)
Material	Plastic
Style	Flip style
Service	Unlocked
Band	2G: GSM 850/1900MHz
	3G: WCDMA 850/1700/1900MHz
	4G: FDD-LTE B2/B4/B5/B7/B12 /B17/B66; TDD-LTE B41
SIM	Single Nano SIM single standby
ROM	Support TF card extension up to 32GB maximally
Phonebook Number	2000

Message	SMS
Earphone	Micro USB
Speaker	2030 BOX loudspeaker
Screen	Double screen 2.8 inch QVGA inner display screen 1.77 inch QQVGA outer hard screen
Camera	0.3MP rear camera
Radio	Wireless FM radio
Multimedia	MP3/MP4 etc.
BT Version	V2.1
SOS Function	Can preset 5 SOS numbers and 1 emergency SMS
HAC	Support
Other features	Alarm, calendar, calculator, VoLTE, E-book, speed dial, torch etc.
Battery	Removable 2250mAh li-ion polymer battery

Languages	English, Arabic, French, Indian, Indonesian, Malayu, Portuguese, Russian, Spanish, Thai
	Vietnamese, Italian, Turkish, Deutsch, Greek, Hebrew, Cestina, Nederlands, Polish, Svenska
Color	Ukrainian
	Grey , red
Accessories	1* Battery
	1* Charger
	1* Charging cradle
	1* User manual



FCC Caution:

Any Changes or modifications not expressly approved by the party responsible for compliance could void the user's authority to operate the equipment.

This device complies with part 15 of the FCC Rules. Operation is subject to the following two conditions: (1) This device may not cause harmful interference, and (2) this device must accept any interference received, including interference that may cause undesired operation.

Note: This equipment has been tested and found to comply with the limits for a Class B digital device, pursuant to part 15 of the FCC Rules. These limits are designed to provide reasonable protection against harmful interference in a residential installation. This equipment generates, uses and can radiate radio frequency energy and, if not installed and used in accordance with the instructions, may cause harmful interference to radio communications. However, there is no guarantee that interference will not occur in a particular installation. If this equipment does cause harmful interference to radio or television reception, which can be determined by turning the equipment off and on, the user is encouraged to try to correct the interference by one or more of the following measures:

- Reorient or relocate the receiving antenna.
- Increase the separation between the equipment and receiver.
- Connect the equipment into an outlet on a circuit different from that to which the receiver is connected.
- Consult the dealer or an experienced radio/TV technician for help.

Specific Absorption Rate (SAR) information

SAR tests are conducted using standard operating positions accepted by the FCC with the phone transmitting at its highest certified power level in all tested frequency bands, although the SAR is determined at the highest certified power level, the actual SAR level of the phone while operating can be well below the maximum value. Before a new model phone is available for sale to the public, it must be tested and certified to the FCC that it does not exceed the exposure limit established by the FCC, tests for each phone are performed in positions and locations as required by the FCC.

For body worn operation, this model phone has been tested and meets the FCC RF exposure guidelines when used with an accessory designated for this product or when used with an accessory that contains no metal and that positions the handset a minimum of 5mm from the body. Non-compliance with the above restrictions may result in violation of RF exposure guidelines.