

7*24H After-sale Service Team

- Customer Service Team: support@jesled.com
- EU Customer Service Team: support-eu@jesled.com
- JP Customer Service Team: support-jp@jesled.com
- Facebook: @JESLED Lighting
- Whatsapp: +86 185 7558 8152



Sea&Mew Consulting
97 Avenue d'Alfortville, 94600 Choisy-le-Roi

Siyu Gao
Info@seamew.de



Sea&Mew Accounting Ltd
Electric Avenue Vision 25, London, Enfield EN3 7GD
Billy Han
info@seamew.net

CE UK CA FC RoHS
Manufacturer: Dong Guan City Shengwei Lighting Co., Ltd
MADE IN CHINA

(4) Switch to the music rhythm interface:



(5) Switch to the mode interface:

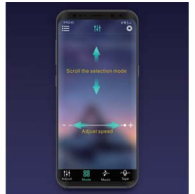

(6) Switch to the microphone rhythm interface:

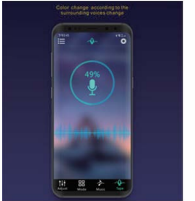

3.3 App Connect to LED Strip

(1) APP main interface, click the [list] button in the upper left corner, pop-up device management interface:



(2) Click [nearby equipment]:

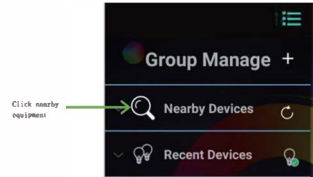

(3) List the light control equipment nearby:

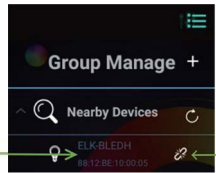

(4) Click on the right side of the [Connect] button icon, connect the device:

(5) Automatic connection after first connection

In some cases, the system will be connected automatically. The case1 is that when the LED light strip is reinserted, the phone APP will automatically sense the powered-on device and connect it back. The case2 is that when the phone or the APP is restarted, the device will be connected automatically. The third is that when carrying the phone away from the device, once again return to the vicinity of LED lights with the device, it will automatically connect back.

APP Program Usage



Notes:
Detailed operating instructions, enter the menu "Guide":



FCC Statement

Changes of modifications not expressly approved by the party responsible for compliance could void the user's authority to operate the equipment. This equipment has been tested and found to comply with the limits for a Class B digital device, pursuant to Part 15 of the FCC Rules. These limits are designed to provide reasonable protection against harmful interference in a residential installation. This equipment generates uses and can radiate radio frequency energy and, if not installed and used in accordance with the instructions, may cause harmful interference to radio communications. However, there is no guarantee that interference will not occur in a particular installation. If this equipment does cause harmful interference to radio or television reception, which can be determined by turning the equipment off and on, the user is encouraged to try to correct the interference by one or more of the following measures:

- Reorient or relocate the receiving antenna.
 - Increase the separation between the equipment and receiver.
 - Connect the equipment into an outlet on a circuit different from that to which the receiver is connected.
 - Consult the dealer or an experienced radio/TV technician for help.
- This device complies with part 15 of the FCC rules. Operation is subject to the following two conditions
1. this device may not cause harmful interference, and
 2. this device must accept any interference received, including interference that may cause undesired operation.

*RF warning for Mobile device:
This equipment complies with FCC radiation exposure limits set forth for an uncontrolled environment. This equipment should be installed and operated with minimum distance 20cm between the radiator & your body.

LED mobile phone Bluetooth controller

Product Features

- LED Bluetooth controller is directly via mobile phone control remote distance can reach 20m without the need to set up, easy to connect
- open the software within 5 seconds you can automatically connect the controller
- Flow the rhythm of the music changes
- Group control
- Brightness, speed addition and subtraction
- Maximum can be 10 meters RGB(W) strip
- The software shows that the text is based on the language of the mobile phone set up automatic translation of Chinese and English

Animation Effect:

- Colorful gradient
- All kinds of monochrome, double color gradient
- All kinds of monochrome, double color, colorfull flashing
- Colorful jump

- Follow the rhythm of the music changes

Product Paramters:

- Bluetooth: BT 5.0
- Input Voltage: 4.5~26V
- Working Temp: -25~75℃
- Size: 43*22*11mm
- Weight: 30g
- Max Power: 30W (5v)

Installation instructions for led Strip light

