

*alpha*

**X3**

# Kids' Smart Sonic Electric Toothbrush Instructions



alpha.com

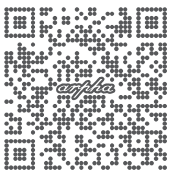

SCAN HERE

# CONTENTS

EN	Kids' Smart Sonic Electric Toothbrush X3	02
----	--	----

Thank you for purchasing X3 electric toothbrush.  
Before starting to use this product, please read this instruction  
carefully and keep it for future reference.

※This product is suitable for children age 8-month and above.  
※

## Characteristics

- Convenient to mark brushing record by lighting function.
- The toothbrush handle is anti-photoallergic, by stably being irradiated under yellow light, baby's sensitive gums can be improved and oral immune capability enhanced, in the mean time, prevent tooth decay.
- Certified by FDA and with medical nano anti-bacteria agent added, the brushing head is capably anti-bacteria and anti-fungal.3
- With 360 degree turning function, it's able to do deeper clean, even the blind spot.
- Produced with the US brand "Dupont" bristle, highly rubbed to make every bristle tail round and shiny, so that it's able to protect baby's oral environment.
- Made by the German brand "Pedex" spiral filament, the cleaning effect is not harmful for baby oral.
- Designed with slight vibration motor, baby's dental health is carefully nursed.
- Made by platinum food grade silicone (baby teethers), this material is more resistant in high temperature, ripping, bite and suck.

## Product Content

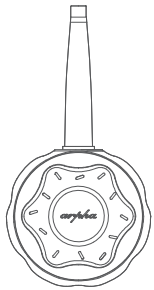

Children Intelligent  
Electric Toothbrush Handle



360 Degree  
Round Brush Head



Food Grade Silicone  
Brush Head



General Brush Head

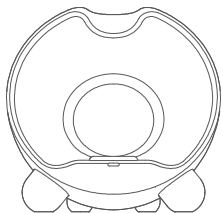

Wireless Charger Base



USB TYPE-C Charger

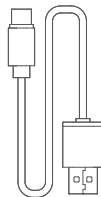

Platinum Silicone Sheet / Baby Teethers

## Cautions

### ⚠ Warning

- This product is not suitable for children under 8 months. Keep away from babies.
- Guardians are strongly advised to assist when in use.
- Use this product under doctor's instructions and advice after having oral surgery.
- Those who are or used to be equipped with heart rate regulator or any other similar devices, seek for doctor's or supplier's advice before use.
- This product is for oral clean purpose only.
- This Product must not be seen as toys.
- Stop using this product and seek for doctors if not feeling well after use.
- This product cannot be washed or polished by strong acid or alkali detergents or sanitized by disinfectant.

### ⊘ Don'ts

- Do not use brush heads that is not produced by the original manufacturer.
- Do not leave this product close to heat.
- Do not violently drop or collide this product.
- Do not wash brush head with water over 60°C.
- Do not wash brush head and the main engine using dish washer or any other similar devices.
- Do not soak this product for long time.
- Do not use this product while running or walking.

### 📝 Reminder

- Before use, please check thoroughly to see if there's any obvious damage on the toothbrush handle or wireless charger. If the above mentioned occurs, cease usage.
- In case of harming the gum, during brushing process, it is suggested not to over pressure the teeth.
- In case of damaging the gum resulted from over-used brush head, it is suggested to replace brush heads every 3 months.
- For the purpose of baby health and hygiene, please do not share the same brush heads.
- Before plugging, please check whether the voltage number conform to the number marked on the product.
- Unplug the wireless charger and thoroughly clean the brush heads and handle if this product is not in frequent use. Make sure the charger is not connected to electronic power supply in case of fire or other danger.

## Product Components

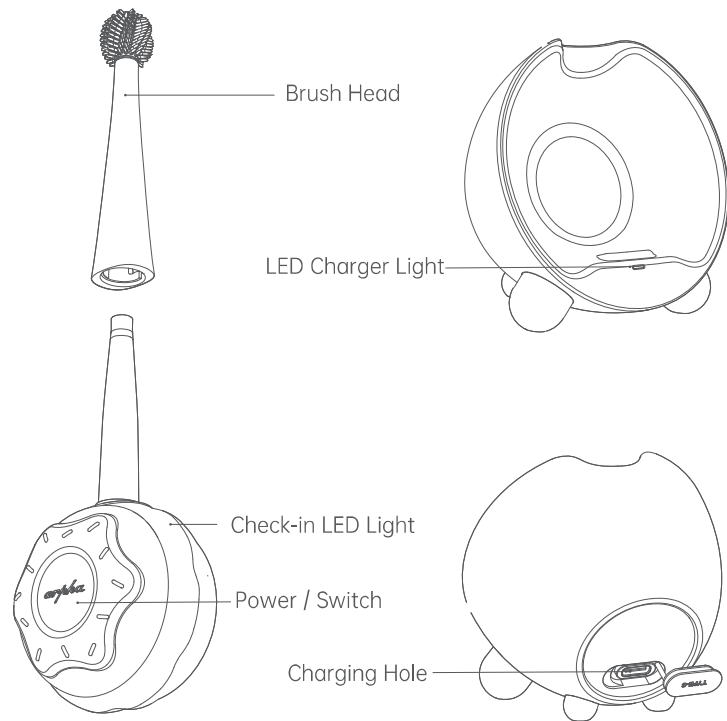

Children Intelligent  
Electric Toothbrush Handle

Wireless Charger Stand  
Main Part

## Product Content

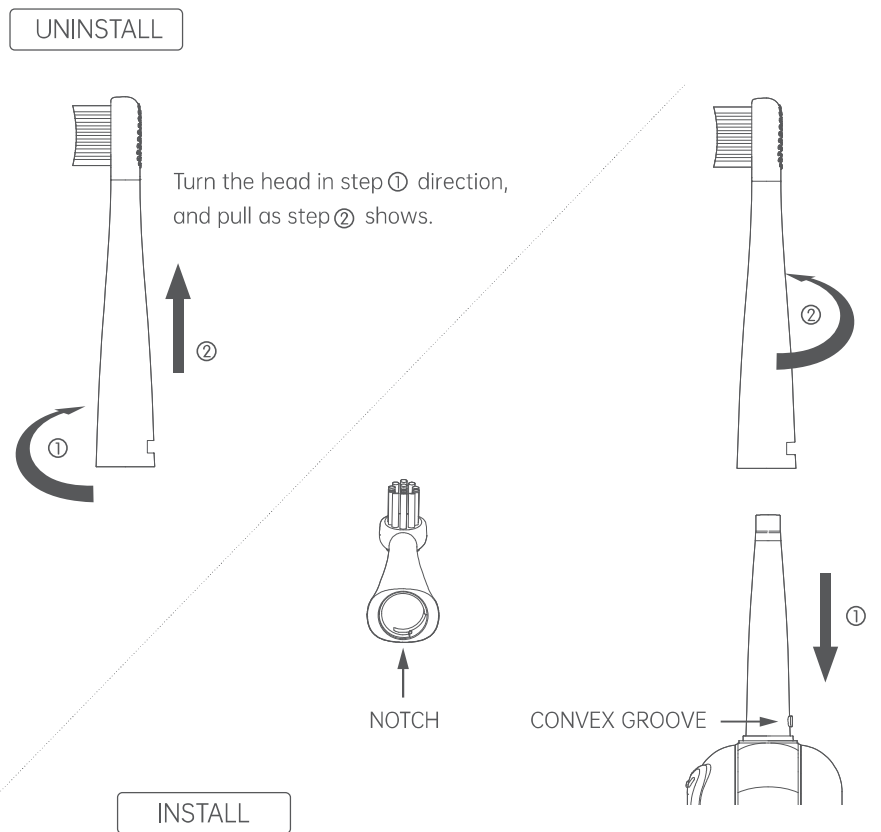

## Cautions

1. Moisten the brush, apply suitable volume of toothpaste onto the brush.
2. Press switch, the check-in LED light will flash in clockwise direction, after brushing is over, it goes light on according to the collected information, and the yellow light on the brush head goes light on along, this will take this product to "standby mode."
3. Gently put the toothbrush on the teeth, press switch again under standby mode, the product will start clean process, in the mean time, the check-in LED light will start flashing from where it was positioned.
4. The default mode is set to be gentle mode, press switch when in use, this product will be switched to clean mode, and whitening mode (suitable for age 6 and above). When this product is working under faster speed mode, the check-in LED light will flash faster as well, it is no problem to switch modes according to the suggested age or personal demand; press switch for 1 second to stop when brushing process is over.
5. According to "Bass Method," human oral is divided into 4 sections (refer to the picture below), during brushing, it is advised to move from outside to inside with gentle "up and down" brushing direction, and make a 0.5 second stop every 30 seconds to record that a section is completed. After all 4 sections are completed, this product will automatically stop working, and switch off after 30 seconds of continuous lighting.

## How to use silicone sheet

The silicone sheet serves as cover on the toothbrush for learner

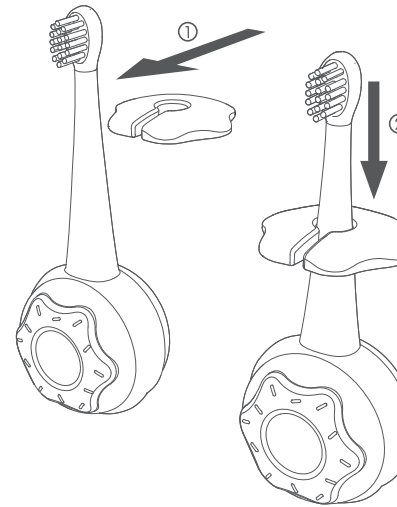

Push in the silicone sheet as step ① shows, and fix it down as step ② shows.



Serves as baby teethers for age between 8-month and 2 years

## How to use

1. Moisten the brush, apply suitable volume of toothpaste onto the brush.
2. Press switch, the check-in LED light will flash in clockwise direction, after brushing is over, it goes light on according to the collected information, and the yellow light on the brush head goes light on along, this will take this product to "standby mode."
3. Gently put the toothbrush on the teeth, press switch again under standby mode, the product will start clean process, in the mean time, the check-in LED light will start flashing from where it was positioned.
4. The default mode is set to be gentle mode, press switch when in use, this product will be switched to clean mode, and whitening mode (suitable for age 6 and above). When this product is working under faster speed mode, the check-in LED light will flash faster as well, it is no problem to switch modes according to the suggested age or personal demand; press switch for 1 second to stop when brushing process is over.
5. According to "Bass Method," human oral is divided into 4 sections (refer to the picture below), during brushing, it is advised to move from outside to inside with gentle "up and down" brushing direction, and make a 0.5 second stop every 30 seconds to record that a section is completed. After all 4 sections are completed, this product will automatically stop working, and switch off after 30 seconds of continuous lighting.

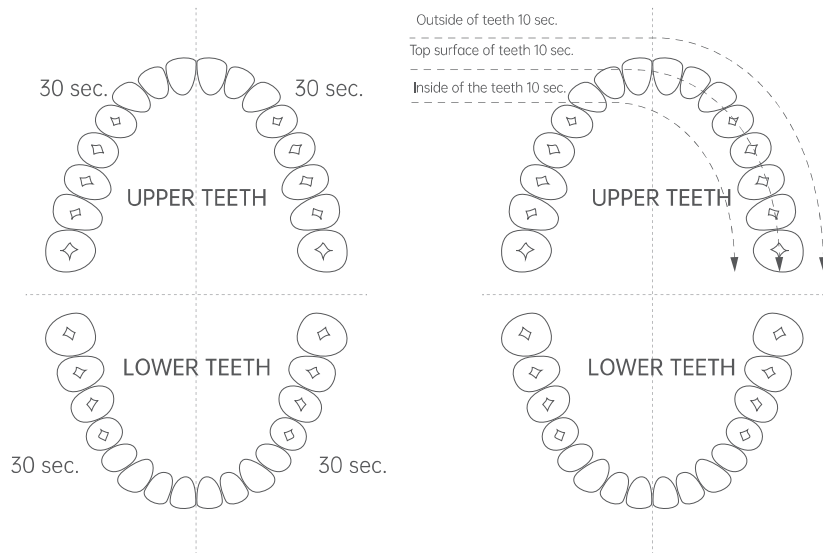

6. Rinse the brush head after use and keep it in dry space.

## Button operation

	Mode	State
Off state	OFF	N/A
1st short press	Standby mode	<ul style="list-style-type: none"> <li>◆ Check-in LED light and the head light are both on</li> <li>◆ Automatically switch off after 2 minutes if no any actions made.</li> </ul>
2nd short press	Gentle mode	
3rd short press	Clean mode	<ul style="list-style-type: none"> <li>◆ Brief stop for 0.5 seconds after continuous 30-second clean to remind user to move to the next oral section</li> <li>◆ Automatically switch off after 2 minutes if no any actions made.</li> </ul>
4th short press	Whitening mode (suitable for age 6 and above).	

Long press to force off under any modes.

※Short press is equal to 0.5 second; long press is equal to 1 second or more.

## Check-in Function

1. Check-in during brushing, the LED light will flash at the current position, as long as the clean process is completed, the light will turn continuous lighting from flashing, meaning successfully check-in.
2. Should an error occur during brushing, make a long press on switch for 1 second to force off, and this will result in check-in failure, the clean process will need to be activated again.

## Spectrum Introduction –Yellow Light

Being irradiated by light benefits human body; yellow light (wavelength: 585-595nm) is capable of directly triggering a series of biostimulation towards human body cell, thereby producing cell self-repairing effect, soothing sensitive inflammation and other ill reactions.

## Washing Suggestion

1. Put the brush head under the tap water, move back and forth to let the bristle be showered.
2. Rinse the toothbrush handle.
3. Slightly swing the brush head to dehydrate, and polish with dry fabric.

# Maintenance

- Always use clean and soft fabric to polish.
- 2. Do not polish with volatility related detergent or alcohol sanitation.
- 3. Keep this product away from sunlight-exposed space.
- 4. If not in frequent use, unplug from power supply, thoroughly clean the brush head and the main engine, and keep this product in dry, shade space.
- 5. It is suggested to replace brush heads every 3-months to maintain the best cleaning effect.

# Product Specification

Rated voltage: 3.7V

Rated power: 0.5W

Battery capacity: 350 mAh(\*)

Charging time: 4 Hours

Functioning length: Use 4 minutes a day for 30 days (\*\*)

\*There's ±50mAh tolerance scope in the capacity estimation.

\*\* all data is calculated based on functioning state of 2 min/time and 2 times/day.

# FAQ and Troubleshooting

- When battery is too low, the check-in LED light flashes for 5 seconds and automatically switch off.
- When toothbrush handle is on standby, it will automatically switch off if no any actions made for more than 2 minutes.
- Do not use when charging.

Scenario	Cause	Solution
Weak vibration	Toothbrush being put too strongly onto the teeth.	Slightly and gently let the toothbrush work on the teeth.
	Brush head is not installed properly.	re-install correctly
	Low battery	charge
Shorter period of time when functioning	Not charged enough or not properly connected to the charging stand.	Make sure the toothbrush handle is properly plugged into the charging hole and the charging light is on.
	Low battery	Charge
	Battery is out of service.	Contact supplier.
Toothbrush handle is malfunction	Not charged enough or not properly connected to the charging stand.	Make sure the toothbrush handle is properly plugged into the charging hole and the charging light is on.
	Battery is out of service.	Contact supplier.

## **FCC Statement**

This equipment has been tested and found to comply with the limits for a Class B digital device, pursuant to Part 15 of the FCC Rules. These limits are designed to provide reasonable protection against harmful interference in a residential installation. This equipment generates uses and can radiate radio frequency energy and, if not installed and used in accordance with the instructions, may cause harmful interference to radio communications. However, there is no guarantee that interference will not occur in a particular installation. If this equipment does cause harmful interference to radio or television reception, which can be determined by turning the equipment off and on, the user is encouraged to try to correct the interference by one or more of the following measures:

- Reorient or relocate the receiving antenna.
- Increase the separation between the equipment and receiver.
- Connect the equipment into an outlet on a circuit different from that to which the receiver is connected.
- Consult the dealer or an experienced radio/TV technician for help.

This device complies with FCC PART15 Rules. Operation is subject to the following two conditions:(1) This device may not cause harmful interference, and (2) this device must accept any interference received, including interference that may cause undesired operation.

Changes or modifications not expressly approved by the party responsible for compliance could void the user's authority to operate the equipment.

This equipment complies with FCC radiation exposure limits set forth for an uncontrolled environment.

This equipment should be installed and operated with minimum distance 20cm between the radiator & your body.