

What's in the Box:

Fig. 1

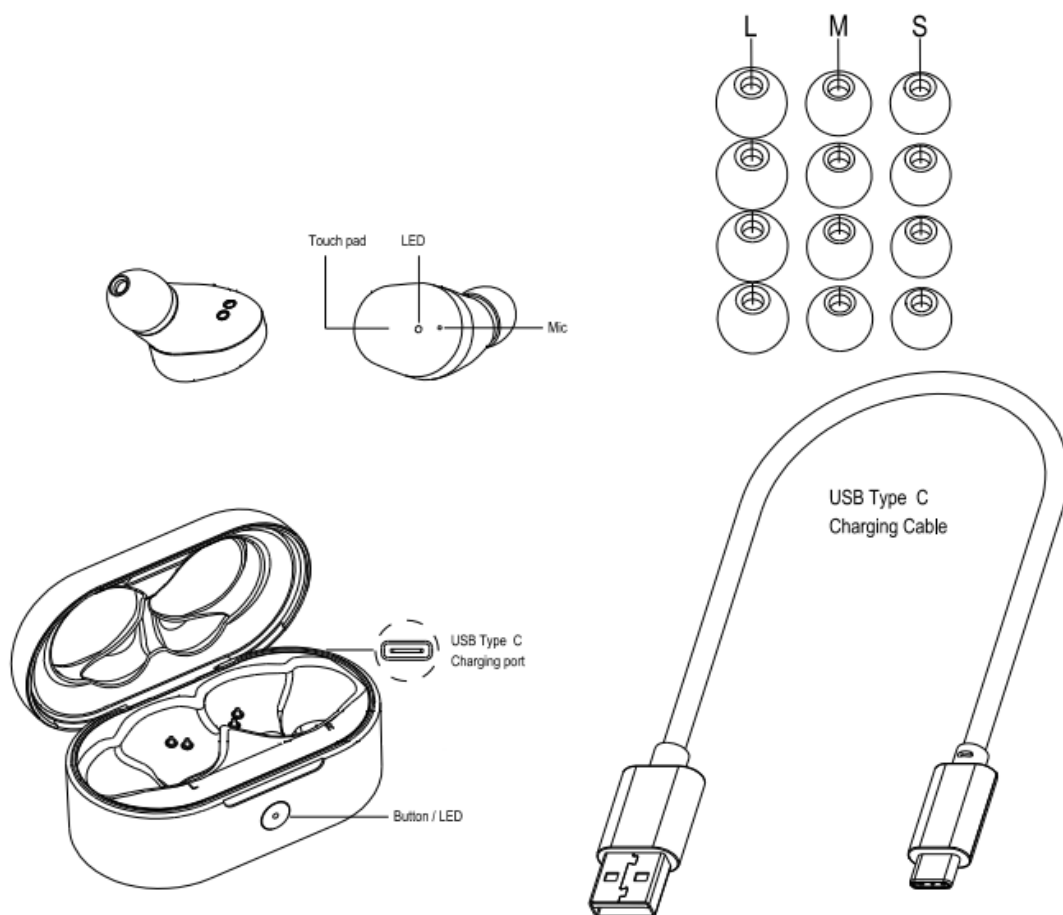

Overview of controls:

Desired Function	Current status	Operation/result	LED	Prompt
Power-on	Power-off	Touch and hold L and R for 1s.	Red LED will glow for 1s	Tone
	Charging	Remove L and R earbud from the case	Red LED will glow for 1s	Tone
Power-off	Power-on	Touch and hold L and R for 3s.	Red LED will glow for 1s	Tone
		Place L and R into case, Auto power-off, and charging.	Red LED will glow for 1s	/
Remove pairing record	Power-off	Touch and hold L and R for 10s.	White and Red LED will alternate 3 times in succession	/
Answer call/Hang up	Incoming call/in call	Tap L or R once.	/	Tone
Reject call	Incoming call	Touch and hold L or R for 1s.	/	Tone
Voice assistant	Standby mode	Touch and hold L or R for 1s, Activate voice control.	/	Tone
Mute on/off	Calling	Double tap L or R.	/	Tone
Music pause/play	Music playing	Tap L or R once	/	/
Next track/Previous track	Music playing	Double tap L, Previous track/ Double touch R, Next track.	/	/
Switch call to earbud	Talk on cellphone	Touch and hold L or R for 1s.	/	/
Switch call to cellphone	Talk on earbuds	Touch and hold L or R for 2s.	/	/

How to Use your NHT 0.2 Wireless Earbuds

Pairing for the first time:

1. Pick up earbuds from Charging Case.
2. The left and right earbuds will automatically enter pairing mode.
3. Search for "NHT 0.2 Wireless Earbuds" and pair with your device accordingly.

Switch Paired Device:

1. Turn off Device A's Bluetooth function; earbuds will automatically disconnect and enter pairing mode.
2. On Device B, Search for "NHT 0.2 Wireless Earbuds" and connect accordingly.

*A multi-point connection is not available for this model. Earbuds will attempt to connect to the last paired device by default.

Initialize:

(Try the following steps in the event of any connectivity issues)

1. Search for "NHT 0.2 Wireless Earbuds" on your device; tap and choose to ignore or cancel pairing.
2. While the earbuds are powered off, touch and hold the L and R earbuds for 10s until the LEDs alternate between red and white three (3) times to set the earbuds to factory default settings.
3. Please refer to "**Pairing for the first time**" to connect after initialization.

How to wear:

1. Before wearing the earbuds, please check etchings to ensure "L" goes in the left ear and "R" in the right ear.
2. Please adjust Mic towards your mouth for a better calling experience. (Fig. 2)

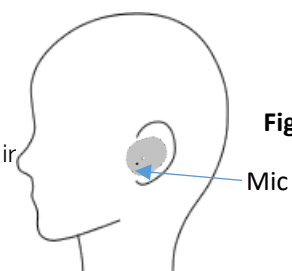

Three-way Calling and Switch:

Make sure the earbuds are already paired with your phone. Tap once to answer an incoming call. If another call is coming from a third party, double tap to put the first call on hold while activating the second call from the third phone.

Ignore another call in three-way calling:

Make sure the earbuds are already paired with your phone. Tap once to answer an incoming call. If another call is coming from a third party, touch and hold L or R for 4s to ignore the second call while retaining the first call.

Mono Mode:

1. With earbuds powered off, touch and hold on to either earbud for 1s to enter pairing mode. (LED blinks red and white)
2. On your device, search for "NHT 0.2 Wireless Earbuds" and tap to connect.

To charge Earbuds:

Place earbuds into Charging Case to charge. The earbuds will automatically turn off and start charging. LEDs will glow solid red during charging and turn off after fully charged.

To charge Charging Case:

Charge Charging Case via USB cable. LED will blink white while charging and turn solid white once fully charged.

Charging Case battery capacity display (under standby mode):

Press button; if battery capacity is less than 5%, red LED will blink for approx. 18s. If battery capacity is more than 5%, Red LED glows for approx. 18s.

Product Parameters:

Model name: NHT 0.2 Wireless Earbuds

Bluetooth version: V5.1	Battery type: li-ion	Headphone type: Closed, Dynamic
Connectivity range: 10m	Battery life: 4.5h, earbuds (+11.3h, charging case)	Driver unit: 6mm
Audio codec: SBC, AAC	Charging time: approx. 1.5hr (earbud/case)	Frequency range: 20Hz-20,000Hz
	Standby time: approx. 120h	Weight (Earbuds/ea): approx. 4.8g

After-sales service of the NHT 0.2 Wireless Earbuds:

Warranty Period: For a period of 3 months parts and labor from the date the product(s) is first purchased.

If the product(s) is discontinued, the warranty coverage period starts from the date of manufacture. To be eligible for warranty coverage, the product must have been purchased NHT directly (www.nhthifi.com) or an authorized NHT dealer in the USA or Canada. If (NHT) warrants that if the NHT branded product fails to function properly due to a manufacturing defect when it has been installed and operated according to instructions and used under normal conditions, it will be either replaced or repaired (both at NHT's option) with a unit of comparable value without charge to you.

Warning:

1. Never disassemble or modify this product for any reason to avoid potential damage and/or danger to yourself and/or others.
2. Do not expose the product to extreme temperatures < 0° C or > 45° C (< 32° F, > 113° F).
3. Do not charge the earbuds with anything other than the dedicated Charging Case.
4. Avoid using the earbuds when near high voltage appliances/environments due to increased risk of electric shock.
5. Do not use harsh chemicals, abrasives, or detergents on the product.
6. Keep the earbuds dry as best as you can.

Caution:

Please listen responsibly as hearing may be damaged through excessive use of earbuds and/or prolonged exposure to loud sounds.



FCC Warning

This device complies with part 15 of the FCC Rules. Operation is subject to the following two conditions:

(1) This device may not cause harmful interference, and (2) this device must accept any interference received, including interference that may cause undesired operation.

Any Changes or modifications not expressly approved by the party responsible for compliance could void the user's authority to operate the equipment.

Note: This equipment has been tested and found to comply with the limits for a Class B digital device, pursuant to part 15 of the FCC Rules. These limits are designed to provide reasonable protection against harmful interference in a residential installation. This equipment generates uses and can radiate radio frequency energy and, if not installed and used in accordance with the instructions, may cause harmful interference to radio communications. However, there is no guarantee that interference will not occur in a particular installation. If this equipment does cause harmful interference to radio or television reception, which can be determined by turning the equipment off and on, the user is encouraged to try to correct the interference by one or more of the following measures:

- ▶ -Reorient or relocate the receiving antenna.
- ▶ -Increase the separation between the equipment and receiver.
- ▶ -Connect the equipment into an outlet on a circuit different from that to which the receiver is connected.
- ▶ -Consult the dealer or an experienced radio/TV technician for help.

The device has been evaluated to meet general RF exposure requirement. The device can be used in portable exposure condition without restriction.