

ZEALOT-S31

快速入门指南
WIRELESS SPEAKER
QUICK START GUIDE

PACKING CONTENT

包装内容

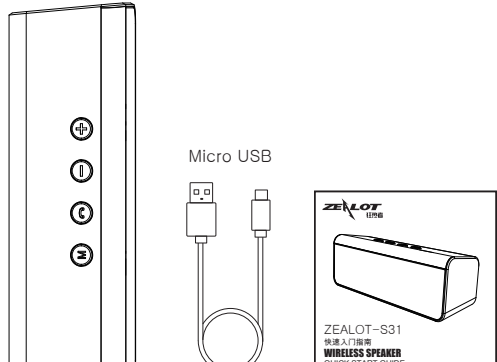

POWER ON

开关机

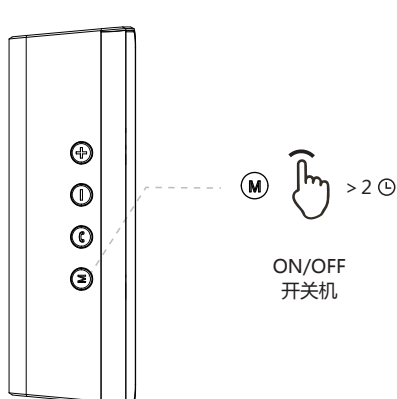

WIRELESS CONNECTION

无线连接

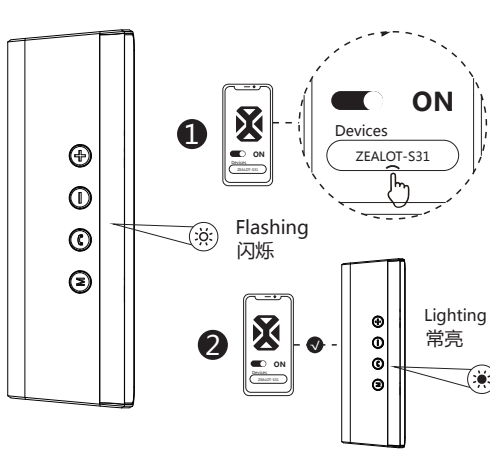

MODE SWITCH

模式转换

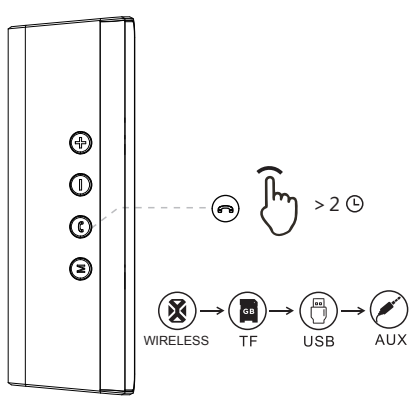

消费者若使用电源适配器充电，则应购买配套使用获得CCC认证并满足标准要求电源适配器。
If consumers use a power adapter to charge, they should purchase a matching set of CCC certification and meet the standards Required power adapter.



PLAY

播放控制

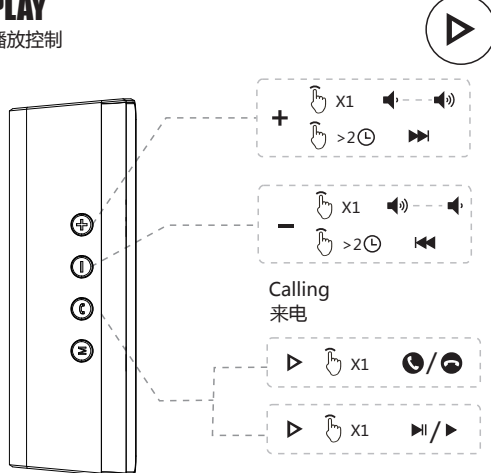

PARTYADD

派对对连

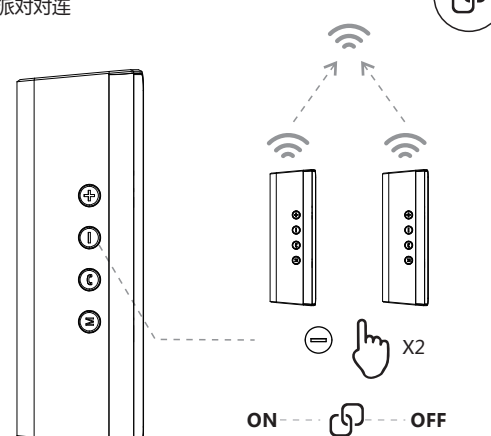

CHARGE

充电

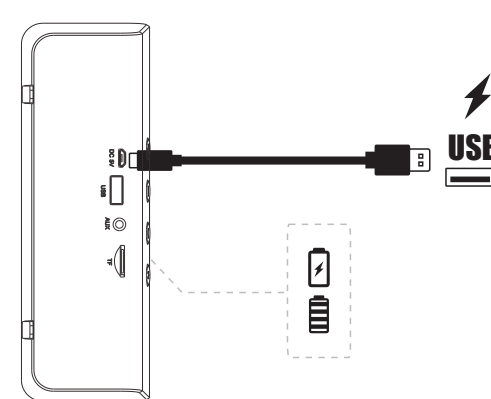

WARNING

EN

- To ensure correct use and trouble-free operation, please read this user manual carefully first.
- For the first use, it is recommended to fully charge it.
- Please use and store the product at room temperature.
- Do not expose the product to fire, high temperature, direct sunlight, etc.
- Please keep the speaker volume moderate to avoid temporary or permanent hearing impairment.
- Do not use organic solvents or other chemicals to clean the product.
- Do not let small particles enter the product.
- Do not disassemble the product or make any modifications to the product structure or any part thereof.
- If the battery is not replaced correctly, there will be an explosion accident, only the same battery type can be replaced.
- The battery (battery pack) must not be exposed to such sunlight, fire or similar overheating conditions.
- Do not throw and drop the product to avoid damage.

Technical Specification

技术规范

EN

Wireless version V5.2
 Charging voltage:DC 5V
 Working voltage:3.7V
 Transmission distance:10m
 Frequency range:100Hz-20KHz
 Speaker:4Ω*2
 SNR:≥85dB
 Distortion:1%
 Weight:330g
 Size:180*60*56mm

FCC WARNING

This device complies with part 15 of the FCC Rules. Operation is subject to the following two conditions: (1) This device may not cause harmful interference, and (2) this device must accept any interference received, including interference that may cause undesired operation.

Note: This equipment has been tested and found to comply with the limits for a Class B digital device, pursuant to part 15 of the FCC Rules. These limits are designed to provide reasonable protection against harmful interference in a residential installation. This equipment generates, uses and can radiate radio frequency energy and, if not installed and used in accordance with the instructions, may cause harmful interference to radio communications. However, there is no guarantee that interference will not occur in a particular installation. If this equipment does cause harmful interference to radio or television reception, which can be determined by turning the equipment off and on, the user is encouraged to try to correct the interference by one or more of the following measures:

- Reorient or relocate the receiving antenna.
- Increase the separation between the equipment and receiver.
- Connect the equipment into an outlet on a circuit different from that to which the receiver is connected.
- Consult the dealer or an experienced radio/TV technician for help.

Note: The Grantee is not responsible for any changes or modifications not expressly approved by the party responsible for compliance; such modifications could void the user's authority to operate the equipment.

The device has been evaluated to meet general RF exposure requirement. This equipment complies with FCC's RF radiation exposure limits set forth for an uncontrolled environment. This device and its antenna(s) must not be co-located or conjunction with any other antenna or transmitter.