

**⚠ WARNING:** May result in serious injury or death. Turn off power at circuit breaker before installing the unit.  
**Attention:** pour éviter un incendie, un choc électrique ou la mort. Coupez l'alimentation au disjoncteur ou au fusible et testez que l'alimentation est coupée avant le câblage

## FEATURES

1. Please call a licensed electrician for installation.
2. Drill 1/2" KO in the sheet metal for PPA104S installation, make sure the PPA104S well fixed in the luminaire.
3. Screw in the sensor into the receptacle and make sure the connection is tight. Ensure the rubber gasket touches the outside surface of the fixture.
5. Please refer below diagram for Wiring.
6. Return powerback to source.
7. Commissioned the sensor via Keilton App.

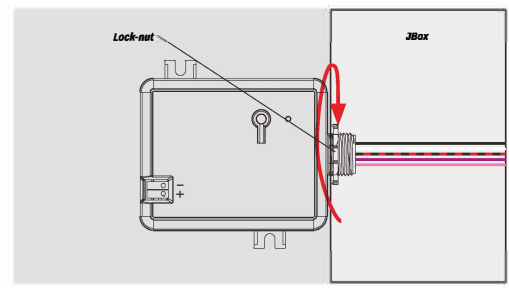

## WIRING

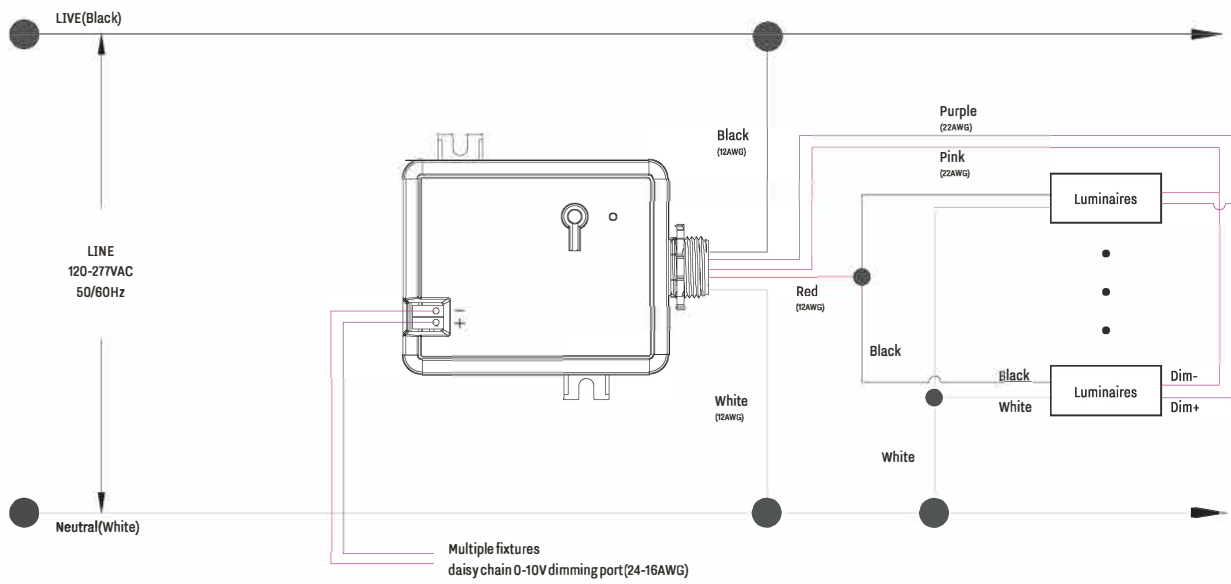

Note: PPA104S MAX Load 20A, Sink Current Max.48.5mA of the dimming port.  
 TIPS: This Bluetooth device is compatible with Keilton lighting control system only.

### How to Install Keilton APP?

Scan below QR code for downloading the APP.



### How to Control Lights with a Phone?

Scan to download Keilton APP instruction



## WARRANTY INFORMATION

Our company warranties this product to be free of defects in materials and workmanship for a period of five(5) years. There are no obligations or liabilities on the part of our company for consequential damages arising out of, or in connection with, the use or performance of this product or other indirect damages with respect to loss of property, revenue or profit, or cost of removal, installation or reinstallation.  
 Contact: sales@litetrace.com

**FCC Statement:**

This device complies with Part 15 of the FCC rules. Operation is subject to the following two conditions: 1) this device may not cause harmful interference, and 2) this device must accept any interference received, including interference that may cause undesired operation.

This equipment has been tested and found to comply with the limits for a Class B digital device, pursuant to Part 15 of the FCC rules. These limits are designed to provide reasonable protection against harmful interference in a residential installation. This equipment generates, uses and can radiate radio frequency energy and if not installed and used in accordance with the instructions, may cause harmful interference to radio communications. However, there is no guarantee that interference will not occur in a particular installation. If this equipment does cause harmful interference to radio or television reception, which can be determined by turning the equipment off and on, the user is encouraged to try correct the interference by one or more of the following measures:

- Reorient the receiving antenna.
- Increase the separation between the equipment and receiver.
- Connect the equipment into and outlet on a circuit different from that to which the receiver is connected.
- Consult the dealer or an experienced radio/TV technician for help.

Changes or modifications not expressly approved by the party responsible for compliance could void your authority to operate the equipment.

The distance between user and products should be no less than 20cm

The EUT is In door use only

