

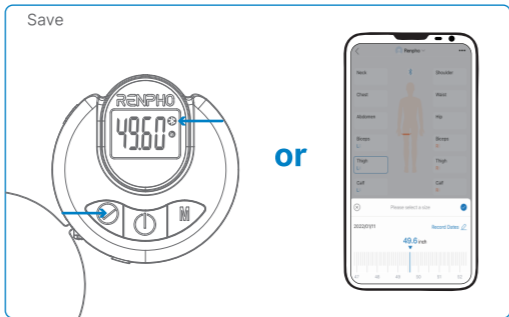

1. Press the detach button to release the tape, and wrap it around the body part to be measured.
2. Insert the locking pin into the tape receptacle, press until a "click" sound is heard.
3. Press and hold the retract button until the tape has fully tightened around the body part to be measured.
4. The measurement data will be displayed on the screen. Press the unit button to alternate between units.



1. Click the body part name (e.g. Thigh) to sync data on the app.
2. Choose the date.
3. Press  on the tape or click  on the app to complete the measurement.
4. Click "Save" to keep a record of the data.
5. Press the detach button to unlock the tape and press the retract button to reel in the tape.

Note:

1. DO NOT allow the tape to retract too fast as minor injury may occur otherwise.
2. DO NOT use excessive force to pull the tape (over 1 m/39.4 inch per second) as this may cause inaccurate readings.

Problems	Causes	Solutions
Ambiguous or no display	No battery or incorrect installation of battery	Reinstall or replace the battery
Sudden change of display when the tape hasn't been released	Brought by strong vibration or violent shaking	Reset the display before releasing the tape for measuring
Unusual number flashing or stuck display	Internal malfunction	Remove the battery and reinstall again

FCC Regulatory Compliance

This device complies with part 15 of the FCC Rules. Operation is subject to the following two conditions: (1) This device may not cause harmful interference, and (2) this device must accept any interference received, including interference that may cause undesired operation. Warning: changes or modifications not expressly approved by the party responsible for compliance could void the user's authority to operate the equipment. Note: This equipment has been tested and found to comply with the limits for a Class B digital device, pursuant to Part 15 of the FCC Rules. These limits are designed to provide reasonable protection against harmful interference in a residential installation. This equipment generates, uses and can radiate radio frequency energy and, if not installed and used in accordance with the instructions, may cause harmful interference to radio communications. However, there is no guarantee that interference will not occur in a

particular installation.

If this equipment does cause harmful interference to radio or television reception, which can be determined by turning the equipment off and on, the user is encouraged to try to correct the interference by one or more of the following measures:

- Reorient or relocate the receiving antenna.
- Increase the separation between the equipment and receiver.
- Connect the equipment into an outlet on a circuit different from that to which the receiver is connected.
- Consult the dealer or an experienced radio/TV technician for help.

RF Exposure Compliance

This equipment complies with FCC radiation exposure limits set forth for an uncontrolled environment. This transmitter must not be co-located or operating in conjunction with any other antenna or transmitter.

ISED Regulatory compliance

This device contains licence-exempt transmitters that comply with Innovation, Science and Economic Development Canada's licence-exempt RSS(s).

Operation is subject to the following two conditions:

- (1) This device may not cause interference.
- (2) This device must accept any interference, including interference that may cause undesired operation of the device.

Le présent appareil est conforme aux CNR d'Industrie Canada applicables aux appareils radio exempts de licence. L'exploitation est autorisée aux deux conditions suivantes:

- (1) l'appareil ne doit pas produire de brouillage, et (2) l'utilisateur de l'appareil doit accepter tout brouillage radioélectrique subi, même si le brouillage est susceptible d'en compromettre le fonctionnement.

This equipment complies with IC RSS-102 radiation exposure limits set forth for an uncontrolled environment.

Cet équipement est conforme aux limites d'exposition aux radiations IC CNR-102 établies pour un environnement non contrôlé.

RENPHO Smart Body Tape Measure 2



Model: R-Y001

Thank you for choosing the RENPHO Smart Body Tape Measure 2! This Bluetooth body tape measure is your personal health assistant. It will help you easily measure various body parts so you can keep track of your health and fitness. We hope that you enjoy using it!

Important Safety Instructions

1. DO NOT use this device for any purpose other than outlined in this manual.
2. DO NOT disassemble or modify the device. There are no user-serviceable parts inside.
3. DO NOT subject the device to extreme conditions: extreme temperatures beyond operating temperatures, high vibrations, dusty area, humid conditions (including any liquid) or direct sunlight.
4. DO NOT use excessive force on the tape or the gear. Excessively pulling the tape or grinding the gear may cause permanent damage to the device.
5. DO NOT fold or twist the tape as this may cause permanent damage.
6. DO NOT use excessive force to pull the tape beyond the maximum length of 150cm/60inch. This may permanently damage the device.
7. Be very careful when measuring neck circumference. The tape may accidentally cause choking.
8. Children under ten years old must be supervised by an adult when using the tape.



01

Specifications

Product Name: Smart Tape
Model: R-Y001
Unit: cm/in
Size: 70mm x 70mm x 26mm
Measuring Range: 150cm/60in
Resolution: 1mm, 1/16in
Accuracy: $\pm 3\text{mm}$, $\pm 3/32\text{in}$
Working Temperature: 32°F ~ 122°F
Working Humidity: $\leq 85\%$
Battery: 3V CR2032
Stand-by Current: 1 μA
Working Current: 2mA

Product Diagram

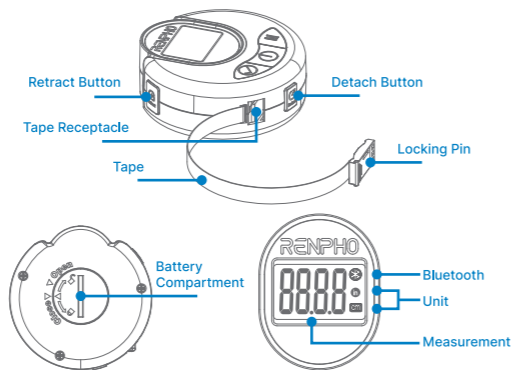

02

What's in the Box

1 x RENPHO Smart Body Tape Measure 2
1 x CR2032 Battery
1 x User Manual

Buttons

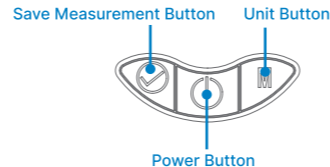

- : Press to power on. Press and hold to power off.
- : Press to switch the unit between inches and centimeters.
- : Press to confirm and send the measurement to the app

via Bluetooth. Press and hold to reset the data.

Install the Battery

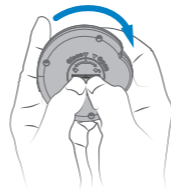

1. Use your thumb to twist the battery cover slot open.
2. Insert the battery and ensure the positive pole is facing up.
3. Place the battery cover over the opening, and rotate counterclockwise to lock it.

03

Getting Started



Scan the QR code or search "Renpho Health" in the Apple App Store or Google Play Store.

Connect with your smartphone app

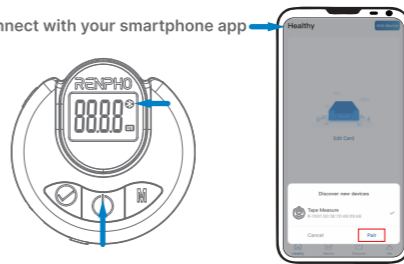

04

Short press the power button to turn the tape on. The Bluetooth is not connected if the Bluetooth icon continuously flashes.

1. Turn on the Bluetooth and open the "Renpho Health" app.
2. Turn on the tape using the power button and tap "Pair" on the app to connect the tape with the app.
3. The Bluetooth icon will be solid once connection is successful.

Warranty Policy

Your RENPHO product purchase is covered by a one-year limited manufacturer warranty from the date of delivery.

For warranty terms and conditions, please visit:
<https://renpho.com/pages/warranty-terms-and-conditions>

Note: Product registration is not required for the warranty. If you choose not to register your product, it will not diminish the product warranty.

Customer Service

Please feel free to contact us if you have any questions or concerns. RENPHO Customer Service Team guarantees a quick response and hassle-free solutions to any issue you may have within business hours.

- TEL: +1(844) 417 0149 (US ONLY)
Monday-Friday 9:00AM-4:30PM
1800 MY RENPHO (1800 69 7367) (AU ONLY)
Monday-Friday 9:00AM-6:00PM (AEST)
- Email: support@renpho.com (US&CA)
support-au@renpho.com (AU)

*For defective products or the return of items, please contact us with your order number within the specified warranty period. DO NOT dispose of any product parts as they may be required for inspection/repair.

US Importer: JOICOM CORPORATION
14129 The Merge Street, Building 3 Unit A, Eastvale, CA 92880

Manufacturer: Shenzhen Ruiyi Business Technology Co., Ltd.
Qianhai Complex A201, Qianwan Road 1, Qianhai Shenzhen-Hong Kong Cooperation Zone, Shenzhen, P.R.China

Made in China
NA1