

User Manual



Smart Bloom 8

Model: ID-IG307S



CONTENTS

Important Safety Instructions	01
About the Product	01
Raise & Lower the LED Light Panel	03
Operation Procedure	03
Control Panel	06
APP Instructions	07
Gardening Tips for Maximum Harvests	16
Product Maintenance	17
Frequently Asked Questions & Answers	18
Warranty (1-Year Period)	19
Customer Service	19

Important Safety Instructions

1. Do not use this product outdoors. It is intended for household use only.
2. Please use the power adapter with a 12V output voltage and a 2A current. To reduce the risk of electric shock, do not alter or replace the power adapter in any way.
3. Always unplug the Gardening Kit from the outlet before doing any routine maintenance.
4. Do not use the Gardening Kit if it has a damaged cord or power adapter. Do not use if it is malfunctioning or has dropped into the water. If the product is damaged, contact customer service via email: support@idooworld.com.
5. Do not set up the machine when it is plugged in or turned on. Never dismantle or attempt to repair the machine on your own.
6. Do not allow water to touch the LED light panel. Keep the cord away from heated surfaces to prevent damage.
7. Always keep any electrical components of the machine away from water to prevent water damage to the machine. If water is spilled onto any electronic component, dry all electronic cables and components immediately and thoroughly.
8. This machine is not intended to be used by children or persons with impaired physical, sensory or cognitive abilities, and persons lacking experience and knowledge unless they have been given supervision or instructions regarding the machine's usage. Children should always be supervised when operating the machine. It is not a toy.
9. The maximum height of the light panel is about 34.5cm/13.6inch. Please ensure that all seeds grow within the height of the light panel.
10. The water level must be in contact with the seedling sponge in the early stages.
11. The heat dissipation temperature of the aluminum shell of the light panel is less than 122°F/50°C, touch carefully to avoid burns or accidental injury.
12. Keep the water tank clean to avoid bacterial reproduction.
13. In case of withered and unhealthy plants, remove them immediately to avoid root erosion and/or bacterial reproduction. If you notice any rotten roots, it is advised to clean the water tank to prevent them from affecting other plants.

Advice for Water Pump

1. The machine needs water in the tank to operate, otherwise, it would shorten the lifespan of the water pump.
2. Pay attention to plant roots getting tangled up in the water pump. Roots that are too long can interfere with the water pump, trim roots before cleaning, and ensure that there is enough water in the tank before turning the power on.

About the Product

1. Overview



2. Specification

Product Name: Smart Indoor LED Hydroponic System

Model: ID-IG307S

Power Adapter: 100-240V~ 50/60Hz

Input: 12V  2A

Working Temperature: 59°F - 86°F / 15°C - 30°C

Water Tank Capacity: 4L

Material: ABS

Light Panel: NOT Waterproof

Symbol	Definition
	Direct Current
	Alternating Current

3. Package Contents



8 x Basket



10 x Sponge



8 x Tag



1 x Solid Nutrients A



1 x Solid Nutrients B



8 x Seedling Cover



8 x Basket Label



1 x Plug Adapter



1 x Backup Rubber Stopper



4 x Basket Container Cover



1 x Quick Guide Card



1 x User Manual

Raise & Lower the LED Light Panel

* Connect three poles, then insert them through water tank top cover to get the maximum height.

* Insert one pole through water tank top cover to get the minimum height.

Tip: When planting a new seed pod, set the light panel to the lowest possible position.



Operation Procedure

Step 1: Connect the water pump

Insert the water pump cord into the port and then lay the water tank top cover on the machine. Ensure the pump cord is fixed within the notch.



Step 2: Add seeds

Note: The Gardening Kit does not include seeds. It is recommended to purchase seeds from a known local brand.

- Put 3-4 seeds into the wet sponge. (Some seeds germinate in less than 24 hours, some may take 1-4 weeks.)
- Place the sponge into the planting basket.
- Place the basket label and seedling cover in sequence on the planting basket.



Tips:

1. Use the soaking method to remove the bad seeds. It is recommended that the seeds be soaked in water for 2 hours and then selected from the bottom. These seeds will have a higher germination rate.
2. The basket label helps to prevent the sponge from developing mold/algae and the seedling cover helps the seeds germinate.

Step 3: Add water

- Place the planting basket into the basket container.
- Pour tap water or distilled water through the inlet till the water level reaches the bottom of the planting basket. For better results, observe and keep the water level **above 4L**. Keep in mind to **add water while adding a proportionate amount of nutrients (see Step 4)**.



Note:

Do not use well water as it may interfere with the nutrients, or softened water as it may contain sodium contents that are harmful to plants.

Step 4: Add nutrients

1. Add room-temperature tap water or bottled distilled water to nutrient A bottle and shake until well mixed.
2. Add room-temperature tap water or bottled distilled water to nutrient B bottle and shake until well mixed.
3. Add mixed solution A and mixed solution B while adding a proportionate amount of water into the tank. 4L water requires 20ml solution A and 20ml solution B.

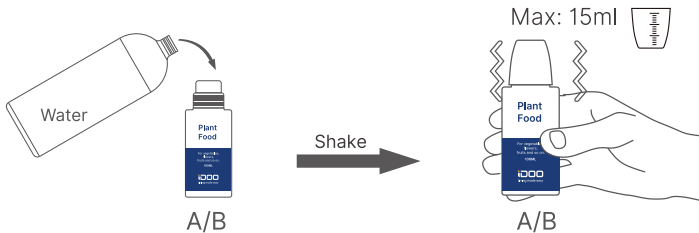

Water	Nutrient
1L	5ml A + 5ml B
2L	10ml A + 10ml B
3L	15ml A + 15ml B
4L	20ml A + 20ml B

Note:

1. Adding too much nutrient solution can be harmful to your plants.
2. Do not use well water or softened water. Most well water contains a large number of dissolved solids that may disrupt the balance of nutrients, and softened water adds sodium. This can cause abrupt browning of plants or simply poor growth.

Shelf Life:

- Plant food nutrients can be stored unopened for 2 years at room temperature without exposure to sunlight.
- Plant food nutrients that have been dissolved in water can be stored for 5 months if not exposed to sunlight.

Step 5: Cover the empty holes

If you intend to plant larger plants, it is recommended to plant them at a separated distance to allow for better overall growth. Cover the empty holes to prevent the water tank from being exposed to light, which could potentially allow for mold and bacteria growth and affect plant roots.



Step 6: Choose one seedling

After the seed germination, it is recommended to keep only one seedling. (Growing two or more seedlings in the same sponge may result in poor growth due to insufficient nutrients.)



Step 7: Plug-in

Plug the cord into the power port and connect the plug to an electrical outlet. Do not plug in if there is no water in the tank.



Control Panel



Power



Water



Vegetables



Flowers &
fruits



Power

After plugging in, the power indicator will be solid **Red** and flash **Green** intermittently, indicating that the machine is in standby mode and WiFi pairing mode.

Press the power button to turn on the machine, the red indicator light will be off. Press again to turn off the machine.

Memory function: The machine has a memory function, whether it is powered off or in standby mode. This means that the next time it is switched on, it will automatically return to the previously selected mode.



Water

The water pump will automatically turn on each time the power button is pressed and run in a cycle (30mins-on-and-30mins-off). The indicator light will turn solid Blue.

Press this button to turn off. Then the pump will automatically turn on after 10 hours. This design is to prevent the user from forgetting to turn the pump on. Note: DO NOT turn off the power, otherwise the pump will not turn on automatically.

When the water is below about 0.4L, the Water indicator light flashes, please add water and nutrient in proportion. (If the pump is not turned on, there will be no prompt.)



Vegetables

Press this button to turn it on/off. It will automatically run in a cycle (16h-on-and-8h-off). The indicator light will turn solid Blue and the light panel will turn **Red/White/Blue**.



Flowers &
fruits

Press this button to turn it on/off. It will automatically run in a cycle (16h-on-and-8h-off). The indicator light will turn solid Blue and the light panel will turn **Red/White**.

Note:

1. Vegetables and Flowers & fruits modes work independently. The cycle will reset each time you switch between modes.
2. To avoid the LED light affecting your sleep during nighttime, you can disable the current planting mode to turn off the light. The light will turn on automatically after 10 hours. This design is to prevent the user from forgetting to turn the light on.

Note: DO NOT turn off the power, otherwise the LED light will not turn on automatically.

3. Once you choose a planting mode, the LED light will automatically turn on and off in a cycle to provide your plants with the "sunlight" needed.

Note: No need to turn on/off the light manually.

APP Instructions

Note: Due to continuous updates and improvements, the app may appear slightly different. Please follow the in-app instructions in case of any differences.

1. Search

Search for "Gennecc" on App Store/Google Play or scan the QR code below to download the app.



Gennecc



2. Register

Tap "Register" to create a new account and then log in.

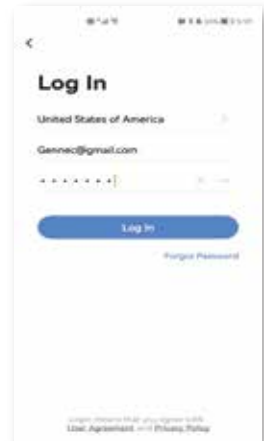
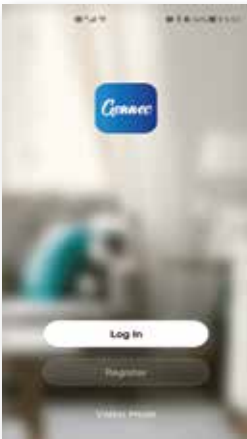

3. Add Device

Note: Please make sure your phone is connected to a secure 2.4 GHZ WiFi network. The device can only be connected on a secure 2.4 GHZ network.

Plug in the device and enable your Bluetooth, the power indicator will flash green, waiting for connecting. Once connection is successful, the power indicator will be solid **Green**.

There are other 3 methods to connect the device.

Method 1

Tap “Add Device” or “+” on the upper right corner, then tap “Add”. Input the Wi-Fi password and tap “Next” to add the device through Default Configuration Mode (EZ Mode) following the in-app instructions.

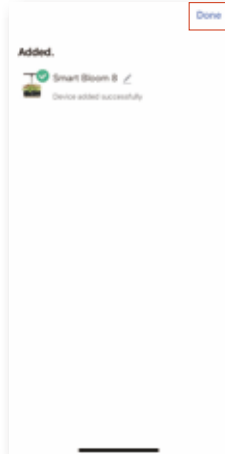
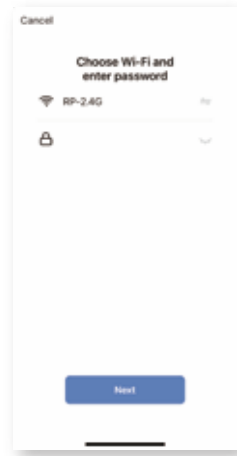
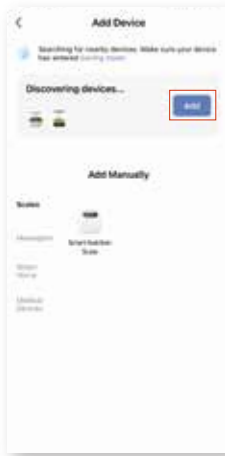

Method 3

If the Default Configuration Mode (EZ Mode) fails to connect, you can use AP (Access Point) Mode. This mode enables you to connect your mobile phone to the device's hotspot.

1. Follow the following steps.

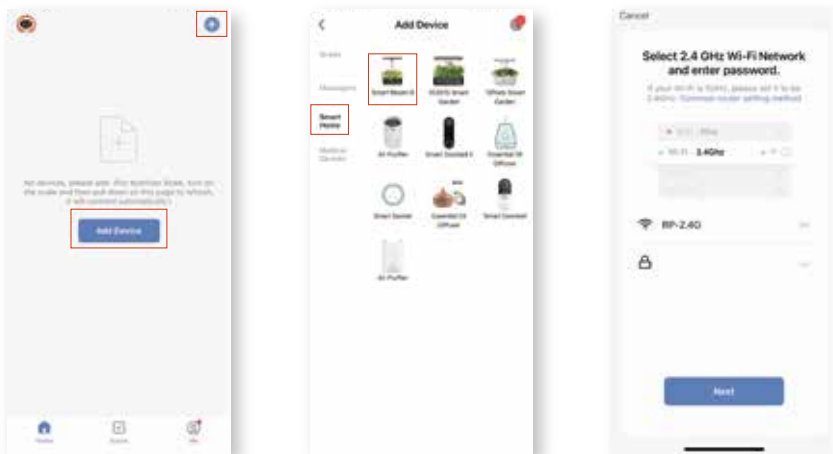

2. Tap the upper right corner and switch to AP Mode, then reset and connect the device following the in-app instructions step by step. Choose "SmartLife_XXXX". (XXXX is a code consisting of numbers and letters. The code for each Smart Garden is different.) Then return to App page and wait for it to connect.

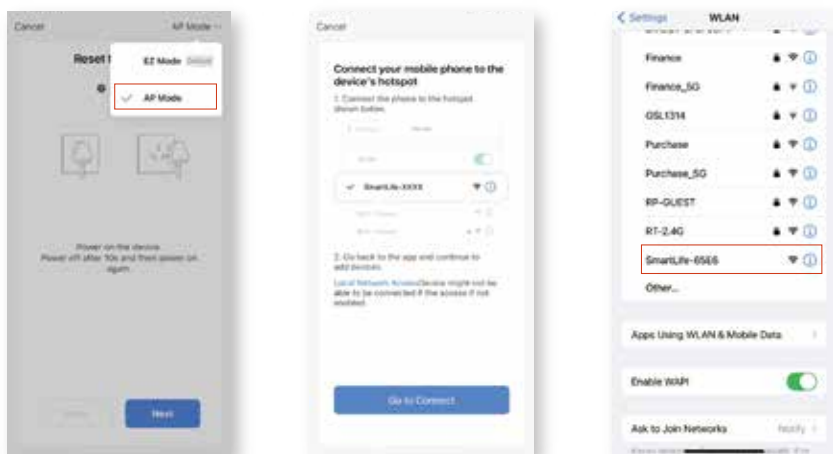

Power Indicator Light	Status
Green light flashes rapidly	EZ Mode
Green light flashes slowly	AP Mode
Solid green light	Wifi connected

4. Operation

4.1 Home Page

After pairing successfully, you will be directed to the Home Page. Tap “Power On/Off” to turn on/off the device.

Tap corresponding keys to control the settings of Flowers & Fruits/Vegetables modes, Light, and Pump.

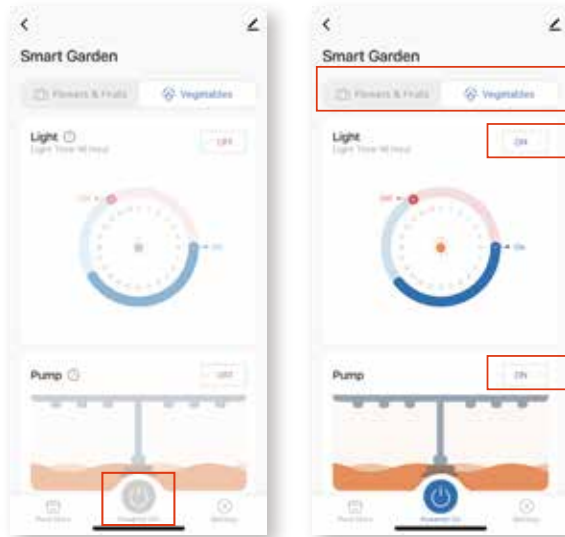

Tap the “Settings” icon to set the following functions or you can directly tap the **corresponding image area** to enter its settings.

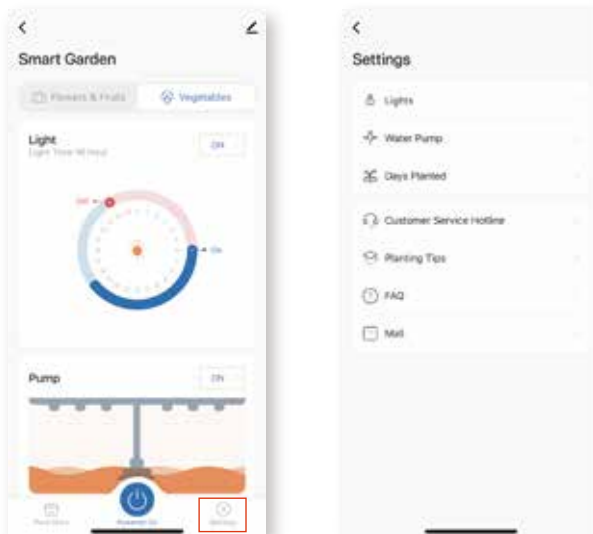

Light Settings

Tap “Settings” → “Lights” → “Custom Settings” to customize the light time for different growing stages.

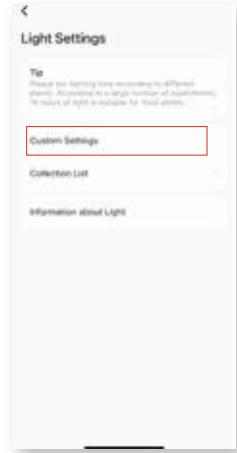
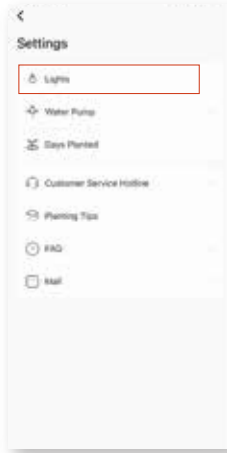

Tap “Save” to complete the time setting. The default timer is 16-hour on and 8-hour off.

Collection function: If you find certain time settings more practical, tap 'Collection' and assign a name to add it to the Collection List, so you can apply it to the same plant next time.

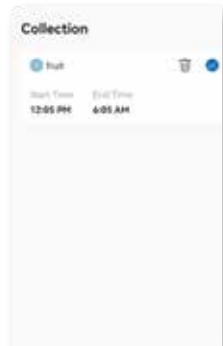

Note: If you turn off the lights manually, the device will go to sleep for 10 hours. Sleep time is deducted from the light cycle.

For example, the default light time is 16 hours on and 8 hours off. If you turn the light off after it has been on for 5 hours, the light will resume with 1 hour remaining.

If you turn the light off after it has been on for 10 hours, the light will automatically turn on after 14 hours.

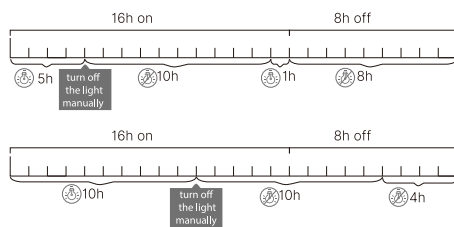

Water Pump Setting

Tap “Settings” → “Water Pump” to enter the Water Pump Setting. You can customize the pump runtime for different plants or for your own routine. The default timer is 30 min-on and 30 min-off.

If you turn off the pump on the app, the pump will enter sleeping mode and automatically turns on.

Note: When the device is short of water, the pump section will turn yellow. Please add water in

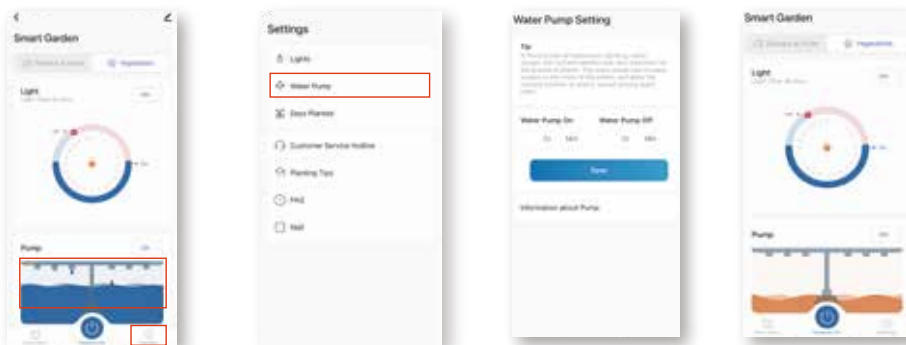

Days Planted Setting

Tap “Settings” → “Days Planted” to enter Days Planted setting. You can manually modify or reset the Days Planted by inputting a specific number of days.

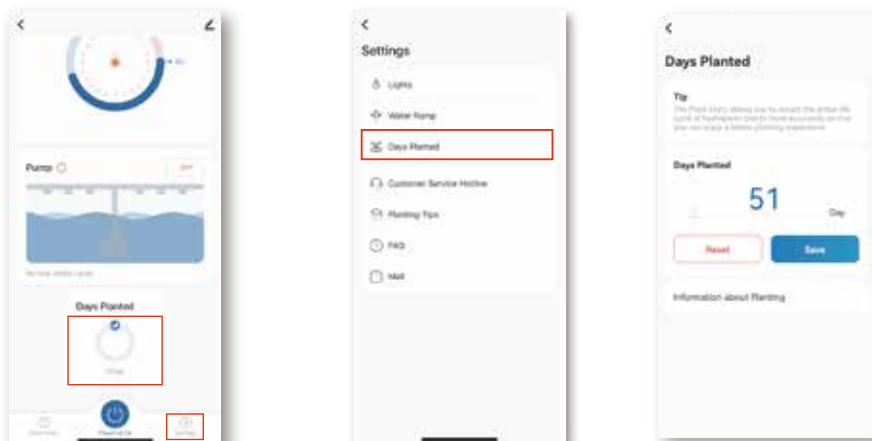

4.3 Plant Diary

Tap “Plant Diary” on the Home Page, then you can add your plant diary. You can set the name, date and time to start recording different stages of growth. Tap “Save” to save the settings. To delete the Diary, simply tap the bin icon.

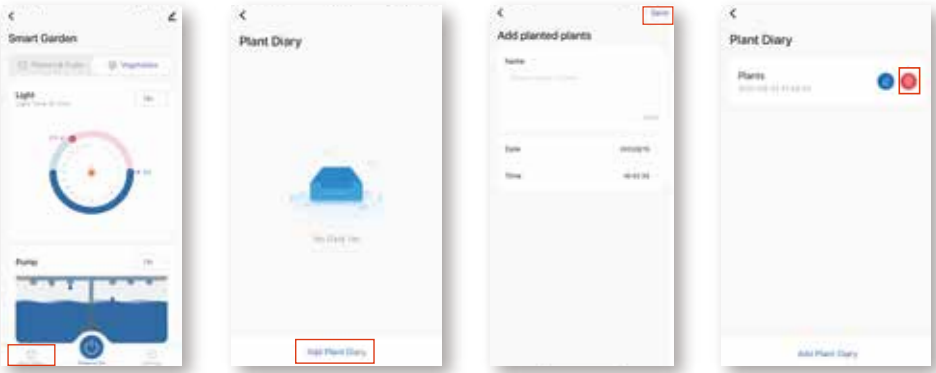

Select the new Plant Diary entry, then you can edit the content. Tap “Add Content” to upload content and pictures to record growth of the plants at different stages. Tap “Save” to save the contents. Tap the bin icon to delete the content of this record.

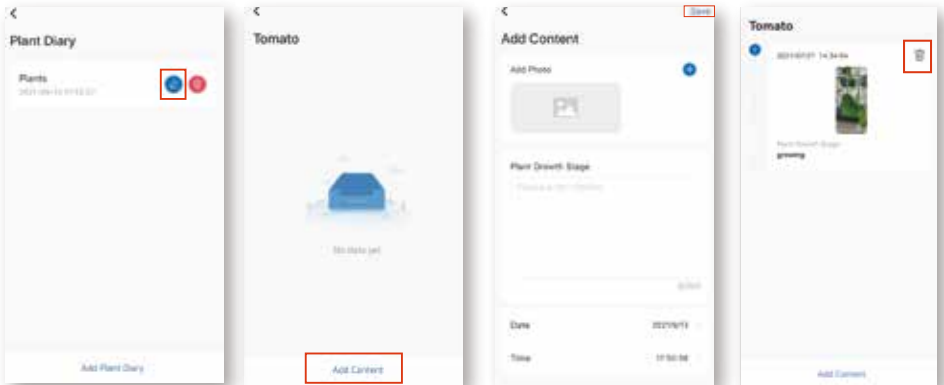

5. Remove Device

Tap the pen icon at the upper-right corner on the Home Page to enter the interface shown below, swipe down and tap “Remove Device” to remove/reset the device.

Or you can return to Home page, long press the connected device and then select it, tap “Remove Device”.

* This will help troubleshoot issues you may encounter, especially when your planter has gone offline.

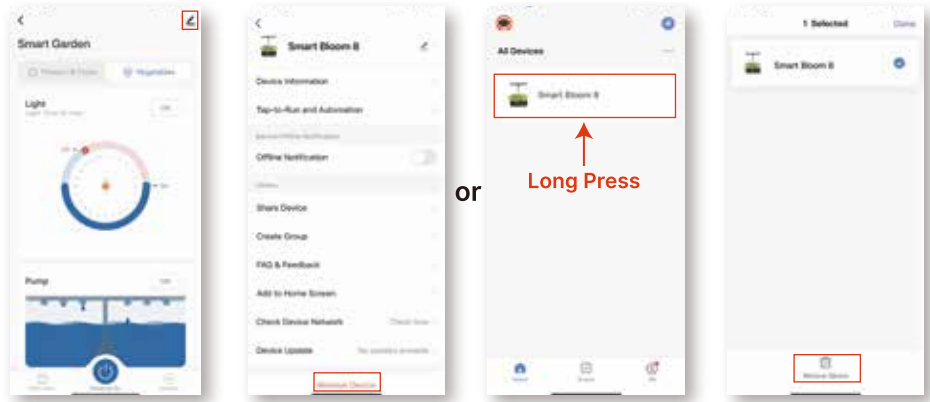

Tip: If you want to connect this device to another phone, you can either remove the device, or press and hold the Power button until the Power indicator light flashes, so that the product can enter network configuration mode.

Gardening Tips for Maximum Harvests

Germination

1. Check the seed information regarding optimal temperature and days to germinate. Plant 3-5 seeds per sponge. Some seeds germinate in less than 24 hours, some take 1-7 days, others require 1-4 weeks.

Note: Plants have seasonal, periodic, and regional characteristics. Characteristics of different plants (temperature, light, and atmospheric humidity) are all related to plant growth. Planting crops suitable for local growth in the current season is the best.

2. If there are plants that have sprouted, turn on the LED Light Panel. Do not wait for all the plants to sprout, otherwise, those sprouted plants will grow excessively. You do not need to turn the light on when you first place them and had better wait until the seeds have finished germinating.

3. The seedling cover helps regulate moisture and temperature for optimal seed germination. Leave them on until plants are nearly touching the cover, then take them off to allow for normal growth.

4. For larger plants, it is recommended to plant them at a separated distance to allow for better overall growth. Cover the empty holes to prevent the Water Tank from being exposed to light, which could potentially allow for mold and bacteria growth and affect plant roots.

Transplant:

- Only when you see rhizome (plant stems) around the sponge, may you transplant the seedling.
- Split the sponge to take one seedling out and move it to another pot.



Pruning

- Prune your plants to maintain their height, rather than continuing to raise the light panel. Pruning ensures your plants stay compact and healthily distanced from the light panel, which will provide you with a bigger harvest!
- Pruning the plant just above a new leaf set while maintaining the light panel height will ensure that slow-growing plants in your garden get all the light they need to flourish.
- Prune often to maintain a healthy garden, but never take more than 1/3 of each plant at a time.
- Plants compete for light. Left untended, faster-growing plants can even begin to block enough light to suppress the growth of their slower-growing neighbors. Spreading leaves must be trimmed to ensure slow growers continue to receive enough light to thrive and produce big yields.
- Finally, pruning can also mean harvesting. Each time you



prune you get to enjoy fresh herbs in a salad, soup on pizza or a sandwich. A full, healthy garden will look much better than a giant, uncontrolled mess. Pruning keeps control of your Gardening Kit!

Pollinating

As most people do not have bees in their home, you will need to start manually pollinating your fruiting plants (tomatoes, peppers, etc.) once they begin to flower (approximately 4–6 weeks after planting). To pollinate, use one or more of the following methods:

1. Place an open hand inside plant branches and gently move your hand back and forth to shake the plant and spread the pollen. Do this carefully to avoid injury.
2. Use one cotton swab or fine brush to gently rub the flowers of different plants and promote the effects of cross-pollination.

Flowering and Fruiting

1. Change the water and add proportionate nutrient solution once per week, ensuring the plant can absorb enough potassium so that it can flower and fruit.
2. In a high-temperature environment, the nutrient solution concentration will be high due to rapid water evaporation. Be sure to change the water once every 7-15 days.

Harvesting

- The Gardening Kit works best with a harvesting method called “cut and come again.” Simply put, you enjoy frequent, small harvests and then watch as the plants rapidly regrow - ready for harvest again and again.
- Enjoy frequent, smaller harvests for the first month or two until plants mature to offer larger harvests.
- Harvest often to maintain a healthy garden, but never take more than 1/3 of each individual plant at a time.
- For most salad greens and herbs, cut the top 2 inches off the entire garden, or harvest large leaves individually by cutting off at the base of the plant.

Product Maintenance

Cleaning Water Tank

Keep the water tank clean to avoid bacterial reproduction. The light panel is detachable, so you can directly pull it out to help clean the water tank easily.

Changing Water

The nutrient concentration will be higher as water evaporates in a high-temperature environment. It is advised to change the water approximately once every 7-15 days. After the plants bloom, change the water once a week to ensure that the potassium content is sufficient.

There is a drain hole at the back of the water tank to help change water easily. Remove the rubber stopper and let the water flow out.

Note: When changing water, always ensure to add nutrient solution in proportion.



Cleaning Pump

Clean the water pump at least once a month.

Step 1: Turn the power off and remove the top cover of the water tank.

Step 2: Take out the pump and remove the filter cover from the water pump.

Step 3: Take out the cotton. Rinse the cover and cotton with water ONLY. Any washing liquid will harm the nutrition balance.

Step 4: Put the filter cotton back into the cover and reinstall to the water pump.



Note: During the planting process, if there are dead or badly growing plants, remove them to prevent root erosion bacteria from affecting the growth of other plants. If root rot has occurred, it is recommended to clean and disinfect the water tank to avoid affecting other plants.

Place Your Garden Kit

On a sturdy, water-tolerant surface;

In a 59°F-86°F (15-30°C) environment (optimal);

Beyond the reach of children or pets;

Away from direct sources of heat (stove, furnace vents, e.g.,) or cold (window drafts, A/C vents, e.g.,).

It does not need any additional light or a sunny window. However, too much direct sunlight may overheat your plants.

Frequently Asked Questions & Answers

1. Why do only a few plants grow and then wither quickly?

a. The seeds you purchase make a difference. For best results, buy seeds from reliable manufacturers and avoid those not suitable for water hydroponic devices.

b. Be sure to add the correct proportion of nutrient solution to water.

c. Keep the LED grow lights at least 12cm/4inch from the plants and place them in a 59°F-86°F (15°C-30°C) environment.

2. Why does the pump start with noise?

a. The noise is caused by the unpleasant air in the water pump when it is used for the first time. It can be eliminated by continuously working for 3 to 5 minutes or restarting it multiple times.

b. When the water level is below the pump, the pump may operate with noise. Add water to 4L, and the noise will stop.

c. Open the water pump and take out the filter cotton to check whether there is a jam inside.

3. Can sponges be reused?

It is reusable when the stems of a plant are pulled out of the sponges. However, it is not

recommended to do so as it will not be as good as the first usage. We have a specific link if you want to purchase additional sponges.

4. Does it kill the plant while removing it from a sponge (if I prefer to move it to a pot, for example)?

Normally, it won't kill the plants. It is recommended to wait until it's vigorous to ensure higher survival rate.

5. Why does it not germinate?

It may be affected by temperature, place it in a temperature environment suitable for seed germination. You can also try to grow it in the soil to test whether it is the seed problem.

6. Why does it not bloom or bear fruit?

Make sure the nutrition is enough. Keep in mind to add water while adding a proportionate amount of nutrients.

7. How can you prevent the sponge from getting moldy or developing algae?

Basket labels are included in the package to prevent the sponge from developing moldy/algae. You can also cover the sponge with an opaque film, such as tin foil.

Warranty (1-Year Period)

The manufacturer's warranty is void under the following circumstances but not limited to:

- Improper or inadequate maintenance or modification.
- Accident, misuse, abuse, contamination, or other external causes.
- The use of unspecified adapter and accessories.
- Loss or damage in transit.
- Damages that occur as a result of one's failure to follow the instructions.
- This warranty does not apply to expendable or consumable parts and does not extend to any product from which the serial number has been removed.

Customer Service

We have an award-winning warranty, exchange, and customer service team that guarantees hassle-free solutions to any issue you might have within the 24 business hours.

 **Tel: +1(951)751-2590 (US ONLY)**

Monday-Friday: 9:00AM-4:30PM

 **Email: support@idooworld.com**

*For defective products or the return of items, please contact us with your order number within the specified warranty period. DO NOT dispose of any product parts as they may be required for inspection/repair.

FCC Regulatory Compliance

This device complies with part 15 of the FCC Rules. Operation is subject to the following two conditions: (1) This device may not cause harmful interference, and (2) this device must accept any interference received, including interference that may cause undesired operation.

Warning: changes or modifications not expressly approved by the party responsible for compliance could void the user's authority to operate the equipment.

Note: This equipment has been tested and found to comply with the limits for a Class B digital device, pursuant to Part 15 of the FCC Rules. These limits are designed to provide reasonable protection against harmful interference in a residential installation. This equipment generates, uses and can radiate radio frequency energy and, if not installed and used in accordance with the instructions, may cause harmful interference to radio communications.

However, there is no guarantee that interference will not occur in a particular installation. If this equipment does cause harmful interference to radio or television reception, which can be determined by turning the equipment off and on, the user is encouraged to try to correct the interference by one or more of the following measures:

- Reorient or relocate the receiving antenna.
- Increase the separation between the equipment and receiver.
- Connect the equipment into an outlet on a circuit different from that to which the receiver is connected.
- Consult the dealer or an experienced radio/TV technician for help.

This equipment complies with FCC radiation exposure limits set forth for an uncontrolled environment. This equipment should be installed and operated with minimum distance 20cm between the radiator & your body.

RF Exposure Compliance

This equipment complies with FCC radiation exposure limits set forth for an uncontrolled environment. This transmitter must not be co-located or operating in conjunction with any other antenna or transmitter.

ISED Regulatory compliance

This device contains licence-exempt transmitters that comply with Innovation, Science and Economic Development Canada's licence-exempt RSS(s).

Operation is subject to the following two conditions:

- (1) This device may not cause interference.
- (2) This device must accept any interference, including interference that may cause undesired operation of the device.

Le présent appareil est conforme aux CNR d'Industrie Canada applicables aux appareils radio exempts de licence.

L'exploitation est autorisée aux deux conditions suivantes:

- (1) l'appareil ne doit pas produire de brouillage, et
- (2) l'utilisateur de l'appareil doit accepter tout brouillage radioélectrique subi, même si le brouillage est susceptible d'en compromettre le fonctionnement.

This equipment complies with IC RSS-102 radiation exposure limits set forth for an uncontrolled environment.

Cet équipement est conforme aux limites d'exposition aux radiations IC CNR-102 établies pour un environnement non contrôlé.



 **US Importer: JOICOM CORPORATION**
14129 The Merge Street, Building 3 Unit A, Eastvale, CA 92880

Manufacturer: Shenzhen Ruiyi Business Technology Co., Ltd.
Qianhai Complex A201, Qianwan Road 1, Qianhai Shenzhen-Hong Kong
Cooperation Zone, Shenzhen, 518000 P.R.China

Made in China

NA1

