

EKSA

**STAR
ENGINE^{BT}**
Wireless Gaming Headset
E5000 BT

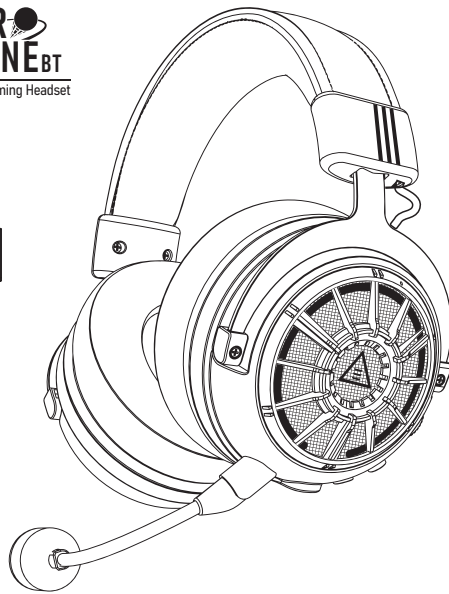

User Manual



Language Guide

English 1

Deutsch 13

Français 25

日本語 37

Русский 49

Português 61



Package Contents

- ① 1* EKSA StarEngine BT Headset
- ② 1* EKSA USB-A and TypeC Adapter
- ③ 1* Pluggable Microphone
- ④ 1* 3.5mm Audio Cable
- ⑤ 1* Charging Cable
- ⑥ 1* Microphone Sponge Cover
- ⑦ 1* Quick Guide Card
- ⑧ 1* User Manual
- ⑨ 1* Carry Pouch

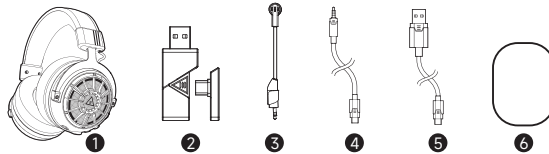
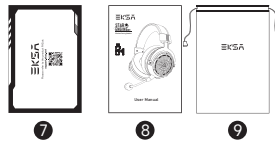

Specification

Speakers:

Speaker size: 50 mm
 Speaker impedance: 32 Ω
 Speaker frequency range: 20 Hz-20 kHz
 Speaker Sensitivity: 105 \pm 3 dB
 Lighting: RGB
 Charging time: 2.5 h

Distance/Hours

Bluetooth Mode Play Time: 100 hours (Lights off)
 2.4G Mode Play Time: 80 hours (Lights off)
 Bluetooth Mode Play Time: 52 hours
 2.4G Mode Play Time: 45 hours
 Connection distance: 15 m
 3.5mm audio cable length: 1.8 m

Microphone:

Mic type: Condenser Mic
 Talking microphone directivity: Omni-directional
 Microphone sensitivity: -42 dB \pm 3dB
 Microphone impedance: 2.2 k Ω
 Microphone placement type: Plug and play

Operation Guide

Volume wheel :

  Turn volume up to +

  Turn volume down to -

Microphone mute button / Mode switching / Pairing :

  **x1** Click microphone to turn off/on;

  **x2** Double-click microphone to switch between 2.4G and Bluetooth;

  **5"** Long press microphone mute button for 5 seconds to pair 2.4G/Bluetooth.



Operation Guide



Switch on/off/Play pause/Light switching :



Long press the button for 3 seconds to turn on/off.



Click the button to play/pause;

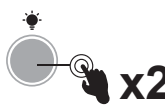

Double-click the button to turn on/switch/off the RGB lights.



Transmitters :

Plug in the transmitter to automatically connect back to the device.



3.5mm wired mode:

When the 3.5 mm audio cable is plugged in, the headset turns off automatically. When the headset is in wired mode, only the volume control wheel works, no other function works.



All-Platform Compatible

The EKSA StarEngine BT headset is configured with USB, Type-c, 3.5mm ports and also features Bluetooth connectivity. The product is compatible with PS5|PS4|Xbox One S/X|Nintendo Switch|PC|Laptop|Mobile phone or Bluetooth enabled devices.

Note : The Xbox Series only works with 3.5mm wired connections.

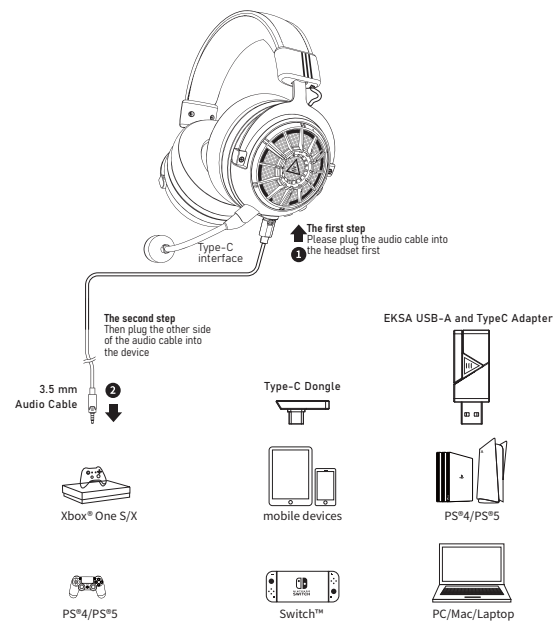



EKSA 7.1 SoundBase

Built-in powerful 50mm magnetic neodymium drivers and a 7.1 surround sound chip bring you an immersive gaming experience. Download the 7.1 driver, plug in the transmitter and select the 7.1 surround sound mode. You can also download the 7.1 SoundBase driver from our official website (<https://www.eksa.net/download>).
Note: EKSA's 7.1 surround sound driver only supports Windows 10/11.

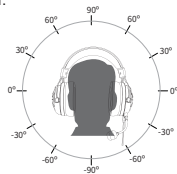

7.1 Sound effect settings:

1. Click right mouse button: Speakers
2. Select 7.1Virtual Speaker Shifter
3. Check the 7.1 surround sound selection
4. Click the game mode

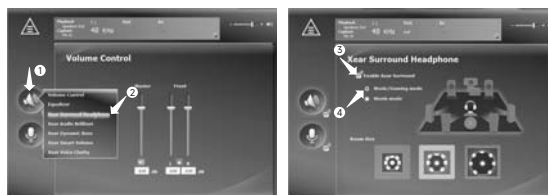



Dongle Sound Settings

Please follow the steps below to ensure that your EKSA StarEngine BT headset is the default audio device.

Windows®:

Audio Settings:

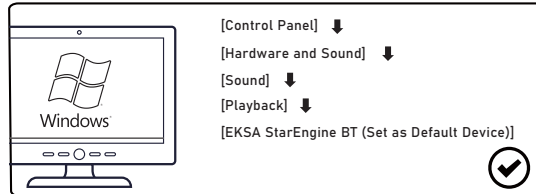

Microphone Settings:

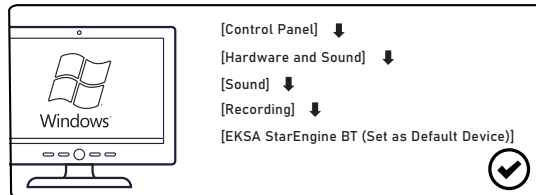

macOS:

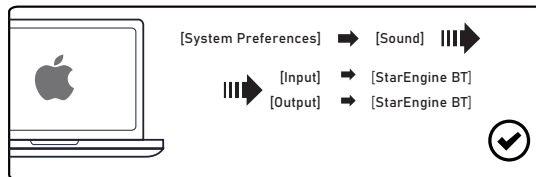



How to Use

PlayStation® 4 / PlayStation® 5:

Connect your PS®4/PS®5 directly using a USB, transmitter, then follow the steps below to check the audio settings to ensure that your PS®4/PS®5 automatically switches audio for playback and microphone.

PS®4

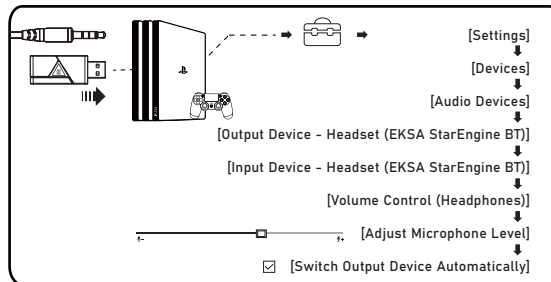

PS®5

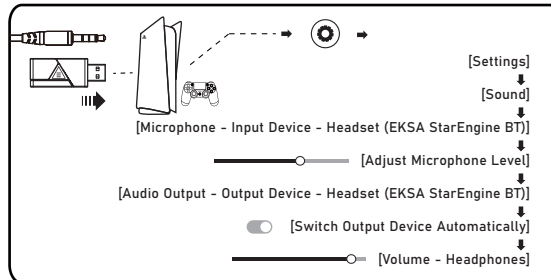



How to Use

Xbox One® S / X:

To work on the NEW version of the Xbox One® S/X controller, you can directly connect your headset to the controller via the 3.5 mm audio cable.

Notes:

1. The headset is not compatible with Xbox®360.
2. Old version of Xbox® One needs a Microsoft adapter (not included).
3. USB doesn't work on the Xbox One S/X.

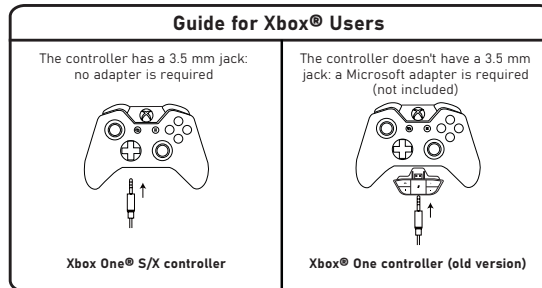



Bluetooth Pairing/Connection

For the first time pairing, the headset switches to Bluetooth mode after powering on the headset, the headset enters the pairing state, and if it is not connected for 5 minutes, the headset enters the shutdown.

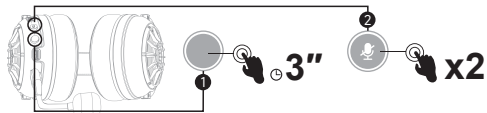

After there is a pairing record, the headset is turned on and switched to Bluetooth mode, the headset enters back to the connection state, 10 seconds without back to the connection, the headset enters into the pairing state, 5 minutes without connection, the headset enters into the shutdown. If within 5 minutes with the headset and device pairing connection success, the headset into the connection success state.

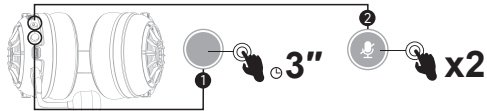

Headset boot switch to bluetooth mode, long press the microphone mute button for 5 seconds, the headset into the bluetooth clear record, clear the record after the headset into the pairing mode, the headset voice prompts Pairing after releasing the key, when the headset pairing status light is red and blue alternately flashing.

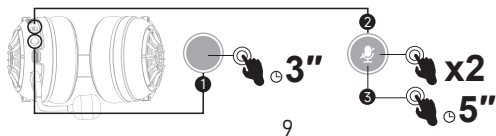



Transmitter Pairing/Connection

1. When shipped from the factory, the headset is connected to the transmitter in a binding connection, plug the transmitter into the device, turn the headset on, keep it in 2.4G mode, and the headset automatically connects back to the transmitter.

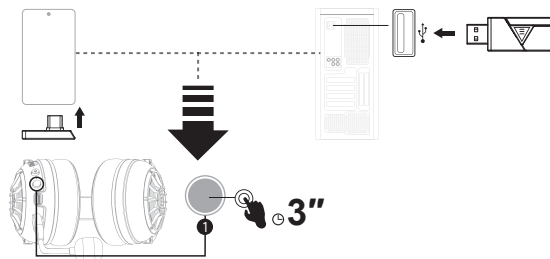

2. If the transmitter is inserted into the device, the headset is powered on in 2.4G mode, the headset can not be connected back. Please keep the headset in 2.4G mode, long press the microphone mute button for 5 seconds, release the button after the voice prompt Pairing, at this time the headset pairing status light: red and blue alternately flashing. When the headset hears the tone Connected, it means that the headset and the transmitter are automatically paired successfully, and the headset status light blinks blue twice every 2 seconds.





3.5mm Wired Connection

- (1) Under power-on condition, plug in the 3.5mm audio cable, the headset automatically shuts down and the headset switches to 3.5mm wired connection mode;
- (2) The headset cannot be turned on in 3.5mm wired connection mode;
- (3) In 3.5mm wired connection mode, volume up and down is valid, other functions are invalid.



Frequently Asked Questions

Q1: I have no audio on my headset / I don't get any sound from my headset.

- (1) First, make sure you have connected your headphones properly to your device. If that doesn't work, check your audio settings to make sure you have the speakers enabled and not muted, then check the volume of your device and headphones to make sure it's at the proper level.
- (2) Unplug and re-plug the transmitter or 3.5mm audio cable; wipe any stains or dust from the transmitter connector; reconnect the transmitter to your device and check that the microphone is working properly.
- (3) Check the sound settings (see pages 6 and 7 for detailed steps).

Q2: I can't use the headset's microphone while connected to my computer.

- (1) Go to Control Panel > Hardware and Sound > Sound. Disable the onboard microphone on your computer and make the headset microphone default.
- (2) Check that the microphone is not muted.



Frequently Asked Questions

Q3: The people I talk to on the phone can't hear me.

- (1) Check that the microphone is not muted.
- (2) Go through the audio settings and make sure your headset is the default audio device. See pages 4 and 5 for a more specific method of setting the sound.
- (3) Make sure your device is compatible with the headset. Older versions of Xbox®One require an additional Microsoft adapter (not included).
- (4) If all of this has been verified and the headset is compatible with your device, but the headset's microphone still does not work, feel free to contact us (info@eksa.net).

Q4: The headset cannot be connected to the transmitter.

- (1) Check if the transmitter is correctly inserted into the device, and check if the indicator light on the transmitter is working. If the transmitter is working, please turn on the headset, headset switch to 2.4G mode, long press the microphone mute button for 5 seconds, until the red and blue status light flashes rapidly alternately or Pairing voice prompts to release the button, at this time, the headset pairing status light: red and blue alternately flashes rapidly, the headset hears the tone Connected indicates that the headset and the transmitter is automatically paired with the success of the headset and the headset status light every two seconds. Blue light flashes twice every 2 seconds
- (2) If you still can not connect after the above correct operation, please feel free to contact us (info@eksa.net).

Limited Warranty/**保証**/**Garantie Limitée/**
Eingeschränkte Garantie/Ограниченная
Гарантия/Garantía Limitada/Garanzia
Limitata/Garantia Limitada/Sınırlı Garanti

Our friendly customer service team is ready and waiting to help. Feel free to contact us:

私たちのカスタマーサービスチームはいつでもお手伝いします。連絡先は次のとおり:

Notre amicale équipe de service à la clientèle est prête et attend de vous aider. N'hésitez pas à nous contacter :

Unser freundliches Kundenservice-Team steht Ihnen jederzeit zur Verfügung. So können Sie uns kontaktieren:

Наша дружелюбная команда обслуживания клиентов готова и ждет помощи. Не стесняйтесь обращаться к нам:

Nuestro amable equipo de servicio al cliente está listo y esperando para ayudarlo. Bienvenido a contactarnos:

Il nostro cordiale team di assistenza clienti è pronto e in attesa di aiutarlo. Non esitate a contattarci:

Nossa equipe amigável de atendimento ao cliente está pronta e esperando para ajudar. Sinta-se à vontade para nos contatar:

Güler yüzlü müşteri hizmetleri ekibimiz yardıma hazır ve bekliyor.Bizimle iletişime geçmekten çekinmeyiniz:

Global:

☎ +85269404955(Mon to Fri 9:00 am-6:30 pm, UTC +8 HKT)

✉ info@eksa.net

🌐 www.eksa.net/warranty

FCC WARNING

This device complies with part 15 of the FCC Rules. Operation is subject to the following two conditions: (1) This device may not cause harmful interference, and (2) this device must accept any interference received, including interference that may cause undesired operation.

Any Changes or modifications not expressly approved by the party responsible for compliance could void the user's authority to operate the equipment.

This equipment has been tested and found to comply with the limits for a Class B digital device, pursuant to part 15 of the FCC Rules. These limits are designed to provide reasonable protection against harmful interference in a residential installation. This equipment generates uses and can radiate radio frequency energy and, if not installed and used in accordance with the instructions, may cause harmful interference to radio communications. However, there is no guarantee that interference will not occur in a particular installation. If this equipment does cause harmful interference to radio or television reception, which can be determined by turning the equipment off and on, the user is encouraged to try to correct the interference by one or more of the following measures:

- Reorient or relocate the receiving antenna.
- Increase the separation between the equipment and receiver.
- Connect the equipment into an outlet on a circuit different from that to which the receiver is connected.
- Consult the dealer or an experienced radio/TV technician for help.

FCC RF exposure statement:

The device has been evaluated to meet general RF exposure requirement. The device can be used in portable exposure condition without restriction.

IC Caution:

Radio Standards Specification RSS-Gen, issue 5

English:

This device contains licence-exempt transmitter(s)/receiver(s) that comply with Innovation, Science and Economic Development Canada's licence-exempt RSS(s). Operation is subject to the following two conditions:

This device may not cause interference.

This device must accept any interference, including interference that may cause undesired operation of the device.

RF exposure statement:

The device has been evaluated to meet general RF exposure requirement. The device can be used in portable exposure condition without restriction.

French:

Cet appareil contient des émetteurs / récepteurs exemptés de licence conformes aux RSS (RSS) d'Innovation, Sciences et Développement économique Canada. Le fonctionnement est soumis aux deux conditions suivantes:

Cet appareil ne doit pas causer d'interférences.

Cet appareil doit accepter toutes les interférences, y compris celles susceptibles de provoquer un fonctionnement indésirable de l'appareil.

Déclaration d'exposition RF:

L'appareil a été évalué pour répondre aux exigences générales d'exposition aux RF. L'appareil peut être utilisé dans des conditions d'exposition portable sans restriction.

IC Caution:Radio Standards Specification RSS-Gen, issue 5- English:This device contains licence-exempt transmitter(s)/receiver(s) that comply with Innovation, Science and Economic Development Canada's licence-exempt RSS(s). Operation is subject to the following two conditions:

This device may not cause interference. This device must accept any interference, including interference that may cause undesired operation of the device.

RF exposure statement:The device has been evaluated to meet general RF exposure requirement. The device can be used in portable exposure condition without restriction.

French:Cet appareil contient des émetteurs / récepteurs exemptés de licence conformes aux RSS (RSS) d'Innovation, Sciences et Développement économique Canada. Le fonctionnement est soumis aux deux conditions

suivantes:Cet appareil ne doit pas causer d'interférences.Cet appareil doit accepter toutes les interférences, y compris celles susceptibles de provoquer un fonctionnement indésirable de

l'appareil.Déclaration d'exposition RF:L'appareil a été évalué pour répondre aux exigences

générales d'exposition aux RF. L'appareil peut être utilisé dans des conditions d'exposition

portable sans restriction.

Manufacturer: YI ZHAO (SHENZHEN) CO., LIMITED

Add.: 6th Floor, T3 Creative Building, Creative Expo City, No.5010 Baoan Avenue, Hangcheng Street, Baoan Shenzhen, China

Manufacturer: YI ZHAO (SHENZHEN) CO., LIMITED
Add.: 6th Floor, T3 Creative Building, Shenzhen Colorful Huiwei Cultural and Creative Expo City, No.5010 Baoan Avenue, Caowei Community, Hangcheng Street, Baoan District, Shenzhen City, Guangdong Province, China



APEX CE SPECIALISTS LIMITED
Add.: 89 Princess Street, Manchester, M1 4HT, UK
Tel.: +441616371080
Email: info@apex-ce.com



C&E Connection E-Commerce (DE) GmbH
Add.: Zum Linnegraben 20, 65933, Frankfurt am Main, Germany
Tel.: +4906927246648
Email: info@ce-connection.de

US Agent

TRANS-PAC CHINA LLC
Add.: 3715 S 182nd Street, C120 Seatac, WA 98188-9993 US
Tel.: +1 (818) 818-0538
Email: lisaleeinchina@gmail.com



Points de collecte sur www.quefairedemesdechets.fr
Privilégiez la réparation ou le don de votre appareil !



FCC ID:2A25A-E5000BT IC:28237-E5000BT E5000 BT E-AG08-01
FCC ID:2A25A-EHA06 IC:28237-EHA06 Made in China