

Botslab

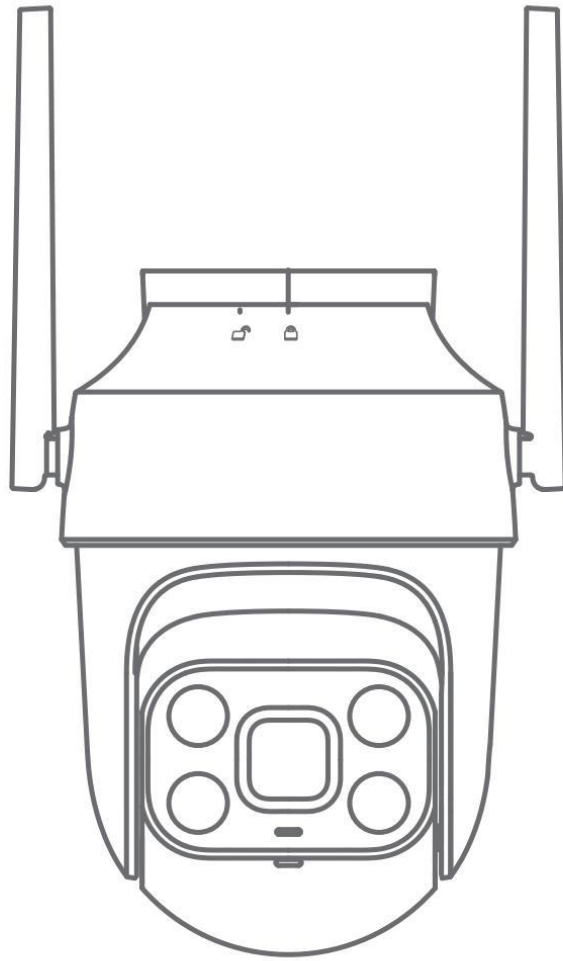

W312

Botslab Outdoor Pan/Tilt Camera Pro

Quick Start Guide

Packing list

Please check whether the main unit and all accessories are complete upon unpacking.

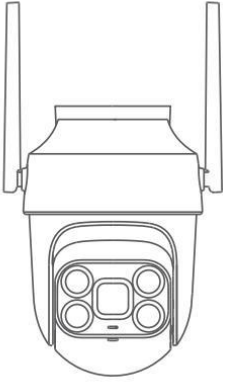

Main camera
unit x 1

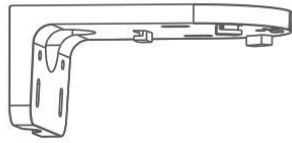

Wall
bracket x 1



Positioning
sticker x 1

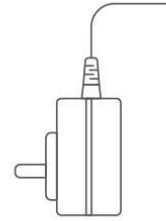

Power
adapter x 1

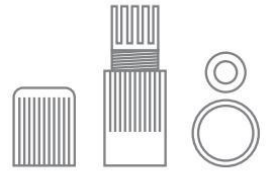

Waterproof
kit x 1



Screwdriver
x 1

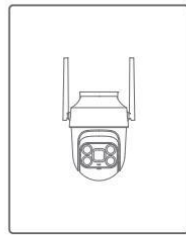

Quick Start
Guide x 1

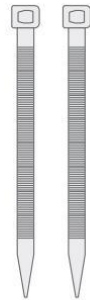

Cable
ties x 2



Eject
pin x 1

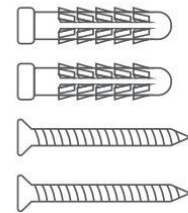

Screw pack for
installation x 1



Warning
stickers x 1

Product appearance

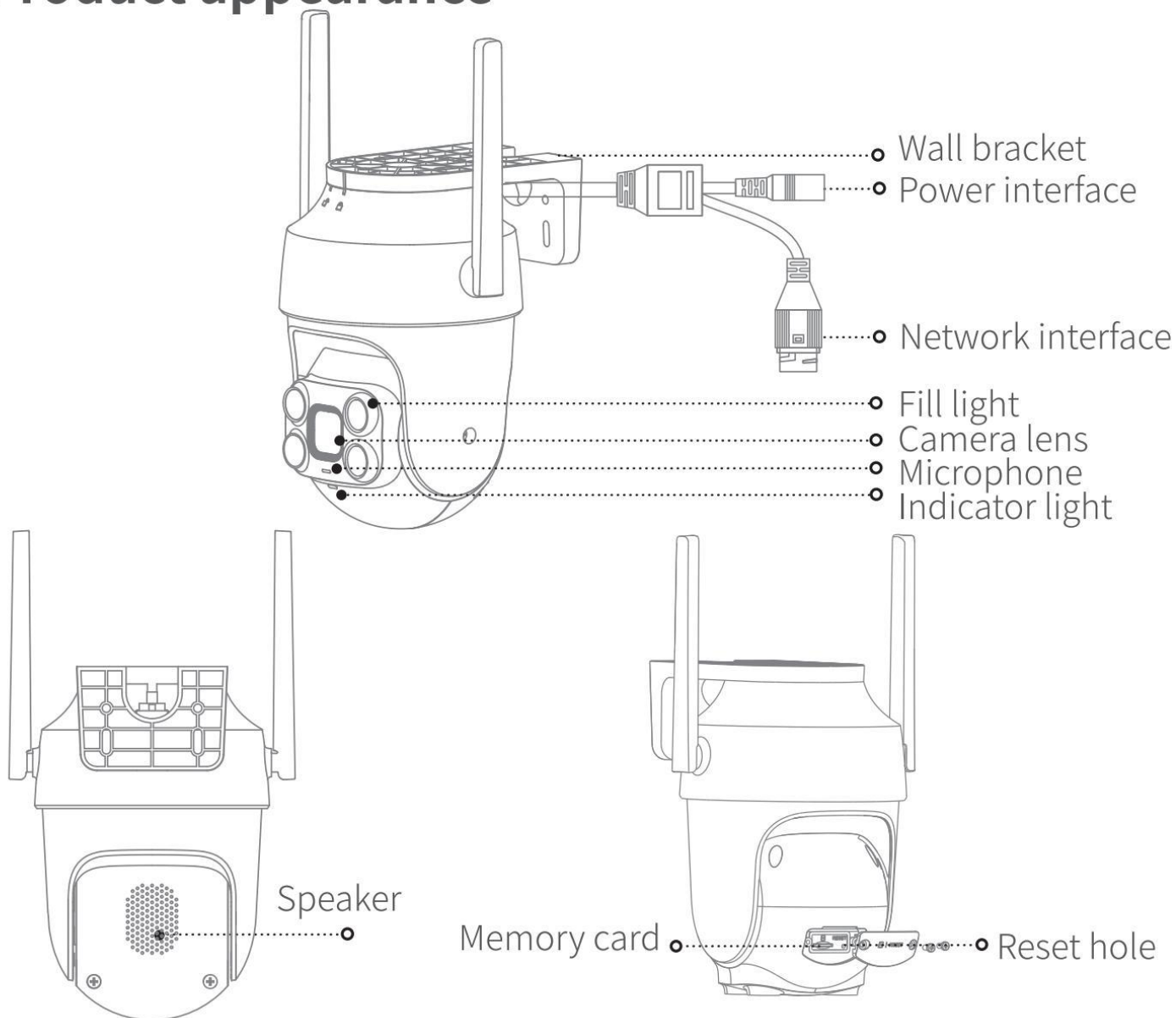

Reset hole: When the camera is powered on, press the reset hole with the eject pin for 5 seconds, and the "Di" sound indicates a successful reset.

Memory card: Maximum storage of 256 GB.

Network configuration instructions

Download and install the APP

Method I : Scan the QR code below with your mobile phone to download and install the **Botslab** APP.

Method II : Search and download the **Botslab** APP from App Store or Google Play, and then install it.



Scan to download **Botslab**
APP

Connect to a power

1. Connect the camera to the power adapter. After the camera is turned on, the status indicator light is "flashing green", indicating that the device enters the network setup state and awaits being added.

i Note: If the status indicator light is not flashing green, please reset the device now. Please use the original power adapter that comes with the camera.

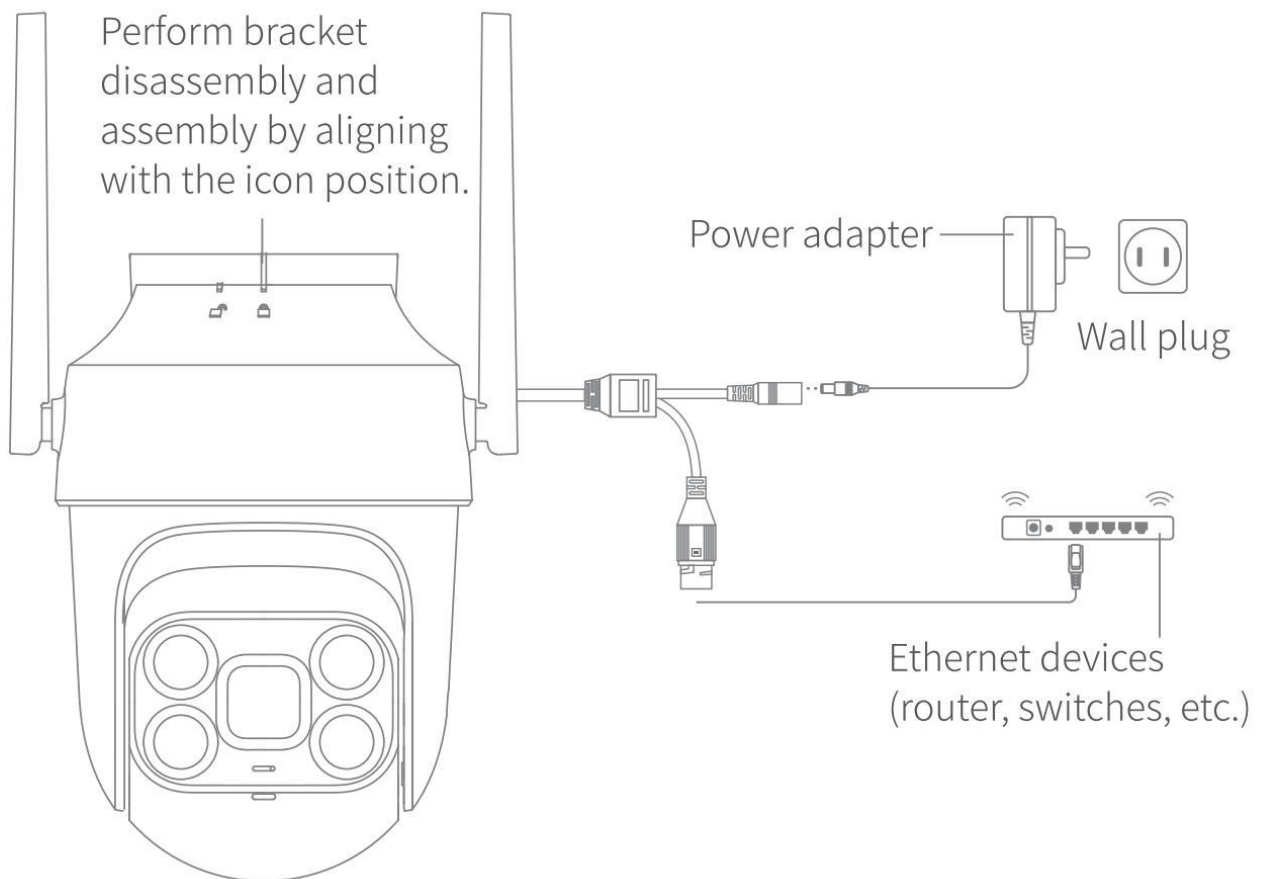

Add camera

Launch the Botslab APP, tap the "Sign up" button, and start creating your account. If you already have an account, please log in directly and add a camera.

Method I : Tap the "+" button in the upper right corner of the APP homepage to "Add Device", tap the "Camera" button, tap and select the "Outdoor Pan/Tilt Camera Pro W312" icon to enter the distribution page, and add the camera as instructed.

Method II : Tap the "+" button in the upper right corner of the APP homepage to "Scan" the code, then use your mobile phone to scan the QR code at the bottom of the camera to enter the distribution page, and add the camera as instructed.

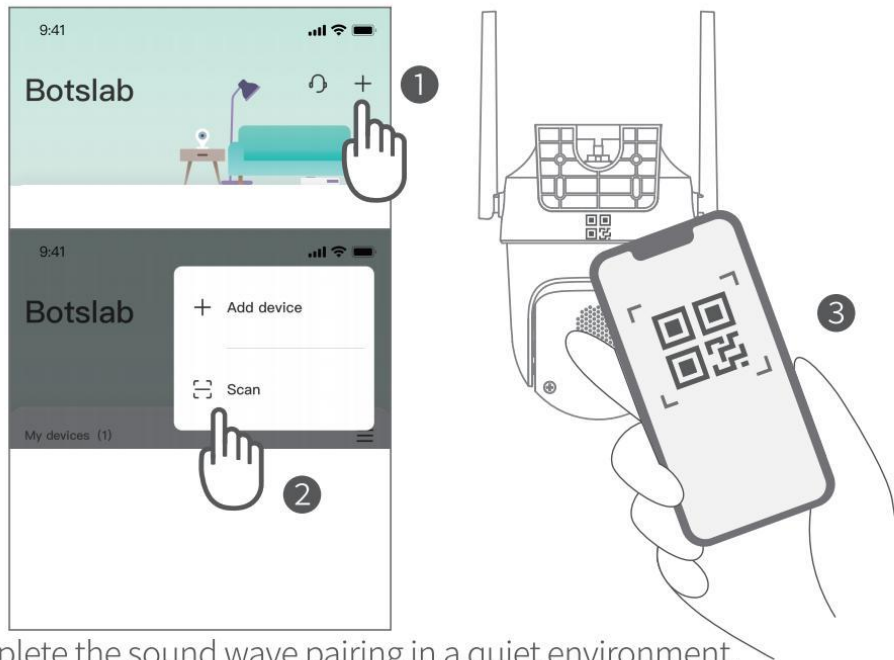

notice:

- Complete the sound wave pairing in a quiet environment.
- Support network cable connection.
- When using WiFi connection, please ensure that the camera is connected to a Wi-Fi network in the 2.4GHz/5GHz frequency band.

Installation guide

Insert a Micro SD card (optional).

Open the waterproof card cover with a screwdriver, insert the Micro SD card, and log in to the Botslab app for initialization before using it.

Wall-mounted Installation

- The camera supports both ceiling and wall-mounted installation. After selecting an appropriate installation method and location, securely affix the installation sticker. Drill holes and install the expansion pipe, then fasten the wall bracket with screws.
- Align the card slot and push the camera upward into the fixed bracket, rotating it until it aligns with the wall bracket positioning marks.

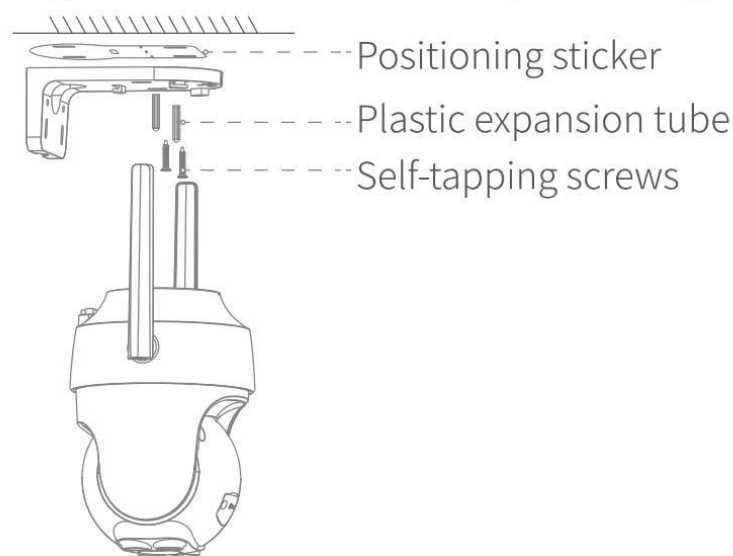

Precautions:

- Please ensure that the camera has been successfully added before proceeding with the wall installation.
- The wall surface where the camera is installed must be able to support at least three times the combined weight of the camera and wall bracket.

Install waterproof kit (optional)

- ① Before installation, inspect the waterproof kit items and place the waterproof rubber ring on the camera's network interface.

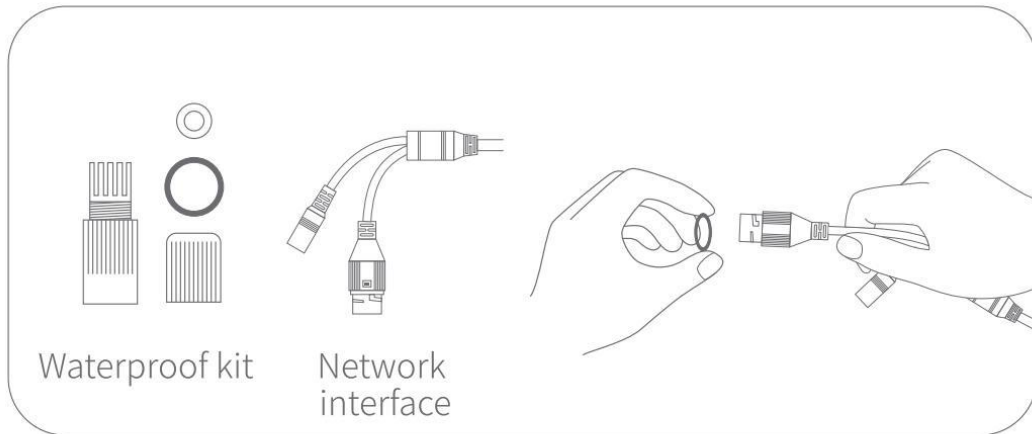

- ② Thread the waterproof kit through the network cable one by one, and connect the network cable to the network interface.

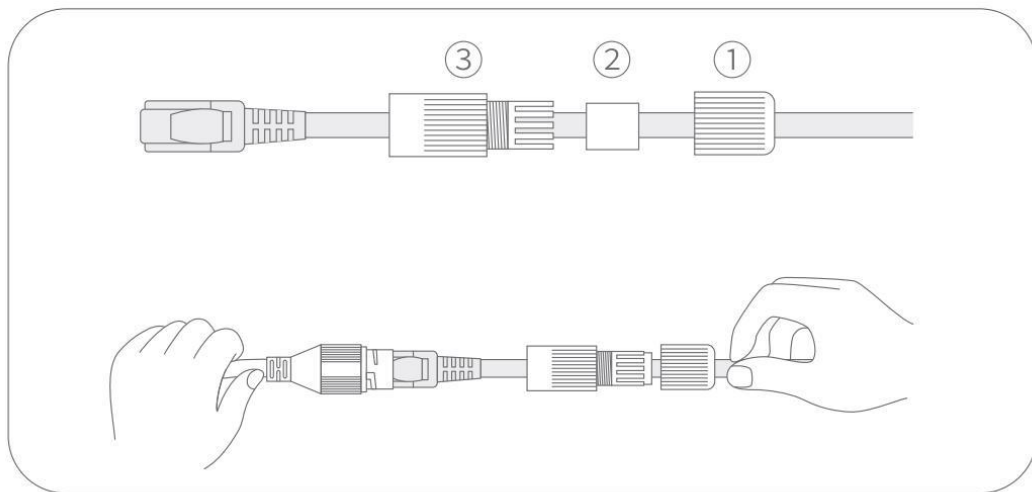

- ③ Tighten the waterproof kit at the camera's network interface first, and then screw the locking bolt.

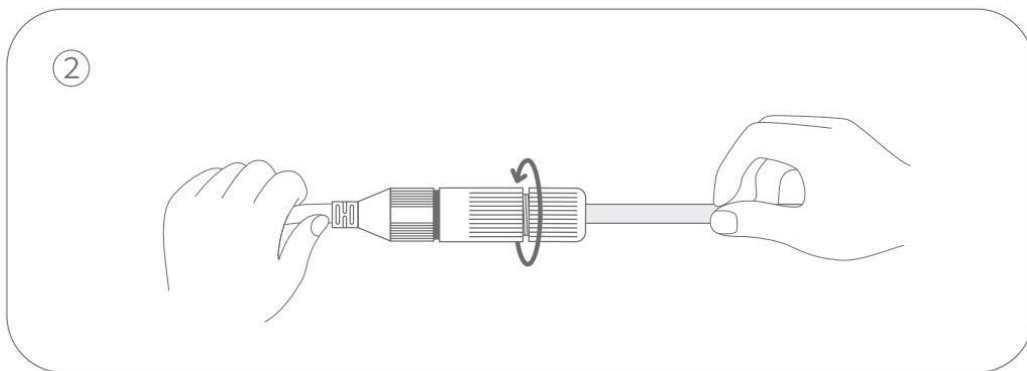
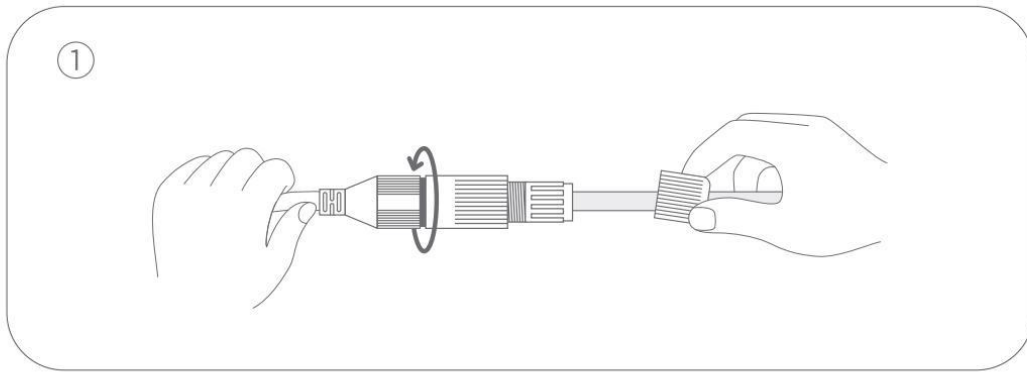

After the installation is completed, connect the camera to power source again. After startup, the camera will automatically connect to the pre-configured network.

Precautions:

- The camera's waterproof kit can effectively prevent rainwater from seeping into the network interface. Failure to install it properly may result in equipment damage, which is not covered by the after-sales warranty service.

Notes

1. For better night vision imaging, do not use the camera with the front or sides of the lens near reflective materials such as glass and white walls; otherwise, the images of things nearby will be rendered bright while those far away dark or even white.
2. Try to place the device in a place with good network signal reception. The distance between the device and metal objects (e.g., metal supports, metal doors, and windows) or other signal interference sources should not be too close.
3. Do not place the device near the heat source, e.g., electric heater, oven, or stove fire.
4. The applicable working temperature of this product is -20°C – $+60^{\circ}\text{C}$. Please do not use it in an environment where the temperature is too high or too low.
5. Please do not use this product in an environment that is excessively humid and may cause water ingress.

Operating mode description

Status indicator light	
Constant blue	Camera connected
Flashing blue	Someone viewing video
Constant green	Camera turned on/failure
Flashing green	Waiting for network configuration/Camera offline

i The manufacturer reserves the right to adjust the functional status of the product through firmware upgrades or software adjustments.

IMPORTANT

Personal information security

For the safety of you and your family, please make sure that the products you purchase are not bound to any unauthorized person. Botslab will take strict measures to protect the information security of you and your family.

Description of Hazardous material Contents

Component	Toxic and Harmful Substances and Elementst					
	Lead (Pb)	Mercur (Hg)	Cadmium (Cd)	Hexavalent Chromium (Cr (VI))	Polybrominsted Biphenyl (PBB)	Polybrominsted DiphenylEthers (PBDE)
Plastic enclosure	○	○	○	○	○	○
Circuit board components	×	○	○	○	○	○
Power cable	×	○	○	○	○	○
Adapter	×	○	○	○	○	○
Lens	○	○	○	○	○	○

This form is prepared in accordance with SJ/T11364.

○ : Indicates that for each item in this produce ,said hazardous substance id below the requirements set forth by the standard GB/T26572.

× : hazardous substance in at least one homogeneous material of this part exceeds the limit specified in GB/T26572. However, it satisfies limit requirements specified in the List of Exempt Applications of Hazardous Substances Identified in the Management Catalog.



Note:

A small patch of electronic components for special purposes is marked with "X" in the table (such as high voltage resistors, ceramic resistors, diodes), in which the lead content may exceed 0.1% . As the screws and the core in the data cables using alloy with better performance, the lead content may also be exceed 0.1%. These components are in accordance with the requirements of the exemption clause of the EU RoHs directive. Limited by the current global technology development, there are no other alternative technologies and components. The external lead contents of these components are in accordance with enviornmental protection requirements.

Declaration of Conformity

Hereby, Botslab,Inc. declares that the radio equipment type W312 of Botslab Outdoor Pan/Tilt Camera Pro is compliance with Directive 2014/53/EU and this product is allowed to be used in all EU member states. The full text of the EU declaration of conformity is available at the following internet address: www.botslab.com

Operation frequency (Max power)

2412 MHz to 2472 MHz: 15.57dBm

5180MHz to 5320 MHz: 13.65dBm

5500 MHz to 5700 MHz: 15.23dBm

5745MHz to 5825 MHz: 12.64dBm

RF exposure statement

RF exposure information: The Maximum Permissible Exposure (MPE) level has been calculated based on a distance of $d=20$ cm between the device and the human body. To maintain compliance with RF exposure requirement, use product that maintain a 20cm distance between the device and human body.

The device is restricted to indoor use when operated in the European Community using frequency 5150MHz-5250MHz to reduce the potential for interference.

Restriction in BE, BG, CZ, DK, DE, EE, IE, EL, ES, FR, HR, IT, CY, LV, LT, LU, HU, MT, NL, AT, PL, PT, RO, SI, SK, FI, SE, UK(NI).

UK Declaration of conformity

Hereby, Botslab,Inc declares that the product is in compliance with the essential requirements and other relevant provisions of Radio Equipment Regulations 2017(SI 2017 No.1206). You can find the Declaration of Conformity on www.botslab.com.

The device is restricted to indoor use when operated in the European Community using frequency 5150MHz-5250MHz to reduce the potential for interference.

The device complies with RF specifications when the device used at least 20cm

from your body.

RF Operating frequency(Max Power):

2412 MHz to 2472 MHz: 15.57dBm

5180MHz to 5320 MHz: 13.65dBm

5500 MHz to 5700 MHz: 15.23dBm

5745MHz to 5825 MHz: 12.64dBm

The operating temperature of the product is:-20 °C -+60 °C



FCC Statement

This device complies with Part 15 of the FCC Rules. Operation is subject to the following two conditions: (1) This device may not cause harmful interference, and (2) this device must accept any interference received, including interference that may cause undesired operation.

Warning: Changes or modifications not expressly approved by the party responsible for compliance could void the user's authority to operate the equipment.

Note: This equipment has been tested and found to comply with the limits for a Class B digital device, pursuant to Part 15 of the FCC Rules. These limits are designed to provide reasonable protection against harmful interference in a residential installation.

This equipment generates, uses, and can radiate radio frequency energy and, if not installed and used in accordance with the instructions, may cause harmful interference to radio communications. However, there is no guarantee that interference will not occur in a particular installation. If this equipment does cause harmful interference to radio or television reception, which can be determined by turning the equipment off and on, the user is encouraged to try to correct the interference by one or more of the following measures: (1) Reorient or relocate the receiving antenna. (2) Increase the separation between the equipment and receiver. (3) Connect the equipment into an outlet on a circuit different from that to which the receiver is connected. (4) Consult the dealer or an experienced radio / TV technician for help.

This equipment must be installed and operated in accordance with provided instructions and the antenna(s) used for this transmitter must be installed to provide a separation distance of at least 20cm from all persons and must not be collocated or operating in conjunction with any other antenna or transmitter.

After-Sales Service

1.Warranty policy

- This product comes with a One-year Local Warranty Service. For detail of warranty service, please kindly contact local Authorized Distributors in your country.

2.Non warranty policy

- Cannot present valid warranty certificate and purchase invoice.
- Damage caused by use, maintainance, or keeping of the product not in accordance with product description, damage caused by disassembly and repair unauthorized by Botslab, or artificial damage.
- Damages which result of force majeure.
- Normal decoloration and wastage during usage will not be included into warranty service.