

COVER PAGE**State Project No: U-12-LY-0564m****Project Name:** TARA Transmitter Station, Millard County, Utah**Report Date:** July 2012**Principal Investigator:** Joshua Trammell**Field Supervisor:** Joshua Trammell**Record search completed at what office(s)?** Utah SHPO**Record search date(s):** June 27, 2012**Area Surveyed – Intensive:** 100 square meters (25 acres) **Recon/Intuitive:** 0 acres**7.5' Series UGS Map Reference(s):** USGS 7.5' Quadrangle Hinckley, UT 1983

<u>Sites Reported</u>	<u>Count/Smithsonian Site</u>
<u>Numbers</u>	
Archaeological Sites	<u>0</u>
Revisits (no inventory update)	<u>0</u>
Updates (updated IMACS site inventory form attached)	<u>0</u>
New Recordings (IMACS site inventory form attached)	<u>0</u>
Total Count of Archaeological Sites	<u>0</u>
Historic Structures (USHS 106 site info form attached)	<u>0</u>
Total National Register Eligible Sites	<u>0</u>

-
1. X 1 Copy of the Final Report.
 2. X Copy of 7.5' Series USGS map with Survey/Excavated Area Clearly Identified.
 3. X Completed "Cover Page" Accompanying Final Report and Survey Materials
 4. X STLA Archaeological Field Work Authorization Form

CULTURAL RESOURCES INVENTORY SUMMARY

1. **Utah State Antiquities Section Project Number:** U-12-LY-0564m
2. **Report Date:** July, 2012
3. **Project Name / Description:** Class III Cultural Resource Inventory for the TARA Transmitter Station, Millard County Utah
4. **Form Prepared by:** Joshua Trammell
5. **Inventory completed by:** Joshua Trammell
6. **Project Inventory Description:** The 25 acre project area was intensively surveyed by walking parallel 15 meter pedestrian transects. No cultural resources were observed.

Acres <u>newly</u> inventoried for this project	25
Survey Interval of inventory	15m
Average Ground Visibility	75%
USGS 7.5 min Quad Map Reference	Hinckley
Legal Description of inventory	17 S 8 W NW ¼ of SE ¼ , SW ¼ of NE ¼, NE ¼ of SW ¼ , SE ¼ of NW ¼ Section 31

7. **Literature Review (review of sites and projects within two miles of project area).**

Date of Literature review	June, 2012
Previously recorded eligible sites within two miles of project area	1
Previously recorded Ineligible sites within two miles of project area	3
Previous inventory projects within two miles of project area	2

8. **Results of project inventory:**

NRHP Eligible sites recorded	0
NRHP Ineligible sites recorded	0
# of prehistoric isolates recorded	0
# of historic isolates recorded	0

CULTURAL RESOURCES INVENTORY SUMMARY (cont.)

12. Conclusions: A total of 25 acres were inventoried for the current project. The project was intensely surveyed by walking parallel transects spaced no more than 15 meters apart. Sites are defined as features associated with artifacts or an accumulation of 10 or more objects (more than 50 years old) within a 10 meter diameter area. Anything less substantial than a site that is at least 50 years old is classified an isolated artifact. Neither isolated artifacts nor archaeological sites were observed. .

Recommendations: Implement project as proposed. No historic property was found within the APE, therefore, in accordance with 36 CFR §800.4(d)(1), **no historic properties will be affected** by actions within the inventoried areas.

13. Attachments: Attachment A-Copy of 7.5' Series USGS map with Survey/Excavated Area Clearly Identified (Figure 1); Attachment B- STLA Archaeological Field Work Authorization Form.



Toyapi Archaeological Consulting, LLC

**Class III Cultural Resource Inventory for the TARA Transmitter Station,
Millard County, Utah**

Prepared For:
John Belz,
University of Utah, Department of Physics

Submitted To:
Utah SHPO

Utah SHPO Project No. U-12-LY-0564m

July, 2012

By:
Joshua Trammell, Principal Investigator
Toyapi Archaeological Consulting, LLC
SLC, UT 84102

TABLE OF CONTENTS

Introduction.....	1
Project Area	1
Class I Inventory	1
Class III Inventory	1
Field Methods	1
Class III Inventory Results.....	2
Recommendations.....	2

Attachment A: 7.5' UGS Map of Surveyed Area (Figure 1)

Attachment B: STLA Archaeological Field Authorization Form

Attachment C (electronic file): GIS Data of Surveyed Area

Introduction

In June 2012, Toyapi Archaeological Consulting, LLC conducted a Class III cultural resource inventory for the Telescope Array (TARA) Transmitter Station, Millard County, Utah (Figure 1). The inventory was conducted for the University of Utah, Department of Physics (technical point of contact-John Belz). The Class III inventory was completed to identify and evaluate cultural resources in the project area (Utah State Historic Preservation Office Project Number **U-LY-0564m**).

Project Area

The project area is located west of Delta, a short distance northwest of Highway 6 in the town of Hinckley. The survey parcel is located on land administered by State of Utah School and Institutional Trust Land Administration (STLA). The STLA parcel consists of ~655.5 square meters (~162 acres) of land surrounded on all sides by private property currently under cultivation. The area surveyed is a ~100 square meter (~25 acres) parcel centered on the proposed location of TARA Transmitter Station, located at the southern end of the STLA land holding (see Figure 1). The area affected by the proposed transmitter station is relatively small, measuring ~85 square meters.

Much of the project area has been affected by modern disturbances, namely agriculture, roads, and use as a disposal site for modern and historic trash. The STLA parcel is currently covered by a dense stand of greasewood, creating an island of native vegetation surrounded by cultivated fields. Although currently covered with greasewood, it is more than likely over the last 150 years-or-so the STLA land was also (at least intermittently) under cultivation as well.

Class I Inventory

Inventory Results

Class I literature review was conducted at the State Historic Preservation Office (SHPO) by Marty Thomas and Arie Leflang (SHPO), June 2012. The record search indicates a total of two cultural resource surveys projects (**U-00-SY-0537**, and **U-11-BC-0493**), and four previously recorded archaeological sites (**42MD1669**, **42MD1689**, **42MD1764**, and **42MD3565**) are located within 3.2 km (2 miles) of the project area (Table 1). Of the previously recorded sites, all four are historic archaeological sites. Site 42MD1669 consists of eleven segments of a historic irrigation system running along the north side of Highway 6. Similarly, Site 42MD3565 is a segment of a historic canal, located ~1.2 kilometers northeast of survey parcel. Site 42MD1689 is a segment of the Centennial Highway, Highway 27, and Old Highway 6, located ~1.5 kilometers southwest of survey parcel. Site 42MD1764 is a relatively large multi-component site located ~1.5 kilometers south of survey parcel. Site 42MD1764 has been determined eligible for inclusion on the National Registry of Historic Places (NRHP); the remaining three sites are determined not eligible for inclusion on the NRHP.

Class III Inventory

Field Methods

The parcel was surveyed by a team of three archaeologists using 15 meter interval pedestrian transects. When cultural debris was encountered, the area in the immediate vicinity of artifact(s) was thoroughly searched. Cultural resources were evaluated in compliance with the National Historic Preservation Act, the Archaeological Resources Protection Act (36 CFR 60.4).

Class III Inventory Results

Inventory did not identify significant cultural resource. Although the survey parcel and much of the STLA parcel contains substantial quantities of historic trash, these artifacts were observed near and within refuse piles also containing considerable quantities of modern trash. It appears the area has been used over the decades as a trash dump. The historic artifacts do not appear to be in primary or even secondary depositional context, and therefore are considered to have very limited informational potential.

Recommendations

No historic properties were observed within the project area. No historic properties will be affected by proposed actions within the inventoried area, therefore, in accordance with 36 CFR §800.4(d)(1), it is recommended to implement the project as proposed.

TARA Transmitter Survey U-12-LY-0507

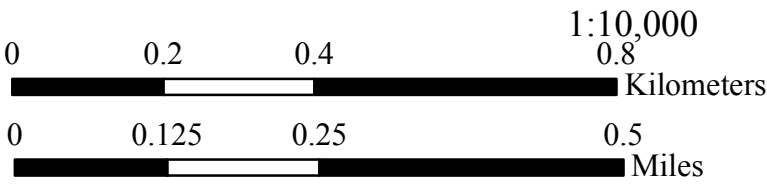
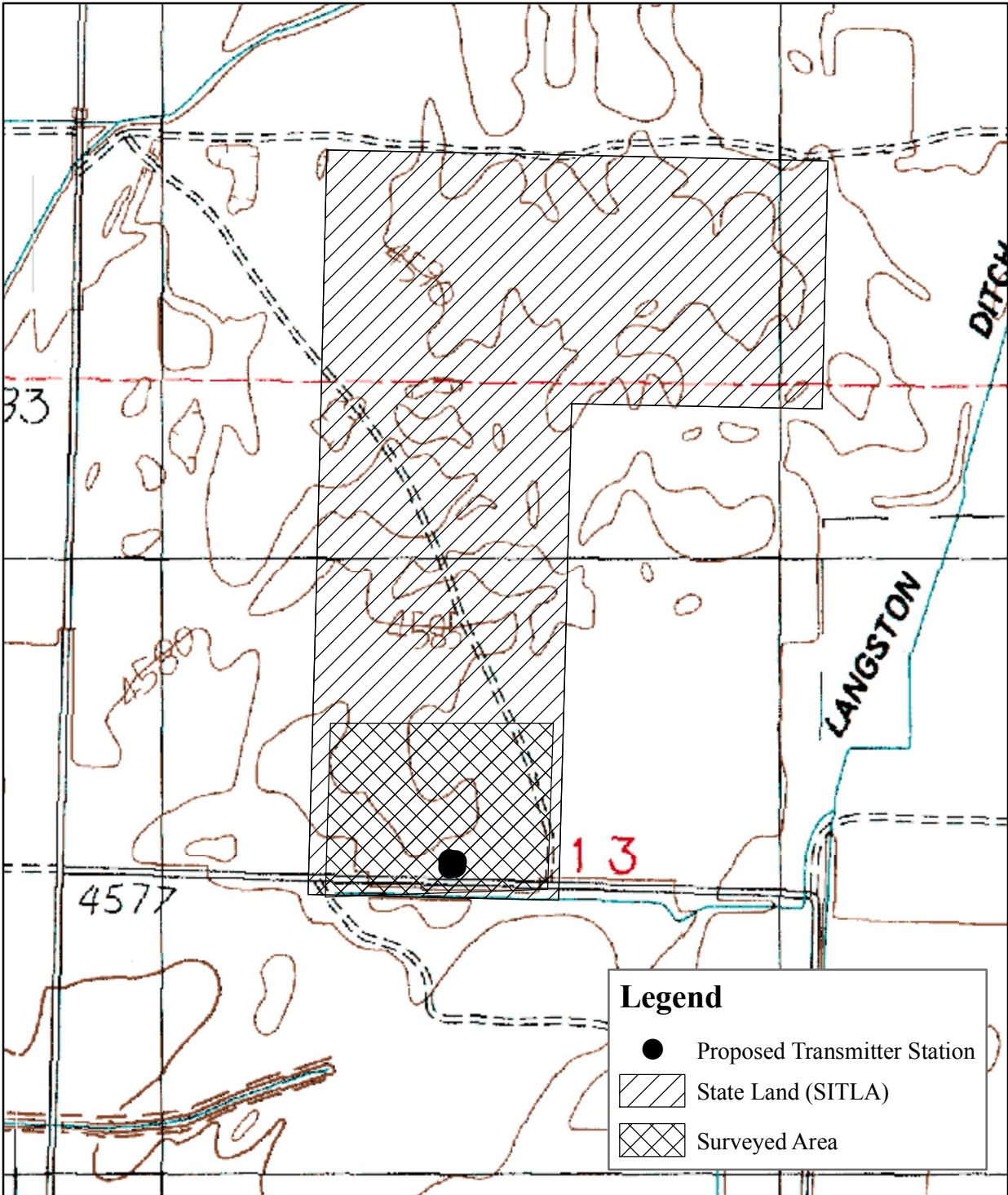

Cartographer: Isaac A. Hart, Toyapi Archaeological Consulting; Data: Toyapi Archaeological Consulting; Projection: UTM Zone 12N NAD 1983; Reference Map: USGS 7.5 Minute Series Hinckley Quadrangle

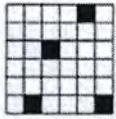

**State of Utah
School and Institutional
Trust Lands Administration**

675 East 500 South #500
Salt Lake City, UT 84102-2818
Telephone No. (801)538-5100
Web site: trustlands.utah.gov

ARCHAEOLOGICAL FIELD WORK AUTHORIZATION REQUEST

1a. Name of Applicant Organization or Firm Toyapi Archaeological Consulting, LLC
 1b. Antiquities Section Project Number U-12-AF-0507
 1c. Project Name TARA Transmitter Station

2. Applicant's Mailing Address 2004 S. 800 E.
 City Salt Lake City State Utah Zip 84105
 Telephone Number 801-641-9269 Fax Number _____
 E-Mail Address toyapiarchaeology@gmail.com

3. Nature of Cultural Resource Work Being Proposed*
 Class III Inventory in Support of TARA Transmitter Station (SULA Application 1740). Work requested by John Belz, Research Assistant, Univ. of Utah Dept. of Physics. Area to be surveyed is ~300x300 m.

*If work is U.C.A. § 9-8-404 or Section 106 compliance-related, identify client and project in as much detail as possible

4. Location of Proposed Work**
 Millard County, Utah. Location: T17s R8w SE 1/4, NW 1/4 of Section 13 (see attached map).

**A map or GIS file indicating Trust Lands to be surveyed is required

5. Proposed Work Will Be Conducted From: 07/01/2012 To: 08/01/2012

6. Responsible Principal Investigator: Joshua B. Trammell PLPCO Permit #: 242

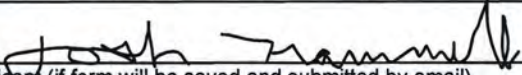
7a. Signature of Applicant***  7b. Date Joshua B. Trammell
 ***Signature or Typed Name of Applicant (if form will be saved and submitted by email)

Special Conditions:
 - Applicant shall immediately notify SITLA of any change in items 2 through 6.

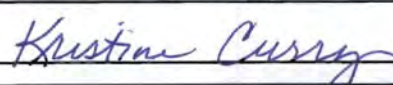
Field Work Authorization Request Approved by:  Date: 6/26/12