

# MPA-1618

## GLOBALSTAR Simplex Patch Antenna

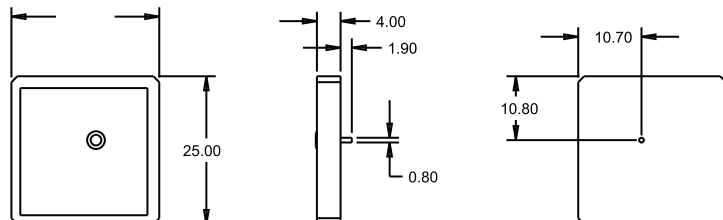

Image does not reflect the actual size of the antenna

### Description

This is a high-performance, very low profile antenna designed for embedded applications that use the Globalstar Simplex system. The antenna is ideal for both PDAs and tracking devices. The embedded antenna's extreme compact size and lightweight make it perfect for various commercial and industrial applications. With a typical efficiency of 60% and peak gain of 3.5 dBic this antenna can operate inside the most extreme and demanding applications providing maximum satellite reception and great performance. This Globalstar Simplex antenna product is one of a kind on the market. The interface connector is a through pin solution.

### Mechanical Specifications



dimensions are in mm

### Electrical Specifications

76X76 mm ground plane

Parameter	Design Specifications
Frequency	1618 MHz
Polarization	LHCP
Efficiency	80%
Realized gain	5 dBic
Axial ratio	2.5 dB (typical) / 5 dB (max)
Bandwidth (-1dB)	20 MHz
Beamwidth (3dB)	100° (both axes)
CP rejection	17 dB (typical) / 11 dB (min)
VSWR	1.3:1
Impedance	50 Ohm
Operating temp.	from -40°C to 85°C

### Features

- Globalstar Simplex
- Adhesive mounting
- Pin connector
- Compact size
- Custom tuning

### Applications

- Vehicle & Fleet Tracking
- Embedded applications
- Handheld devices
- Military & Security
- Asset tracking
- PDAs/Laptops
- Oil & Gas industries
- Navigation devices
- Law Enforcement
- LBS & M2M Applications

### Realized gain plot

Measured at 1618 MHz on a 76X76 mm ground plane

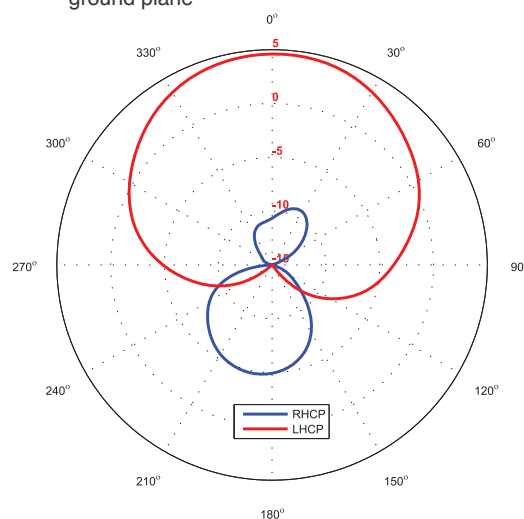

Maxtena Inc.  
7361 Calhoun Place, Suite 102  
Rockville, MD 20855  
1-877-629-8362  
sales@maxtena.com

www.maxtena.com