

Northpoint Technology - DBS Compatibility Test - Austin Test Area

Rx Site Location Log

Rx Site No. 14 p1
Set: 1 /

Site Name:

Date / Time:

12 / 23 / 93 2:37pCST

ACC Pinnacle

Operator:

Dew / MWH / ME

GPS Receiver Reading at Site:

Lat: N 30 13 57.4

Time Read 2:45p CST

Lon: W 97 52 57.8

20145:00

Elev: 802'

WX: PC / 70°

Map Sketch (show street reference and local benchmark features):

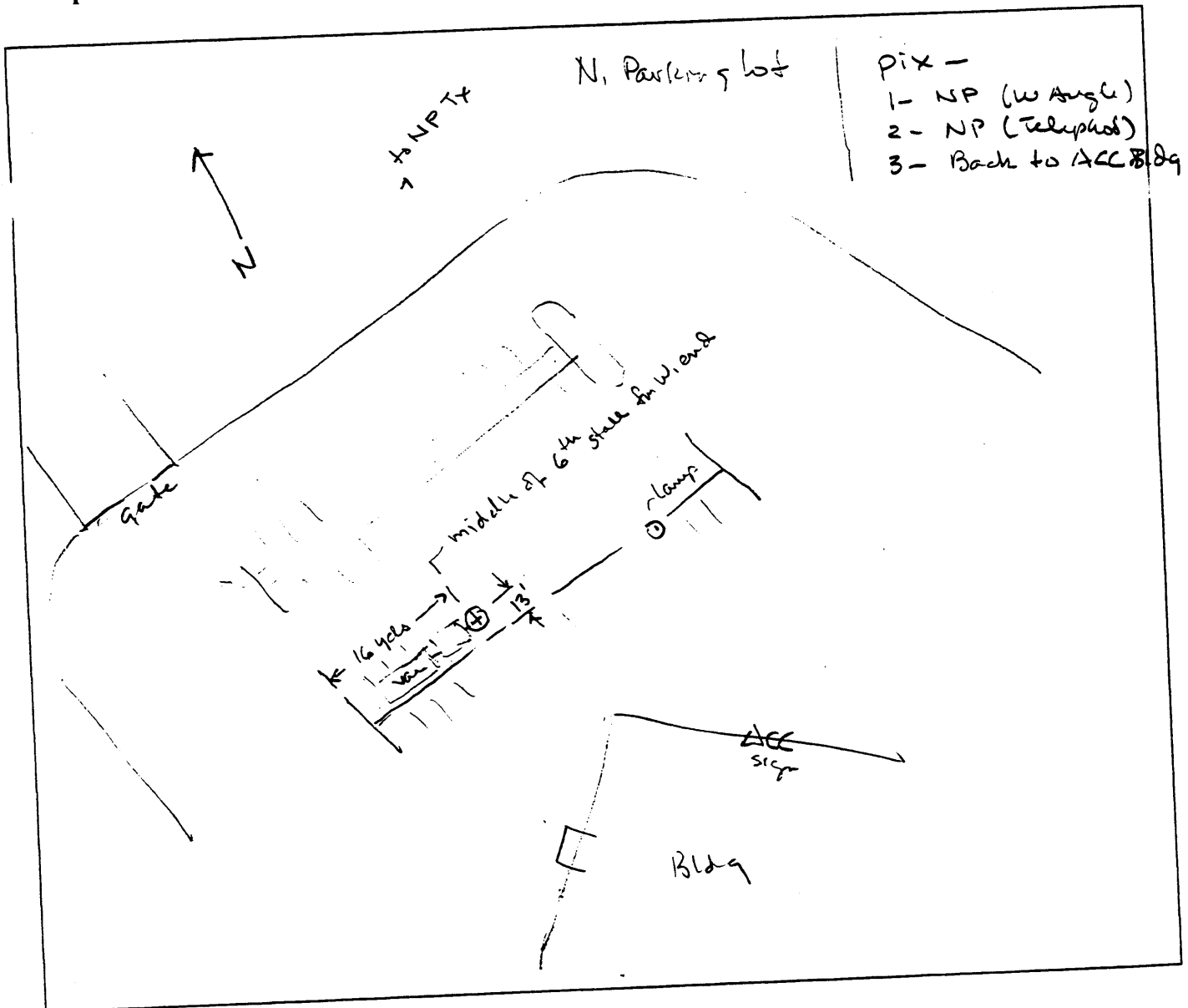

Northpoint Technology – DBS Compatibility Test – Austin Test Area

Rx Site Location Log

Rx Site No. 15 p1
Set: 1/1

Site Name:

Date / Time:

12/23/98 5:20p CST

S. I 35 (10mi)

Operator:

Jim / MWH / WE

GPS Receiver Reading at Site:

Lat: N 30 07 36.6

Time Read 5:20p CST

Lon: W 97 48 03.6

23:20:00

Elev: 717'

Map Sketch (show street reference and local benchmark features):

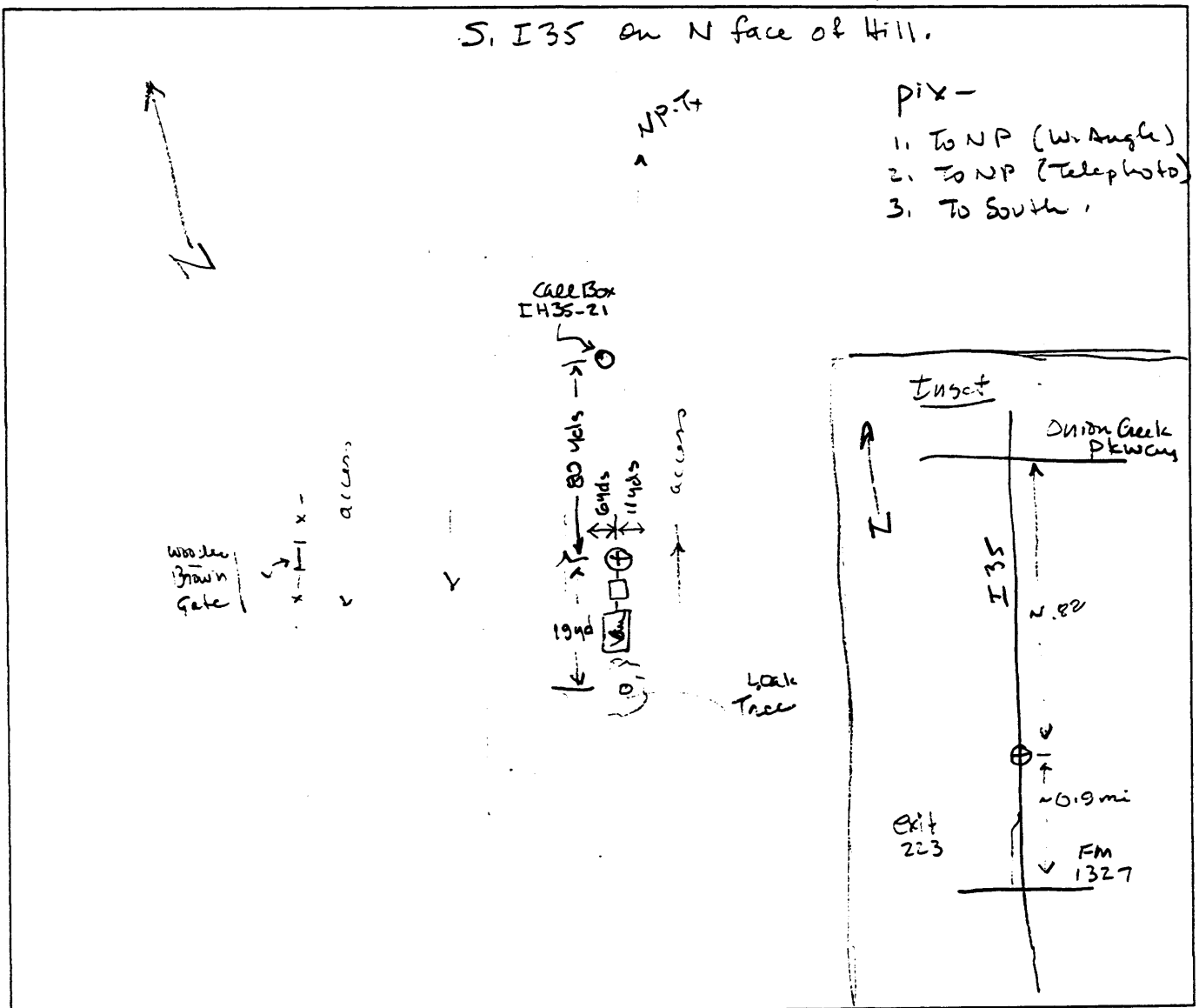

Northpoint Technology - DBS Compatibility Test - Austin Test Area

Rx Site Location Log

Rx Site No. 16 p1
Set: 11

Site Name:

Date / Time:

12/29/98 12:15 CST

Davis Ln Hill

Operator:

Dej / MH / ME / JB

GPS Receiver Reading at Site:

Lat: N 30 11 24.3

Time Read 1:14 p CST
19:14:00

Lon: W 97 49 55.0

Elev: 1067'

Map Sketch (show street reference and local benchmark features):

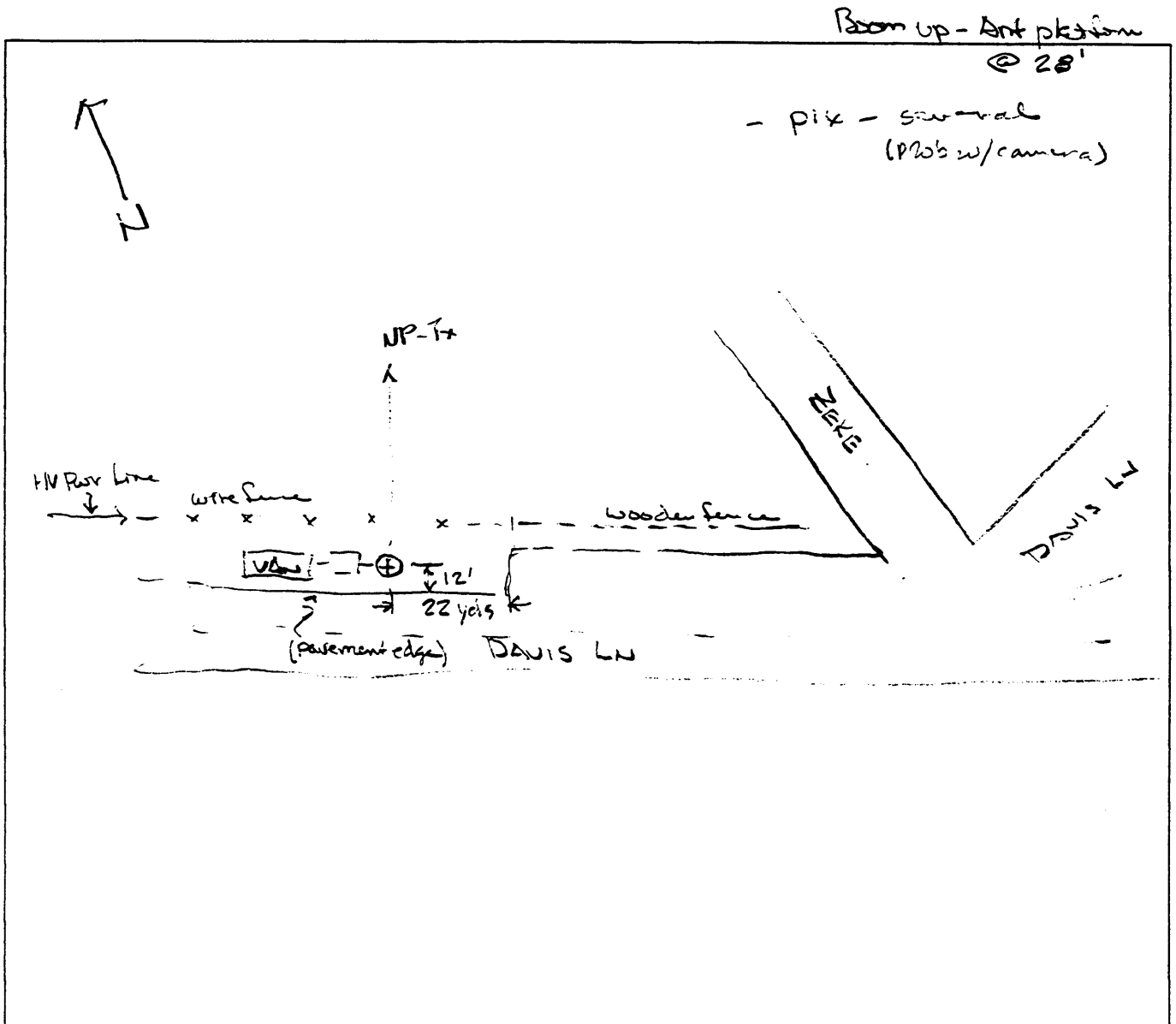

Northpoint Technology – DBS Compatibility Test – Austin Test Area

Rx Site Location Log

Rx Site No. 17 p1
 Set: 11

Site Name: _____ Date / Time: 12/29/99 3:10 CST

Thaxton Operator: Jen / MN / ME / JB

GPS Receiver Reading at Site: Lat: N 30 08 16.8
 Time Read 3:29 p CST Lon: W 97 43 54.7
21:29:00 Elev: 741'

Map Sketch (show street reference and local benchmark features):

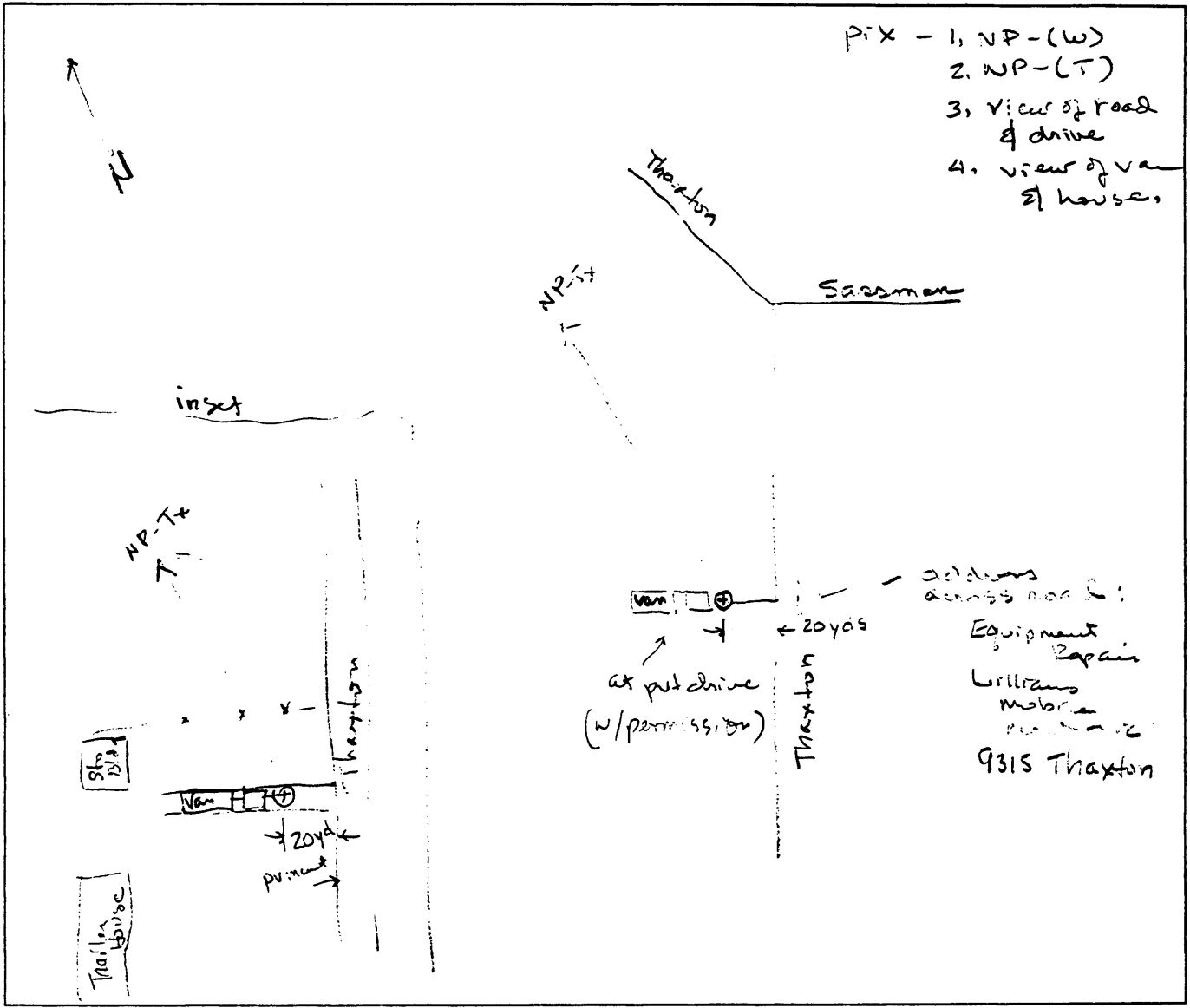

Northpoint Technology – DBS Compatibility Test – Austin Test Area

Rx Site Location Log

Rx Site No. 18 p1
Set: 1/1

Site Name:

Date / Time:

12/29/98 4:07pCST

Guerrero

Operator:

D/MH/ME/JSB

GPS Receiver Reading at Site:

Lat: N 30 06 55.7

Time Read 4:13p CST

Lon: W 97 41 53.1

22:18:00

Elev: 825'

Map Sketch (show street reference and local benchmark features):

WX: clear
~ 70°

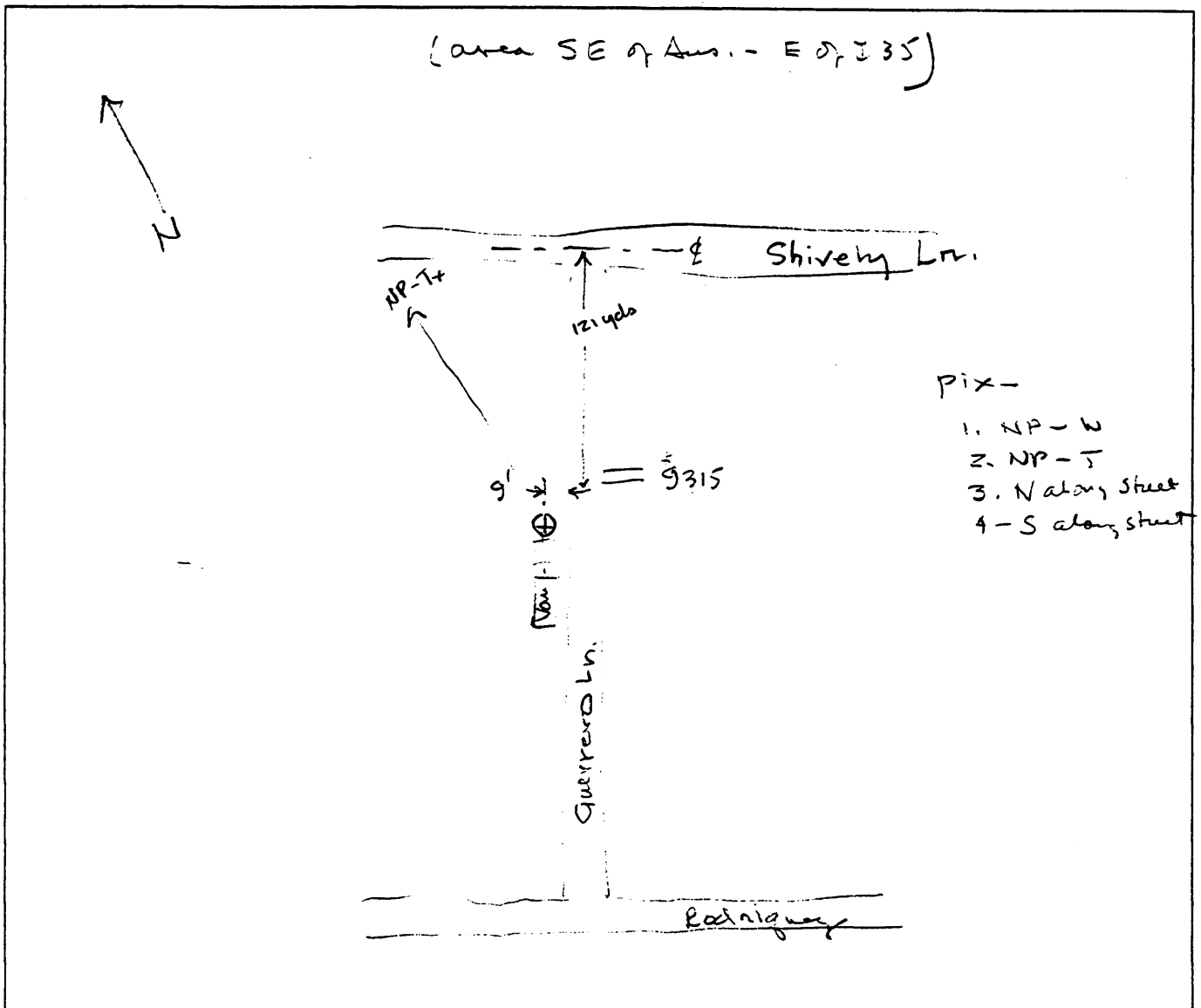

Northpoint Technology - DBS Compatibility Test - Austin Test Area

Rx Site Location Log

Rx Site No. 19 p1
Set: 11

Site Name:

Date / Time: 12/29/98 5:00 CST

Glass Rd

Operator: Jaw / JMB / MH / ME

GPS Receiver Reading at Site:

Lat: N 30 03 50.6

Time Read 5:13 p CST

Lon: W 97 42 41.6

23:13:00

Elev: 763'

Map Sketch (show street reference and local benchmark features):

wx: clear, windy
~65-70°

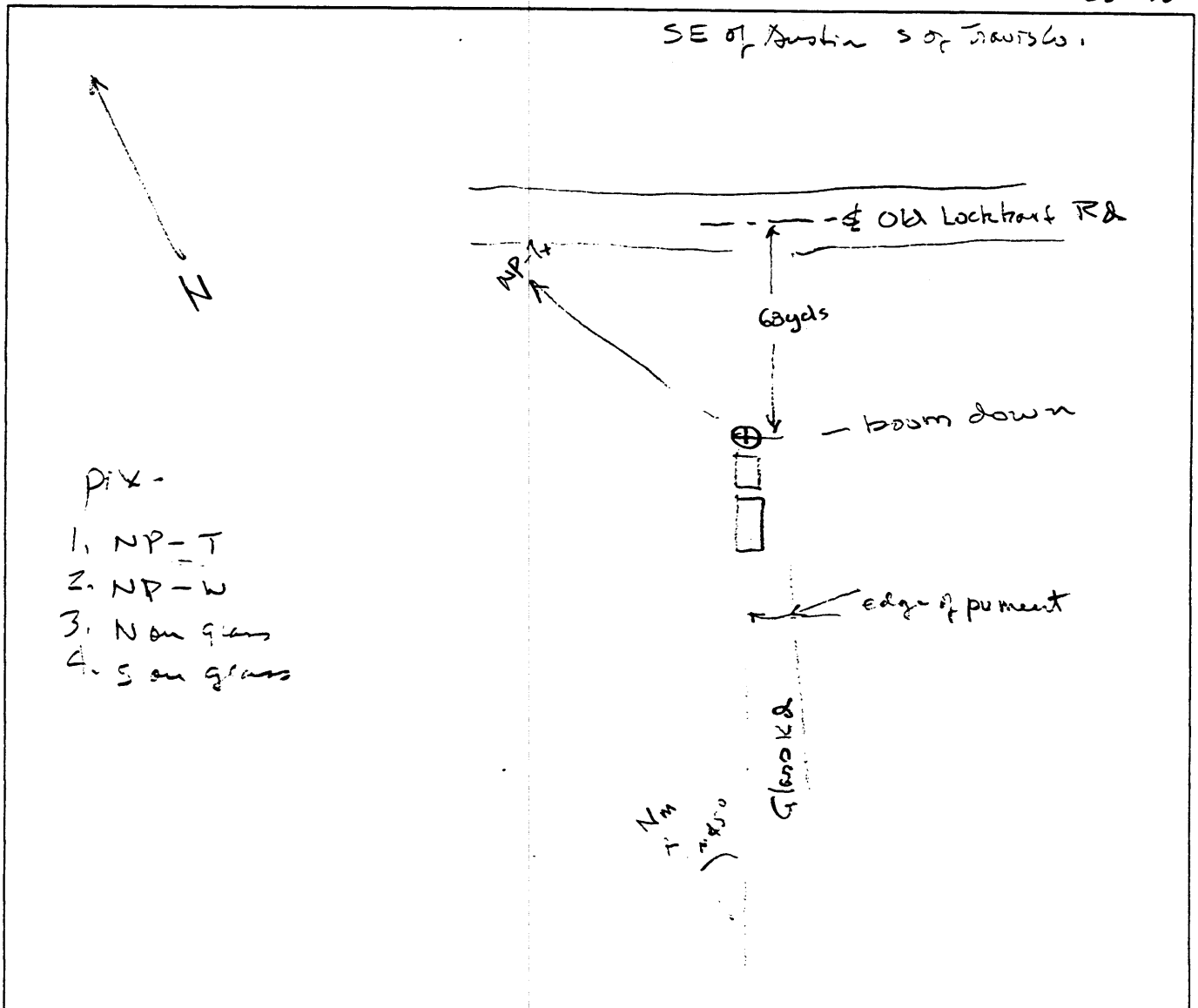

Northpoint Technology – DBS Compatibility Test – Austin Test Area

Rx Site Location Log

Rx Site No. 20 p1
Set: 11

Site Name:

Date / Time:

12/30/98 11:30p CST

Fiesta Shores

Operator:

Dun / MW / ME

GPS Receiver Reading at Site:

Lat: N 30 15 12.4

Time Read 11:43A CST

Lon: W 97 44 13.2

17:43:00

Elev: 443'

Map Sketch (show street reference and local benchmark features):

WX: clear, ~65°F

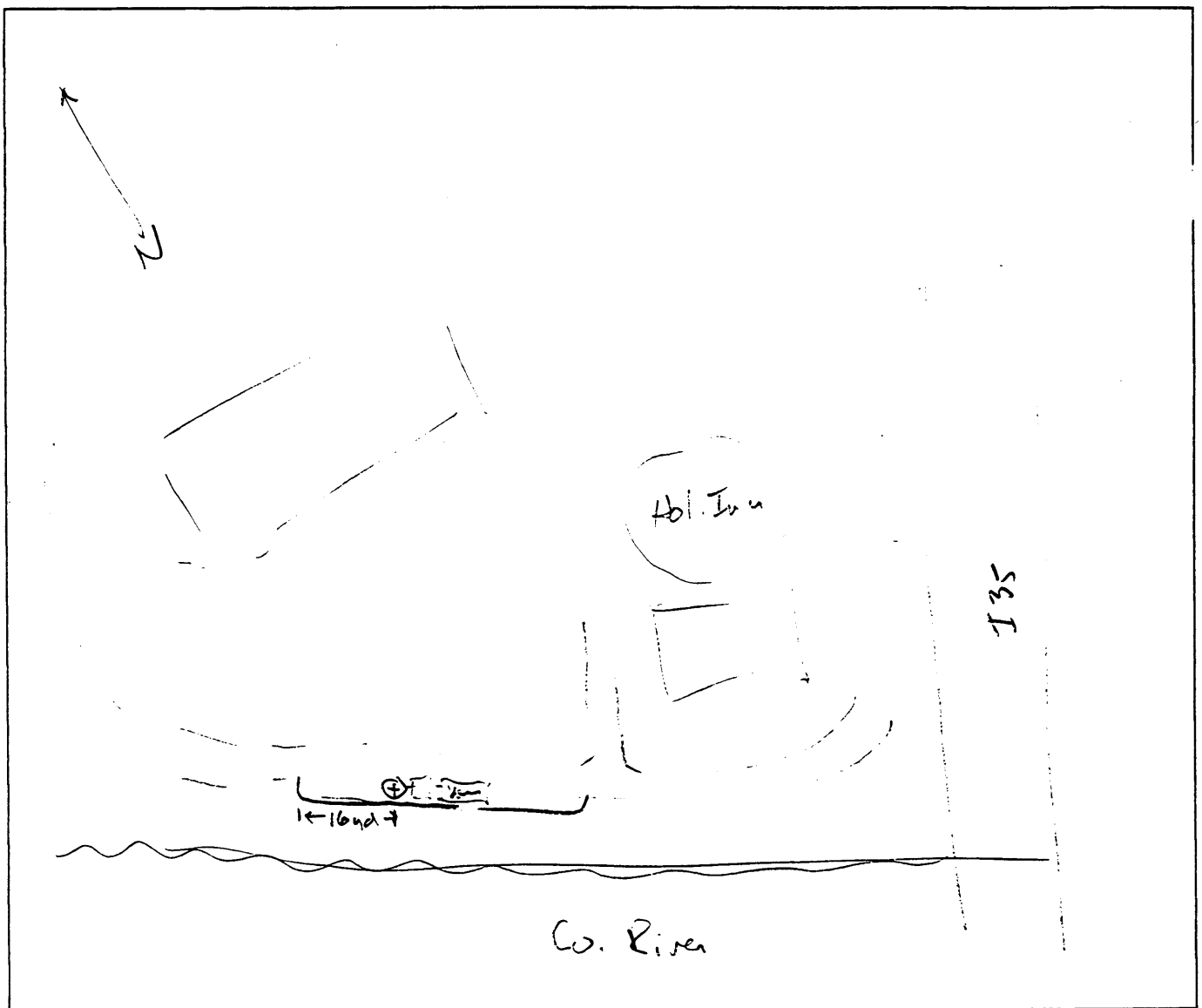

Northpoint Technology - DBS Compatibility Test - Austin Test Area

Site Location Log

Rx Site No. 21 p1
Set: 1/1

Site Name:

Date / Time: 12/30/23 2:08 CST

Summit

Operator: JM / MH / ME

GPS Receiver Reading at Site:

Lat: N 30 14 30.4

Time Read 2:14 p CST

Lon: W 97 44 07.1

20:14:00

Elev: 514'

Map Sketch (show street reference and local benchmark features):

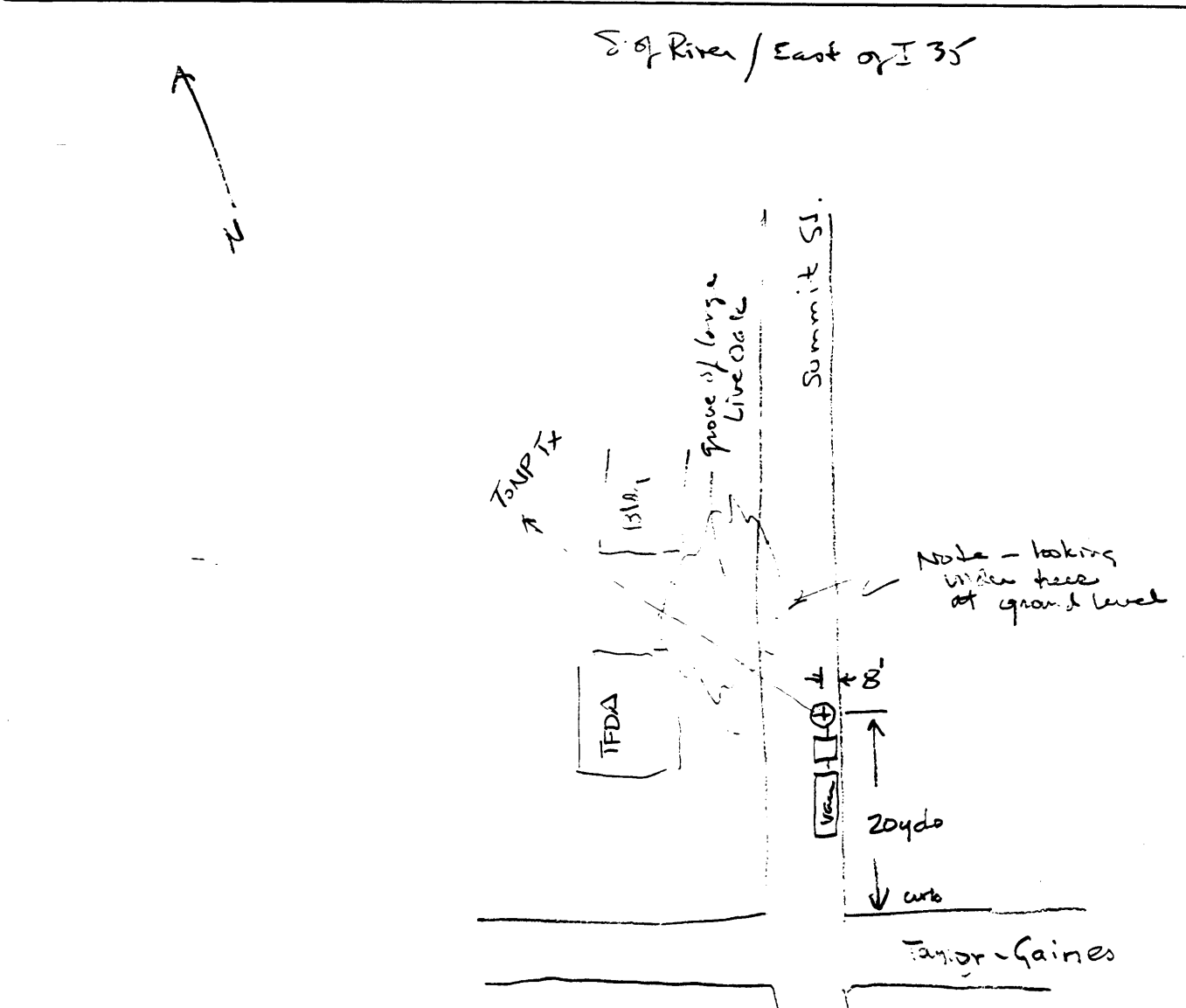

60° F

Summit
Lincoln

Northpoint Technology - DBS Compatibility Test - Austin Test Area

Rx Site Location Log

Rx Site No.

22

pl

Set:

1/

Site Name:

Date / Time:

12/30/98 3:02p CST

4th & San Antonio

Operator:

DW / MH / ME

GPS Receiver Reading at Site:

Lat: N 30 16 01.5

Time Read 3:09p CST

Lon: W 97 44 54.4

21:09:50

Elev: 473

Map Sketch (show street reference and local benchmark features):

WX: Partly cloudy
(thin clouds) ~ 60°F
light breeze

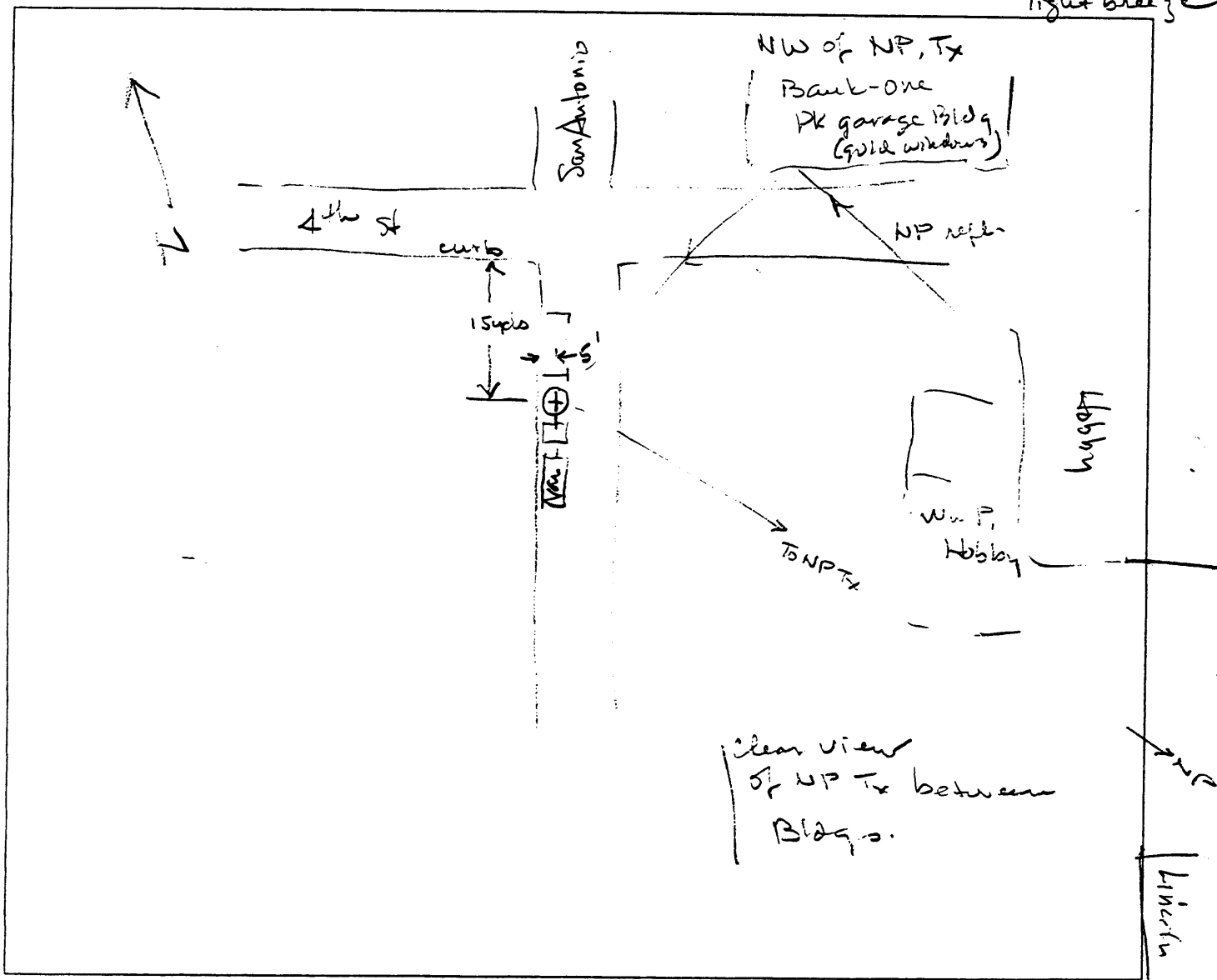

Northpoint Technology – DBS Compatibility Test – Austin Test Area

Rx Site Location Log

Rx Site No.

23

pl

Set:

1 / 1

Site Name:

Date / Time:

12/30/98 3:48p CST

7th & Guadalupe

Operator:

D / M / W / E

GPS Receiver Reading at Site:

Lat: N 30 16 13.0

Time Read 3:53p CST

Lon: W 97 44 46.0

2:53:00

Elev: 558'

Map Sketch (show street reference and local benchmark features):

WX: PC to clear, ~60°F

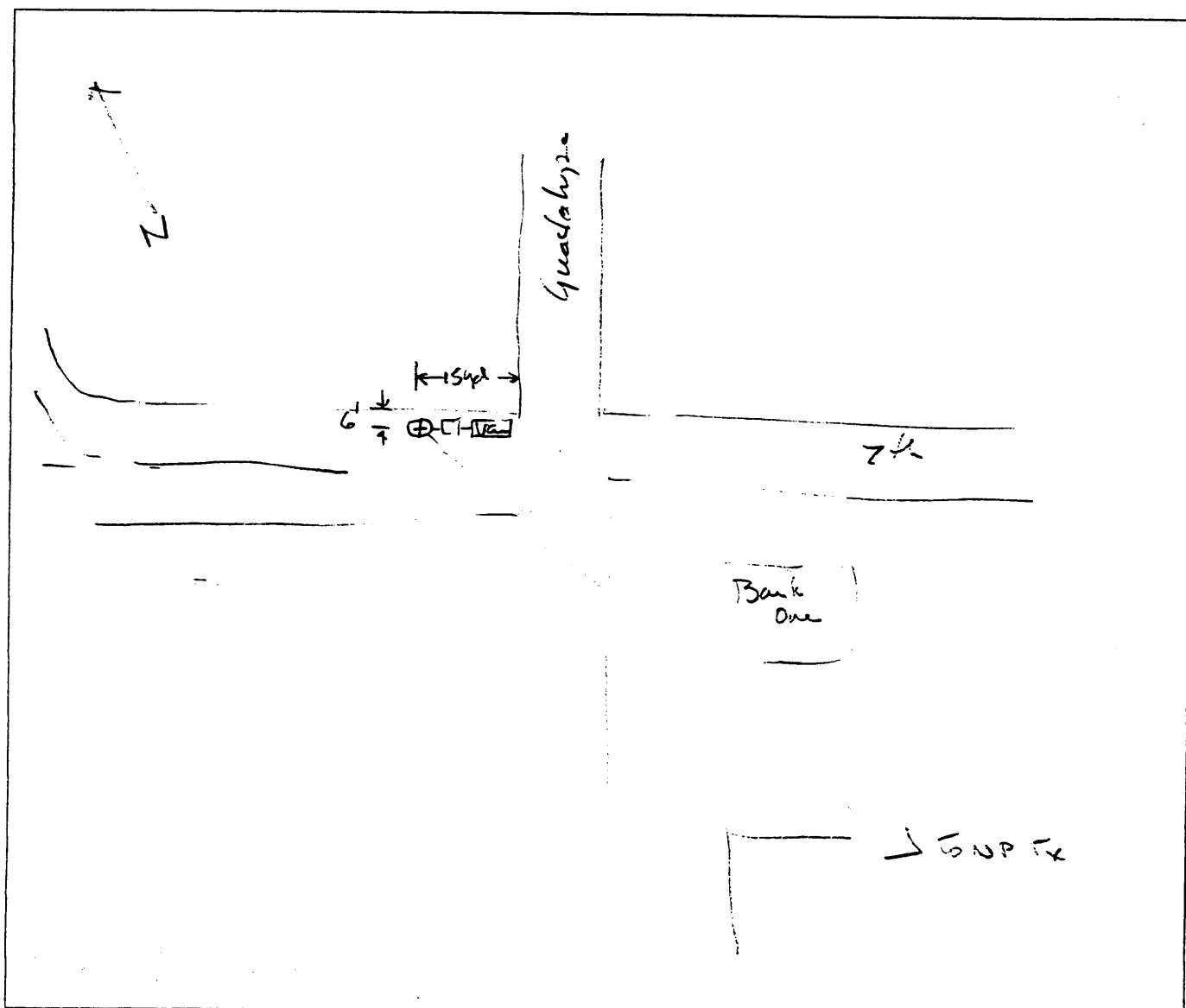

Northpoint Technology – DBS Compatibility Test – Austin Test Area

Rx Site Location Log

Rx Site No. 24 p1
Set: 1/1

Site Name:

Date / Time:

12/30/93 4:22p CST

11th & Guadalupe

Operator:

Jim / M14 / ME

GPS Receiver Reading at Site:

Lat: N 30 16 27.3

Time Read 4:35p CST

Lon: W 97 44 42.3

22:35:00

Elev: 590'

Map Sketch (show street reference and local benchmark features):

w/ PC, 60°K
 breeze

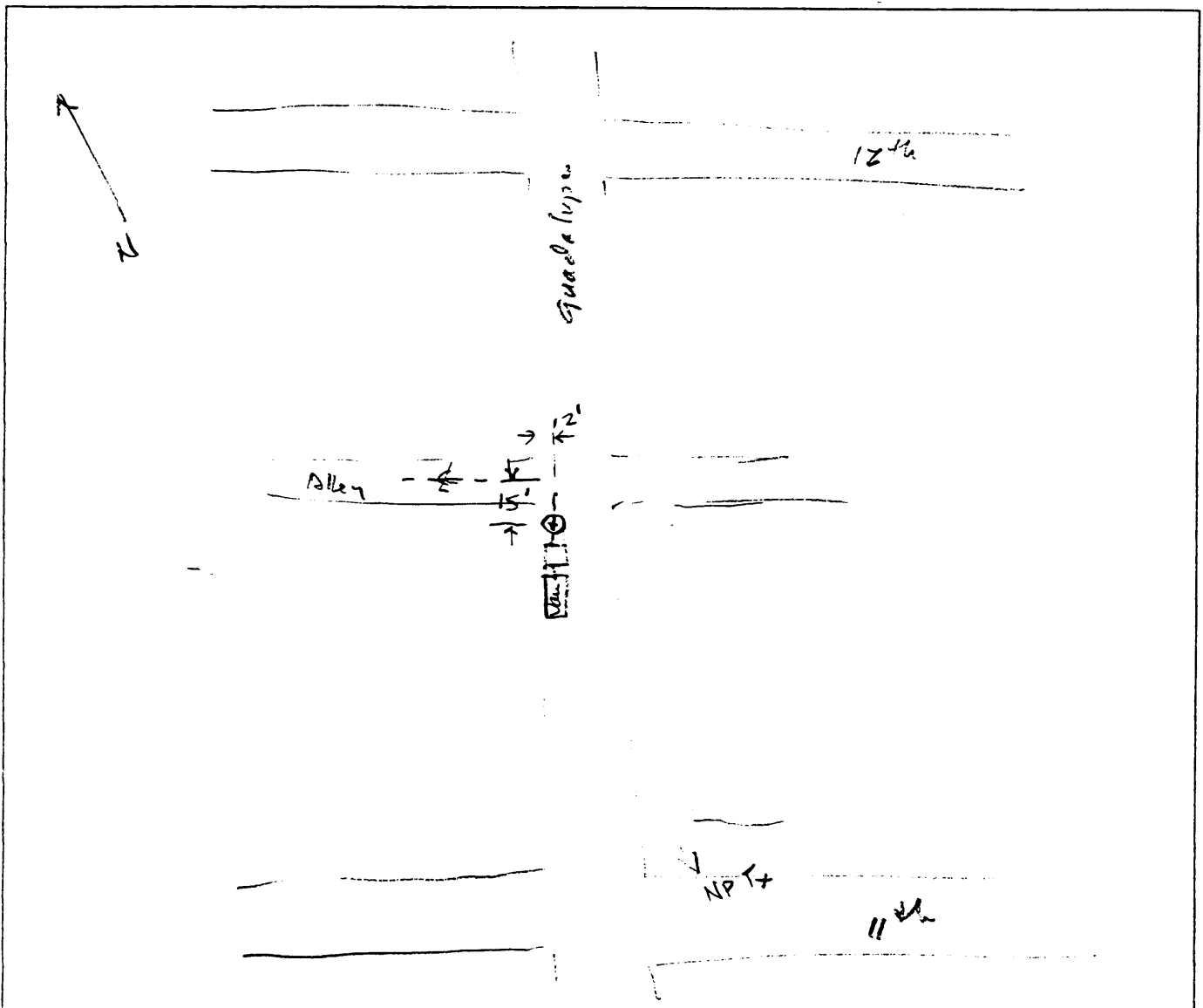

Northpoint Technology – DBS Compatibility Test – Austin Test Area

Rx Site Location Log

Rx Site No. 25 p1
Set: 1/1

Site Name:

Date / Time:

12 / 30 / 98 5:17p CST

7th & Baylor

Operator:

Dm / MH / ME

GPS Receiver Reading at Site:

Lat: N 30 16 24.3

Time Read 5:31p CST

Lon: W 97 45 18.1

2313100

Elev: 404'

Map Sketch (show street reference and local benchmark features):

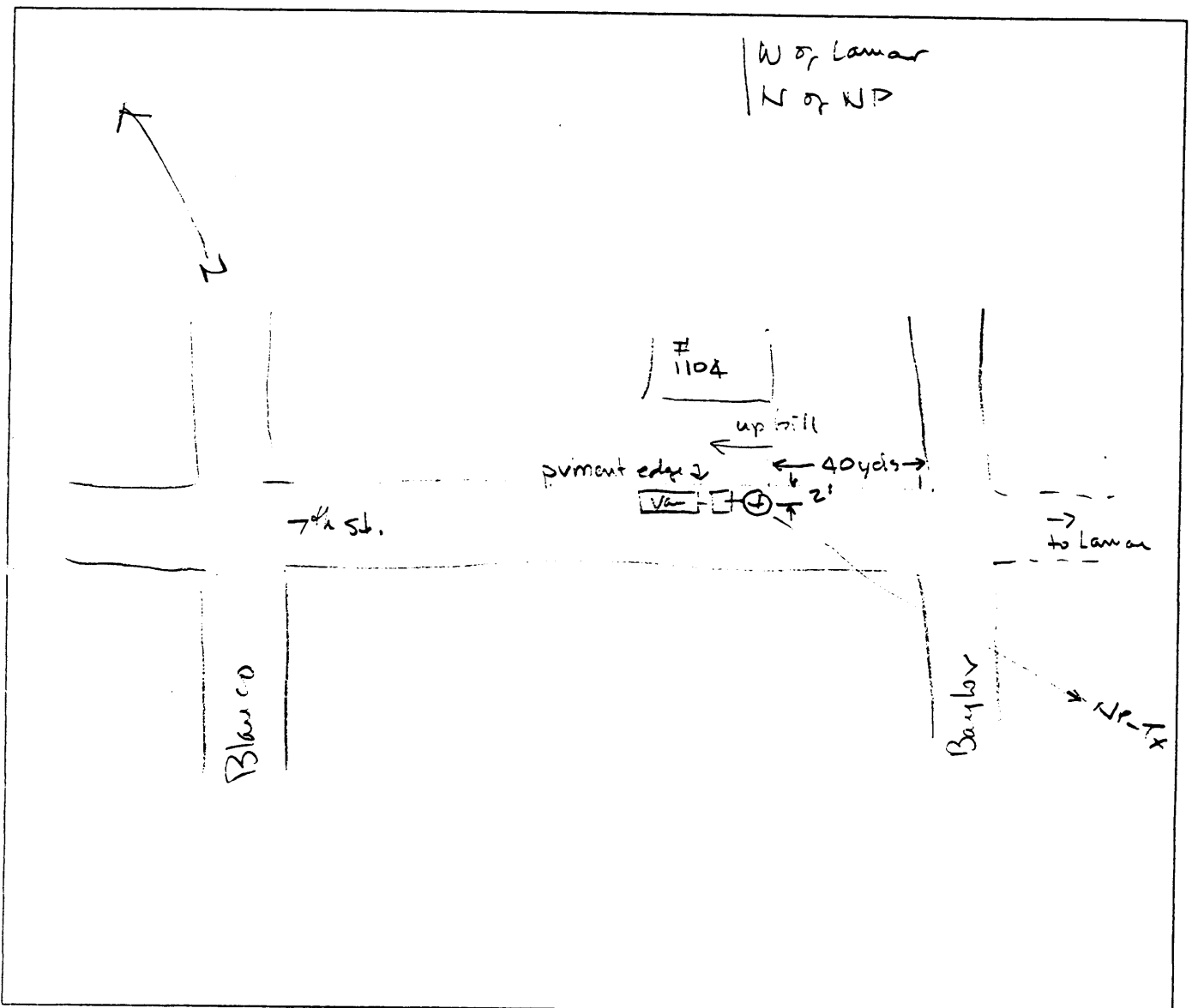

Northpoint Technology - DBS Compatibility Test - Austin Test Area

Rx Site Location Log

Rx Site No.

26

pl

Set:

1/

Site Name:

Date / Time:

12/31/98 11:46 CST

Southwest Driveway

Operator:

Du/MH/ME

GPS Receiver Reading at Site:

Lat: N 30 14 57.0

Time Read 12:00 CST

Lon: W 97 51 04.0

18:00:00

Elev: 891'

Map Sketch (show street reference and local benchmark features):

W heavy overcast
occas. mist
~ 60°F

can only barely see skyline.

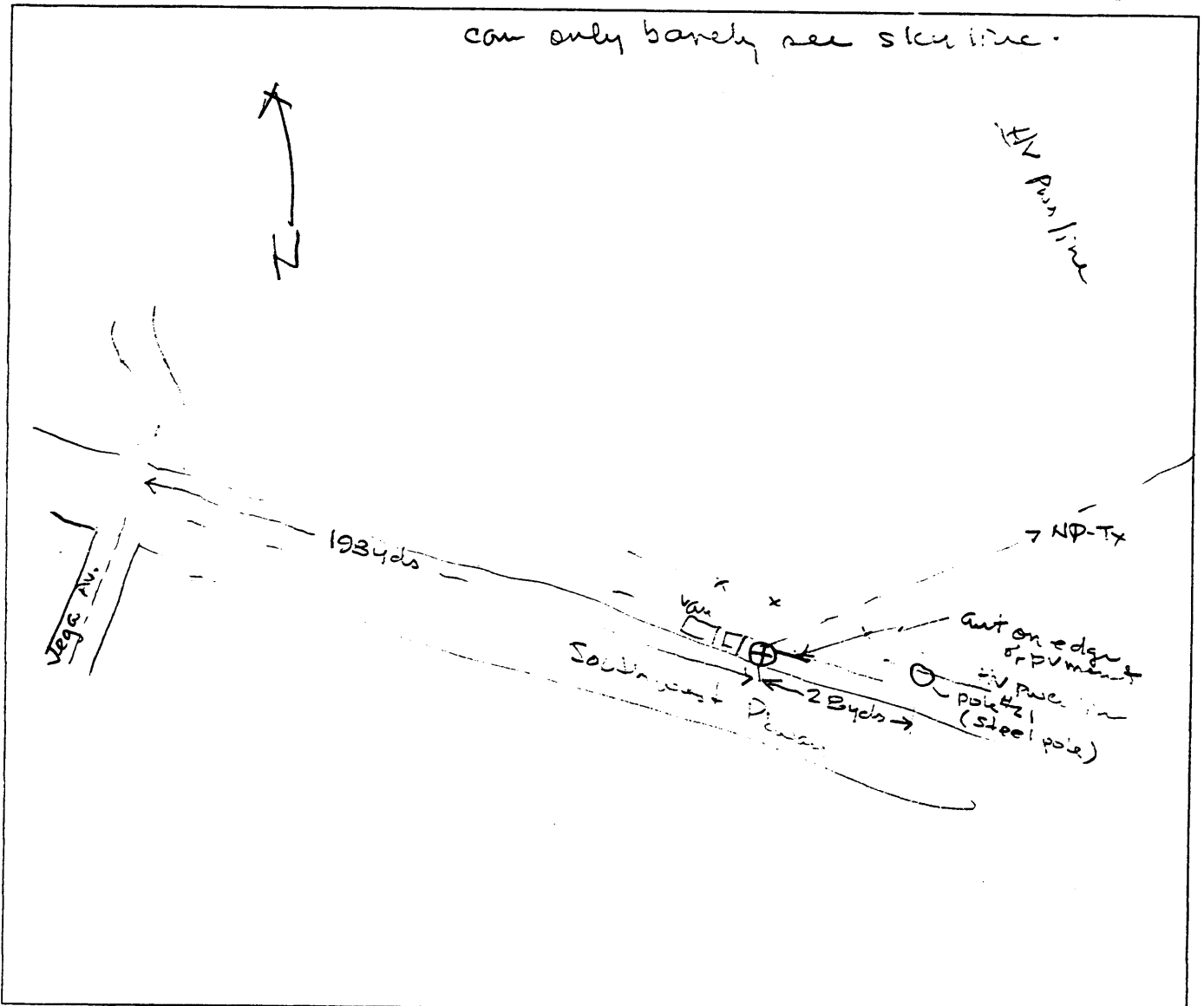

Northpoint Technology - DBS Compatibility Test - Austin Test Area

Rx Site Location Log

Rx Site No. 27 pl
Set: i /

Site Name: _____ Date / Time: 12/31/98 12:23 PST

Southwest Pkwy 2 Operator: Dew / MH / ME

GPS Receiver Reading at Site:	Lat: <u>N 30 15 07.3</u>	N 30 15 08.1
Time Read <u>12:23 PST</u>	Lon: <u>W 97 51 41.8</u>	W 97 51 42.4
<u>18:23:00</u>	Elev: <u>1232'</u>	<u>612'</u>
		<u>18:29:00</u>

Map Sketch (show street reference and local benchmark features):

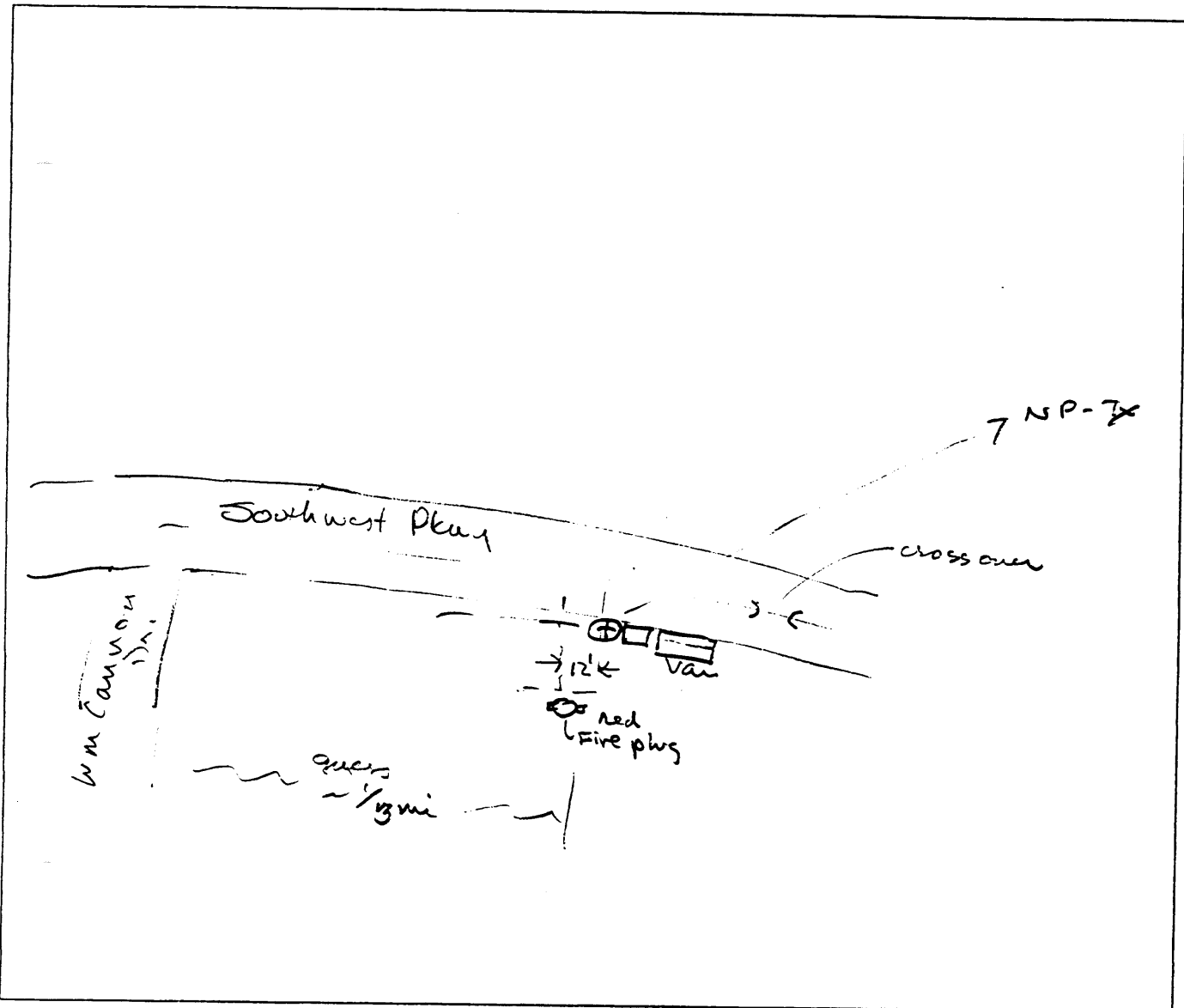

Tx

Northpoint Technology – DBS Compatibility Test – Austin Test Area

Rx Site Location Log

Rx Site No. 28 p1
Set: / /

Site Name:

Date / Time:

12 / 31 / 98 1:05 CST

Mopac @ Gaines Ranch Loop

Operator:

Du / MH / ME

GPS Receiver Reading at Site:

Lat: N 30 14 24.4

Time Read 1:17 p CST
19:17:00

Lon: W 97 49 05.5

Elev: 695'

Map Sketch (show street reference and local benchmark features):

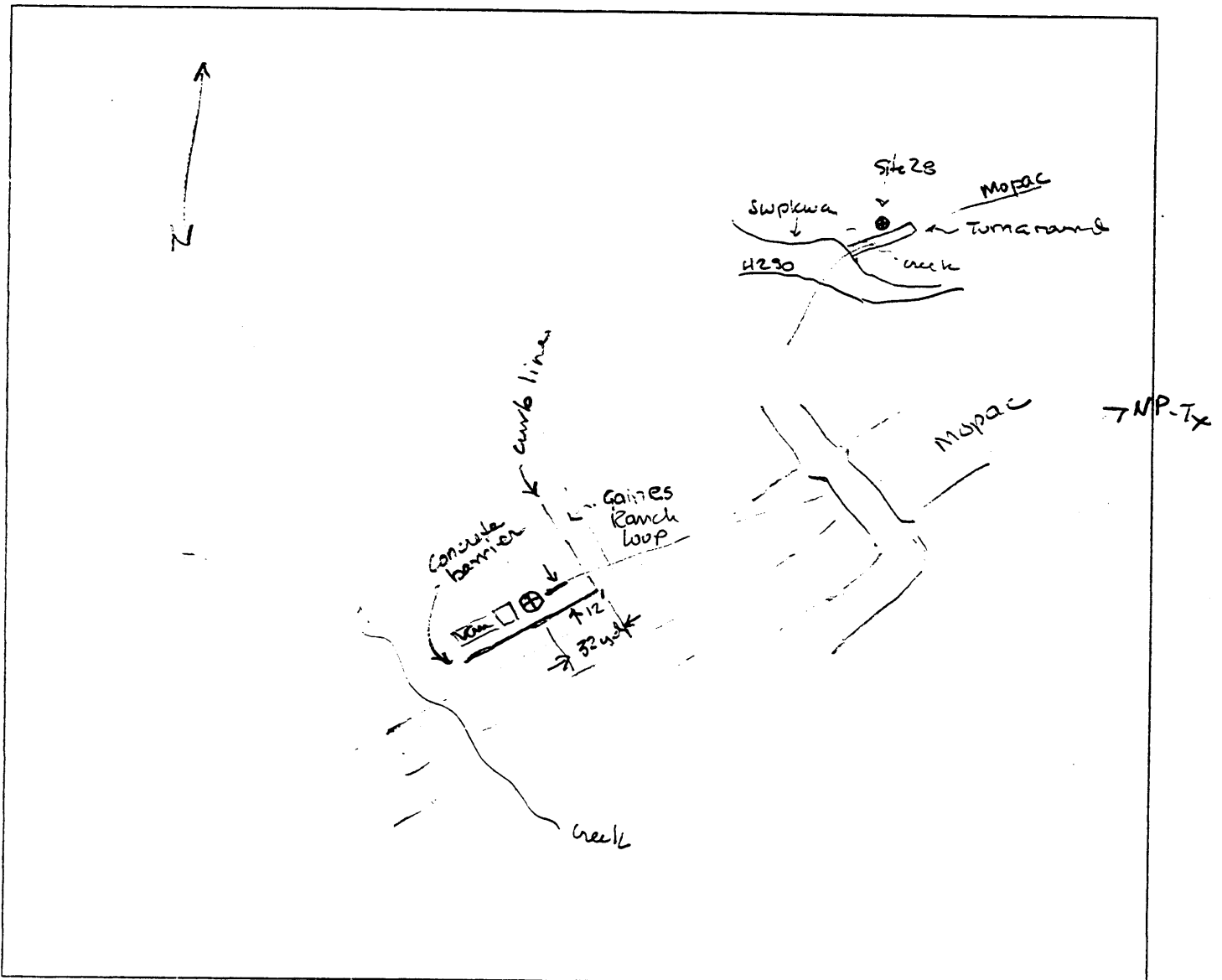

Northpoint Technology – DBS Compatibility Test – Austin Test Area

Rx Site Location Log

Rx Site No. 29 pl
Set: 1/1

Site Name: _____ Date / Time: 12/31/99 3:33 CST

HEB 10th & Wm Cannon Operator: Dm / MH / ME

GPS Receiver Reading at Site: Lat: N 30 11 49.3
Time Read 3:34 p CST Lon: W 97 47 02.3
21:34:00 Elev: 512'

Map Sketch (show street reference and local benchmark features):

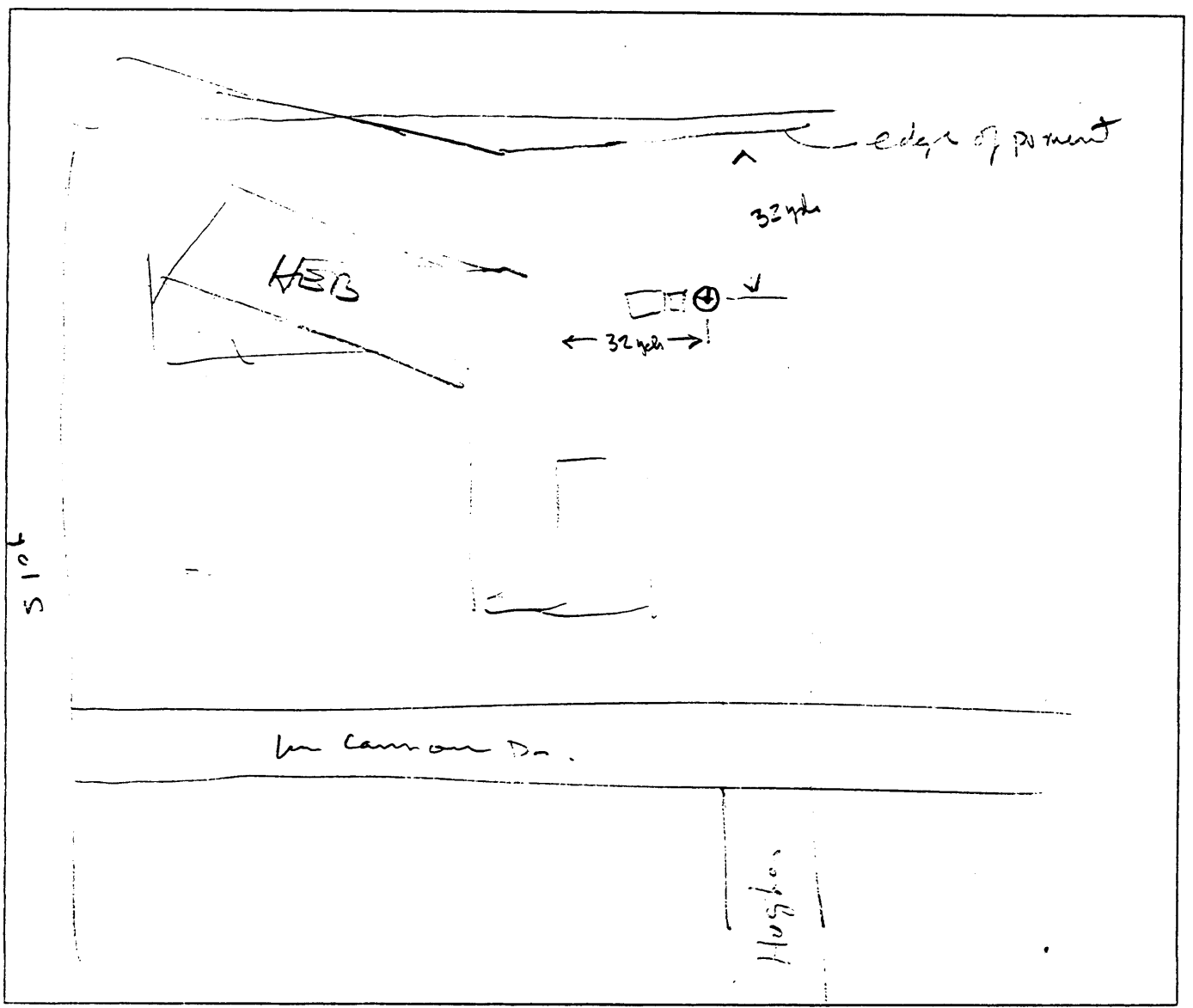

C. Rx Condx Log

Note: This log describes the Rx system in use and is referenced by the Field Logs.