



Wireless Gaming Controller PGR300 / PGR301



Quick Start Guide / Guide de démarrage rapide
Kurzanleitung / Guida rapida
Guía de inicio rápido / Guia de início rápido
快速入門指南

acer

Quick Start Guide

Specifications

- Model: PGR300/PGR301
- Connection Type: Wireless (Bluetooth 5.0, RF 2.4G) / USB-C
- Input Standard: XInput, Switch mode
- Vibration: Dual Motors
- Size (Length x Width x Height): 157 x 112 x 64 mm
- Weight: 200 g ± 1 g (Including RF 2.4G Receiver)
- Button Amount: 16
- Working Temperature: In operation: 0°C to 45°C
Non-operation: -10°C to 60°C
- Humidity (not condensed): In operation: 5% to 55%
Non-operational: 20% to 60%

Package Contents

- Wireless Gaming Controller x 1
- Quick Start Guide x 1
- Warranty Booklet x 1
- RF 2.4G Receiver x 1
- USB-C Cable x 1
- Interchangeable Joysticks x 4 (2 sets)
- AA Batteries x 2

Functions

1. Direction Pad (D-Pad)
2. Joysticks
3. Select Button
4. O Button (Specifications vary depending on model.)
5. Mode Button
6. T Button
7. Start Button
8. Action Buttons: A, B, X, Y
9. LED Indicator

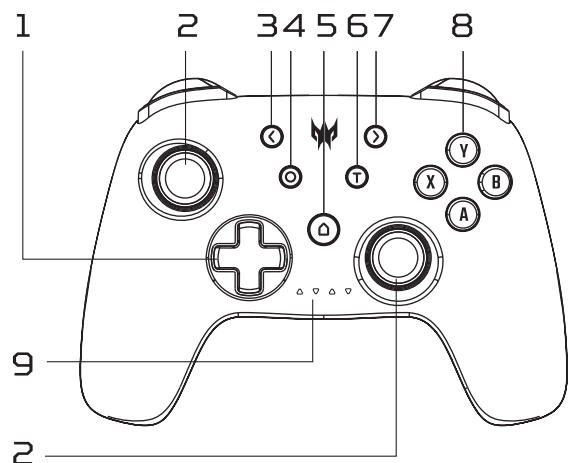

10. L1 Button
11. L2 Button
12. R1 Button
13. R2 Button
14. USB-C Port
15. RF 2.4G Receiver
(IN BATTERY CASE)

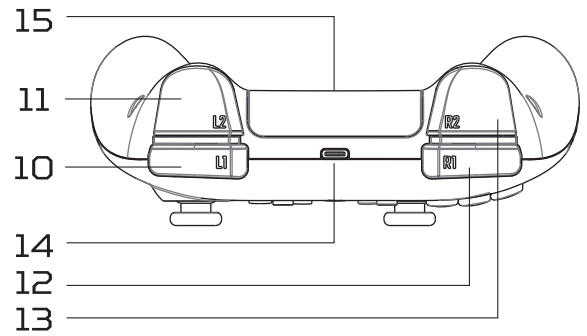

System Compatibility

- Windows® 10 and above (Bluetooth / RF 2.4G / USB-C)
- ChromeOS (Bluetooth / RF 2.4G / USB-C)
- Android™ 9 and above (Bluetooth / RF 2.4G / USB-C)
- iOS 15.5 and above (Bluetooth)
- Switch 3.0.0 and above (Bluetooth / USB-C)

Caution for safe battery usage

Replacement of a battery with an incorrect type that can defeat a safeguard.

Disposal of a battery into fire or a hot oven, or mechanically crushing or cutting of a battery, that can result in an explosion. Leaving a battery in an extremely high temperature surrounding environment that can result in an explosion or the leakage of flammable liquid or gas.

A battery subject to extremely low air pressure that may result in an explosion or the leakage of flammable liquid or gas.

Windows / ChromeOS

1. Bluetooth Connection: Press and hold the Mode and X buttons for 3 seconds while the device is powered off* to enter pairing mode**.
*LED1, 2, 3, 4 are off.

**The gaming controller requires a battery with sufficient power, and the PC must have Bluetooth functionality.

LED2 and LED3 will flash rapidly. Find and pair with named "Predator PGR300" in Bluetooth settings on PC.

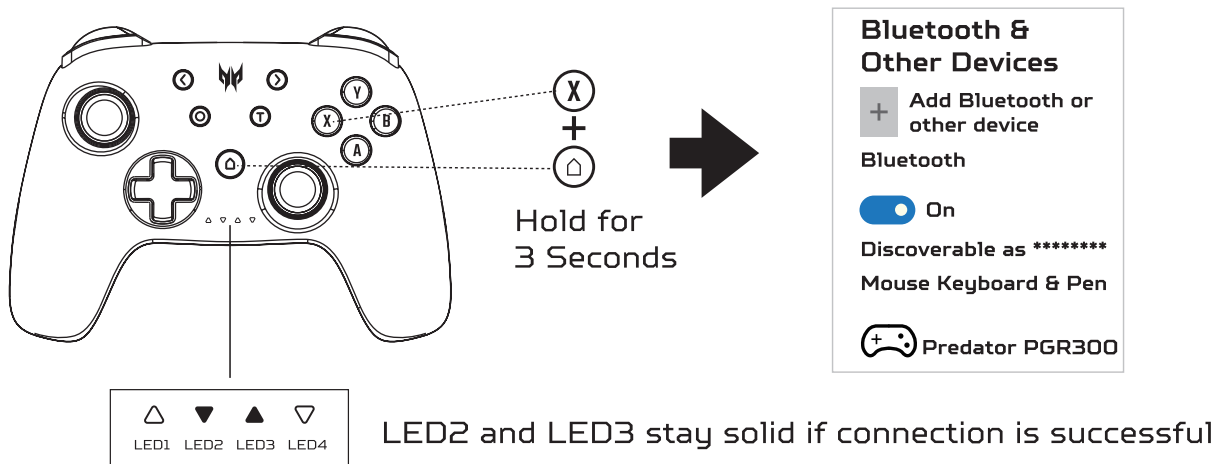

2. RF 2.4G Connection: Plug RF 2.4G Receiver in the device directly. Press and hold the Mode and A buttons for 3 seconds while the device is powered off.

LED1 and LED4 will flash rapidly.

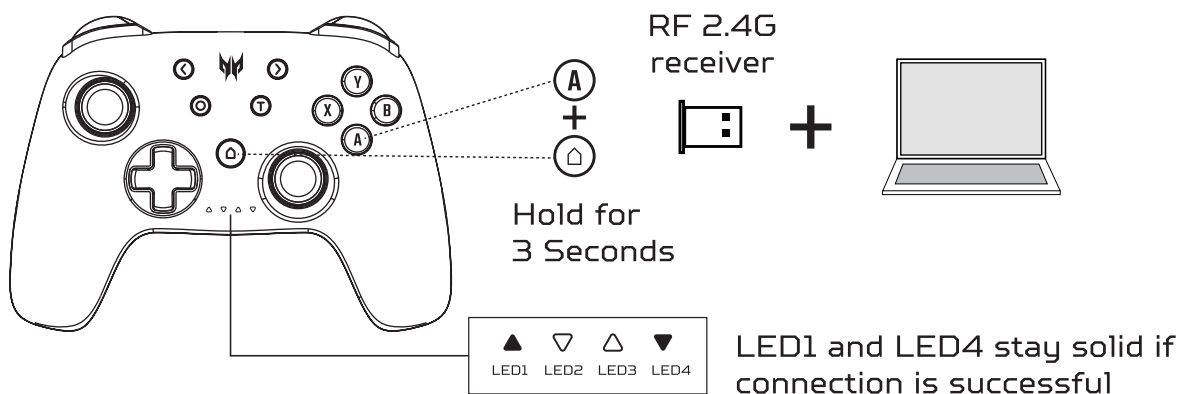

3. USB-C Connection: Plug USB cable in the device directly.

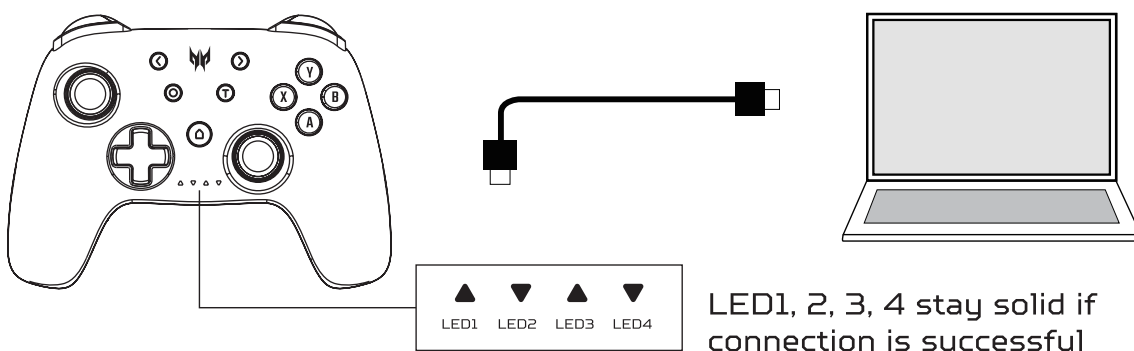

Android

1. Bluetooth Connection: Press and hold the Mode and X buttons for 3 seconds while the device is powered off* to enter pairing mode**.
*LED1, 2, 3, 4 are off.

**The gaming controller requires a battery with sufficient power. LED2 and LED3 will flash rapidly. Find and pair with named "Predator PGR300" in Bluetooth settings on Android device.

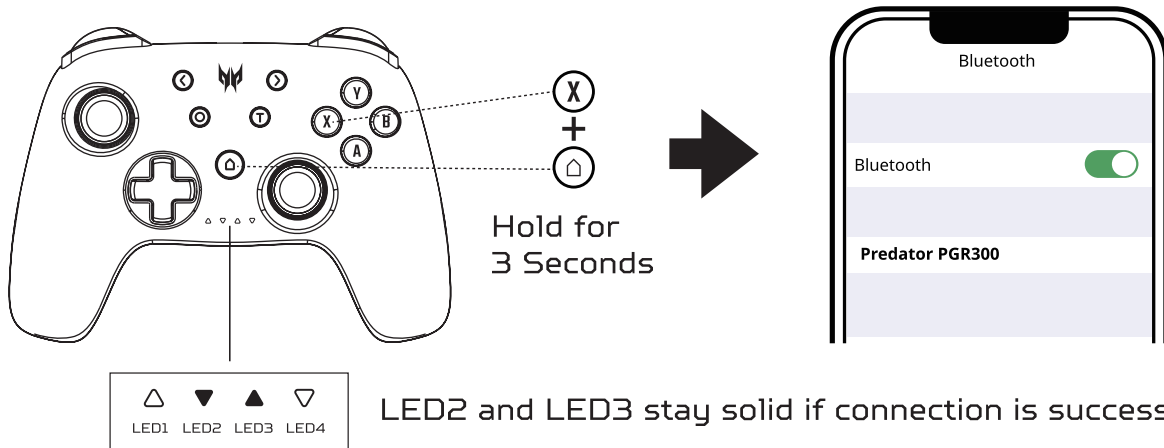

2. RF 2.4G Connection*: Plug RF 2.4G Receiver in the device directly. Press and hold the Mode and A buttons for 3 seconds while the device is powered off. LED1 and LED4 will flash rapidly.

*The Android device must have USB OTG functionality.

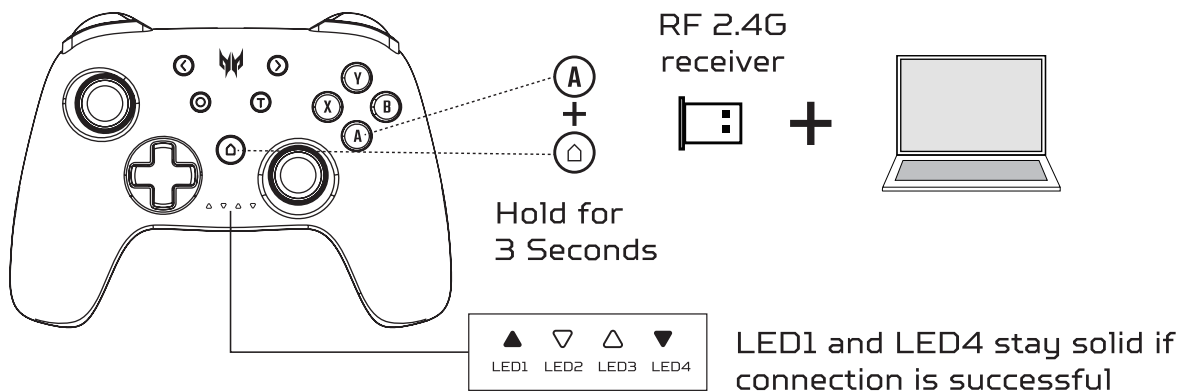

3. USB-C Connection*: Plug USB cable in the device directly.
*The Android device must have USB OTG functionality.

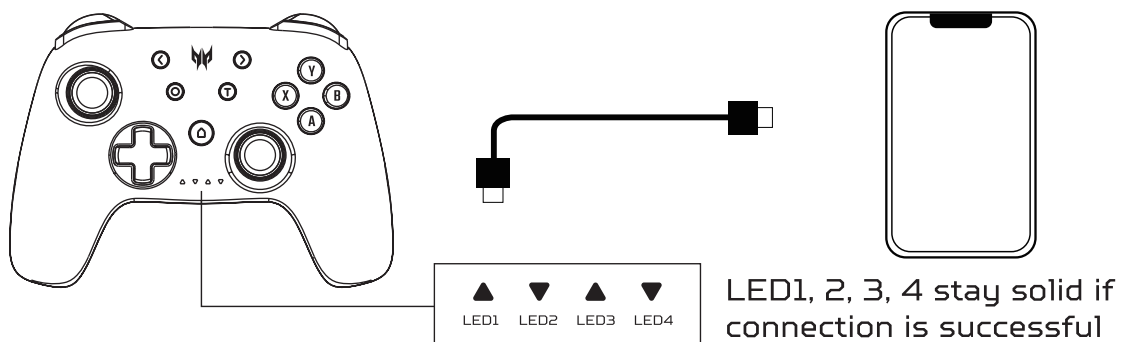

iOS

Bluetooth Connection: Press and hold the Mode and X buttons for 3 seconds while the device is powered off* to enter pairing mode**.

*LED1, 2, 3, 4 are off.

**The gaming controller requires a battery with sufficient power.

LED2 and LED3 will flash rapidly. Find and pair with named "Predator PGR300" in Bluetooth settings on iOS device.

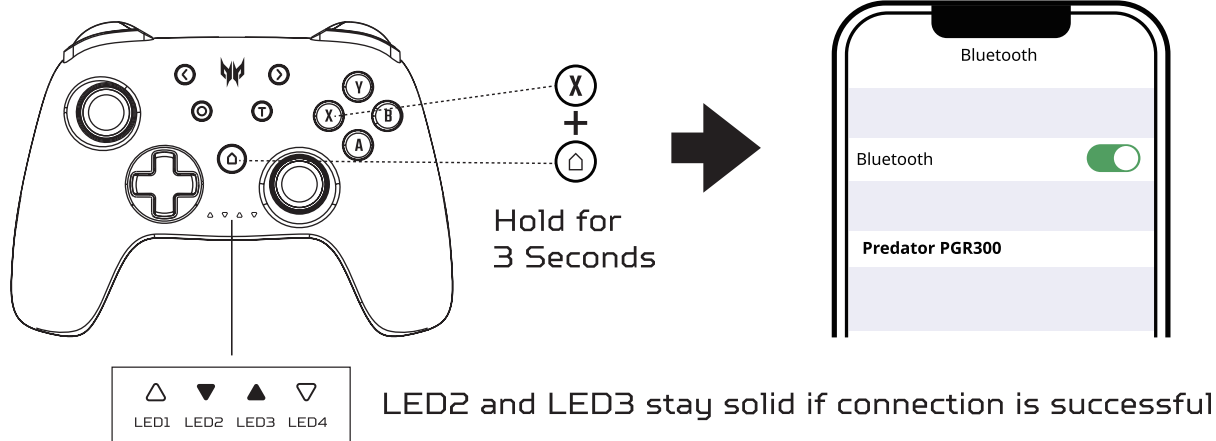

Switch

In Switch mode, the A, B, X, Y buttons will be reconfigured based on the Switch settings. [A and B, X and Y will swap, respectively.]

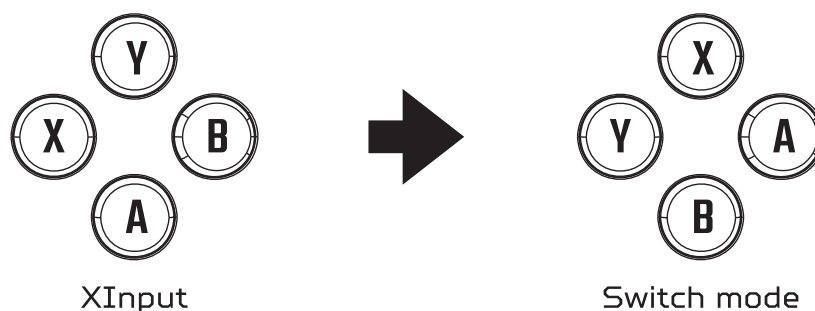

1. Bluetooth Connection: Click the Controllers on the Switch home screen, then select Change Grip/Order from the function list.

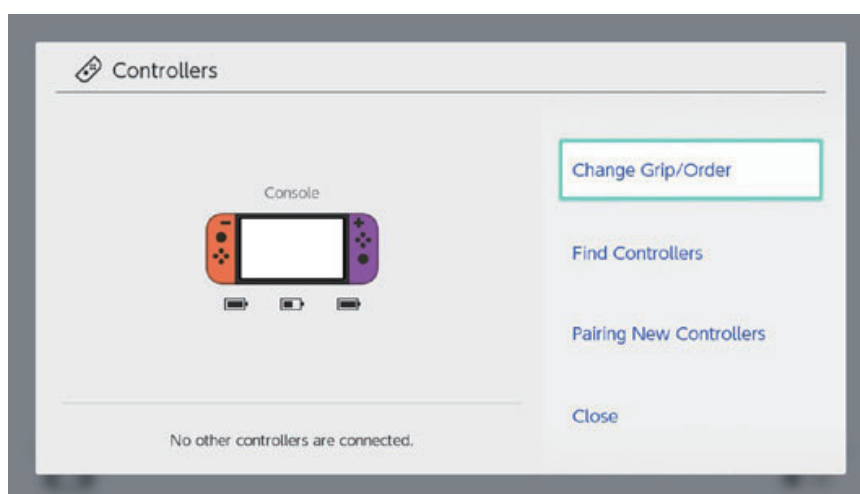
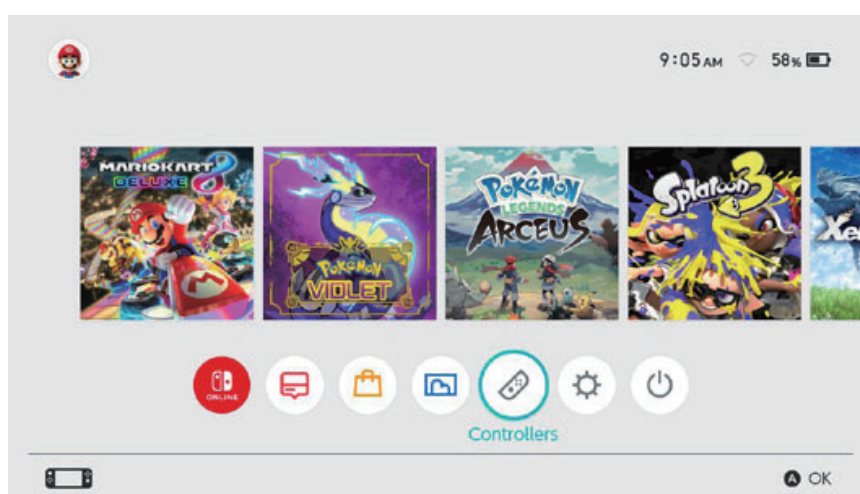

Press and hold the Mode and Y buttons for 3 seconds while the device is powered off* to enter pairing mode**.

*LED1, 2, 3, 4 are off.

**The gaming controller requires a battery with sufficient power.

LED1-4 will run back and forth from left to right. According to the steps on the Switch screen, pair the gaming controllers with the Switch.

If the pairing is successful, the Switch will automatically assign a position for each gaming controller, and the matched LED light will remain on.

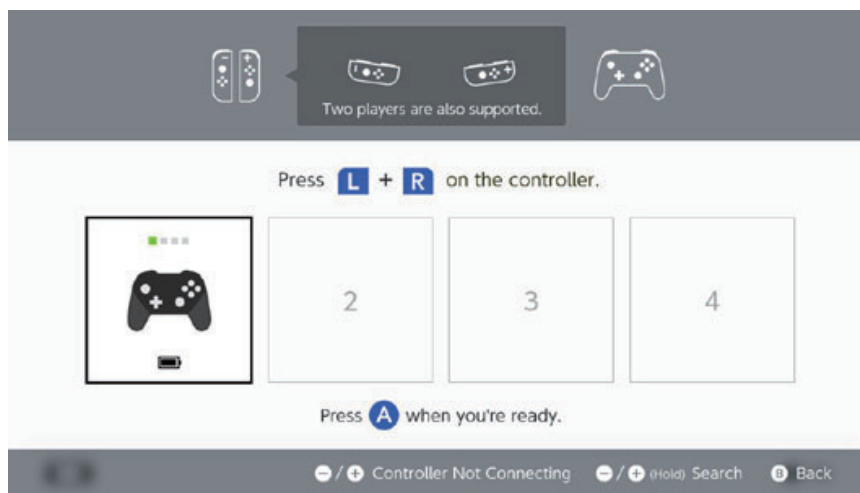
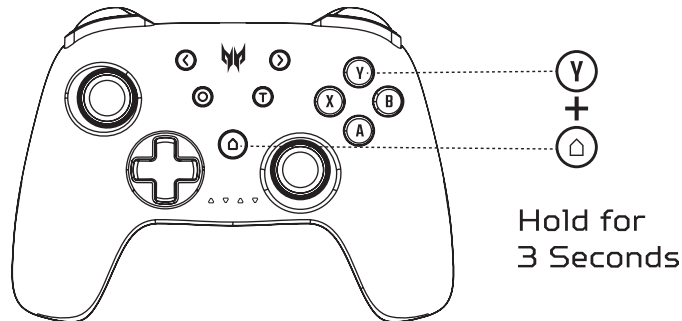

2. **USB-C Connection:** Place the Switch onto the dock, plug the USB cable into the device directly.

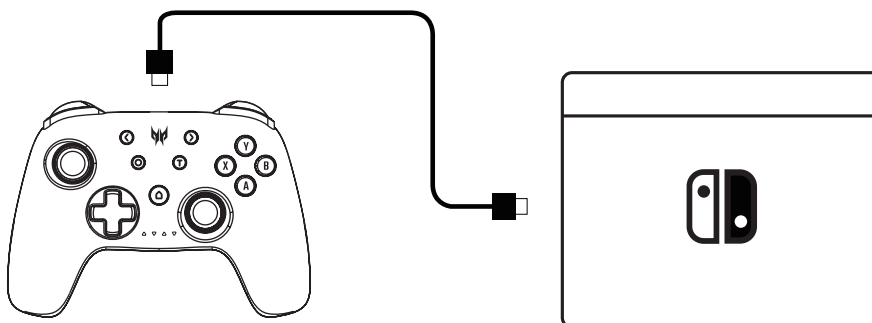

Turbo

Turbo is a function that allows for one button press to do a repeated amount of actions.

1. Turbo On/Off*: Press the T button and Action button that you want to assign. First press T button activates semi-auto mode. Hold Action button, the second press T button switches to full-auto mode.

Again, hold Action button, the third press T button clears the Turbo for that button.

Press T button for over 3 seconds, then press Select (<) button to cancel all buttons for Turbo function.

*Supported buttons: A, B, X, Y, L1, R1, L2, R2, D-Pad
(Up/Down/Left/Right)
Up/Down and Left/Right cannot be set up simultaneously.

Turbo On/Off (illustrated with A)

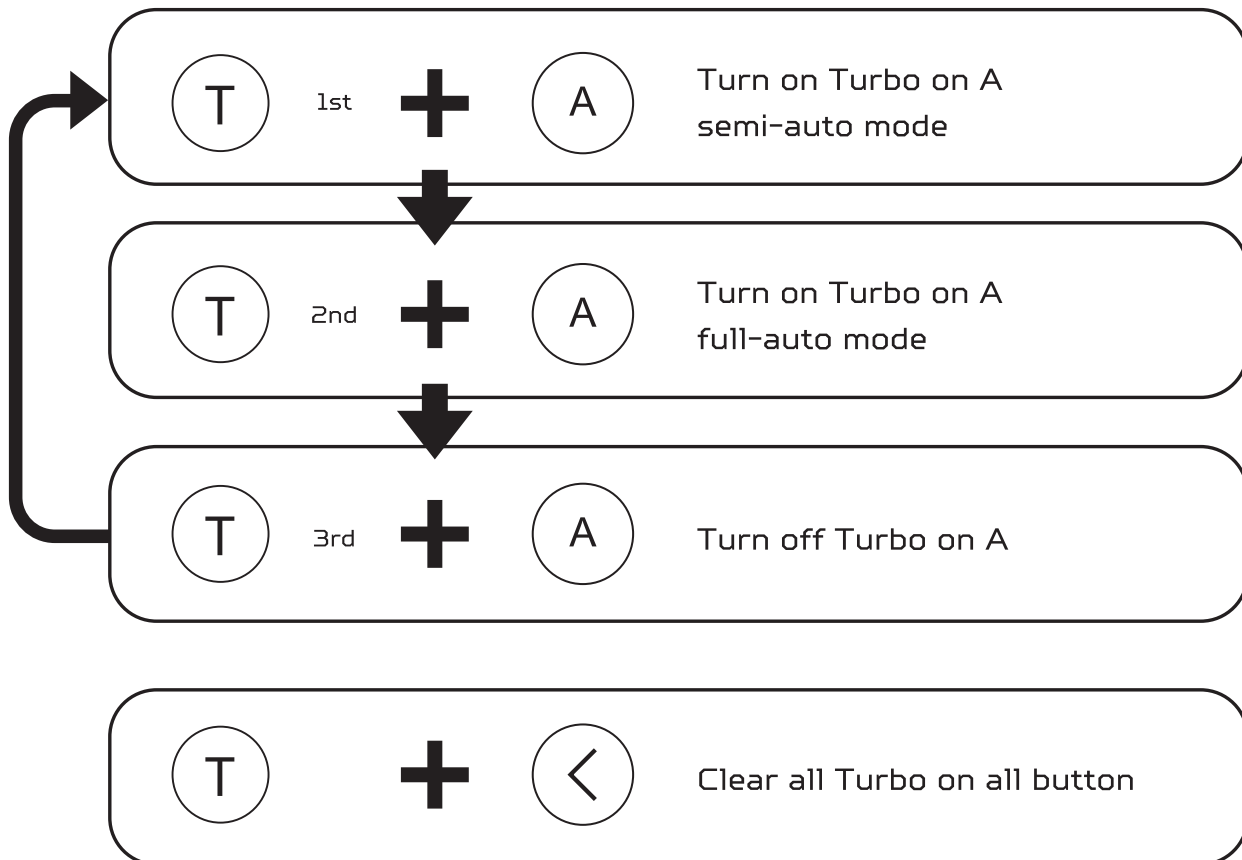

2. Adjust Turbo Level: Press and hold the T button and Left Joystick's up, right, or down buttons to adjust the speed level to high, medium, or low.

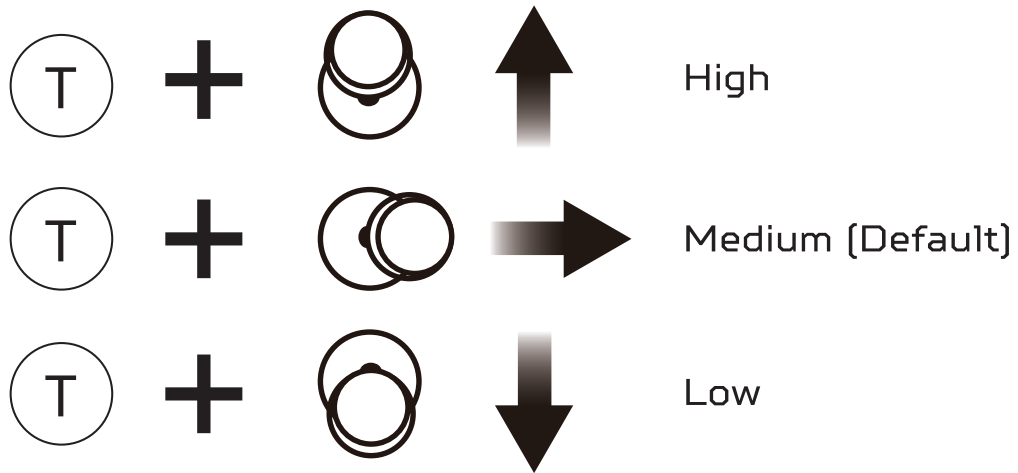

Please be aware that the Turbo function will be cleared whenever the controller is powered off.

Vibration

Adjust Vibration Level: Press and hold the T button and Right Joystick's up, right, or down buttons to adjust the vibration level to high, low, or off.

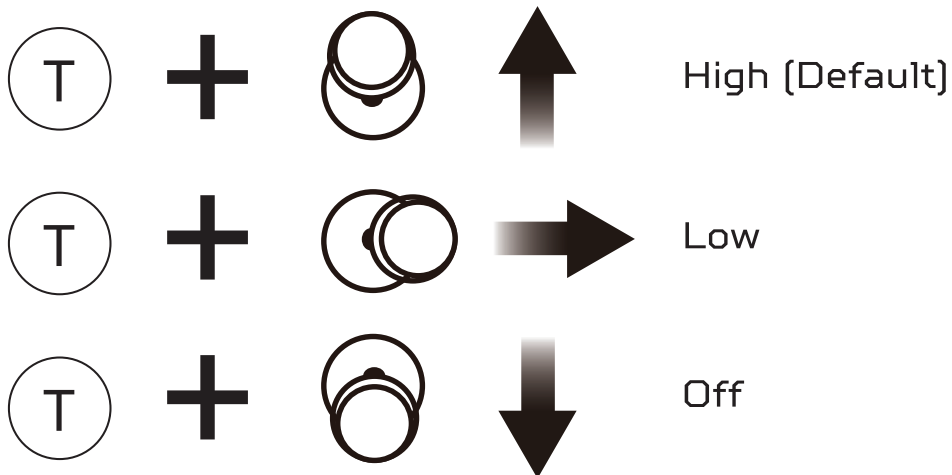

LED Light Setting

Press and Hold Left and Right Joysticks to switch the light between blue (default), red, orange, yellow, green, purple and gradient effect. The settings are saved when the gaming controller is powered off.

Low-Power Reminder

In wireless connection, a low-voltage reminder activates automatically when the voltage is below 2.2V ($\pm 0.05V$), indicated by 3 quick flashes on LED1-4, pausing for 1 second, and then repeating continuously.

The controller will shut down automatically in wireless connection, when the voltage drops below 2.0V ($\pm 0.05V$).

Wireless Reconnect & Wake up

When powered off, pressing the Mode button will awaken and automatically connect the gaming controller to the previously paired device. The LED will flash continuously for 60 seconds (it will remain steady if the connection is successful, and power off if unsuccessful), based on the pairing status of the previously connected device.

Power Off

- When the gaming controller in the wireless Bluetooth connection, press the Mode button for 3 seconds to shut down or disconnect from the main device. In pairing status, it will shut down automatically if pairing fails within 60 seconds.
- Press the Mode button to wake up the main device and reconnect; it will shut down automatically if reconnections fail within 10 seconds.
- When the gaming controller is connected, it will shut down automatically if there is no button operation within 5 minutes (including the motion sensor not working).

Reset

In case of gaming controller malfunctions, insert a small pin into the reset button located in the hole on the back of the gaming controller for a reset.

Motion Sensor Calibration

When powered off, place it on a flat surface. Press and hold [X] Select and Mode buttons to enter calibration mode. LED1, 2, 3, 4 will rapidly flash during calibration. Once completed, the gaming controller will power off.

If calibration failure, LED1, 2, 3, 4 will stay solid. Press the Mode button twice quickly to exit calibration mode. Then, power off and repeat the previous steps.

Caution

- Do not disassemble the device or operate the device under abnormal conditions.
- Do not submerge the device in water.
- If the device could not be functional, or there was thermal abnormal situation, please reconnect or reset.
- If you still encounter problems after going through the corrective measures, please contact your dealer or an authorized service center for assistance.
- For more information regarding the PREDATOR accessories, please visit the PREDATOR website at www.acer.com/predator.



CE declaration of conformity

Hereby, Acer Inc., declares that this Wireless Gaming Controller is in compliance with the essential requirements and other relevant provisions of Radio Equipment Directive 2014/53/EU, and RoHS Directive 2011/65/EU with regard to establishing a framework for the setting of ecodesign requirements for energy-related product.



Abandonment of waste equipment for EU household users

This symbol on the product or on its packaging indicates that the product must not be disposed of with other household waste. When disposing of used devices, it is your responsibility to bring it to a collection point that recycles used electrical and electronic equipment. The separate collection and recycling of used devices at the time of disposal helps to conserve natural resources and ensures that they are recycled in a manner that protects human health and the environment. For more information about recycling points for used devices, please contact your local city office, household waste disposal service, or the shop where you purchased the product.

Federal Communication Commission Interference Statement

This equipment has been tested and found to comply with the limits for a Class B digital device, pursuant to Part 15 of the FCC Rules. These limits are designed to provide reasonable protection against harmful interference in a residential installation. This equipment generates, uses and can radiate radio frequency energy and, if not installed and used in accordance with the instructions, may cause harmful interference to radio communications. However, there is no guarantee that interference will not occur in a particular installation. If this equipment does cause harmful interference to radio or television reception, which can be determined by turning the equipment off and on, the user is encouraged to try to correct the interference by one of the following measures:

- Reorient or relocate the receiving antenna.
- Increase the separation between the equipment and receiver.
- Connect the equipment into an outlet on a circuit different from that to which the receiver is connected.
- Consult the dealer or an experienced radio/TV technician for help.

FCC Caution: Any changes or modifications not expressly approved by the party responsible for compliance could void the user's authority to operate this equipment.

This device complies with Part 15 of the FCC Rules. Operation is subject to the following two conditions: (1) This device may not cause harmful interference, and (2) this device must accept any interference received, including interference that may cause undesired operation.

Radiation Exposure Statement

The product comply with the FCC portable RF exposure limit set forth for an uncontrolled environment and are safe for intended operation as described in this manual. The further RF exposure reduction can be achieved if the product can be kept as far as possible from the user body or set the device to lower output power if such function is available.

IC Statement

CAN ICES-003(B)/NMB-003(B)

Canada – Industry Canada (IC)

This device complies with RSS247 of Industry Canada. Cet appareil se conforme à RSS247 de Canada d'Industrie. This device complies with Industry Canada licence-exempt RSS standard(s). Operation is subject to the following two conditions: (1) this device may not cause interference, and (2) this device must accept any interference, including interference that may cause undesired operation of the device.

CAN ICES-3(B)/NMB-3(B)

Le présent appareil est conforme aux CNR d'Industrie Canada applicables aux appareils radio exempts de licence. L'exploitation est autorisée aux deux conditions suivantes : (1) l'appareil ne doit pas produire de brouillage, et (2) l'utilisateur de l'appareil doit accepter tout brouillage radioélectrique subi, même si le brouillage est susceptible d'en compromettre le fonctionnement.

CAN ICES-3(B)/NMB-3(B)

IC RF Radiation Exposure Statement:

This equipment complies with IC radiation exposure limits set forth for an uncontrolled environment. This equipment should be installed and operated with minimum distance which states in DoC between the radiator & your body. This transmitter must not be co-located or operating in conjunction with any other antenna or transmitter.

Déclaration d'exposition aux radiations:

Cet équipement est conforme aux limites d'exposition aux rayonnements IC établies pour un environnement non contrôlé. Cet équipement doit être installé et utilisé avec la distance minimale indiquée dans la DoC entre le radiateur et votre corps. Cet émetteur ne doit pas être colocalisé ou fonctionner en conjonction avec une autre antenne ou émetteur.



Acer Incorporated
8F, 88, Sec. 1, Xintai 5th Rd., Xizhi
New Taipei City 221, Taiwan

Declaration of Conformity

We,

Acer Incorporated

8F, 88, Sec. 1, Xintai 5th Rd., Xizhi, New Taipei City 221, Taiwan

And,

Acer Italy s.r.l.

Viale delle Industrie 1/A, 20044 Arese (MI), Italy

Tel: +39-02-939-921, Fax: +39-02 9399-2913

www.acer.it

Product: Wireless Gaming Controller
Trade Name: acer
Model Number: PGR300/PGR301

We, Acer Incorporated, hereby declare under our sole responsibility that the product described above is in conformity with the relevant Union harmonization legislation: Radio Equipment Directive 2014/53/EU and RoHS Directive 2011/65/EU. The following harmonized standards and/or other relevant standards have been applied:

EN 300 440 V2.1.1: 2017-03

EN 62479: 2010

EN 301 489-1 V2.2.3: 2019-11

EN 62368-1: 2014+A11: 2017

EN 301 489-3 V2.1.1:2019-03

EN IEC 63000:2018

EN 50663: 2017

EN 300 328 V2.2.2: 2019-07

This radio equipment operates with the following frequency bands and maximum radio-frequency power:

Frequency: 2405-2474MHz

Maximum Output Power: < 10dBm (EIRP)

Year to begin affixing CE marking: 2024.

RU Jan / Sr. Manager
Acer Incorporated (Taipei, Taiwan)

2024/3/29

Date



Acer America Corporation

1730 N First St Suite 400,
San Jose, CA 95112

Tel : (408) 533-7700

Fax : (408) 533-4555



Federal Communications Commission Declaration of Conformity

This device complies with Part 15 of the FCC Rules. Operation is subject to the following two conditions: (1) this device may not cause harmful interference, and (2) this device must accept any interference received, including interference that may cause undesired operation.

The following local Manufacturer /Importer is responsible for this declaration:

Product:	Wireless Gaming Controller
Model Number:	PGR300/PGR301
Name of Responsible Party:	Acer America Corporation
Address of Responsible Party:	1730 N First St Suite 400, San Jose, CA 95112 U. S. A.
Contact Person:	Acer Representative
Phone No.:	(408) 533-7700
Fax No.:	(408) 533-4555