

RAPH'S RAD RIDE™



POWER

1 BATTERIES : 2 X AAA (NOT INCLUDED)

2 CHARGING INDICATOR

CHARGING: RED

CHARGED: GREEN

PAIRING: CONTROLLER BLINKING

Please fully charge the toy for the first time use and always keep the battery in fully charged condition even when the toy is not in use. This will help to ensure that your battery will work properly and prevent it from weakening over time.

3 TURN ON REMOTE & MOTORCYCLE

Note: Always turn off when not in use

CONTENTS

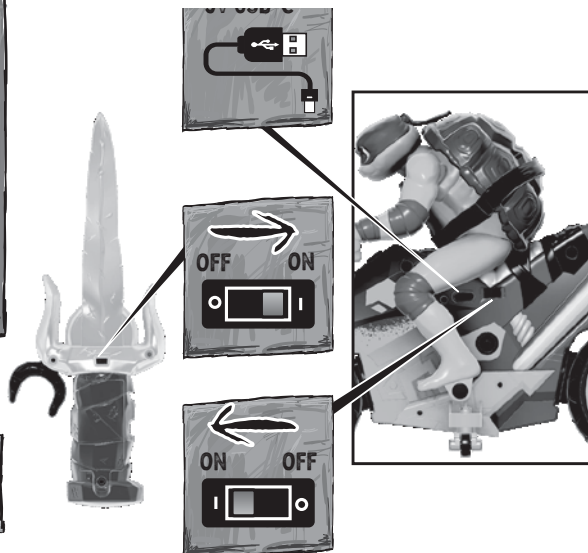

REMOTE FUNCTIONS

4 TURN KNOB TO ROTATE WHEELS & GLIDE SIDEWAYS

5 PUSH/PULL TRIGGER TO DRIVE

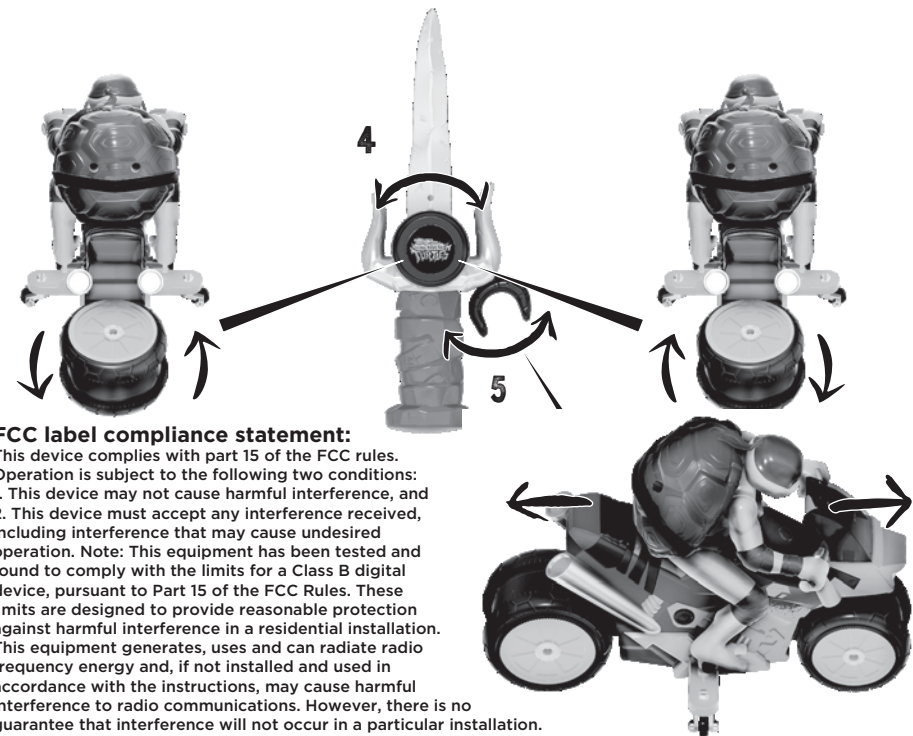

FCC label compliance statement:

This device complies with part 15 of the FCC rules. Operation is subject to the following two conditions:
1. This device may not cause harmful interference, and
2. This device must accept any interference received, including interference that may cause undesired operation. Note: This equipment has been tested and found to comply with the limits for a Class B digital device, pursuant to Part 15 of the FCC Rules. These limits are designed to provide reasonable protection against harmful interference in a residential installation. This equipment generates, uses and can radiate radio frequency energy and, if not installed and used in accordance with the instructions, may cause harmful interference to radio communications. However, there is no guarantee that interference will not occur in a particular installation. If this equipment does cause harmful interference to radio or television reception, which can be determined by turning the equipment off and on, the user is encouraged to try to correct the interference by one or more of the following measures:
- Reorient or relocate the receiving antenna
- Increase the separation between the equipment and receiver
- Connect the equipment into an outlet on a circuit different from that to which the receiver is connected
- Consult the dealer or an experienced radio/TV technician for help
Warning: Changes or modifications to this unit not expressly approved by the party responsible for compliance could void the user's authority to operate the equipment

We reserve the right to improve/amend specifications and colors without notice.

• The transformer, power supply or battery charger used with the electric toy shall be regularly examined for damage to the supply cord, plug, enclosure or other parts, and in the event of damage, it shall not be used until the damage has been repaired.
• The toy shall only be used with a transformer for toys or a power supply for toys;
• The toy shall only be used with a 5V/2A USB-A charger.
• The toy is not to be connected to more than the recommended number of transformers or power supplies.

Hereby, Funrise, declares that the radio equipment type 71138 RAPH'S RAD RIDE is compliant with Directive 2014/53/UE. The full text of the EU declaration of conformity is available at the following Internet address: <https://funrise.com/certificates-france/>

TYPE OF EQUIPMENT : TMNT RAPH'S RAD RIDE (71138)
MODEL NO. : 71138A, 71138B
ADDITIONAL MODEL: 71138



Distributed by Funrise, Inc., Sherman Oaks, CA 91403 U.S.A.
1800-882-3808

© 2024 Viacom Overseas Holdings C.V.
All Rights Reserved.



FCC ID : 2AWSR-F71138A /
FCC ID : 2AWSR-F71138B
MODEL : 71138

* All instruction sheets must be retained since it contains important information.